

NOTES:
 1. FOR LEGEND, ABBREVIATIONS AND GENERAL NOTES SEE SHEETS WA-H-001 AND WA-H-002.

This document and the design it covers are the property of PARSONS. They are loaned only with the borrower's expressed written agreement that they will not be reproduced, copied, loaned, exhibited, or used in any other way, except by written consent from PARSONS to the borrower.

This document and the design it covers are the property of PARSONS. They are loaned only with the borrower's expressed written agreement that they will not be reproduced, copied, loaned, exhibited, or used in any other way, except by written consent from PARSONS to the borrower.

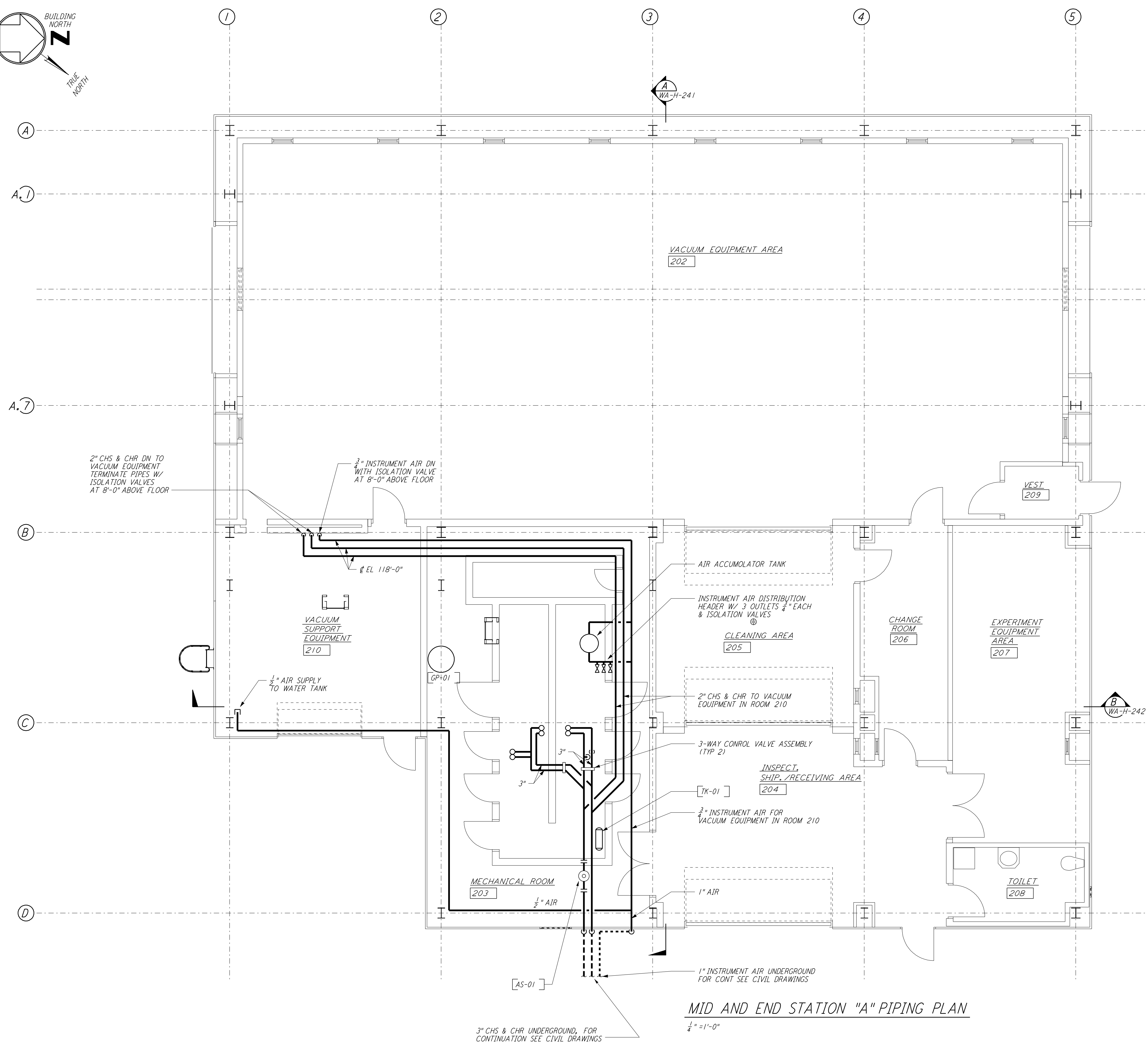

MID AND END STATION "A" PIPING PLAN
 1/4" = 1'-0"

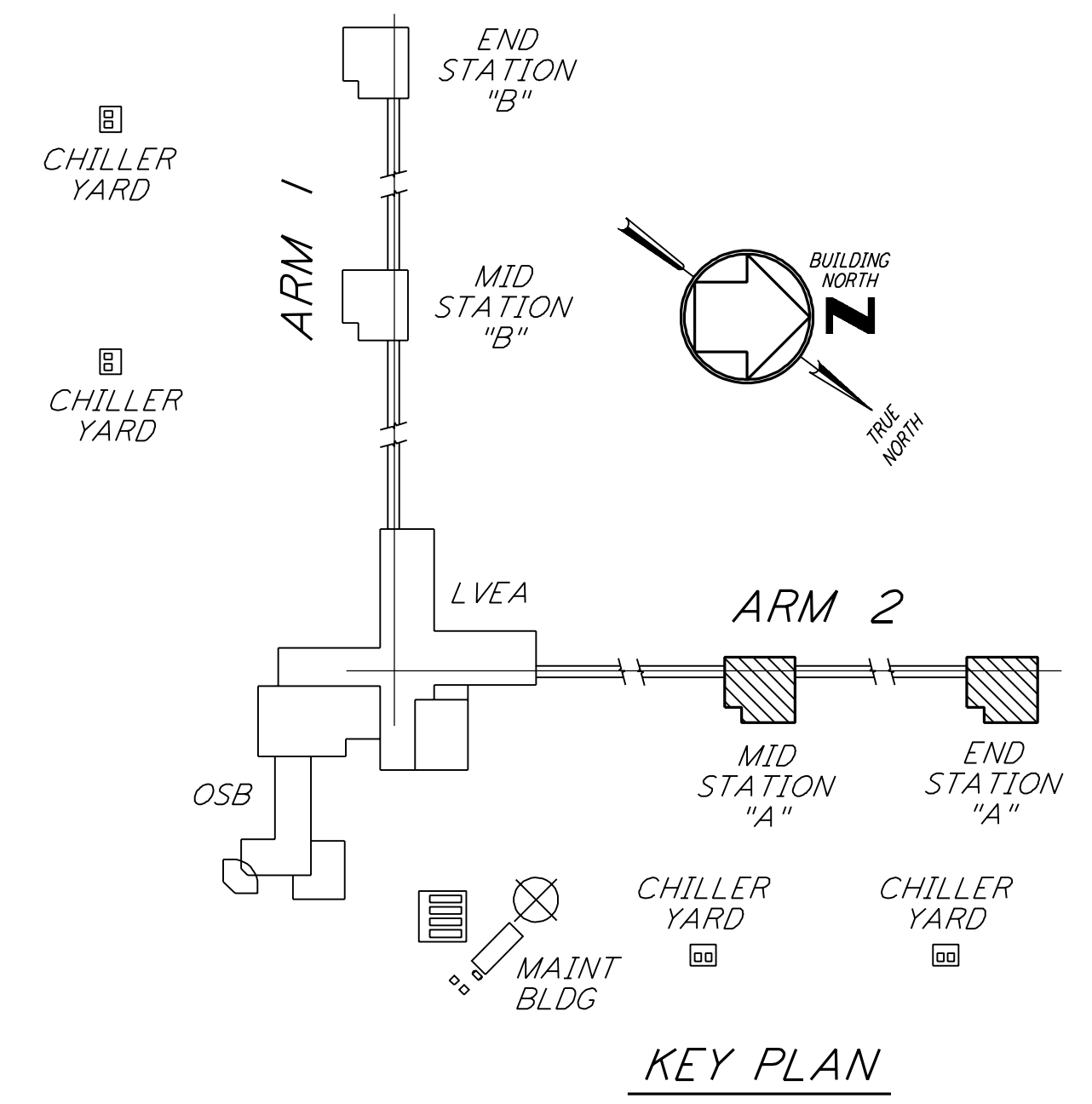

0 4 8 12 16 FT
 1/4" = 1'-0"

LIGO-D960364-01-0

NO.	DATE	BY	CHKD	ENGR	PROJ	DESCRIPTION
1	5-15-98	CP				ISSUED FOR AS-BUILT

ISSUED FOR CONSTRUCTION	CLP	6-24-96
DRAWN		
CHECKED		
ENGINEER		
PROJ		

AS-BUILT DRAWINGS

PARSONS
 100 WEST WALNUT STREET
 PASADENA, CALIFORNIA

LIGO
 CALIFORNIA INSTITUTE OF TECHNOLOGY
 MASSACHUSETTS INSTITUTE OF TECHNOLOGY

LASER INTERFEROMETER
 GRAVITATIONAL-WAVE OBSERVATORY
 SITE NO. 1 - HANFORD, WASHINGTON

HVAC
 MID & END STATIONS "A"
 PIPING PLAN

SCALE: AS NOTED
 SHEET NUMBER: PP150969
 CONTRACT NUMBER: 8094
 PROJECT NUMBER: 8094

WA-H-215