

NOTES:
 1. FOR LEGEND, ABBREVIATIONS AND GENERAL NOTES SEE SHEETS
 WA-H-001 AND WA-H-002.

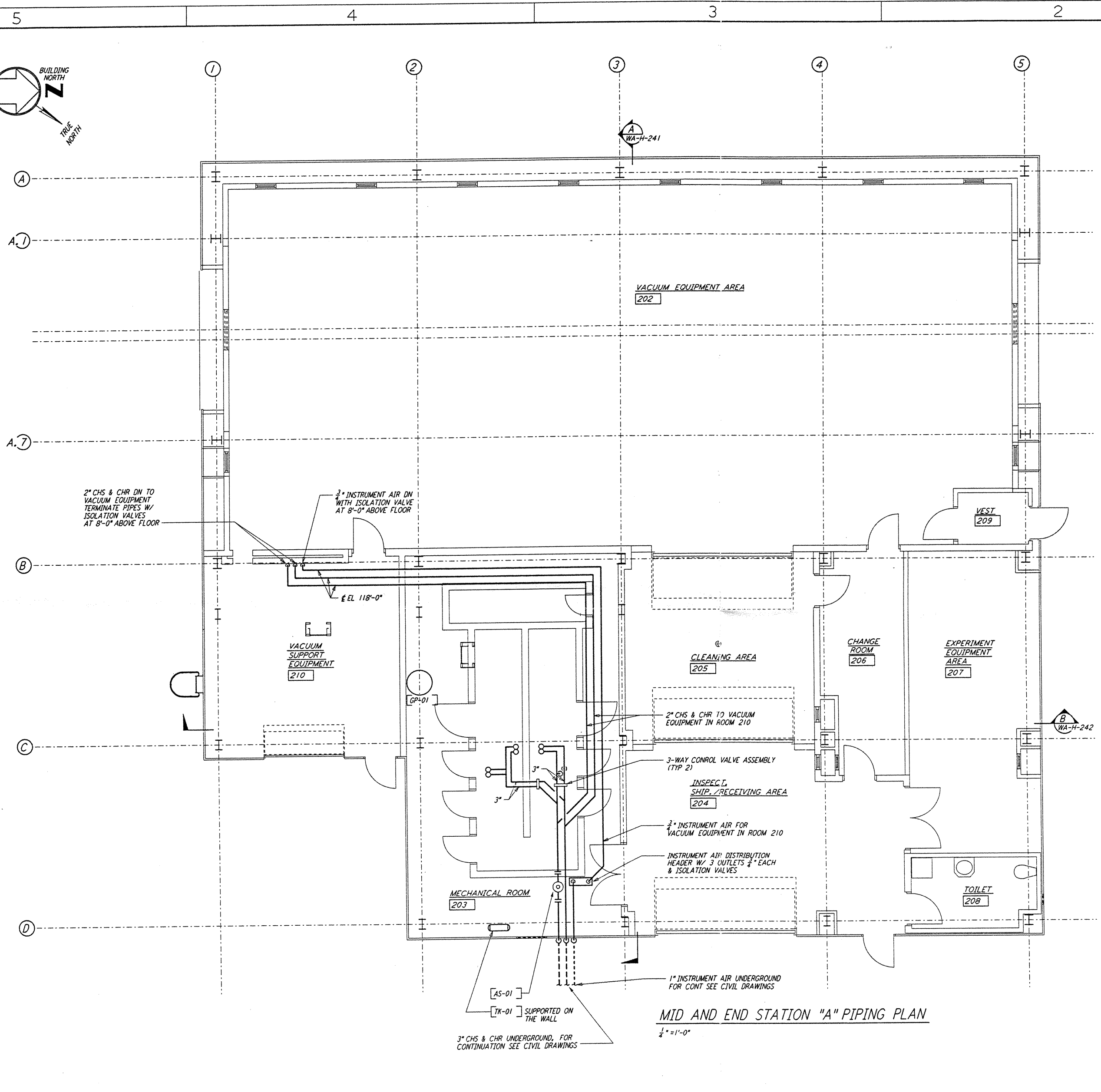

MID AND END STATION "A" PIPING PLAN
 1/4" = 1'-0"

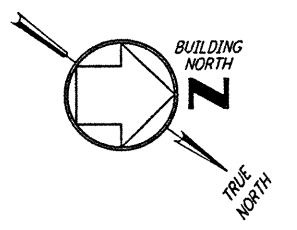
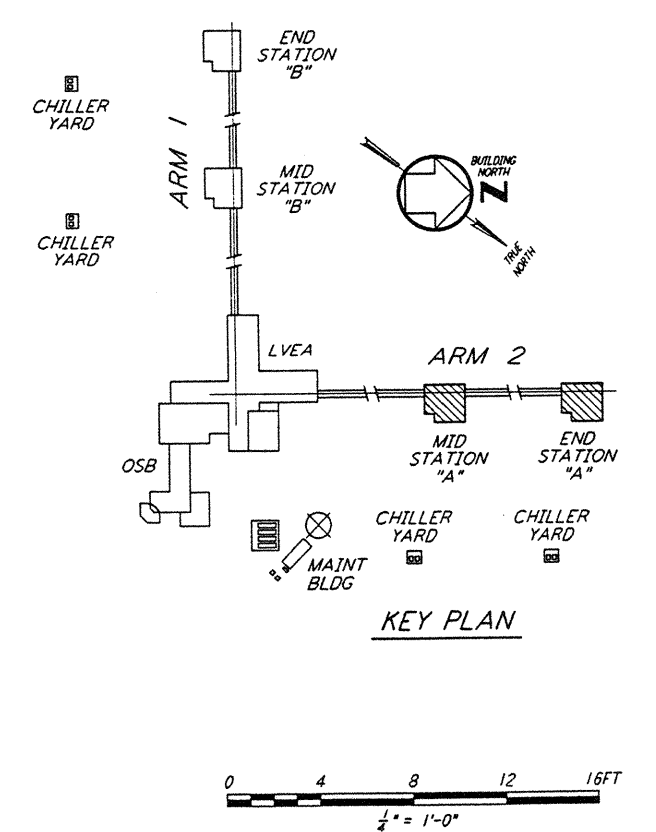

not be reproduced, copied, loaned, exhibited, or used in any other way, except by written consent from **PARSONS** to the borrower.

This document and the design it covers are the property of **PARSONS**. They are loaned only with the borrower's expressed written agreement that they will

ISSUED FOR CONSTRUCTION	
DRAWN	CLP 6-24-96
CHECKED	AA 7/3/96
ENGINEER	AA 7/3/96
PROJ	WAW 7/8/96

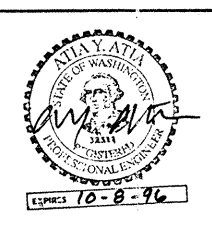

PARSONS
 100 WEST WALNUT STREET
 PASADENA, CALIFORNIA

LIGO
 CALIFORNIA INSTITUTE OF TECHNOLOGY
 MASSACHUSETTS INSTITUTE OF TECHNOLOGY

LASER INTERFEROMETER
 GRAVITATIONAL-WAVE OBSERVATORY
 SITE NO. 1 - HANFORD, WASHINGTON

TITLE: HVAC
 MID & END STATIONS "A"
 PIPING PLAN

SCALE: AS NOTED
 SHEET NUMBER: PP150969
 PROJECT NUMBER: 8094

REVISIONS: **WA-H-215**

DRAWING NO.	DESCRIPTION	NO.	DATE	BY	CHKD	ENGR	PROJ	DESCRIPTION
5								
4								
3								
2								