

not be reproduced, copied, loaned, exhibited, or used in any other way, except by written consent from PARSONS to the borrower.

This document and the design it covers are the property of PARSONS. They are loaned only with the borrower's expressed written agreement that they will

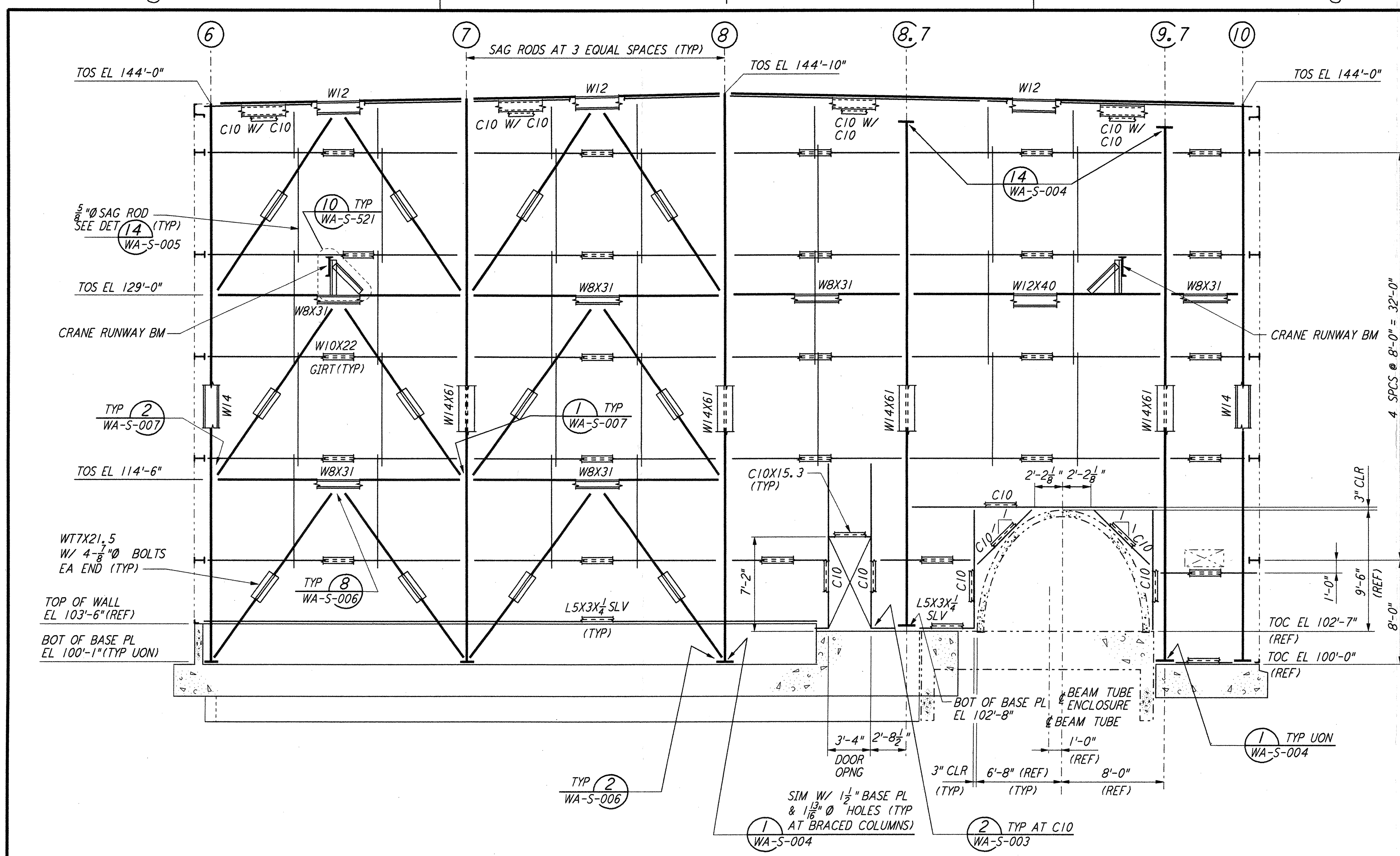

ELEVATION AT COLUMN LINE A

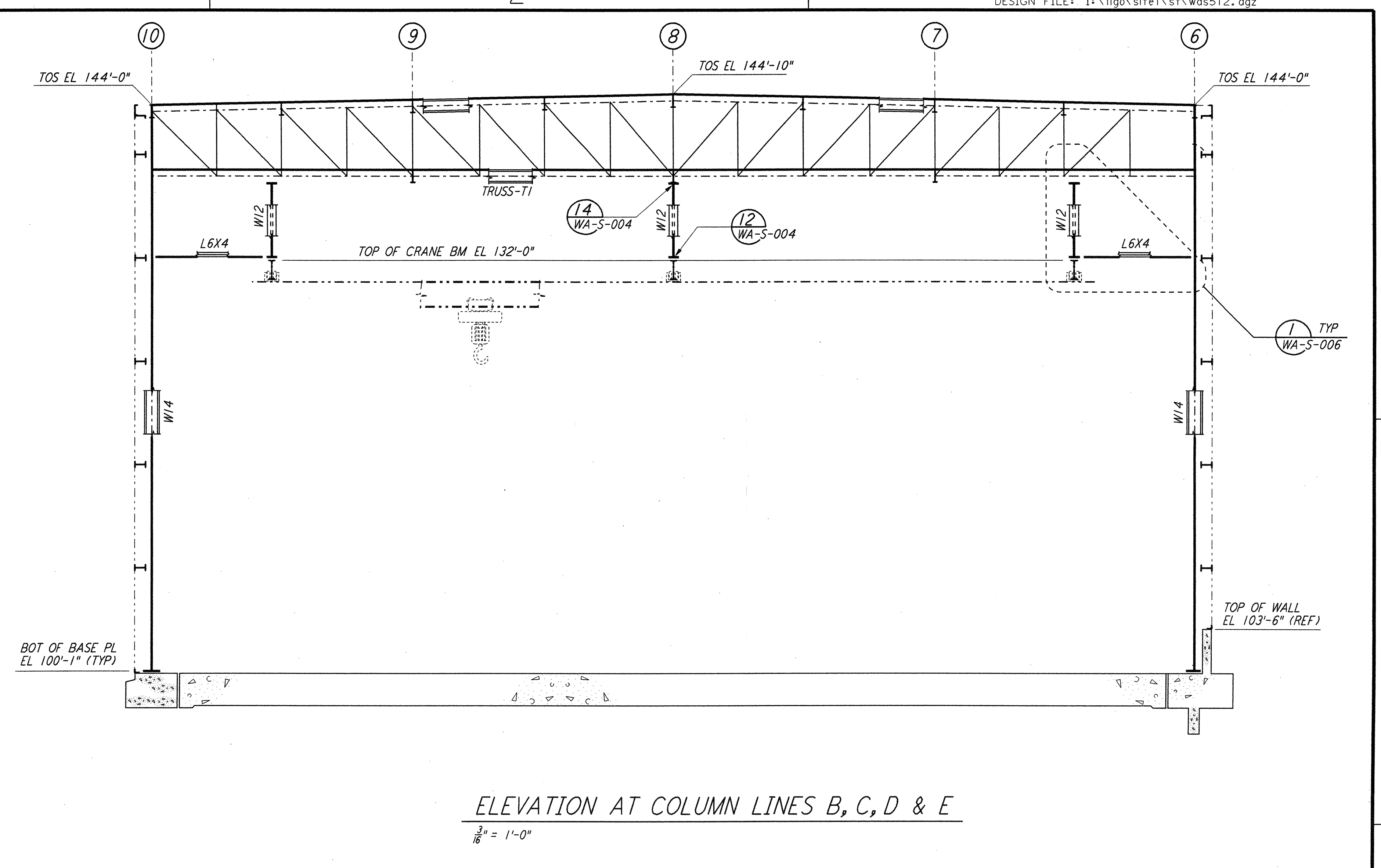

ELEVATION AT COLUMN LINES B, C, D & E

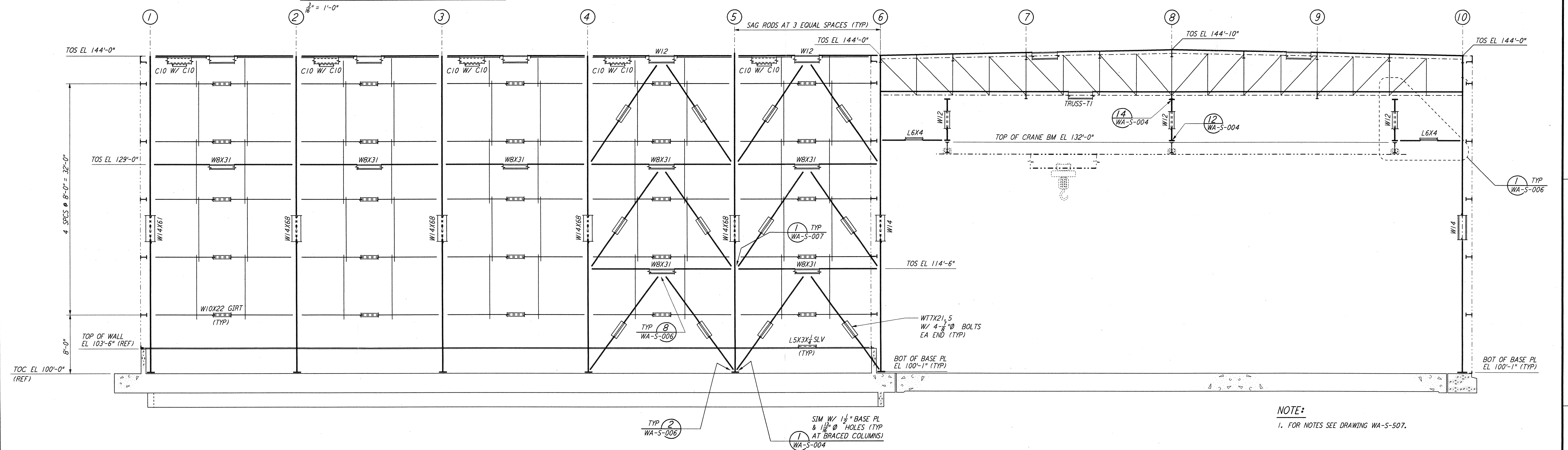

ELEVATION AT COLUMN LINE F

NOTE:  
 1. FOR NOTES SEE DRAWING WA-S-507.

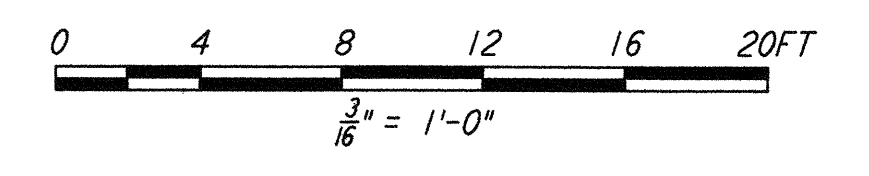

NO.	DATE	BY	CHKD	ENGR	PRJG	DESCRIPTION
1	6-15-98	CKT	BP	MDW		ISSUED FOR AS-BUILT

ISSUED FOR CONSTRUCTION  
 DRAWN MCS 6-24-96  
 CHECKED DDM 7-2-96  
 ENGINEER BP 6-28-96  
 PROJ MDW 7-9-96

**AS-BUILT DRAWINGS**

**PARSONS**  
 100 WEST WALNUT STREET  
 PASADENA, CALIFORNIA

**LIGO**  
 CALIFORNIA INSTITUTE OF TECHNOLOGY  
 MASSACHUSETTS INSTITUTE OF TECHNOLOGY

**LIGO-D960333-01-0**

LASER INTERFEROMETER  
 GRAVITATIONAL-WAVE OBSERVATORY  
 SITE NO. 1 - HANFORD, WASHINGTON

TITLE	SCALE	CONTRACT NUMBER	PROJECT NUMBER
STRUCTURAL CORNER STATION LVEA FRAMING ELEVATIONS SHEET 6	AS NOTED	PP150969	8094
SHEET NUMBER	REVISIONS	<b>WA-S-512</b>	