

not be reproduced, copied, loaned, exhibited, or used in any other way, except by written consent from PARSONS to the borrower.

This document and the design it covers are the property of PARSONS. They are loaned only with the borrower's expressed written agreement that they will

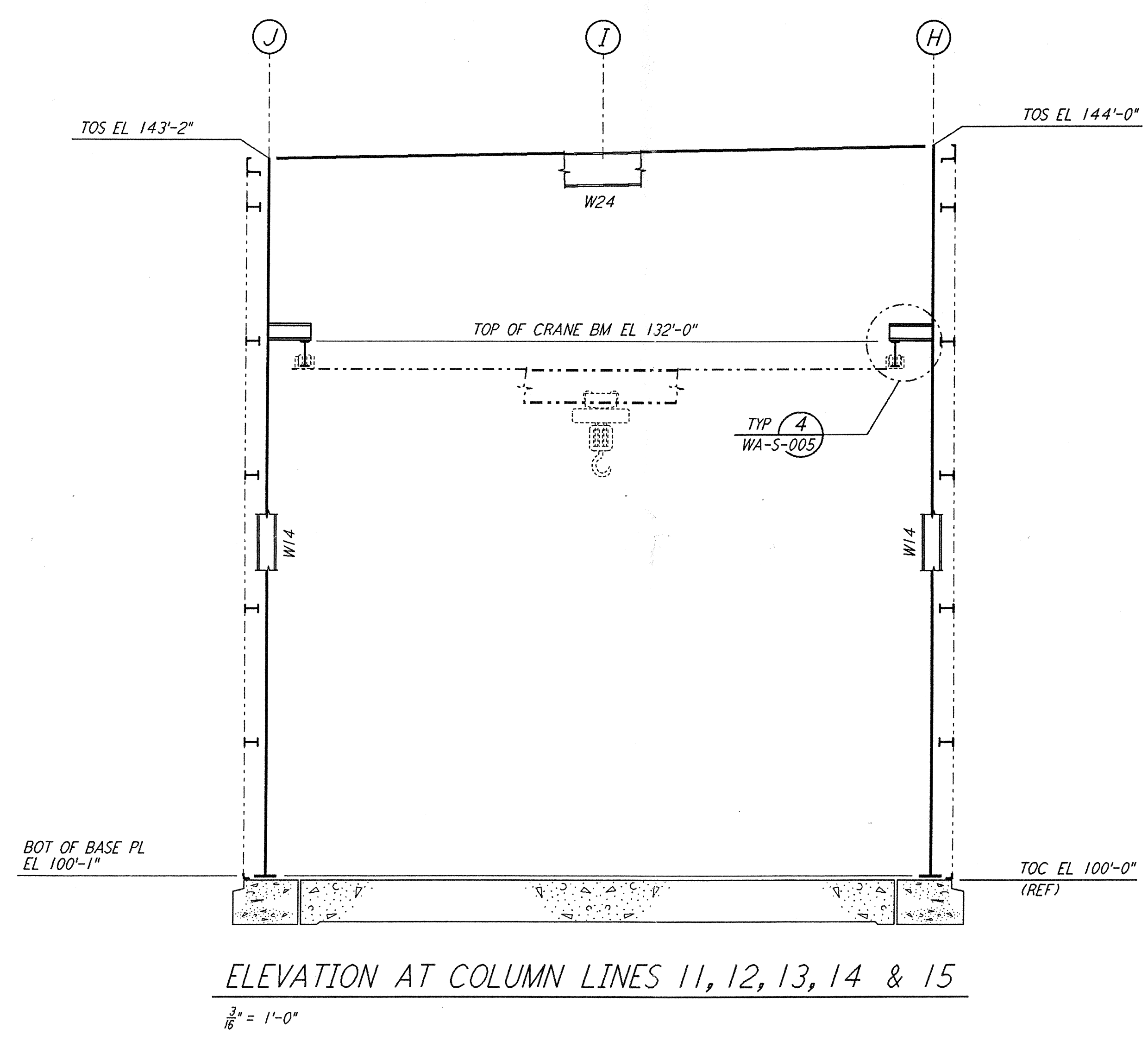

ELEVATION AT COLUMN LINES 11, 12, 13, 14 & 15  
 $\frac{3}{16}'' = 1'-0''$

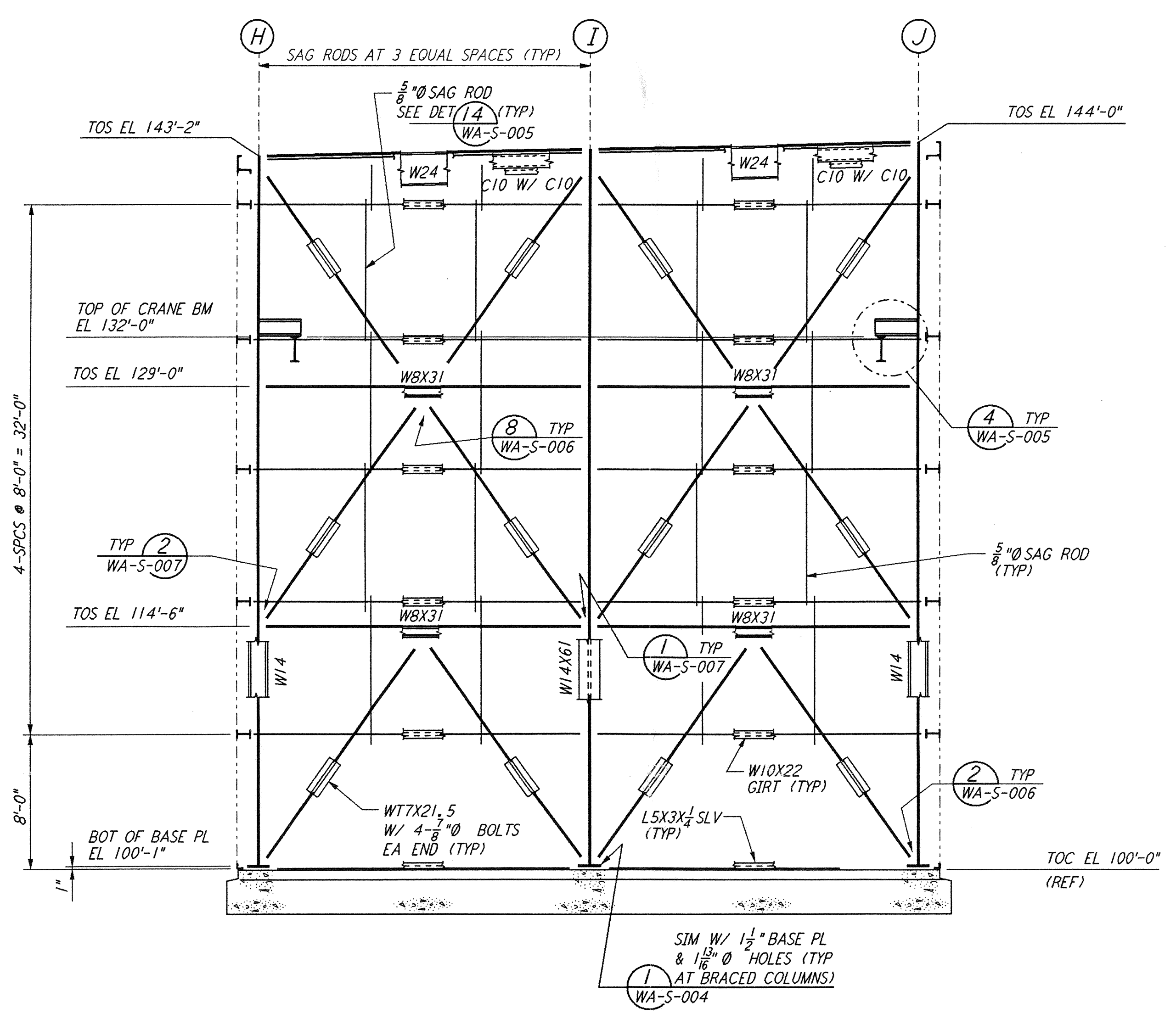

ELEVATION AT COLUMN LINE 16  
 $\frac{3}{16}'' = 1'-0''$

**NOTE:**  
 1. FOR NOTES SEE DRAWING WA-S-507.

|          |         |         |         |
|----------|---------|---------|---------|
| Drawn    | 4/19/96 | 4/19/96 | 4/19/96 |
| Checked  |         |         |         |
| Engineer |         |         |         |
| Proj     |         |         |         |

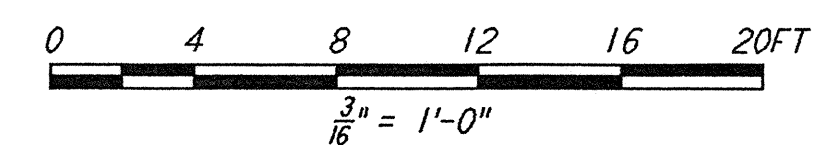

| NO. | DATE    | BY  | CHKD | ENGR | PROJ | DESCRIPTION               |
|-----|---------|-----|------|------|------|---------------------------|
| A   | 4-19-96 | MCS |      |      |      | FINAL DESIGN REVIEW & BID |

|          |     |
|----------|-----|
| DRAWN    | MCS |
| CHECKED  |     |
| ENGINEER |     |
| PROJ     |     |



100 WEST WALNUT STREET  
 PASADENA, CALIFORNIA



CALIFORNIA INSTITUTE OF TECHNOLOGY  
 MASSACHUSETTS INSTITUTE OF TECHNOLOGY

|  |          |                |
|--|----------|----------------|
| LASER INTERFEROMETER<br>GRAVITATIONAL-WAVE OBSERVATORY<br>SITE NO. 1 - HANFORD, WASHINGTON |          |                |
| TITLE  | AS NOTED | PROJECT NUMBER |
| STRUCTURAL<br>CORNER STATION<br>LVEA FRAMING ELEVATIONS<br>SHEET 5                         | PP150969 | 8094           |
| SHEET NUMBER   |          | REVISIONS      |
| WA-S-511   |          | △              |