

not be reproduced, copied, loaned, exhibited, or used in any other way, except by written consent from PARSONS to the borrower.

This document and the design it covers are the property of PARSONS. They are loaned only with the borrower's expressed written agreement that they will not be reproduced, copied, loaned, exhibited, or used in any other way, except by written consent from PARSONS to the borrower.

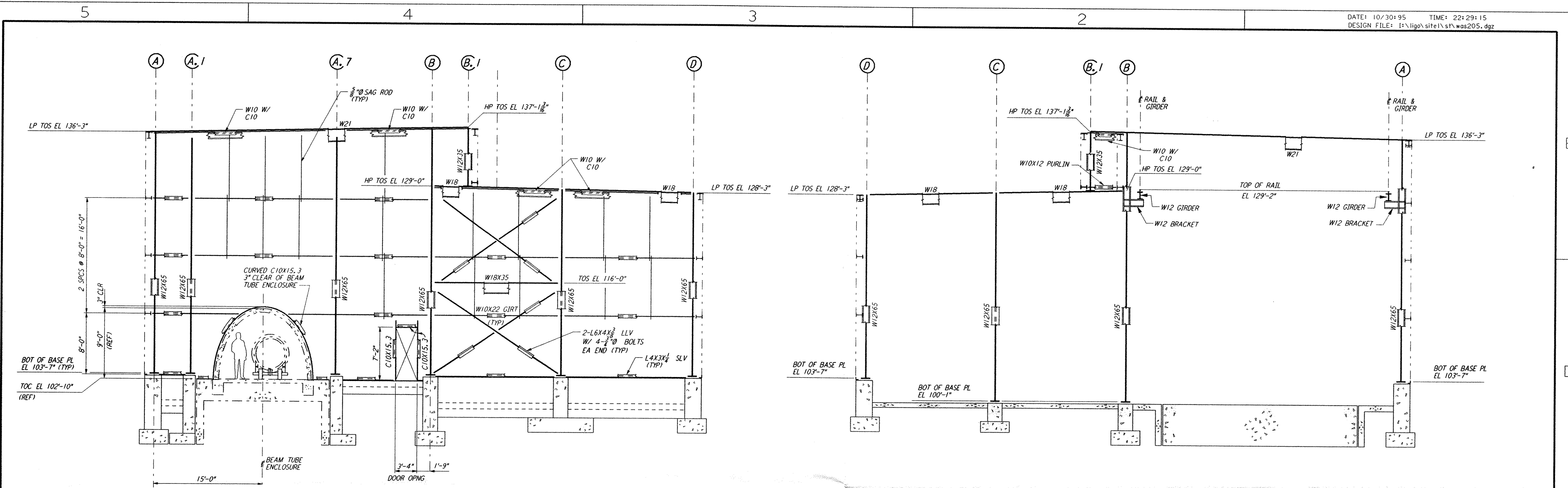

ELEVATION AT COLUMN LINE 1

ELEVATION AT COLUMN LINE 2

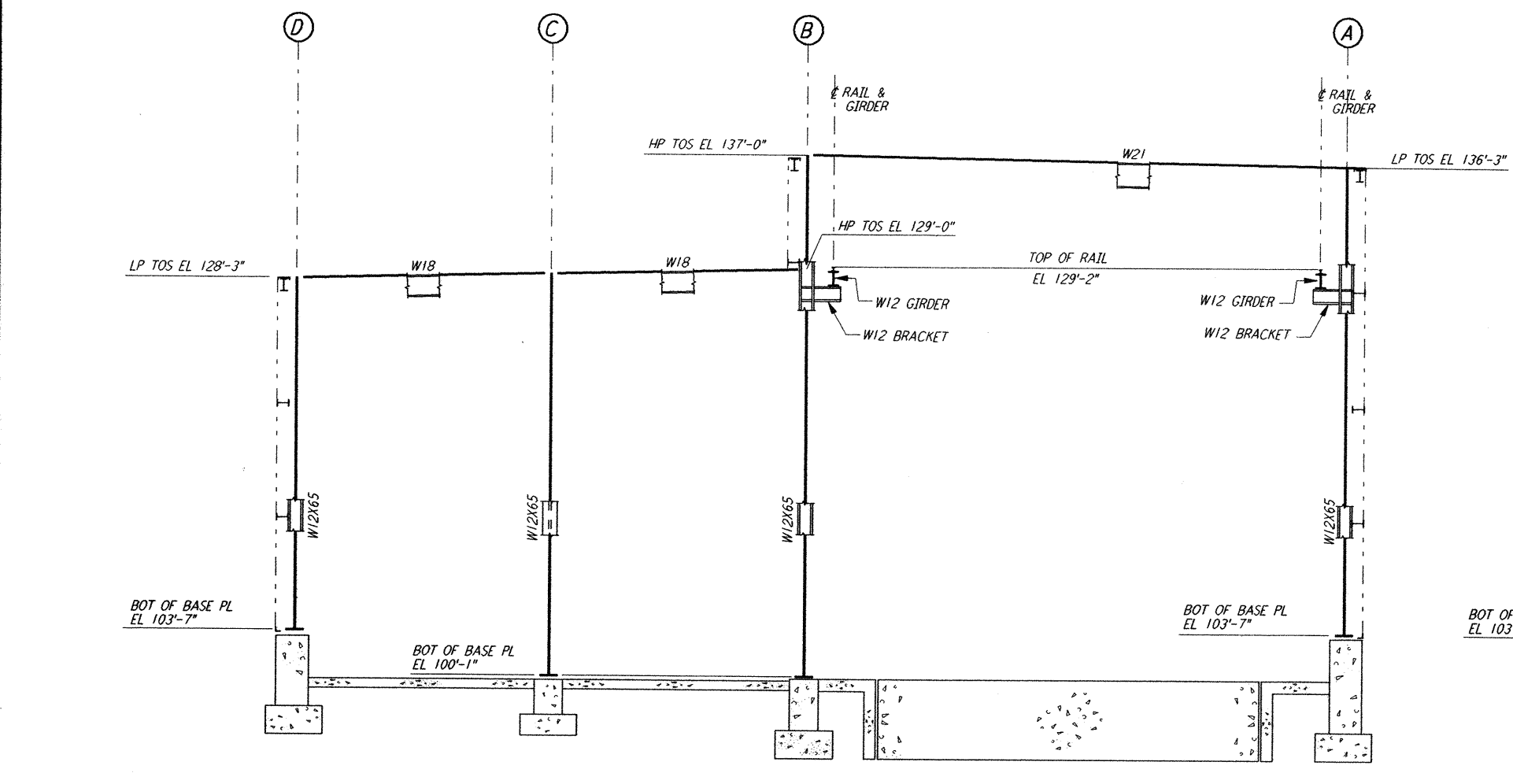

ELEVATION AT COLUMN LINE 3

ELEVATION AT COLUMN LINE 4

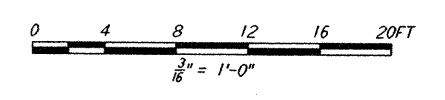

NO.	DATE	APPRO BY	DESCRIPTION OF REVISION
9			
8			
7			
6			
5			
4			
3			
2			
1			

ISSUE	NO.	DATE	APPRO BY	DESCRIPTION OF REVISION
J				
H				
G				
F				
E				
D				
C				
B				
A	10-31-95	TDM		PRELIMINARY DESIGN REVIEW

DATE	10-31-95
DRAWN	MCS
CHECKED	
ENGINEER	
PROJ MGR	

**PARSONS**  
 100 WEST WALNUT STREET  
 PASADENA, CALIFORNIA

**LIGO**  
 CALIFORNIA INSTITUTE OF TECHNOLOGY  
 MASSACHUSETTS INSTITUTE OF TECHNOLOGY

LASER INTERFEROMETER  
 GRAVITATIONAL-WAVE OBSERVATORY  
 SITE NO. 1 - HANFORD, WASHINGTON

MID STATION  
 FRAMING ELEVATIONS  
 SHEET 1

AS NOTED PPI 50969 8094  
**WA-S-205**

Mon Oct 30 22:28:07 1995 S3-V18B2 J:\PLOTS\QUEUES\V18B2\ST205.PRF