

This document and the design it covers are the property of PARSONS. They are loaned only with the borrower's expressed written agreement that they will not be reproduced, copied, loaned, exhibited, or used in any other way, except by written consent from PARSONS to the borrower.

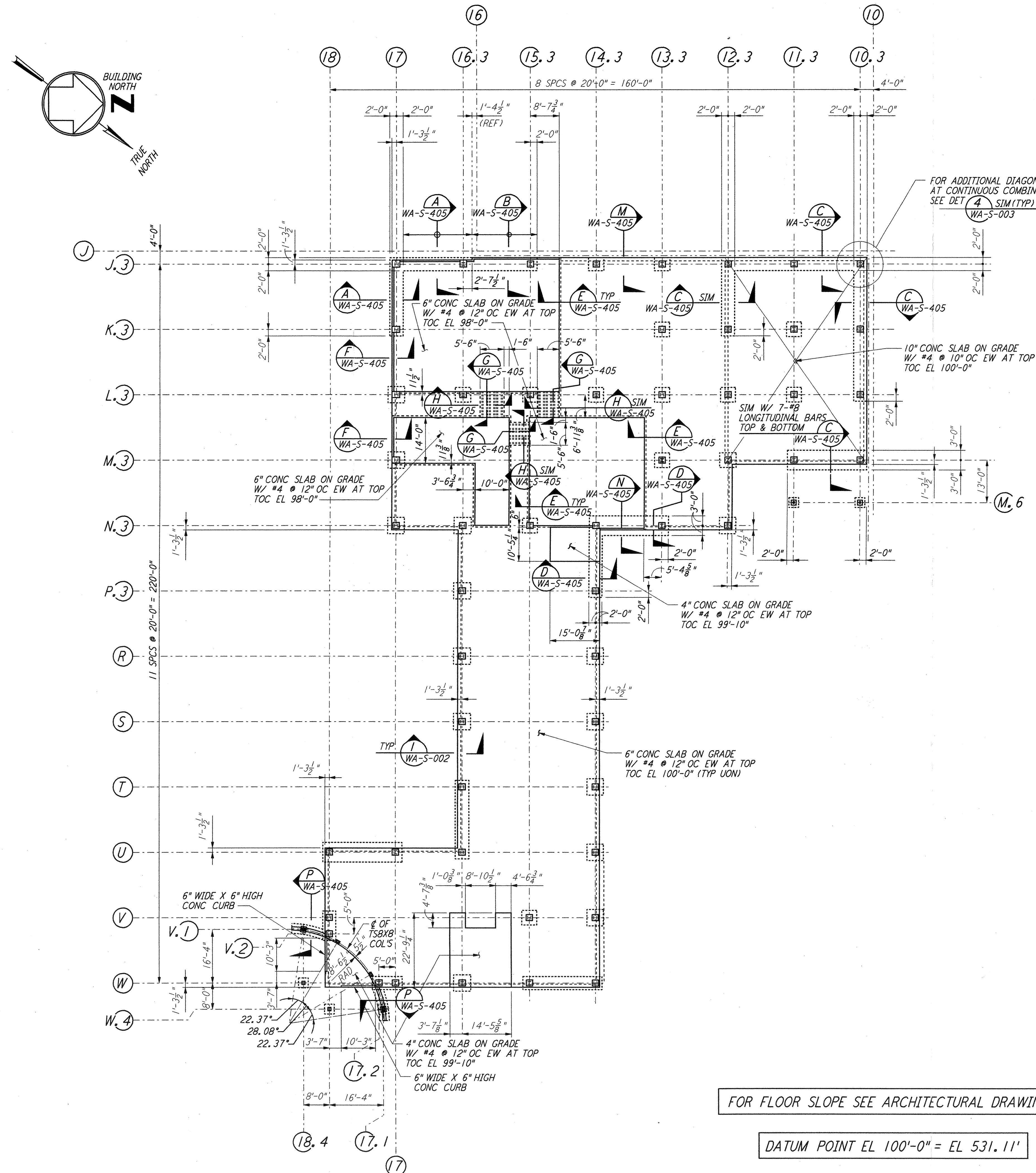

- NOTES:**
- FOR GENERAL NOTES, ABBREVIATIONS AND SYMBOLS, SEE DRAWING WA-S-001.
 - FOR SLAB ON GRADE DETAILS SEE DRAWING WA-S-002.
 - FOR BASE ANGLE AT EDGE OF SLAB OR TOP OF 6" CONCRETE WALL, SEE FRAMING ELEVATIONS AND SECTION (A) WA-S-003

FOR FLOOR SLOPE SEE ARCHITECTURAL DRAWINGS

DATUM POINT EL 100'-0" = EL 531.11'

FOUNDATION PLAN
 1/8" = 1'-0"

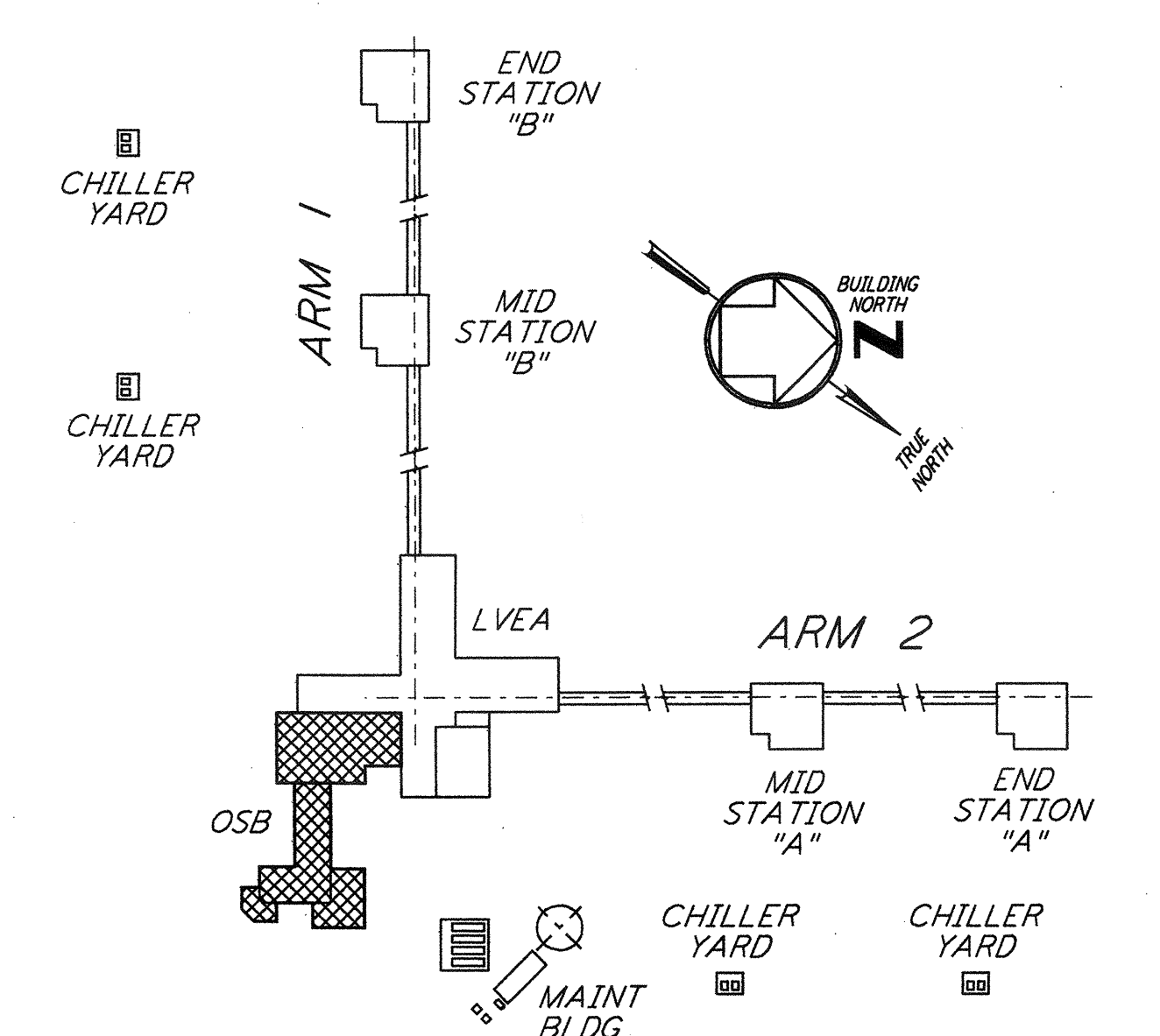

KEY PLAN
 LIGO-D960296-01-0

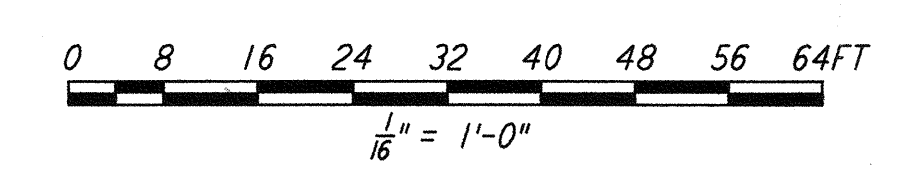

NO.	DATE	BY	CHKD	ENGR	PROJ	DESCRIPTION
1	6-15-98	CRT				ISSUED FOR AS-BUILT

ISSUED FOR CONSTRUCTION
 DRAWN MCS 6-24-96
 CHECKED DDM 7-2-96
 ENGINEER BP 6-26-96
 PROJ MDW 7-9-96

AS-BUILT DRAWINGS

100 WEST WALNUT STREET
 PASADENA, CALIFORNIA

CALIFORNIA INSTITUTE OF TECHNOLOGY
 MASSACHUSETTS INSTITUTE OF TECHNOLOGY

LASER INTERFEROMETER
 GRAVITATIONAL-WAVE OBSERVATORY
 SITE NO. 1 - HANFORD, WASHINGTON

STRUCTURAL CORNER STATION
 OSB FOUNDATION PLAN

AS NOTED PPI50969 8094
WA-S-102