

not be reproduced, copied, loaned, exhibited, or used in any other way, except by written consent from PARSONS to the borrower.

This document and the design it covers are the property of PARSONS. They are loaned only with the borrower's expressed written agreement that they will

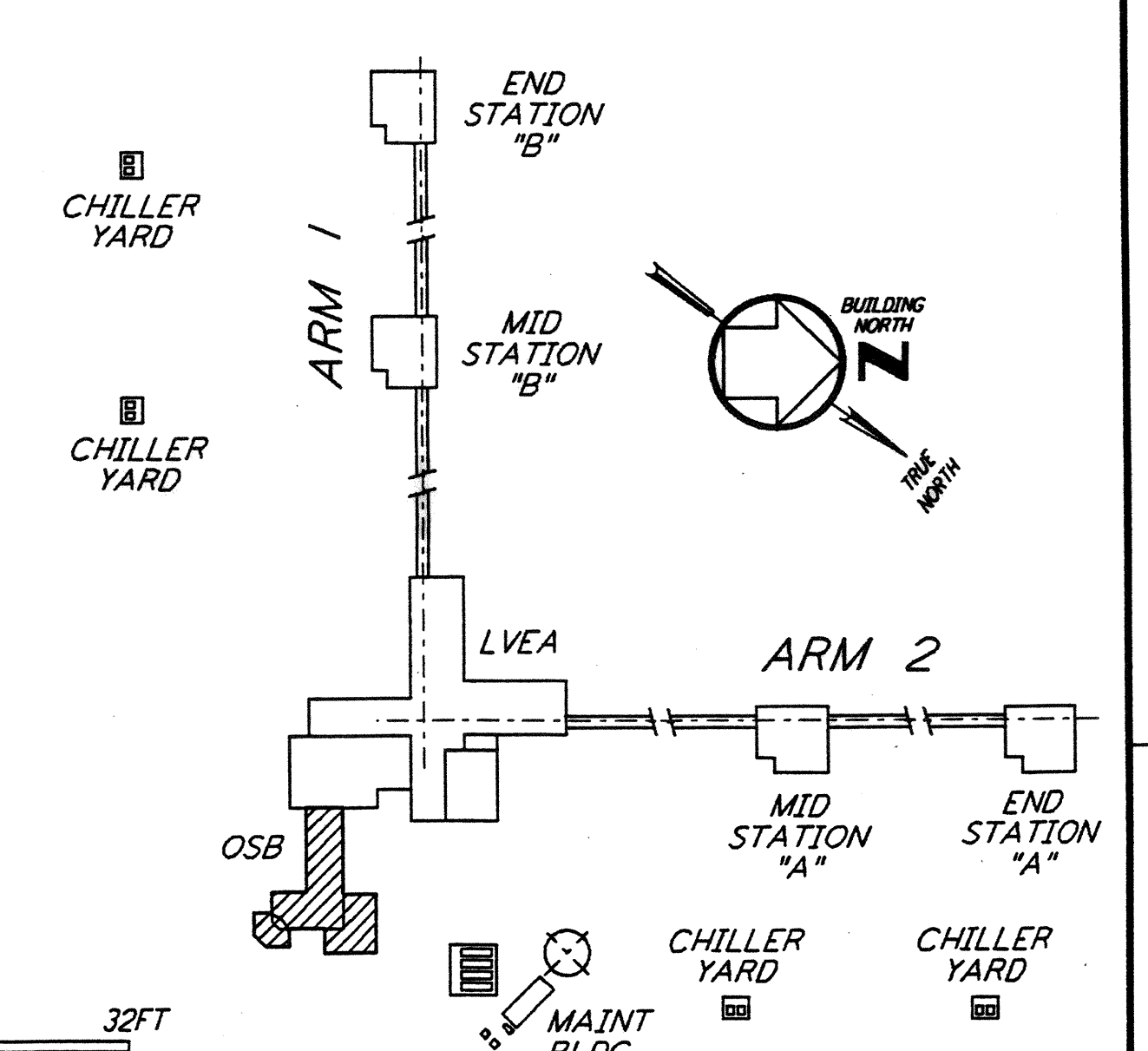
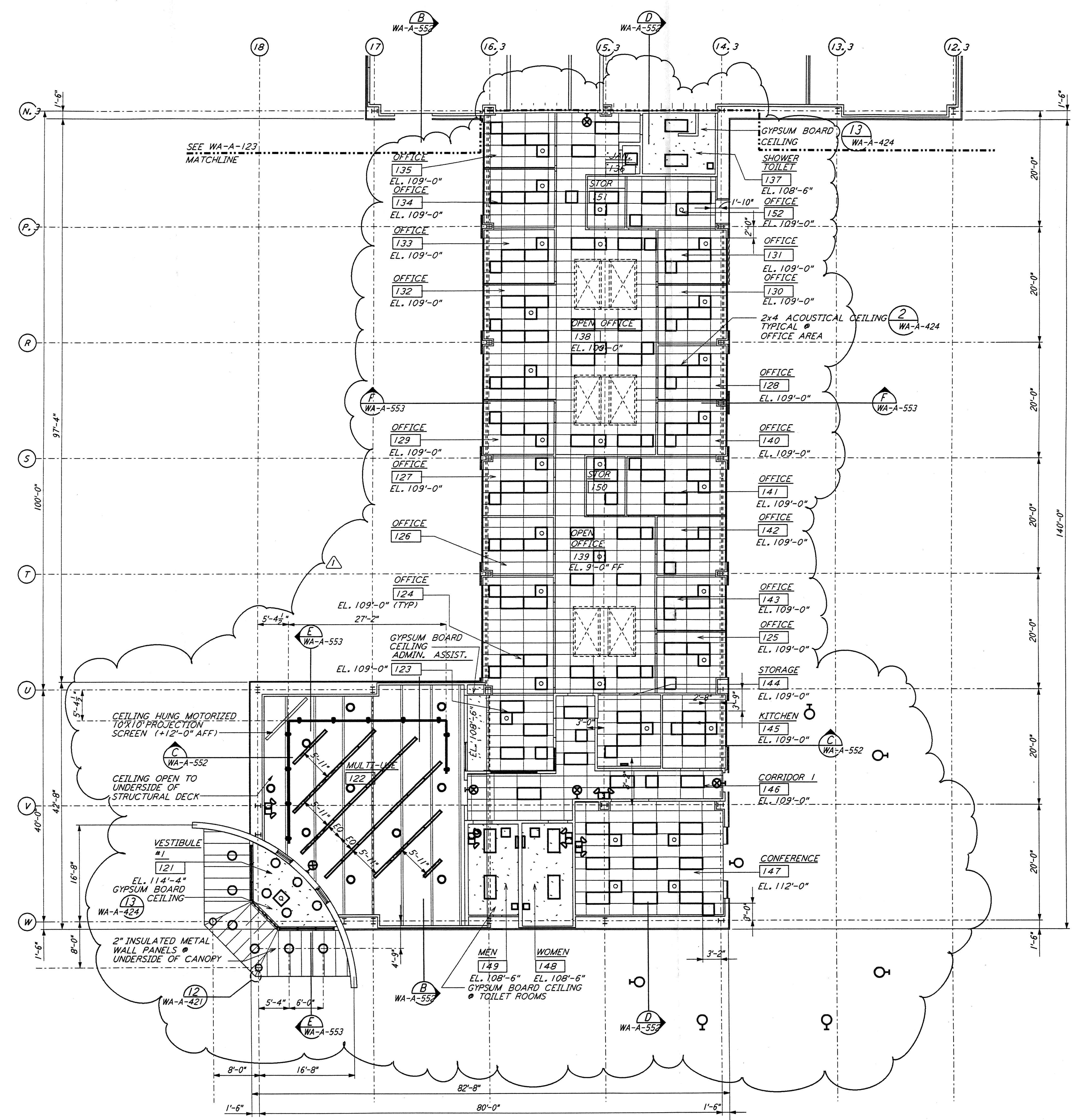
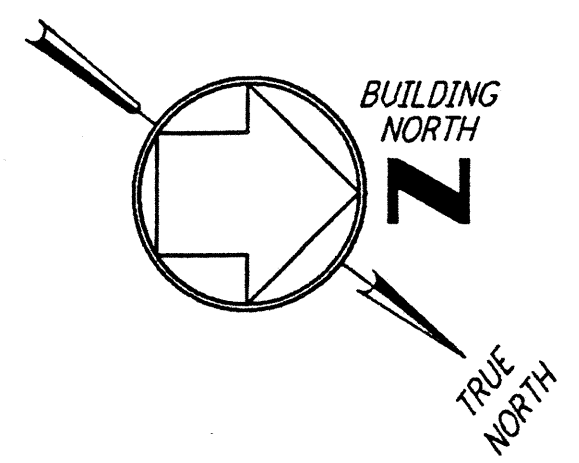

LIGO-D960252-01-0

0 8 16 24 32 FT
 1/8" = 1'-0"
 DATUM POINT EL +100.00 = 531.11' (LVEA)
 DATUM POINT EL +100.00 = 531.11' (OSB)

KEY PLAN

NO.	DATE	BY	CHKD	ENGR	PROJ	OSB REVISION	DESCRIPTION
1	2-28-97	CKT	TB	AK	TDM		

NO.	DATE	BY	CHKD	ENGR	PROJ	OSB REVISION	DESCRIPTION

ISSUED FOR CONSTRUCTION	CKT	5-12-96
CHECKED	TB	5-26-96
ENGINEER	bkk	7-12-96
PROJ	MDW	7-12-96

6629 REGISTERED ARCHITECT
 ALEXANDER BRILL
 STATE OF MASSACHUSETTS
 3/21/97



100 WEST WALNUT STREET
 PASADENA, CALIFORNIA



CALIFORNIA INSTITUTE OF TECHNOLOGY
 MASSACHUSETTS INSTITUTE OF TECHNOLOGY

LASER INTERFEROMETER
 GRAVITATIONAL-WAVE OBSERVATORY
 SITE NO. 1 - HANFORD, WASHINGTON

TITLE	SCALE	CONTRACT NUMBER	PROJECT NUMBER
ARCHITECTURAL CORNER STATION OSB PARTIAL REFLECTED CEILING PLAN SHEET 1	AS NOTED	PP150969	8094
SHEET NUMBER		PROJECT NUMBER	
WA-A-122		8094	