

GENERAL NOTES

PROJECT SITE PLANS

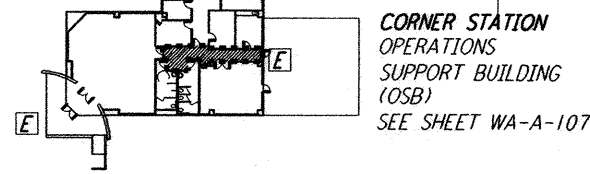
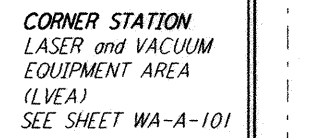
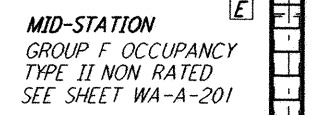
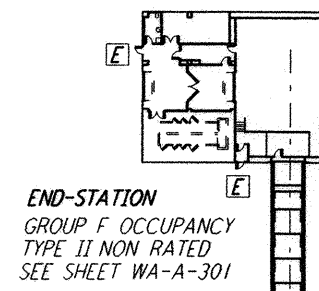

BUILDING CODE INFORMATION :

LVEA
 GROUP F OCCUPANCY (SECTION 306.1)
 ALLOWABLE AREA TYPE II NON-RATED 18,000 SF. (TABLE 5-B)
 ALLOWABLE AREA INCREASES SEPARATION ON THREE SIDES (SECTION 505.1.2)
 100% INCREASE = 36,000 SF.
 ACTUAL AREA OF LVEA AND MECH RM. 34,340 SF.

OBS
 GROUP B OCCUPANCY (SECTION 304.1)
 ALLOWABLE AREA TYPE II NON-RATED 12,000 SF. (TABLE 5-B)
 ALLOWABLE AREA INCREASES SEPARATION ON THREE SIDES (SECTION 505.1.2)
 100% INCREASE = 24,000 SF.
 ACTUAL AREA OF LVEA AND MECH RM. 18,620 SF.

LEGEND / SCHEDULE

- ONE HOUR RATED WALL
- TWO HOUR FIRE WALL
- TWO HOUR OCCUPANCY SEPARATION WALL
- Ⓛ EXIT LOCATION
- ▨ ONE HOUR RATED CORRIDOR CEILING
- TWO HOUR FIRE RATED ROOM

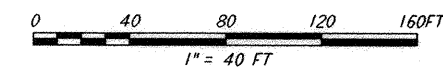
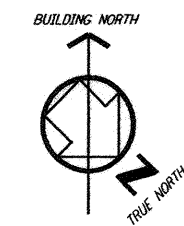
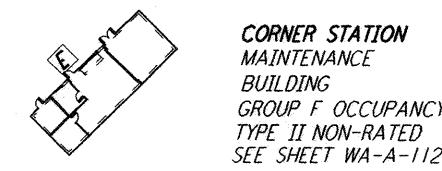
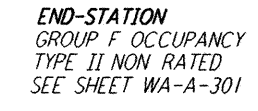
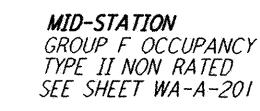

This document and the design it covers are the property of PARSONS. They are loaned only with the borrower's expressed written agreement that they will not be reproduced, copied, loaned, exhibited, or used in any other way, except by written consent from PARSONS to the borrower.

This document and the design it covers are the property of PARSONS. They are loaned only with the borrower's expressed written agreement that they will not be reproduced, copied, loaned, exhibited, or used in any other way, except by written consent from PARSONS to the borrower.

NO.	DATE	APPR BY	DESCRIPTION OF REVISION
9			
8			
7			
6			
5			
4			
3			
2			
1			

DATE	10-31-95
DRAWN	CKT
CHECKED	
ENGINEER	
PROJ MGR	



100 WEST WALNUT STREET
 PASADENA, CALIFORNIA



CALIFORNIA INSTITUTE OF TECHNOLOGY
 MASSACHUSETTS INSTITUTE OF TECHNOLOGY

LASER INTERFEROMETER
 GRAVITATIONAL-WAVE OBSERVATORY
 SITE NO. 1 - HANFORD, WASHINGTON

TITLE	SCALE	CONTRACT NUMBER	PROJECT NUMBER
ARCHITECTURE GENERAL NOTES & LIFE SAFETY PLAN	AS NOTED	PP150969	8094
SHEET NUMBER	REVISIONS		
WA-A-002			

LIGO-D960246-A-0 | LIGOWAF.BDR

Mon Oct 30 22:45:08 1995 s3-v18b2 J:\PLOTS\QUEUES\18B2\AR002E.PRF