

This document and the design it covers are the property of PARSONS. They are loaned only with the borrower's expressed written agreement that they will not be reproduced, copied, loaned, exhibited, or used in any other way, except by written consent from PARSONS to the borrower.

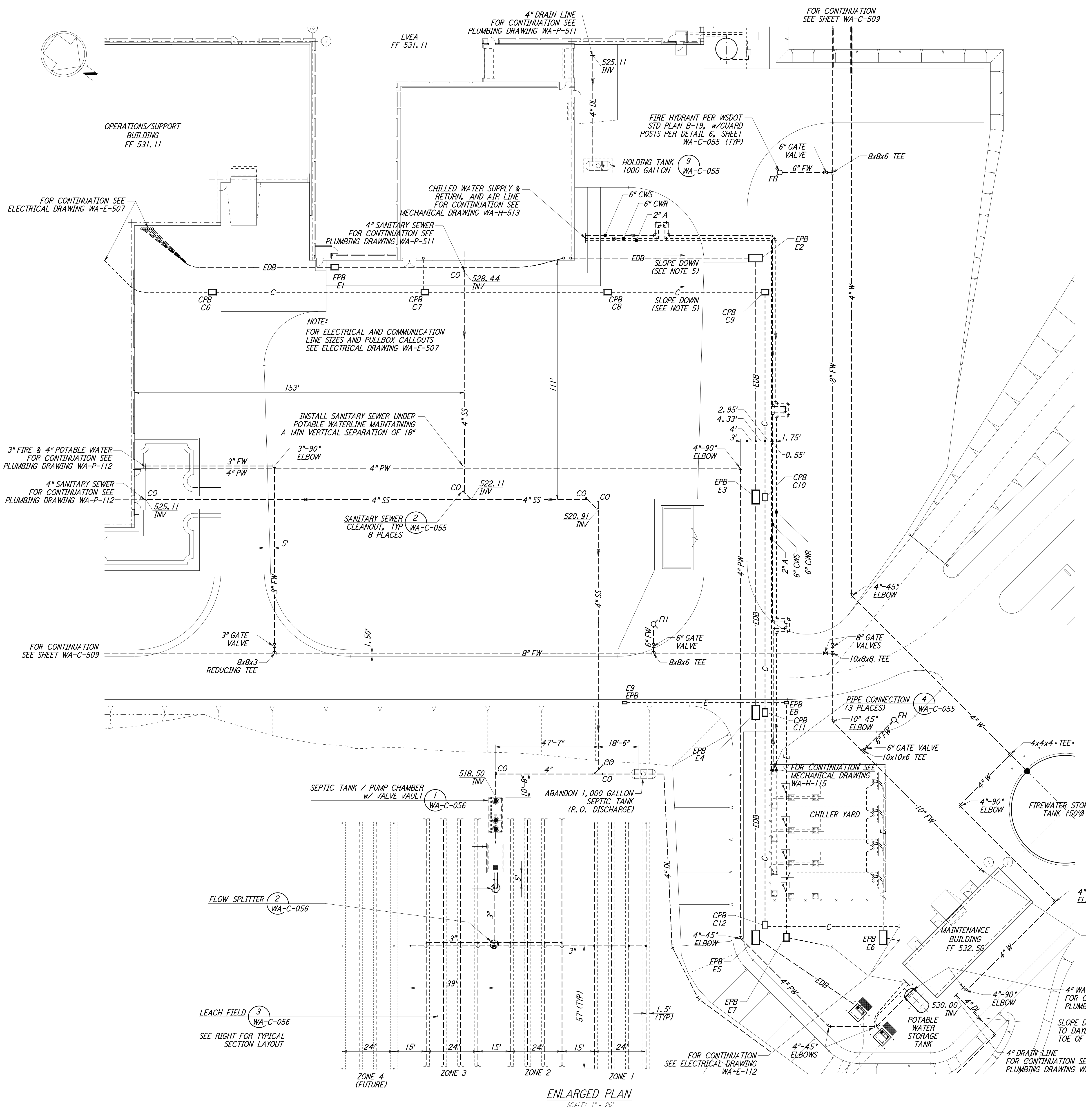

COMMUNICATION PULL BOX LOCATIONS

CPB	COORDINATES	
	NORTH	EAST
C6	411019.6212	1915854.6469
C7	411098.5674	1915795.6032
C8	411166.5147	1915744.7855
C9	411224.9736	1915701.0642
C10	411281.8712	1915777.1408
C11	411341.7635	1915857.2215
C12	411400.8034	1915936.1624

NOTE: COORDINATES ARE TO THE CENTER OF PULL BOX.

ELECTRICAL PULL BOX LOCATIONS

EPB	COORDINATES	
	NORTH	EAST
E1	411058.1263	1915811.3507
E2	411211.9940	1915690.9454
E3	411278.4011	1915779.7361
E4	411338.2937	1915859.8166
E5	411400.7777	1915943.3619
E6	411448.1159	1915907.9574
E7	411412.1916	1915934.8255
E8	411346.9645	1915847.6118
E9	411286.9041	1915892.5312

NOTE: COORDINATES ARE TO THE CENTER OF PULL BOX.

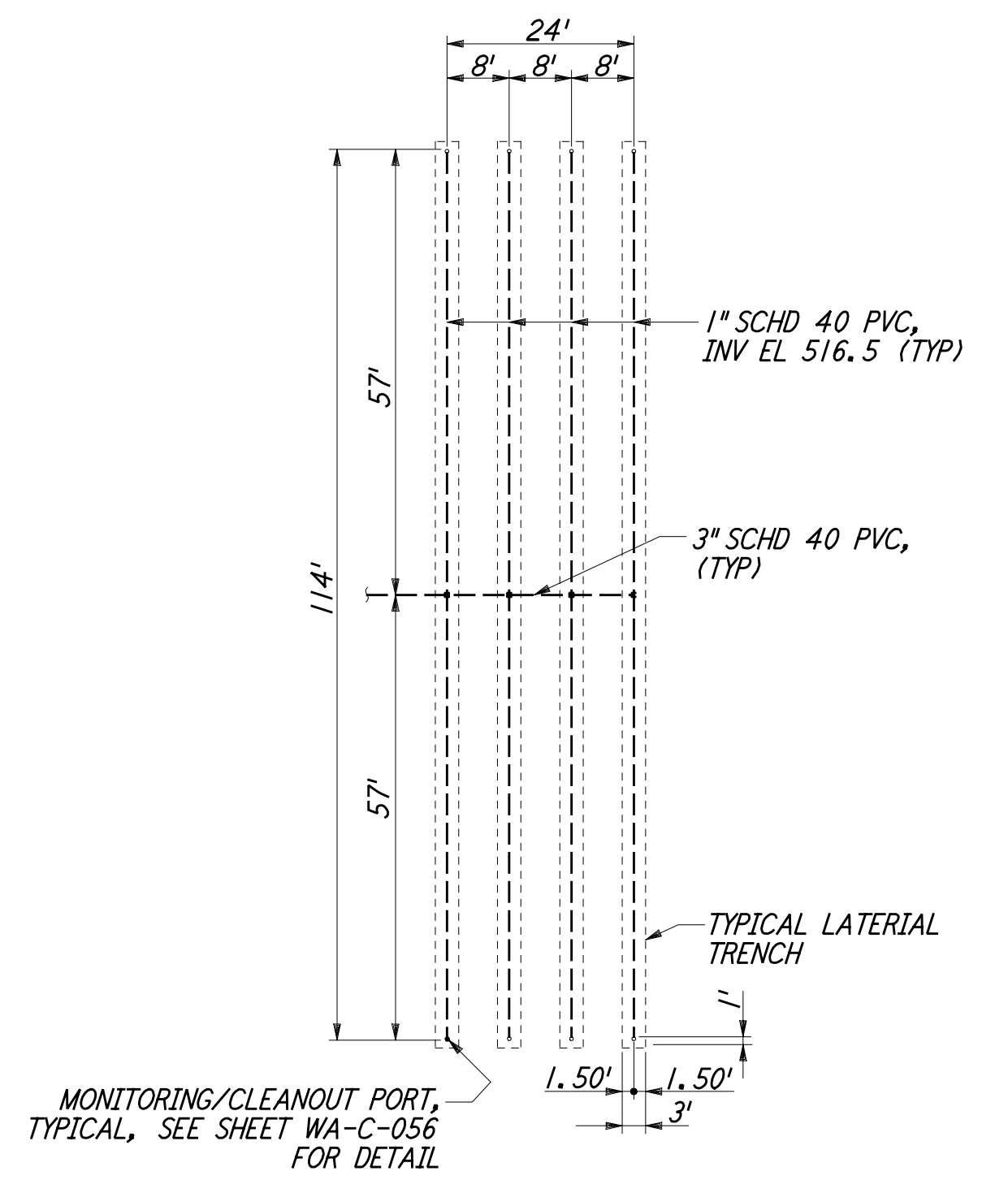

- NOTES:**
- SEE SHEET WA-C-002 FOR GENERAL NOTES, LEGEND AND ABBREVIATIONS.
 - ALL DIMENSIONS SHOWN FOR COMMUNICATION AND ELECTRICAL PULLBOXES ARE INTERNAL DIMENSIONS, UNLESS NOTED OTHERWISE.
 - COMMUNICATIONS CONDUIT SHALL STUB-UP INSIDE THE ACCESS FLOOR CAVITY TO AN ELEVATION THAT WILL PREVENT FLOODING OF CAVITY IF OUTDOOR UNDERGROUND CONDUIT RUNS ARE FILLED WITH WATER.
 - POLYETHYLENE PULL ROPES SHALL BE PROVIDED BETWEEN PULLBOXES AND STUB-UPS FOR EACH CONDUIT.
 - DUCT BANK SHALL SLOPE DOWN AWAY FROM BUILDING AS SHOWN ON PLAN.
 - GROUNDING MAT FOR PERSONNEL PROTECTION SHALL BE PREFABRICATED 4'X 6', SIZE 6" X 6" APART, WIRE NO. 6 AWG, 40X CONDUCTIVITY COPPERWELD, WITH CENTER WIRE # 1/0 AWG, ERICO MFR. CABLE TO MESH TYPE PT, MOLD PTC-1G2C, WELD METAL #65.
 - GROUNDING MAT SHALL BE INSTALLED 12" DEEP MIN. ADJACENT TO HIGH VOLTAGE PRIMARY SIDE.
 - THRUST BLOCKS SHALL BE PROVIDED AT ALL BENDS AND TEES, FOR ALL PRESSURE LINES. SEE DETAIL 3, SHEET WA-C-055 FOR SIZES.
 - SEE DETAIL 5, SHEET WA-C-055 FOR TRENCH BEDDING REQUIREMENTS.

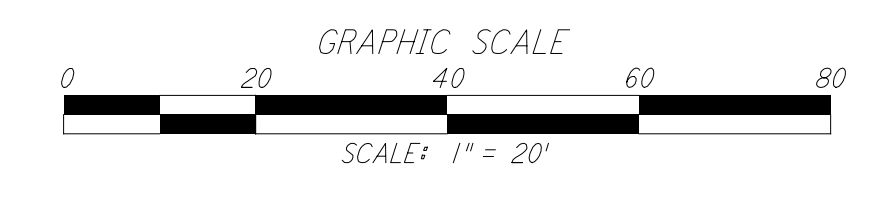

LIGO-D960244-01-0

REVISIONS	NO.	DATE	BY	CHKD	ENGR	PROJ	DESCRIPTION
1	5/15/98	WRB					ISSUED FOR AS-BUILT

FOR CONSTRUCTION

DRAWN	WRB	10/5/95
CHECKED	ML	7/9/96
ENGINEER	JB	7/9/96
PROJ	MDW	7/9/96

AS-BUILT DRAWINGS



LASER INTERFEROMETER GRAVITATIONAL-WAVE OBSERVATORY
SITE NO. I - HANFORD, WASHINGTON

CIVIL CORNER STATION UTILITY PLAN ENLARGED PLANS

SCALE: 1" = 20' SHEET NUMBER: PPI50969 REVISIONS: 8094

WA-C-510