

NOTES:
 1. SEE SHEET WA-C-002 FOR GENERAL NOTES, LEGEND AND ABBREVIATIONS.

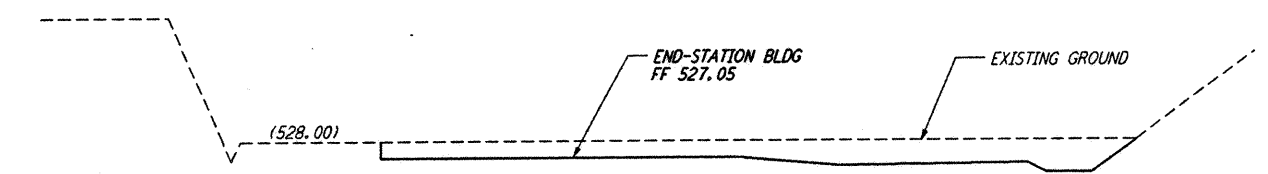

SECTION
 SCALES: HORIZ: 1" = 20'
 VERT: 1" = 10'
 REF: WA-C-054 WA-C-026

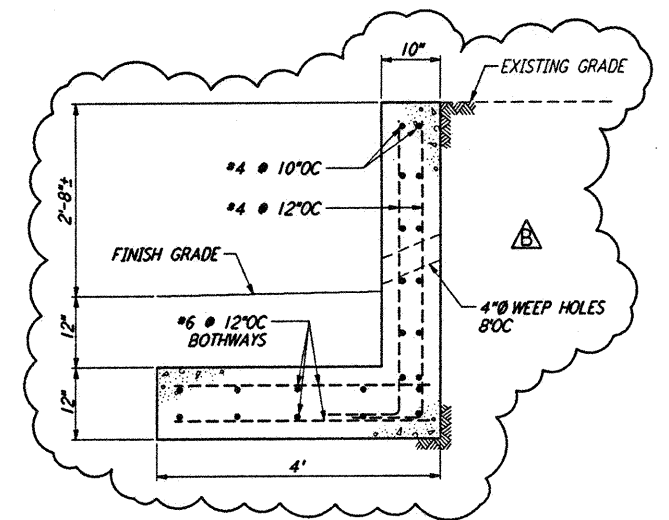

RETAINING WALL
 NOT TO SCALE
 REF: WA-C-054 WA-C-026 WA-C-046

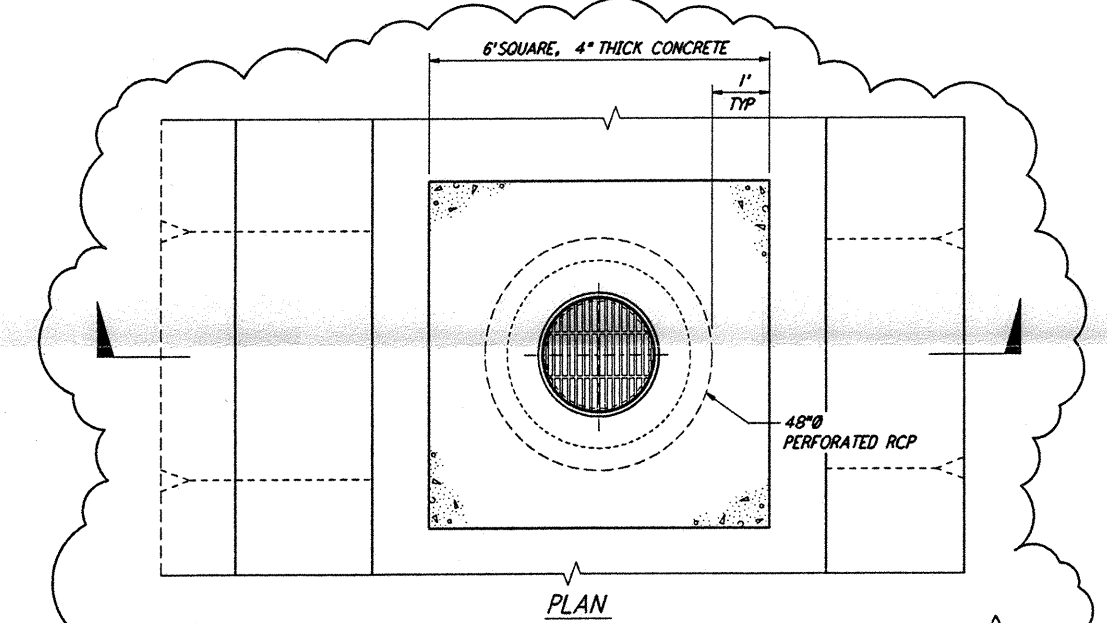

PLAN

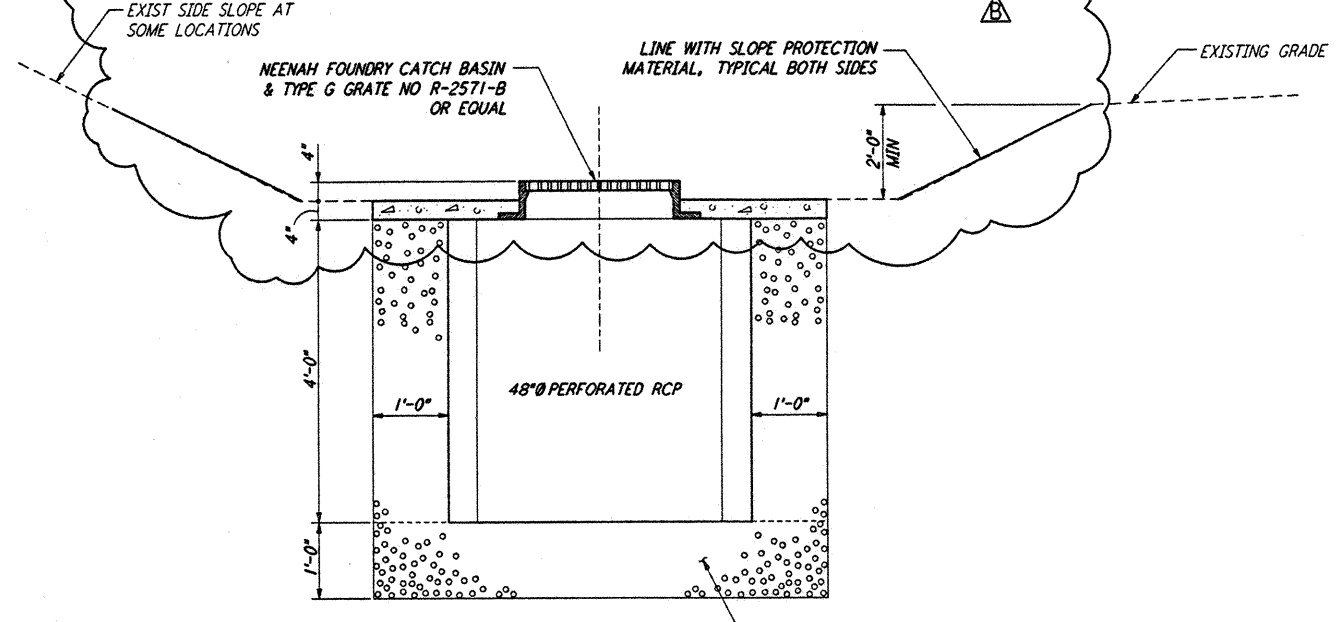

SECTION

48" PERFORATED RCP W/ GRATE
 NOT TO SCALE
 REF: WA-C-054 WA-C-022 WA-C-026 WA-C-042

not be reproduced, copied, loaned, exhibited, or used in any other way, except by written consent from PARSONS to the borrower.

This document and the design it covers are the property of PARSONS. They are loaned only with the borrower's expressed written agreement that they will

NO.	DATE	BY	CHKD	ENGR	PROJ	DESCRIPTION
B	5/22/96	WRB	NJ	UJ		BID ADDENDUM #2
A	4/19/96	WRB	ML	JB	MDW	FINAL DESIGN REVIEW & BID

DESIGNED	WRB
CHECKED	
ENGINEER	
PROJ	

PARSONS
 100 WEST WALNUT STREET
 PASADENA, CALIFORNIA

LIGO
 CALIFORNIA INSTITUTE OF TECHNOLOGY
 MASSACHUSETTS INSTITUTE OF TECHNOLOGY

LASER INTERFEROMETER
 GRAVITATIONAL-WAVE OBSERVATORY
 SITE NO. 1 - HANFORD, WASHINGTON

AS NOTED	PP150969	8094
WA-C-054		

REFERENCES

REVISIONS

LIGO-D960238-B-0

LIGOWAF 3.BDR