

NOTES:
 1. SEE SHEET WA-C-002 FOR GENERAL NOTES, LEGEND AND ABBREVIATIONS.

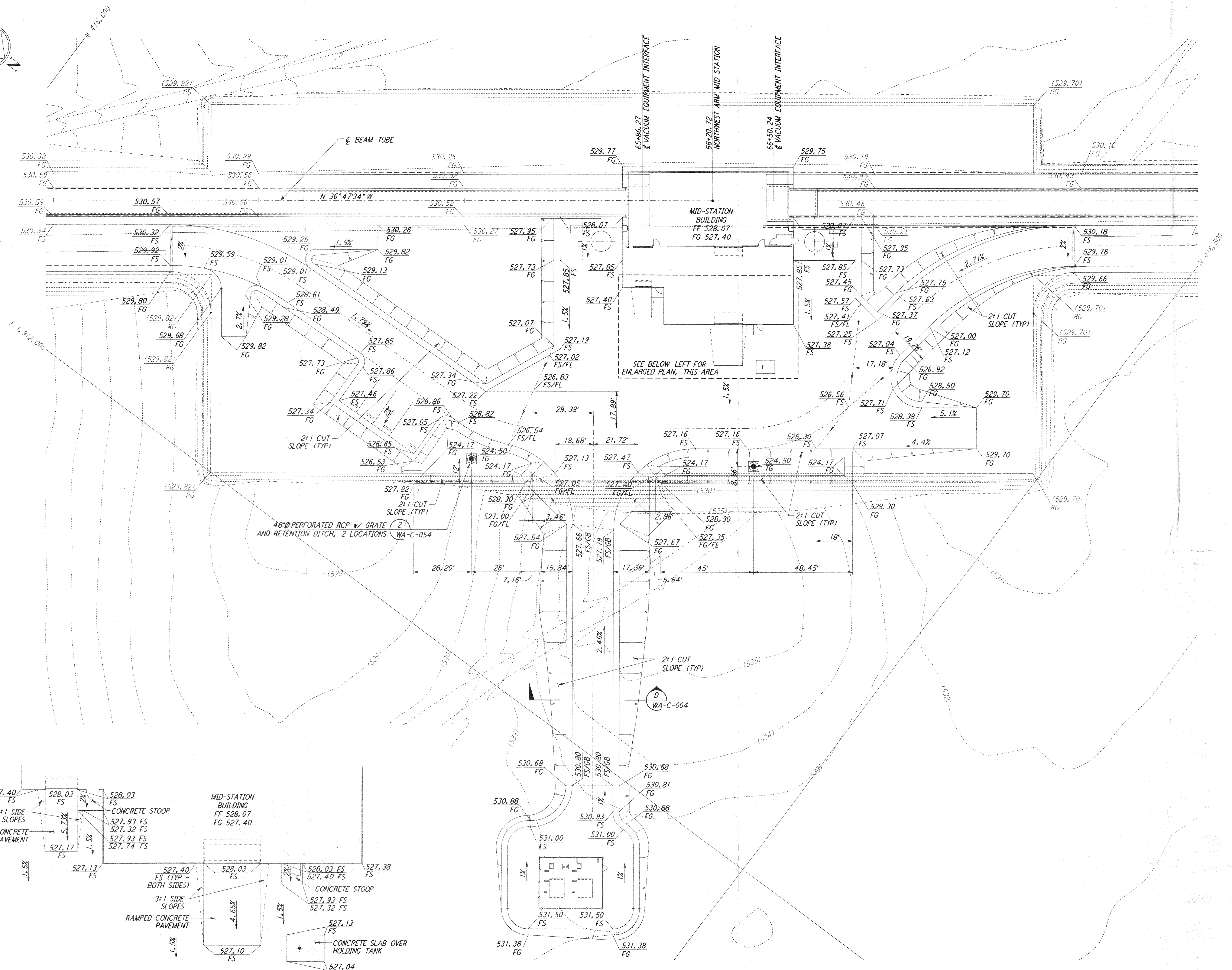

This document and the design it covers are the property of PARSONS. They are loaned only with the borrower's expressed written agreement that they will not be reproduced, copied, loaned, exhibited, or used in any other way, except by written consent from PARSONS to the borrower.

This document and the design it covers are the property of PARSONS. They are loaned only with the borrower's expressed written agreement that they will not be reproduced, copied, loaned, exhibited, or used in any other way, except by written consent from PARSONS to the borrower.

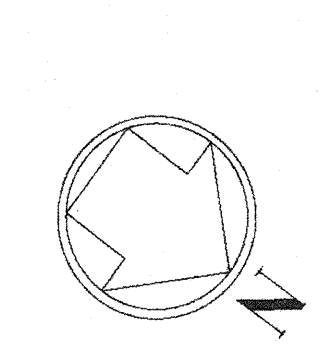
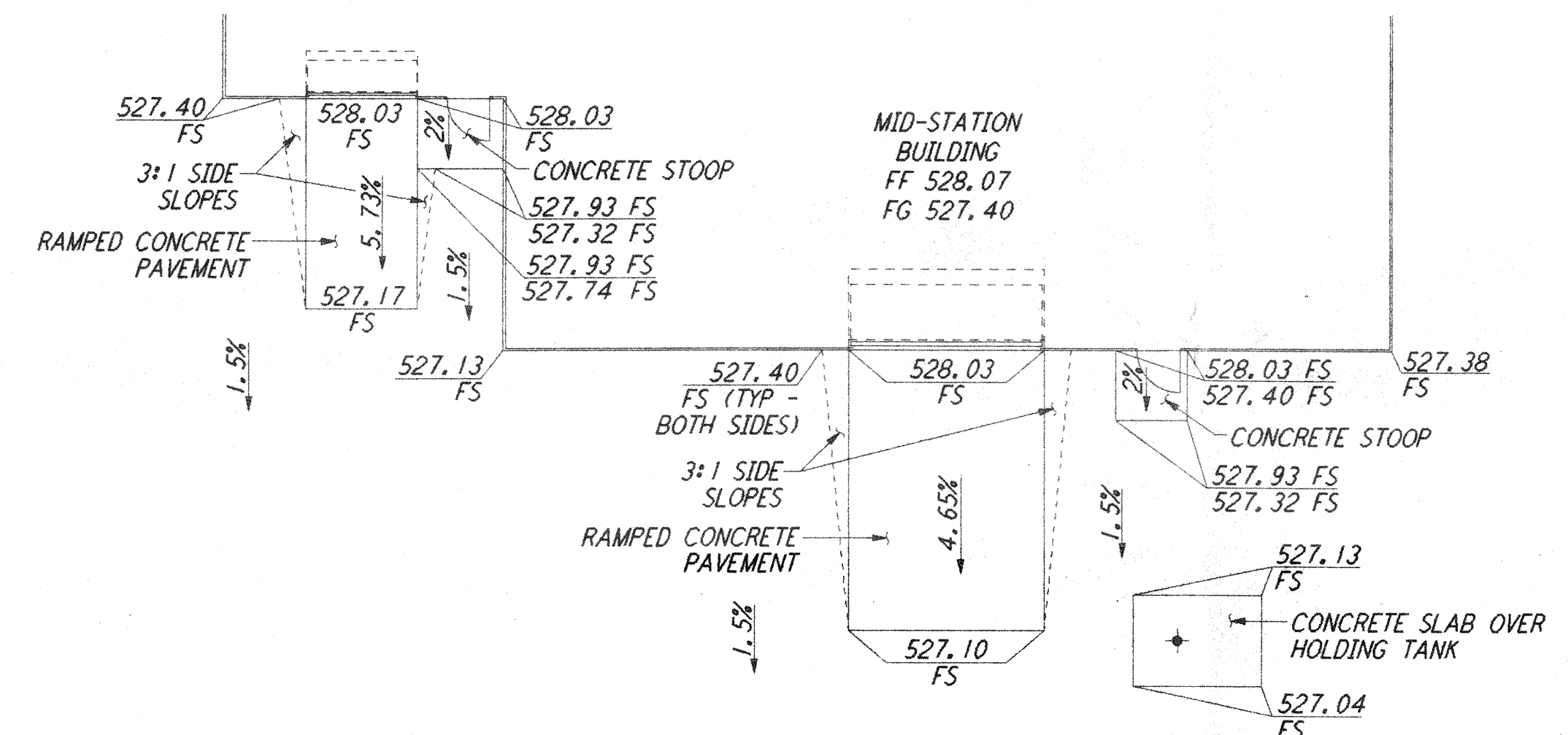

ENLARGED PLAN
 SCALE: 1" = 10'

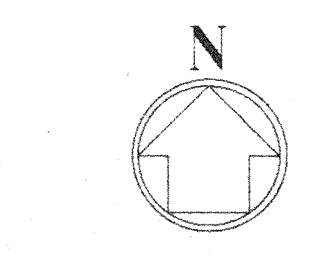
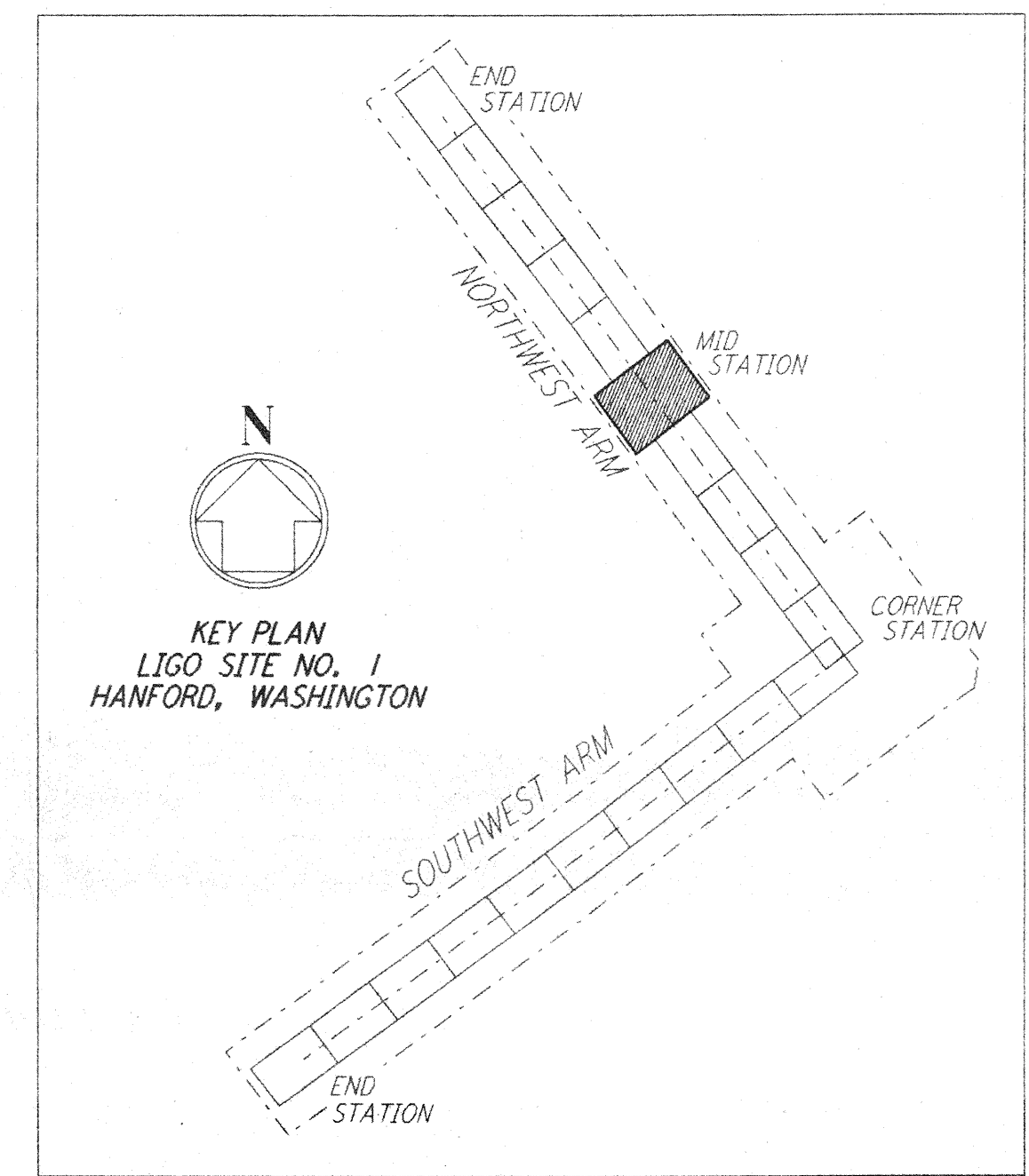

KEY PLAN
 LIGO SITE NO. 1
 HANFORD, WASHINGTON

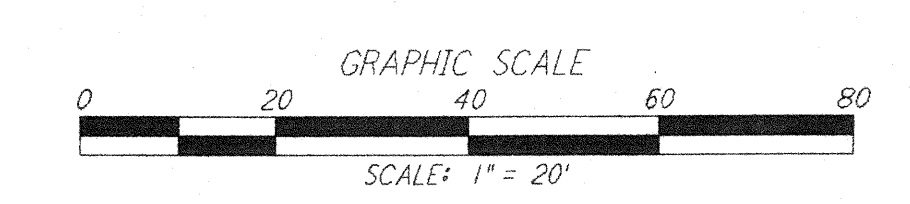

NO.	DATE	BY	CHKD	ENGR	PRJG	DESCRIPTION

NO.	DATE	BY	CHKD	ENGR	PRJG	DESCRIPTION

NO.	DATE	BY	CHKD	ENGR	PRJG	DESCRIPTION

PARSONS
 100 WEST WALNUT STREET
 PASADENA, CALIFORNIA

LIGO
 CALIFORNIA INSTITUTE OF TECHNOLOGY
 MASSACHUSETTS INSTITUTE OF TECHNOLOGY

**LASER INTERFEROMETER
 GRAVITATIONAL-WAVE OBSERVATORY
 SITE NO. 1 - HANFORD, WASHINGTON**

**CIVIL
 NORTHWEST ARM
 MID-STATION
 GRADING PLAN**

SCALE: 1" = 20'
 SHEET NUMBER: **WA-C-022**
 CONTRACT NUMBER: PPI50969
 PROJECT NUMBER: 8094