

not be reproduced, copied, loaned, exhibited, or used in any other way, except by written consent from PARSONS to the borrower.

This document and the design it covers are the property of PARSONS. They are loaned only with the borrower's expressed written agreement that they will

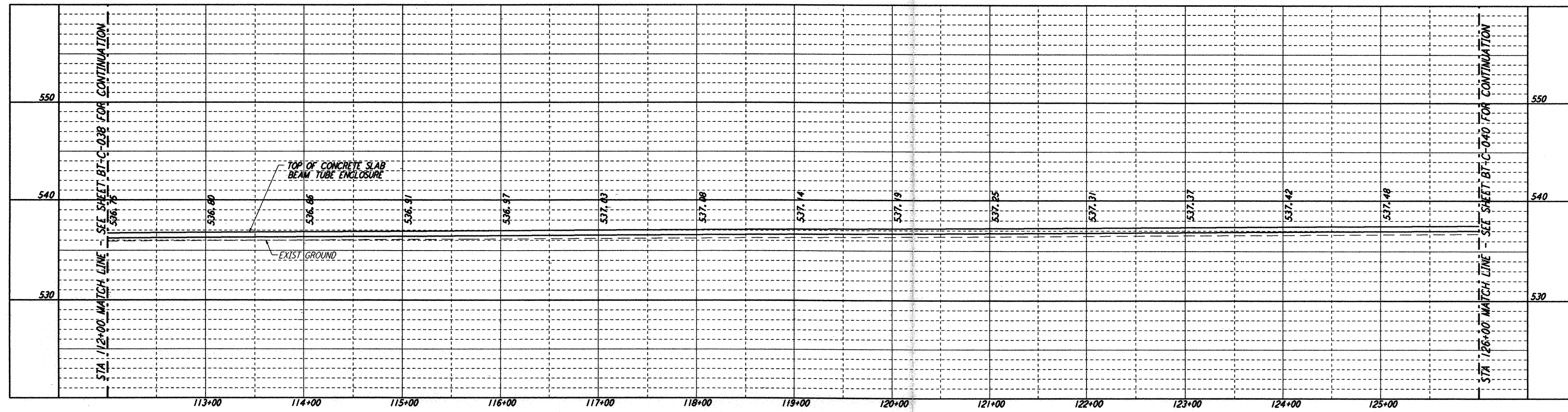

PROFILE
 SCALES: HORIZ: 1" = 50'
 VERT: 1" = 5'

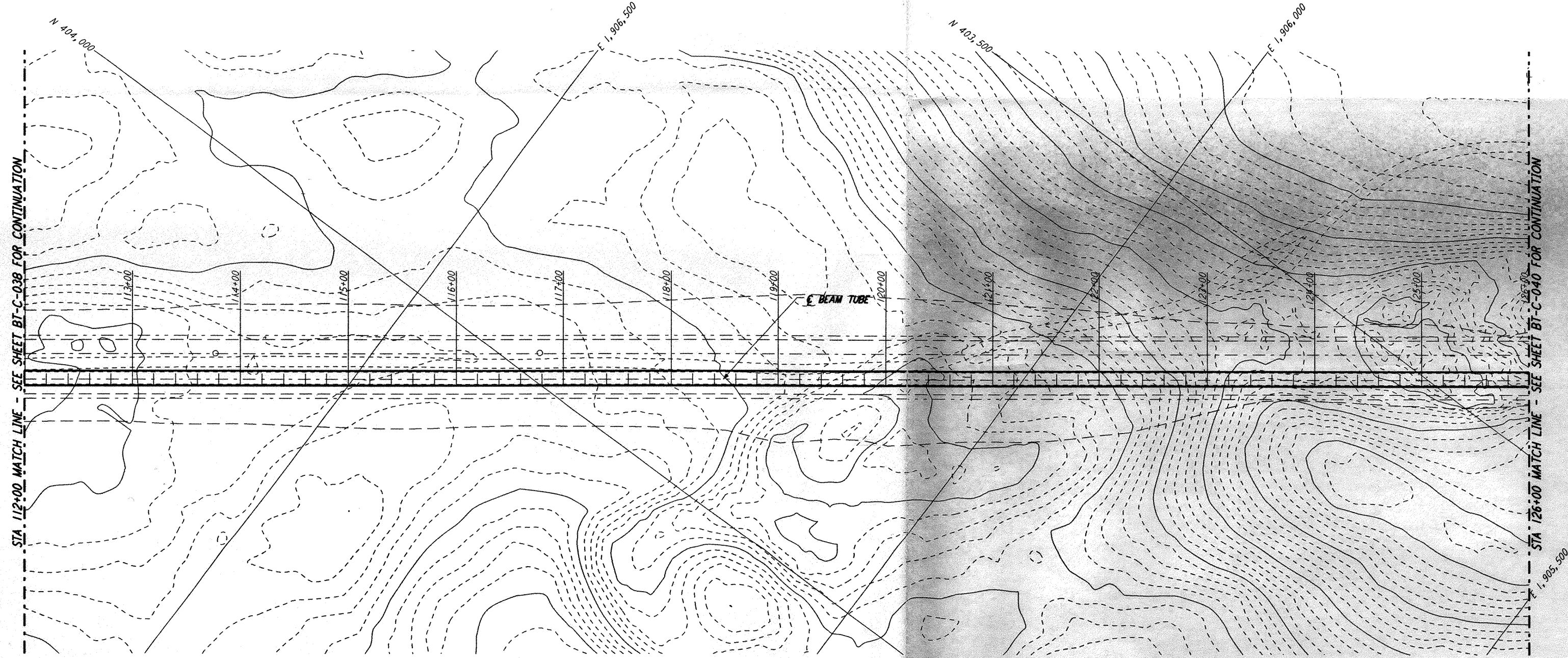

PLAN
 SCALE: 1" = 50'

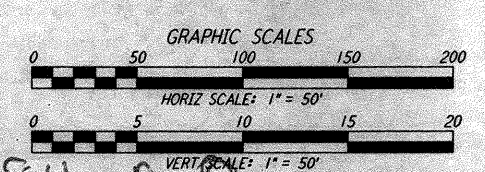
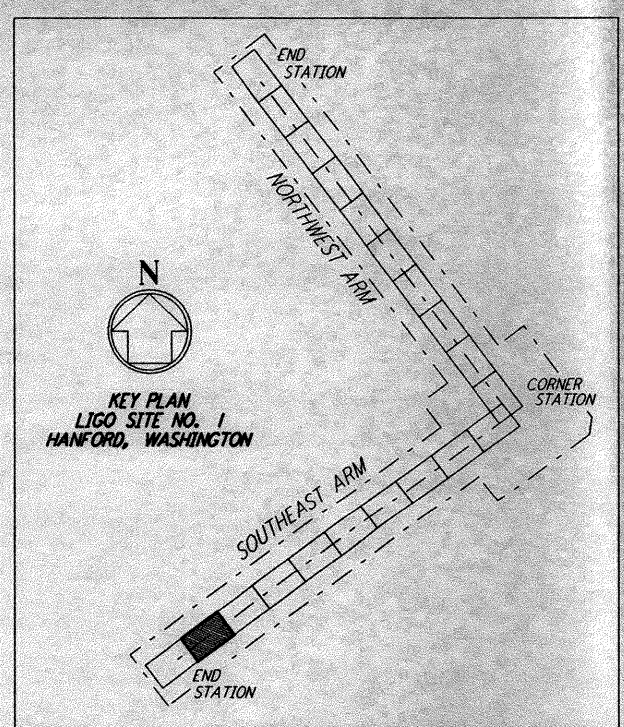
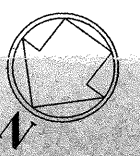

D960184-A-D

NO.	DATE	APRD BY	DESCRIPTION OF REVISION
9			
8			
7			
6			
5			
4			
3			
2			
1			

NO.	DATE	APRD BY	ISSUED FOR
1	8-14-95		PRELIMINARY DESIGN REPORT

DATE	8-10-95
DRAWN	WRB
CHECKED	
SECT HD	
PROJ MGR	
CLIENT	

PARSONS
 100 WEST WALNUT STREET
 PASADENA, CALIFORNIA

LIGO
 CALIFORNIA INSTITUTE OF TECHNOLOGY
 MASSACHUSETTS INSTITUTE OF TECHNOLOGY

**LASER INTERFEROMETER
 GRAVITATIONAL-WAVE OBSERVATORY
 BEAM TUBE ENCLOSURE - HANFORD, WA**

TITLE: SOUTHWEST ARM PLAN AND PROFILE STA 112+00 TO STA 126+00
 SCALE: AS NOTED
 CONTRACT NUMBER: PPI50969
 PROJECT NUMBER: 8094
 SHEET NUMBER: BT-C-039

Thu Aug 10 18:06:55 1995 s3-v18b2 K:\PILOTS\QUIFIES\18R2\CE0390.PRF