

PROFILE
 SCALES: HORIZ: 1" = 50'
 VERT: 1" = 5'

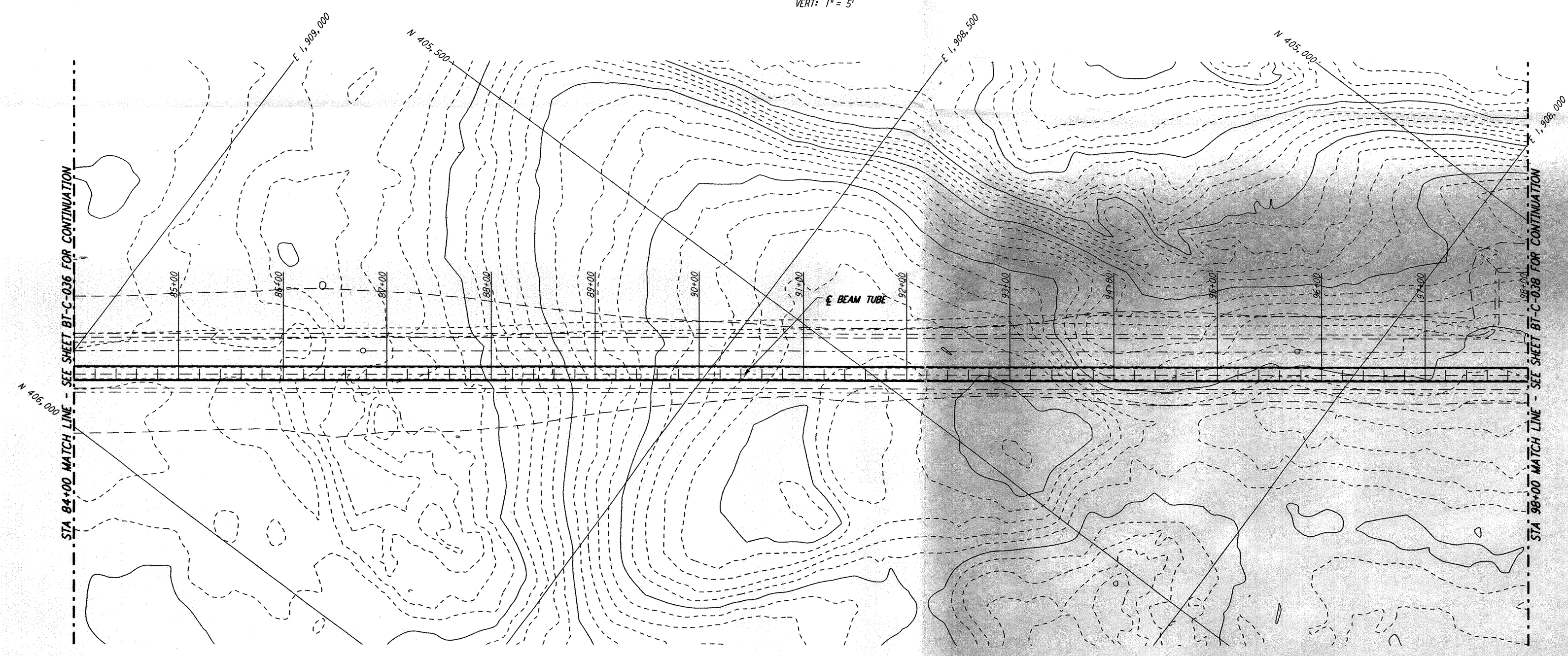

PLAN
 SCALE: 1" = 50'

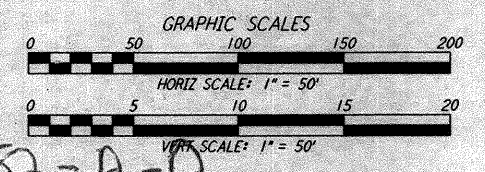
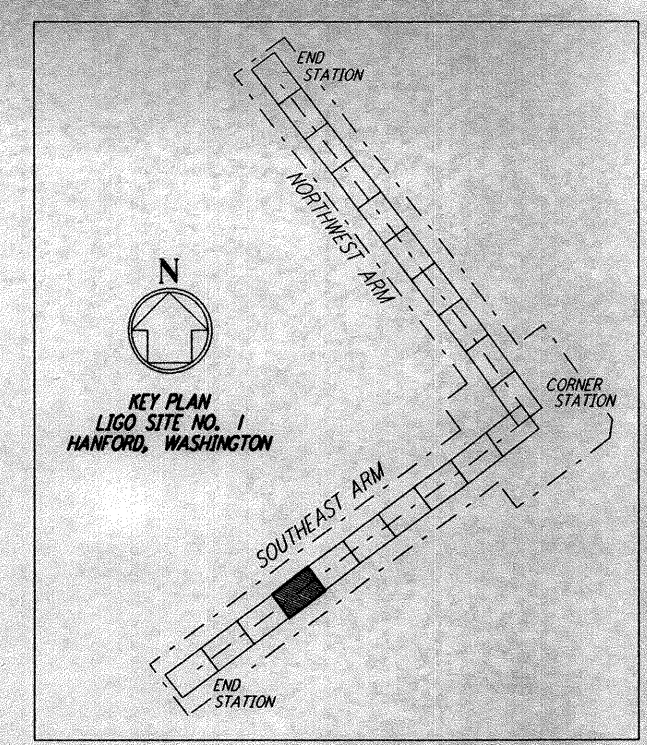

0960182-A-0

This document and the design it covers are the property of PARSONS. They are loaned only with the borrower's expressed written agreement that they will not be reproduced, copied, loaned, exhibited, or used in any other way, except by written consent from PARSONS to the borrower.

| NO. | DATE | APRD BY | DESCRIPTION OF REVISION |
|-----|------|---------|-------------------------|
| 9 | | | |
| 8 | | | |
| 7 | | | |
| 6 | | | |
| 5 | | | |
| 4 | | | |
| 3 | | | |
| 2 | | | |
| 1 | | | |

| NO. | DATE | APRD BY | ISSUED FOR |
|-----|---------|---------|---------------------------|
| 1 | 8-14-95 | | PRELIMINARY DESIGN REPORT |

| | |
|----------|---------|
| DATE | 8-10-95 |
| DRAWN | WRB |
| CHECKED | |
| SECT HD | |
| PROJ MGR | |
| CLIENT | |

PARSONS
 100 WEST WALNUT STREET
 PASADENA, CALIFORNIA

LIGO
 CALIFORNIA INSTITUTE OF TECHNOLOGY
 MASSACHUSETTS INSTITUTE OF TECHNOLOGY

LASER INTERFEROMETER
 GRAVITATIONAL-WAVE OBSERVATORY
 BEAM TUBE ENCLOSURE - HANFORD, WA

| | | | |
|---|--------------|-----------------|----------------|
| TITLE | SHEET NUMBER | CONTRACT NUMBER | PROJECT NUMBER |
| | AS NOTED | PP150969 | 8094 |
| SOUTHWEST ARM PLAN AND PROFILE STA 84+00 TO STA 98+00 | | BT-C-037 | |