

8 7 6 5 4 3 2 1

REV.	DATE	DCN #	DRAWING TREE #
A	4 AUG 2008	E080419-00-D	

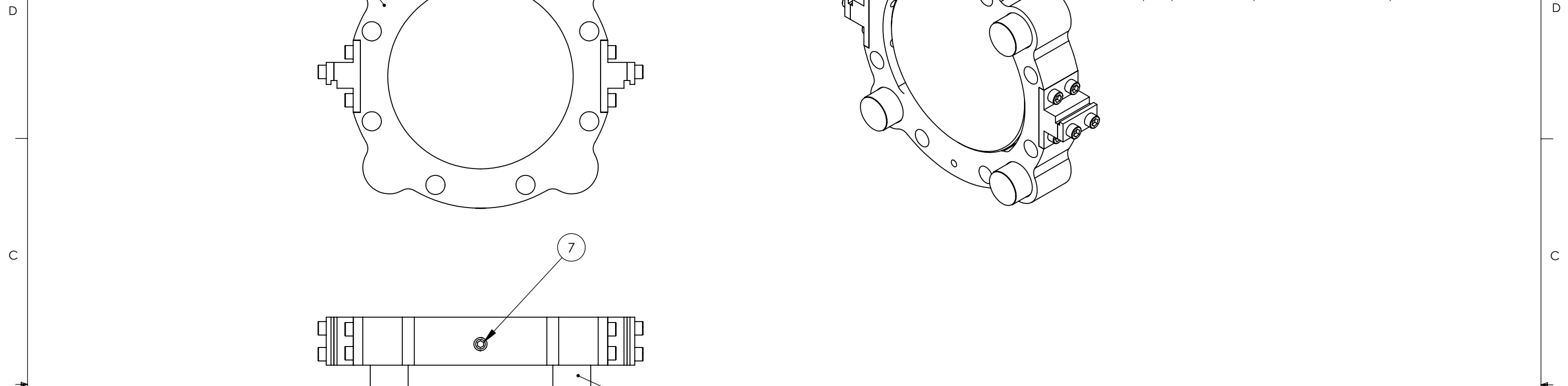

ITEM NO.	REQ	SPARE	TOTAL	PART NUMBER	DESCRIPTION	MATERIAL
10	1	0	1	D070191	NEO35 DIA5mm x L3mm	NICKEL PLTD NdFeB
9	8	2	10	-	SCREW, SOCKET HEAD CAP, #2-56 X 0.25 LG	300 SSSL
8	4	1	5	-	SCREW, SOCKET HEAD CAP, #2-56 X 0.25 LG	Ag-PLATED 300 SSSL
7	1	1	2	-	SET SCREW, SOCKET, CUP POINT, #6-32 X 0.125 LG	300 SSSL
6	4	1	5	D070190	NEO35 DIA10mm x L10mm	NICKEL PLTD NdFeB
5	1	0	1	-	2" X 0.375" OPTIC	
4	1	1	2	D080072	MIRROR NUDGE	PFA 440 HP (PRESHRUNK)
3	2	2	4	D080071	OUTER WIRE CLAMP	304, 316, OR 302 SSSL
2	2	1	3	D080070	INNER WIRE CLAMP	304, 316, OR 302 SSSL
1	1	0	1	D080069	2" MIRROR HOLDER	6061-T6 AL

PARTS LIST

NOTES: (UNLESS OTHERWISE SPECIFIED)

DIMENSIONS ARE IN INCHES		CALIFORNIA INSTITUTE OF TECHNOLOGY MASSACHUSETTS INSTITUTE OF TECHNOLOGY IGR, GLASGOW UNIVERSITY GEO 600 GROUP
TOLERANCES: .XX ± 0.01 .XXX ± 0.005 ANGULAR ± 0.5°		
MATERIAL		SYSTEM ADVANCED LIGO
FINISH		SUB-SYSTEM SUS
DRAWN M. MEYER 24 JAN 2008		NEXT ASSY TIP-TILT MAIN ASSY
CHECKED J. ROMIE 4 AUG 2008		PART NAME MIRROR ASSEMBLY
APPROVED		SIZE B DWG. NO. D080058 REV. A
		SCALE: 1:1 PROJECTION: SHEET 1 OF 1

8 7 6 5 4 3 2 1