

SECTION E-E
SCALE 1 : 8

SECTION F-F
SCALE 1 : 8

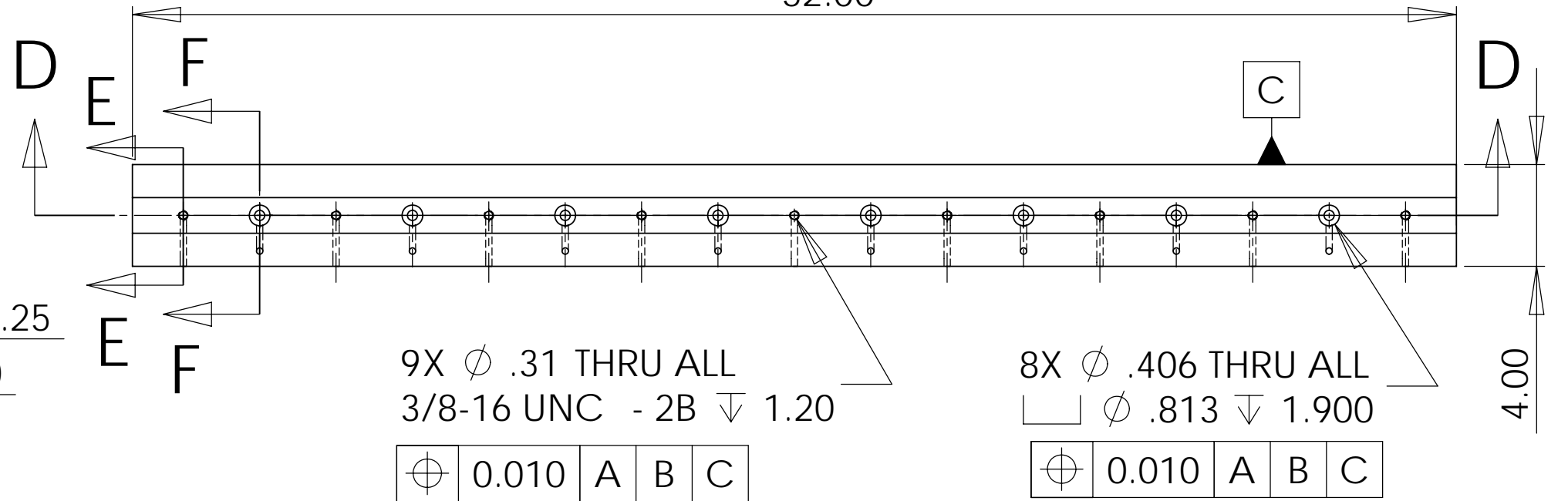
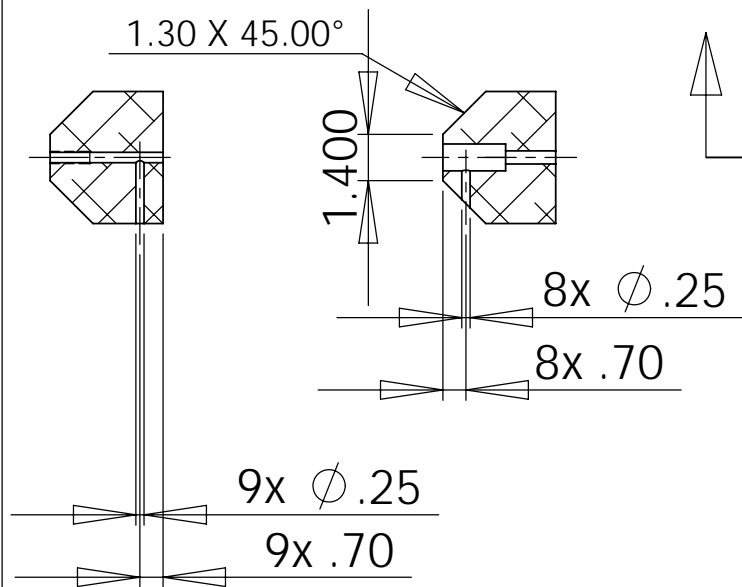

9X ϕ .31 THRU ALL
3/8-16 UNC - 2B ∇ 1.20

8X ϕ .406 THRU ALL
 \square ϕ .813 ∇ 1.900

ϕ 0.010 A B C

ϕ 0.010 A B C

NOTES :

1. THOROUGHLY CLEAN PART TO REMOVE ALL OIL, GREASE DIRT AND CHIPS.
2. ALL MACHINING FLUIDS MUST BE WATER SOLUBLE AND FREE OF SULFUR, CHLORINE, AND SILICONE, SUCH AS CINCINNATI MILACRON CIMTECH 410.
3. WHERE INDICATED, MECHANICALLY SCRIBE, STAMP OR ENGRAVE (VIBRATORY ACCEPTABLE) THE FOLLOWING INFORMATION AS SHOWN BELOW: PART NUMBER-REVISION, USE 0.12" TALL CHARACTERS UNLESS PART SIZE DICTATES SMALLER

		UNLESS OTHERWISE SPECIFIED:		NAME	DATE	LIGO MIT	
		DIMENSIONS ARE IN INCHES		DRAWN	MATICHARD		
		TOLERANCES:		CHECKED	STEIN	8-14-07	TITLE: HAM Upper Riser
		TWO PLACE DECIMAL \pm 0.015		ENG APPR.	MASON	8-16-07	
		THREE PLACE DECIMAL \pm 0.005		MFG APPR.			
		ANGULAR: \pm 30'		Q.A.			SIZE DWG. NO. REV A D070304-A-D A
		SURFACE FINISH: 125		COMMENTS:			
		INTERPRET GEOMETRIC TOLERANCING PER:					SCALE: 1/8 WEIGHT: 59.5 pds SHEET 1 OF 1
		MATERIAL					
		6061 Alloy					
		FINISH					
NEXT ASSY	USED ON						
APPLICATION		DO NOT SCALE DRAWING					