

REV.	DATE	DCN #	DRAWING TREE #
A	15/OCT/06	E060240	.
B	20/DEC/07	E060240-B	.

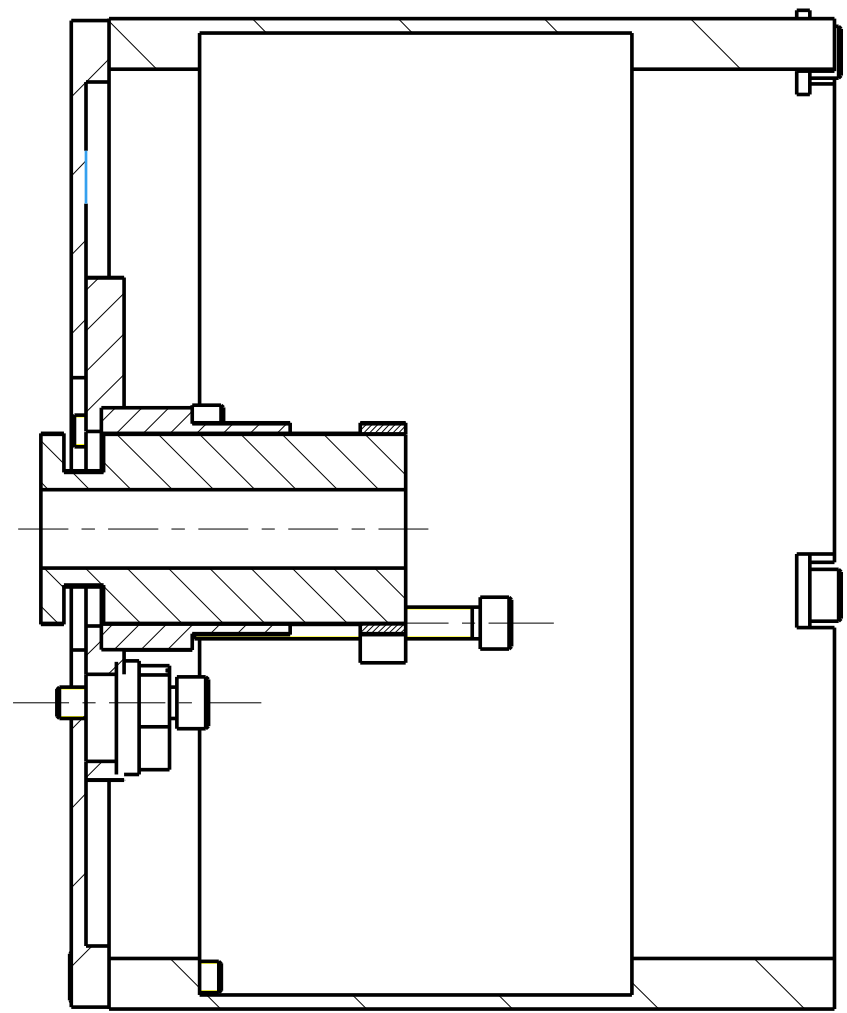

SECTION A-A

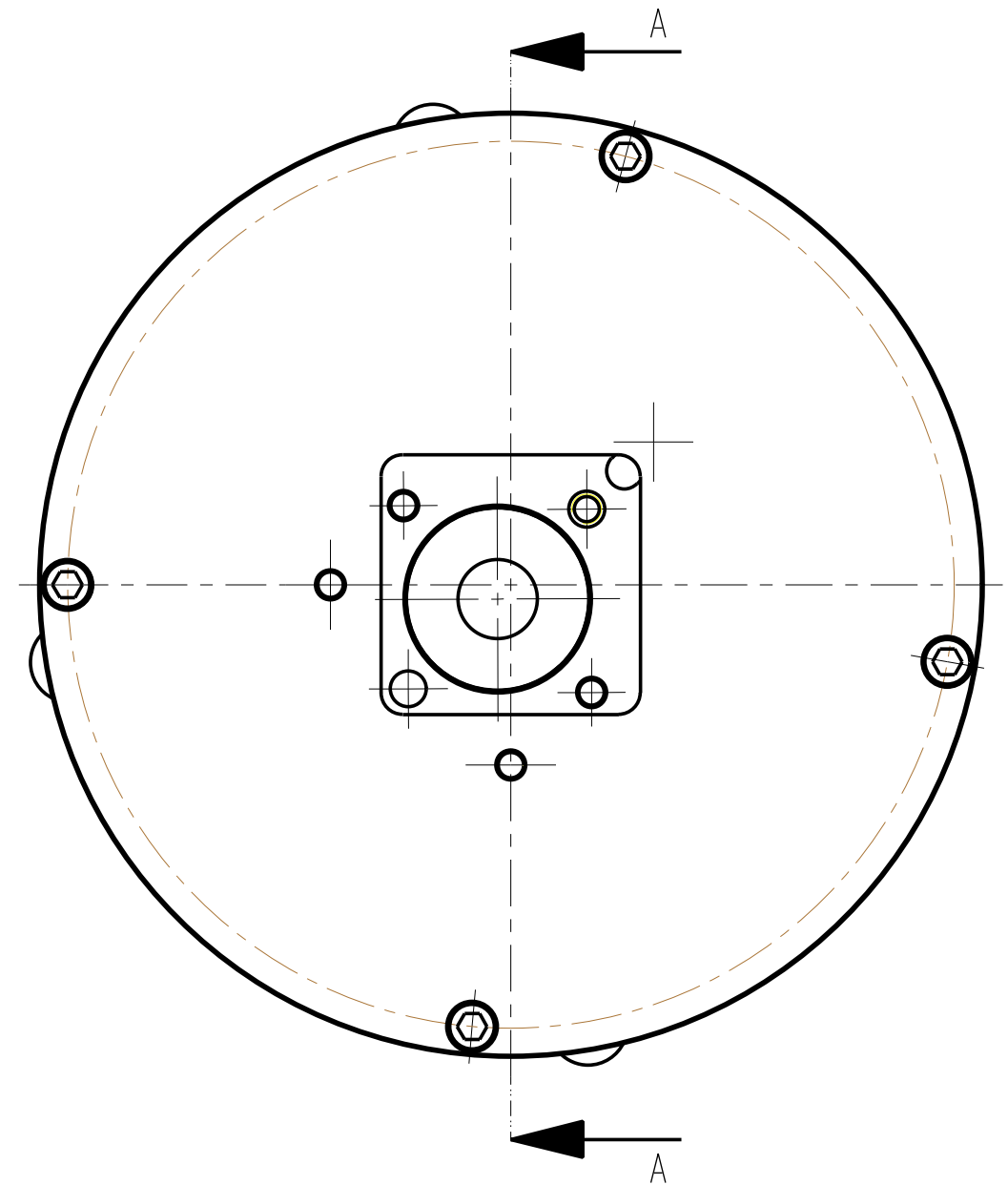
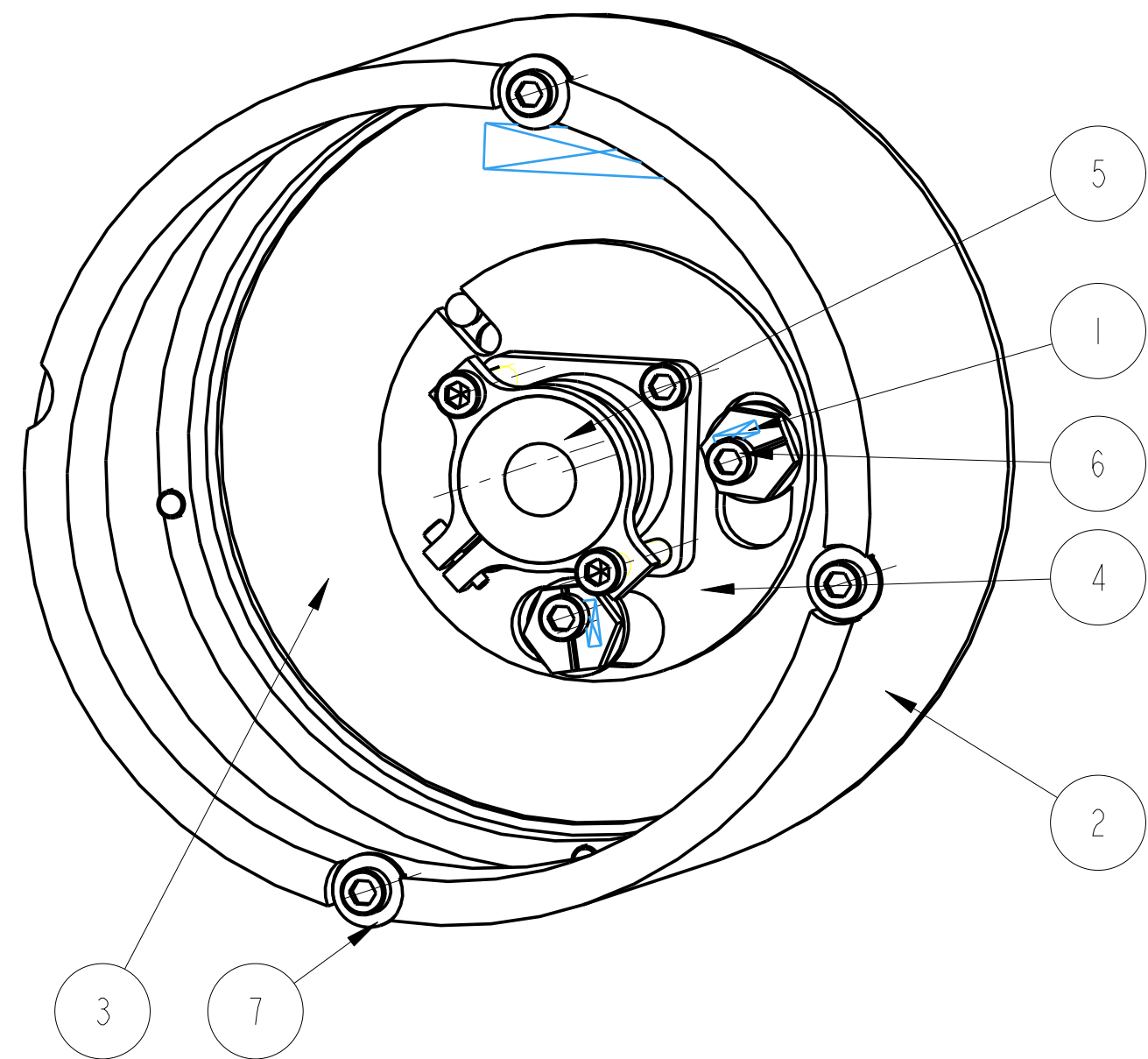
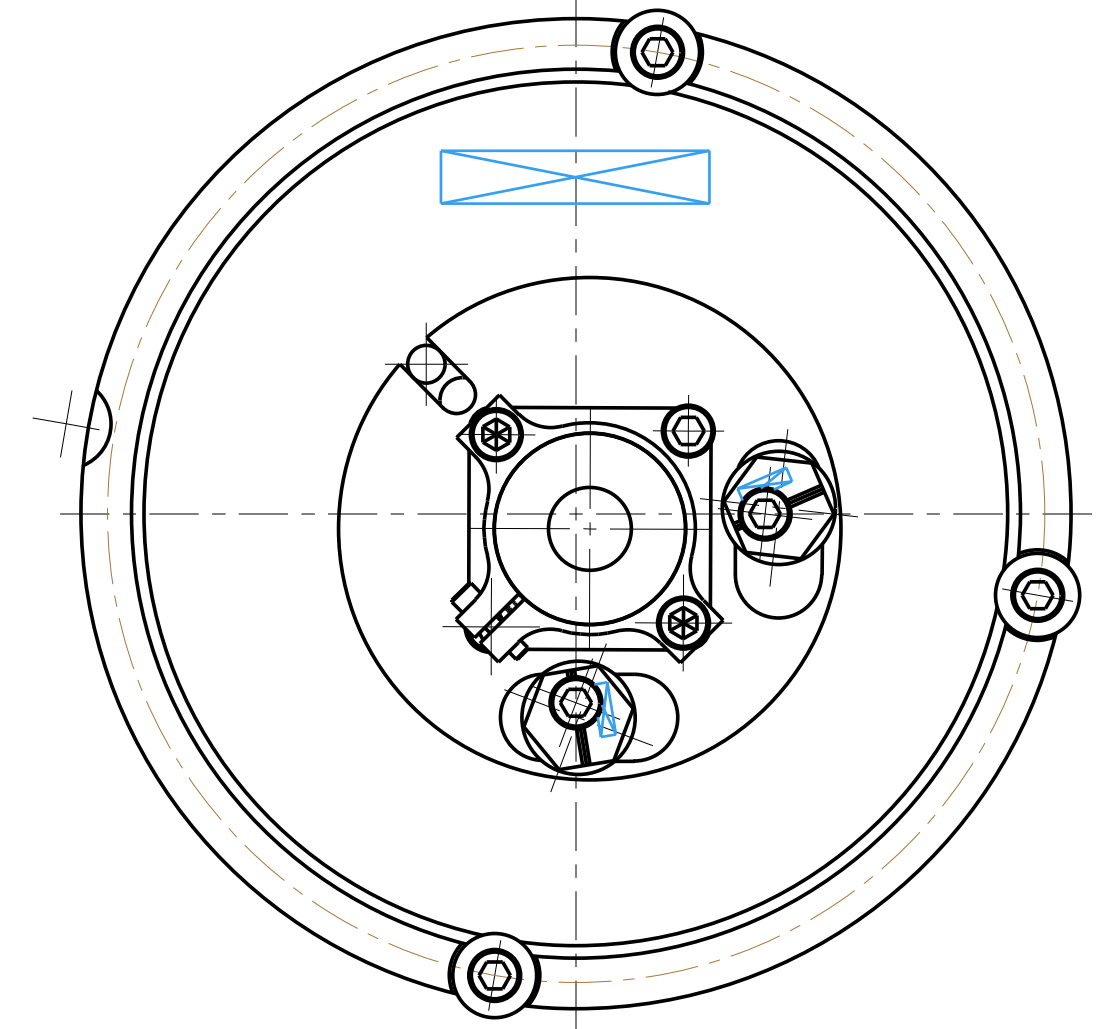

3-D VIEW

ITEM	QTY	SPARE	TOTAL	PART NUMBER	DESCRIPTION	MATERIALS
1	2			D060336	2MM CAM; OSEM ADJUSTER	PH BRONZE; -----
2	1			D060346	CAN BODY; ETM PEN RE MASS CAN	AL ALLOY; 6061 OR 5083
3	1			D060347	CAN FRONT PLATE; ETM PEN RE MASS CAN	AL ALLOY; 5083
4	1			D060348	OSEM TRANSLATION PLATE; ETM PEN RE MASS CAN	AL ALLOY; 5083
5	1			D060349	LIGO I OSEM MOUNT; (FOR PENRE MASS)	AS DRW; ---
6	11				8-32 UNC X 0.625" CAP HEAD; .	ST STEEL; 316
7	3				8-32 UNC WASHER; .	ST STEEL; 316

NOTES: (UNLESS OTHERWISE SPECIFIED)

- REMOVE ALL SHARP EDGES, R.02 MIN.
- DO NOT SCALE FROM DRAWING.
- ALL MACHINING FLUIDS SHALL BE WATER SOLUBLE AND FREE OF SULFUR, CHLORINE AND SILICONE, SUCH AS CINCINNATI MILACRON'S CIMTECH 410 (STAINLESS STEEL)
- SCRIBE, ENGRAVE OR STAMP DRAWING PART NUMBER ON NOTED SURFACE OF PART AND A THREE DIGIT SERIAL NUMBER. SERIAL NUMBERS START AT 001 FOR THE FIRST PART AND PROCEED CONSECUTIVELY. USE .07" HIGH CHARACTERS. EXAMPLE: D020188-001. A VIBRATORY TOOL MAY BE USED.

DIMENSIONS ARE IN INCHES [mm]

TOLERANCES:
X.XX ± .
X.XXX ± .
ANGULAR ± °

MATERIAL: AS DRW
FINISH: AS DRW
√μm [μin] Ro : -----

DRWN	CHKD	APPD	NAME	DATE
J O'DELL	AJB	1W	J O'DELL	24/SEP/06
			SMAY08	28/SEP/06

SCALE 1:1 PROJECTION: SHEET 1 OF 1

CALIFORNIA INSTITUTE OF TECHNOLOGY
MASSACHUSETTS INSTITUTE OF TECHNOLOGY
1GR, GLASGOW UNIVERSITY GEO 600 GROUP
RUTHERFORD APPLETON LABORATORIES

SYSTEM **ADVANCED LIGO**
SUB-SYSTEM **SUS**
NEXT ASSY **PENRE ETM QUAD N-PTYPE**
PART NAME **ETM OSEM CAN**

DRG. NO. **D060345**