

5

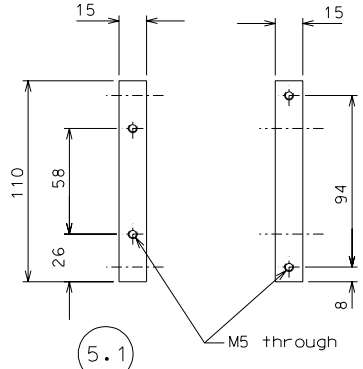

5.1

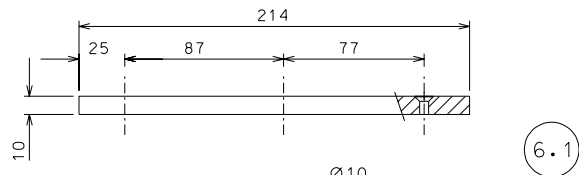

6.1

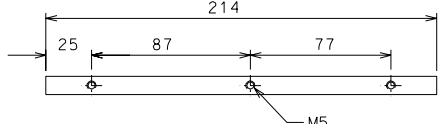

6.2

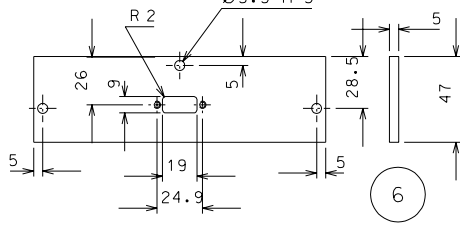
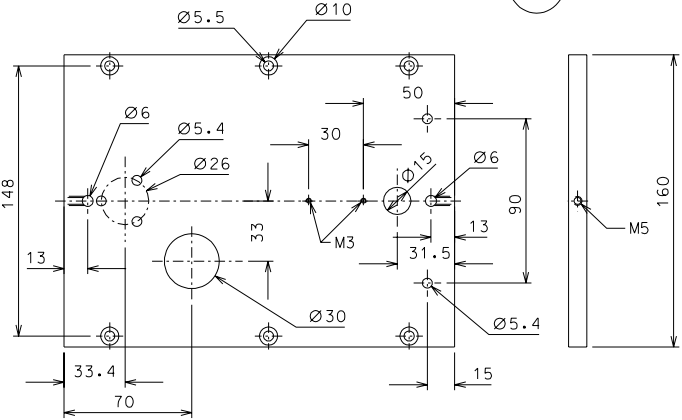
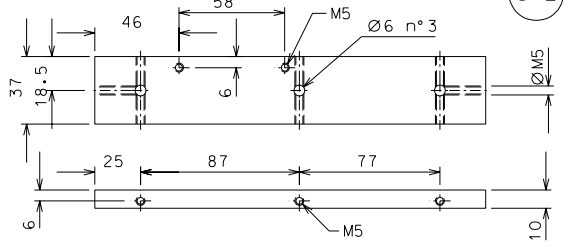

6

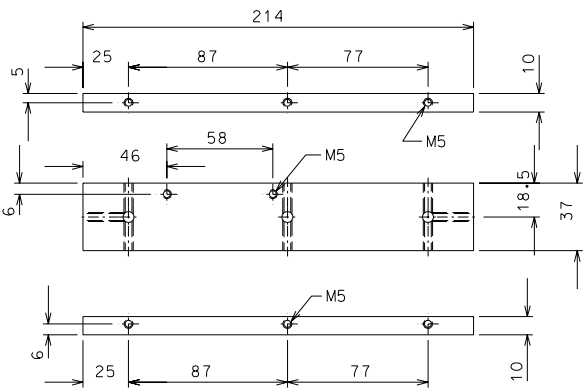

6.3

rif.		note		data		time	
modifiche							
6.2	4	EN 6082	1/2				
6.1	4	EN 6082	1/2				
6	8	EN 6082	1/2				
5.1	8	AISI 304	1/2				
5	4	AISI 304	1/2	6.3	4	EN 6082	1/2
ref.	pieces	mat. and treatments	scale	ref.	pieces	mat. and treatments	scale

General machining tolerances UNI 5307-63							
Dimensions	< 6	6-30	>30-120	>120-315	>315-1000	>1000-2000	>2000-4000
Linear Toli.	± 0.1	± 0.2	± 0.3	± 0.5	± 0.8	± 1.2	± 2
angular Toli.	± 1'	± 30'	± 20'	± 10' referred to the shortest side			
designed for R.De Salvo							
draw. by G. Gennaro-PROME							
date 04-09-06 scale 1/2							
title HAM-OPTICAL BENCH							
DETAILS LVDT ACTUATOR							
LIGO-D051130-03-D							
sheet 105 of 120							