

6-6.2-65-65.2	tommy head M5x16	56
6.1-6.2-65.2	countersunk head M5x20	72
5-5.1	countersunk head M5x20	16
6-65	washer d=8	16
6-65	nut M8	16
6-65	tommy head M8x20	16
5-6.2-68	tommy head M5x12	32
4-5	tommy head M6x20	16
1-65.1	tommy head M6x20	16
detail	type	n°piec.

Screw's table

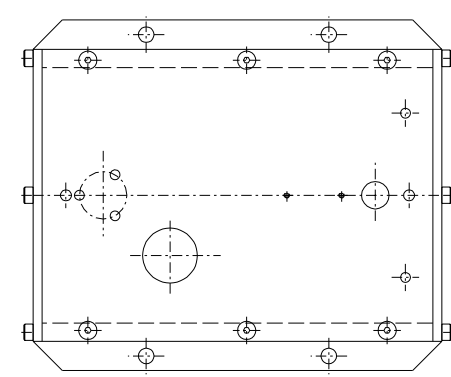

view A-A

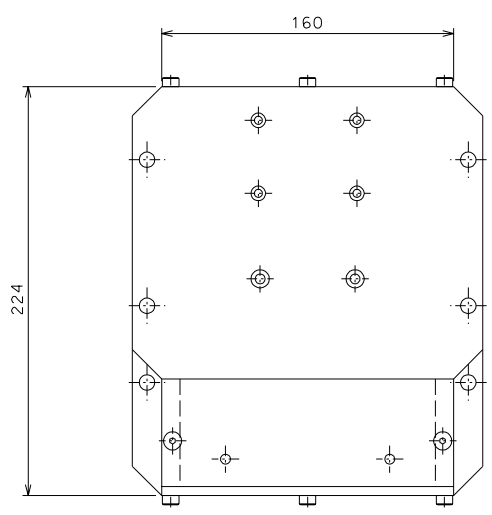
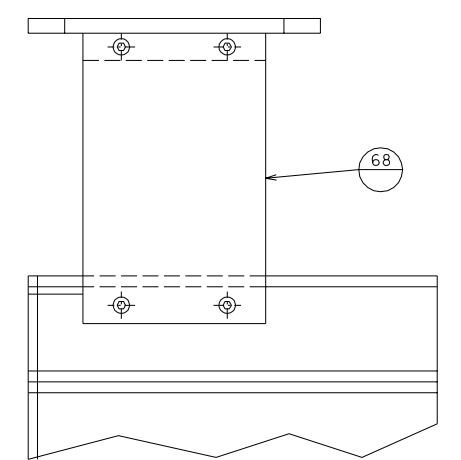
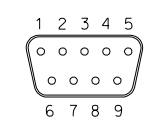

Accu-Glass 9D-PKS 10400  
9 pin sub-D male connector  
on stand

Connection convention:  
1: LVDT drive +  
2: LVDT drive -  
3: LVDT sense +  
4: LVDT sense -  
5: shields  
6-7: act. coil +  
8-9: act. coil -

modified structure		04-08-06	
added connection convention		05-05-06	
ref.	note	date	signature
modifications			
65	129	side base	gr.3.2 111 actuator
6.3	130	lateral cover	gr.3.1 112 LVDT
6.2	130	lateral cover	72 eliminated
6.1	130	sensor/act. base plate	68 129 transport plate
6	130	little sensor plate	65.3 123 lateral cover
5.1	130	fixing sensor plate	65.2 129 lateral cover
5	130	sensor/act. plate	65.1 129 base
ref.	draw.	added legend	ref. draw. added legend

	<b>LIGO PROJECT</b>	designed for <b>R.De Salvo</b>
		draw. by <b>G. Gennaro-PROMECH</b>
		date <b>26-12-04</b>
title <b>HAM-OPTICAL BENCH</b>		<b>LIGO-D051105-02-D</b>
<b>LVDT-ACTUATOR GR.3</b>	scale <b>1/2</b>	<b>A 2</b>