

REV.	DATE	DCN #	DRAWING TREE #
A	2nd FEB 2005	E050051-00	

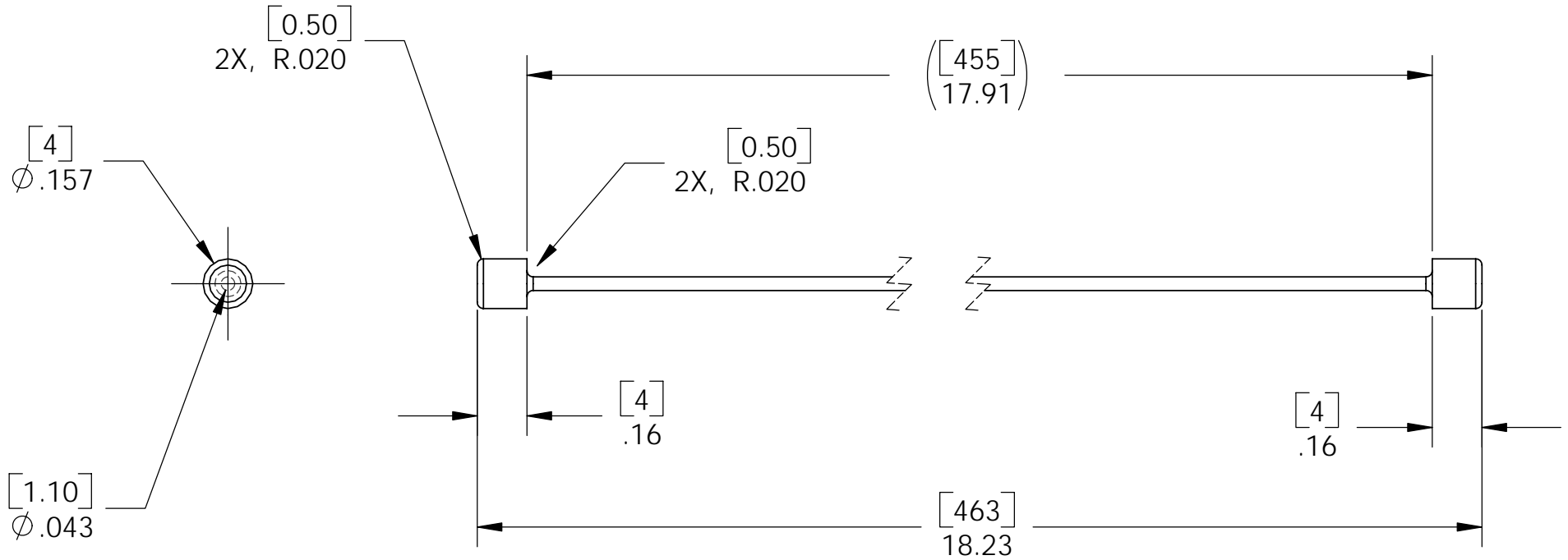

NOTES: (UNLESS OTHERWISE SPECIFIED)

- DO NOT SCALE FROM DRAWING.
- ALL MACHINING FLUIDS SHALL BE WATER SOLUBLE AND FREE OF SULFUR, CHLORINE AND SILICONE, SUCH AS CINCINNATI MILACRON'S CIMTECH 410 (STAINLESS STEEL).
- THE OVERALL LENGTH OF 455mm IS MADE UP FROM 445 mm LENGTH OF WIRE FROM MATLAB MODEL PLUS 2 * 5mm, THE DISTANCE FROM THE END OF THE DRUM END TO THE FLEXURE POINT.
- PLEASE CONSIDER RELEVANCE OF CHOSEN TOLERANCES TO EASE OF MANUFACTURE.

DIMENSIONS ARE IN [mm]
INCHES

TOLERANCES:
.XX ± 0.01
.XXX ± 0.005

ANGULAR ± 0.5 °

MATERIAL
MARAGING STEEL

FINISH
32 μ inch

	NAME	DATE
DRAWN	C Torrie	11 JAN 2005
CHECKED	J Romie	2nd Feb 2005
APPROVED		

LIGO CALIFORNIA INSTITUTE OF TECHNOLOGY
MASSACHUSETTS INSTITUTE OF TECHNOLOGY
IGR, GLASGOW UNIVERSITY GEO 600 GROUP

SYSTEM ADVANCED LIGO

SUB-SYSTEM SUS

NEXT ASSY QUAD ETM C-PTYPE

PART NAME
DRUM ENDED WIRE, TOP STAGE

SIZE DWG. NO. D050018

REV. A

SCALE: 1:4 PROJECTION: SHEET 1 OF 1