

LTR		ZONE	DESCRIPTION	REVISIONS									
DWN	CHK	ENGR	STRESS	MATL	THRM	ME	PROJ	QA	RELEASE DATE				
A				INITIAL RELEASE									

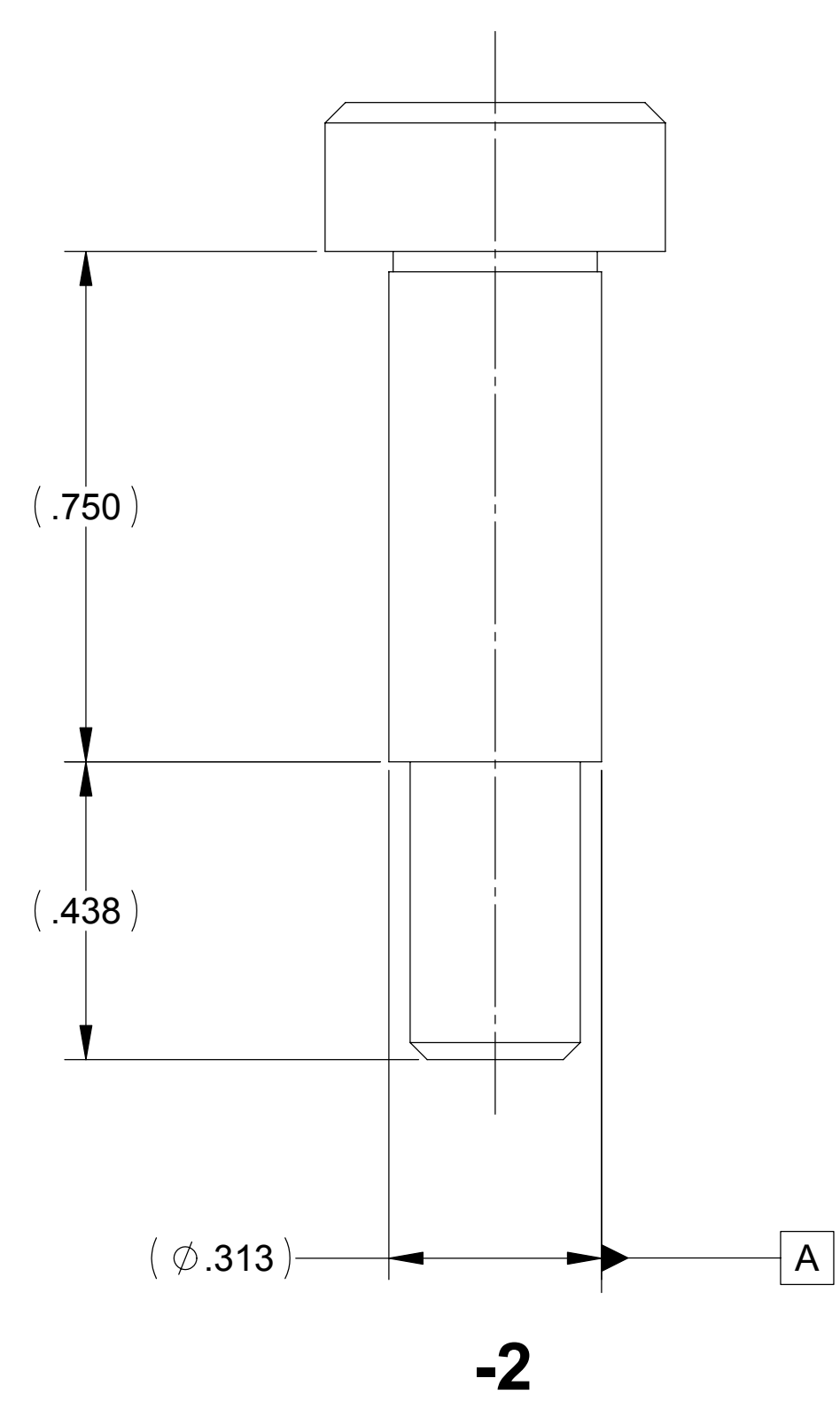
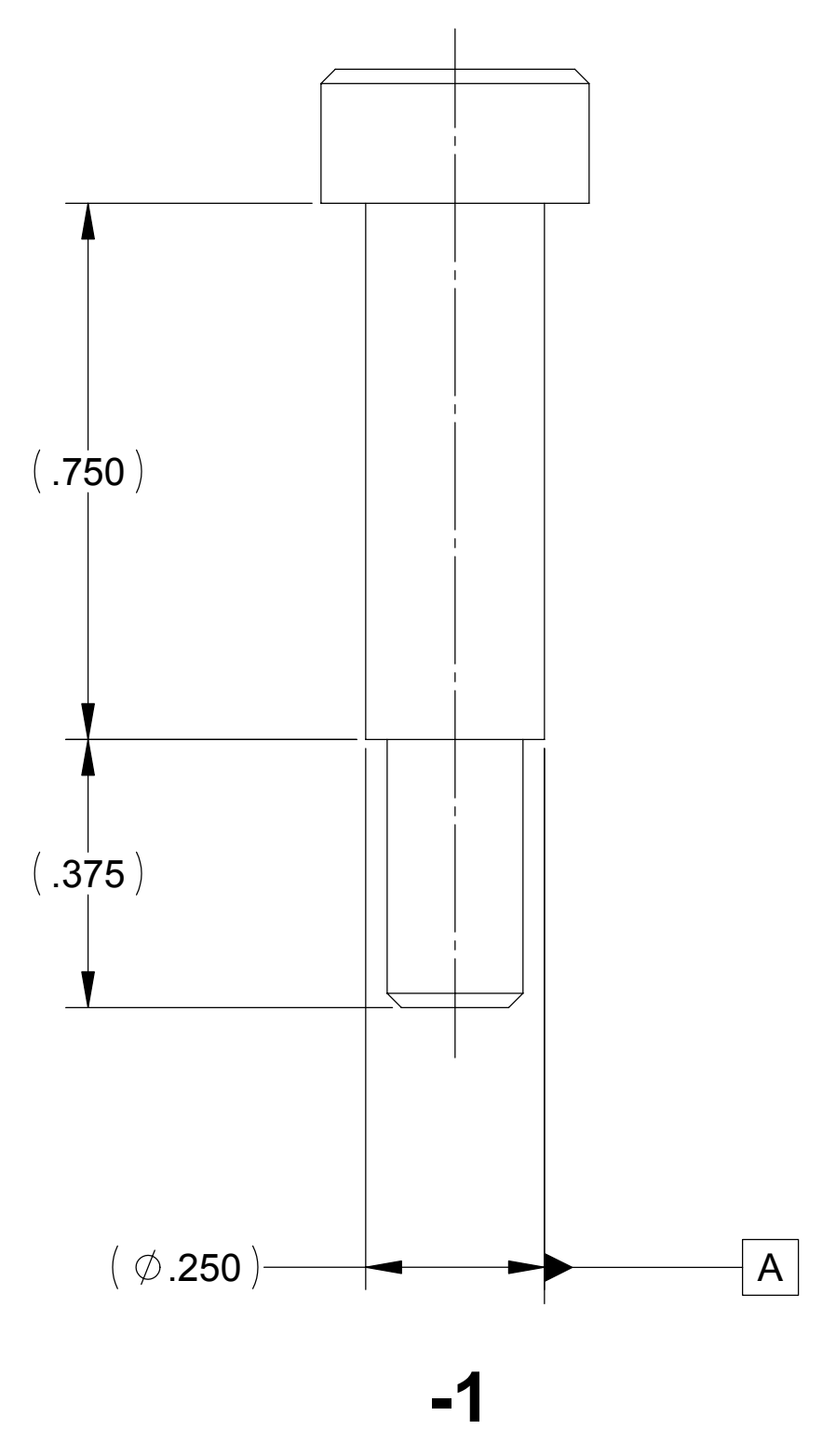
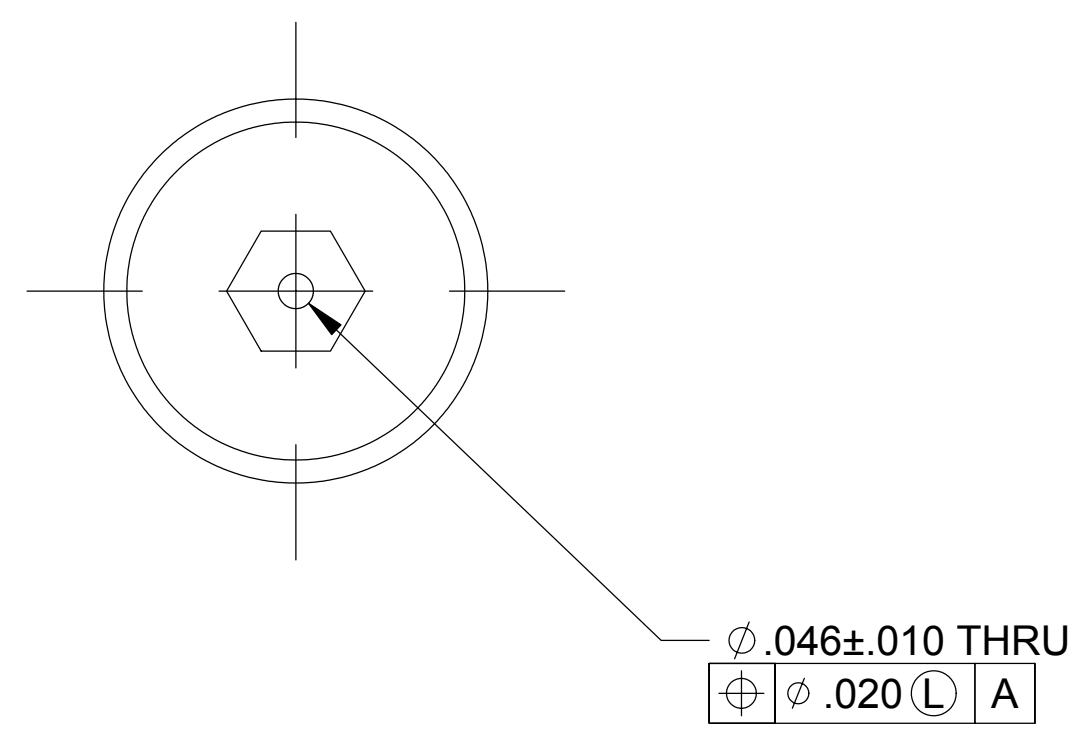
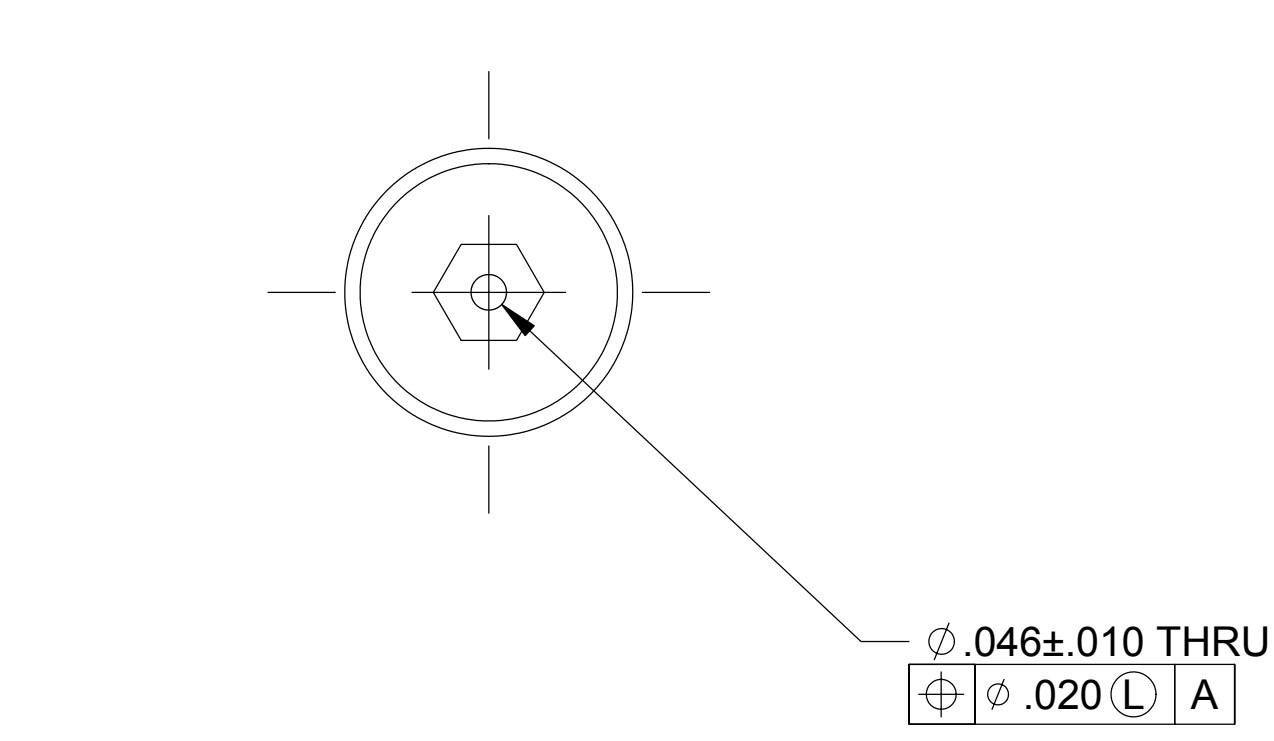

NOTES: UNLESS OTHERWISE SPECIFIED.

- ALL PARTS SHALL BE MANUFACTURED IN ACCORDANCE WITH ASI SPECIFICATION 20008225 (LIGO E048225).
- MAKE -1 VERSION FROM MCMASTER-CARR P/N 94035A575, MATERIAL 18-8 STAINLESS STEEL. MAKE -2 VERSION FROM MCMASTER-CARR P/N 94035A306, MATERIAL 18-8 STAINLESS STEEL. CAGE CODE 3A054
- REMOVE ALL BURRS AND SHARP EDGES .005-.015.
- MACHINE FILLET RADII .003-.015.
- IDENTIFY PART IN ACCORDANCE WITH 20006686, TYPE II.

THIS DOCUMENT MAY CONTAIN ITAR CONTROLLED INFORMATION AND/OR COMMERCE CONTROLLED INFORMATION EXPORT RESTRICTIONS MAY APPLY

20007987-2	SHOULDER SCREW, GS-13
20007987-1	SHOULDER SCREW, L-4C

QTY REQD	ITEM NO	REF DES	CAGE NO	PART OR IDENTIFYING NO	NOMENCLATURE OR DESCRIPTION	SPECIFICATION	MATERIAL OR NOTE	ZONE
					PARTS LIST			
CONTRACT NO				UNLESS OTHERWISE SPECIFIED DIMENSIONS ARE IN INCHES TOLERANCES DECIMALS .XX ±.03 .XXX ±.010 ANGLES ± 1/2° MACHINE FINISH 63 DO NOT SCALE DRAWING INTERPRET DWG PER ASME Y14.5M-1994		ALLIANCE SPACESYSTEMS, INC. 1250 Lincoln Ave., Suite 100 Pasadena, CA 91103		
20007970				1388		<b>RELEASED</b> <b>1/23/2005</b>		
NEXT ASSEMBLY				PROJECT CODE		DWN KEVIN J SPINK 09/16/04 PROJ ENGR STRS		
APPLICATION				SEE NOTE 2		<b>ALTERED ITEM - SCREW,            SHOULDER - VENTED            LIGO-D047987-A</b>		
						SIZE D CAGE CODE 1KNU9 <b>20007987</b>		REV A
						SCALE 4:1		UNCLASSIFIED SHEET 1 OF 1

FILE ATTACHMENTS

	20007987-1 94035A575.x_t
	20007987-2 94035A306.x_t