

REV.	DATE	DCN #	DRAWING TREE #
A	FEB 17th 2006	E060057-00	E060059-A

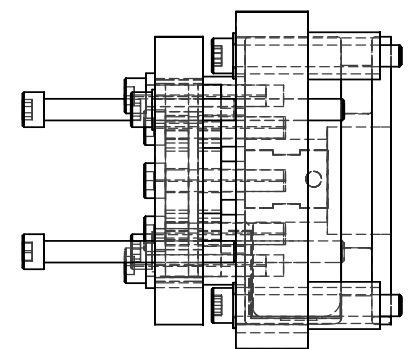
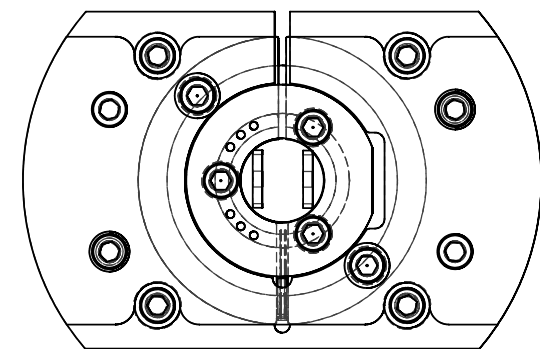
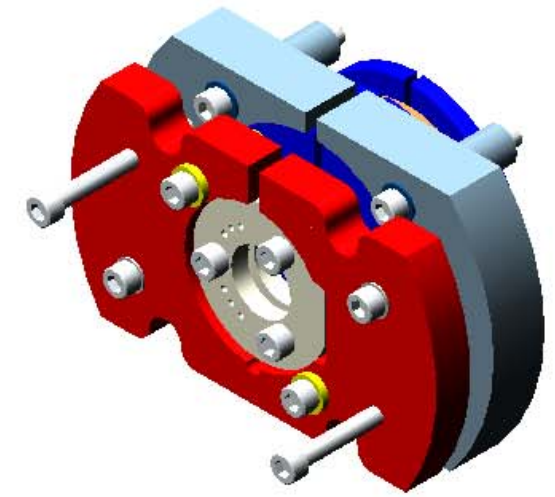
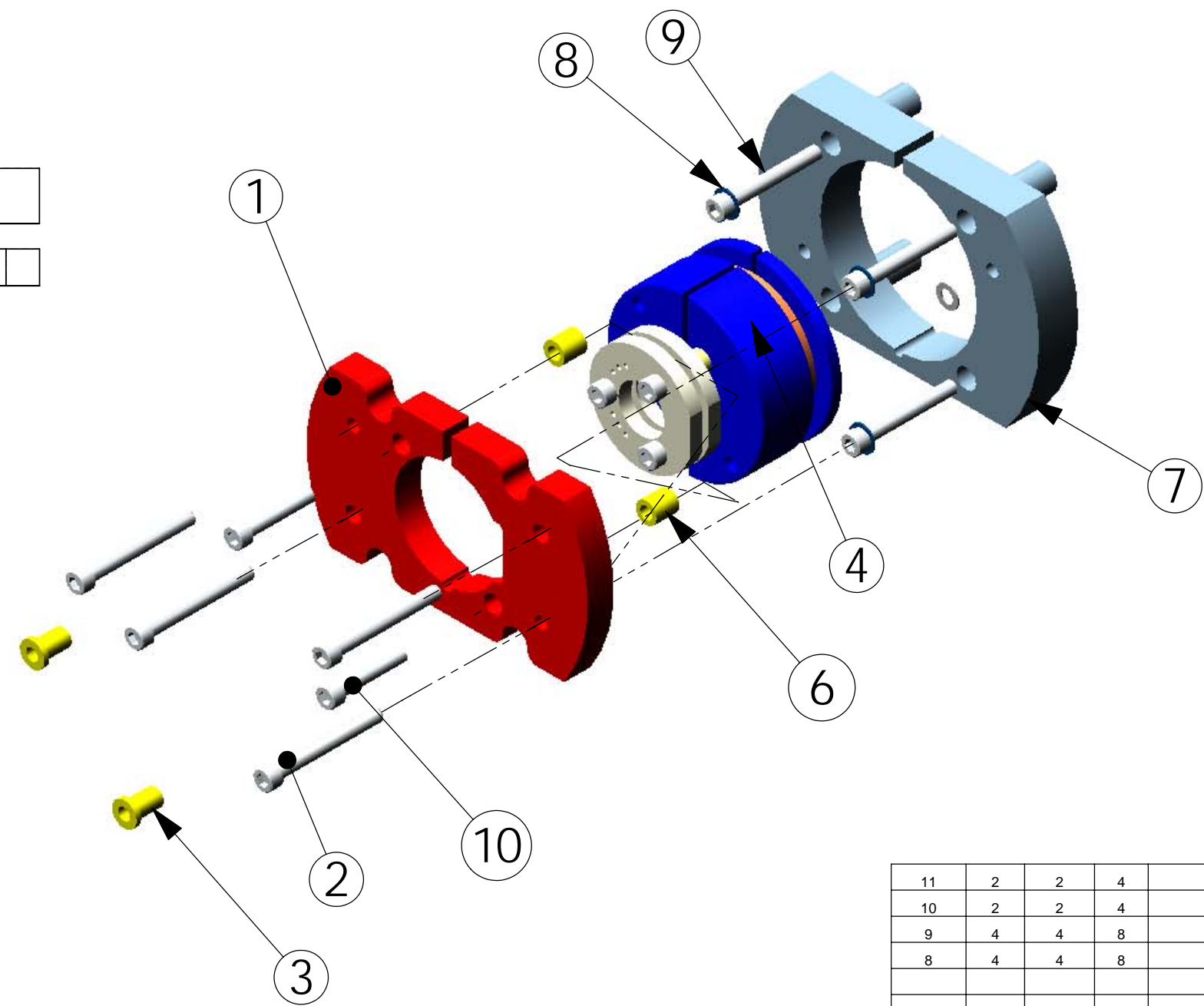
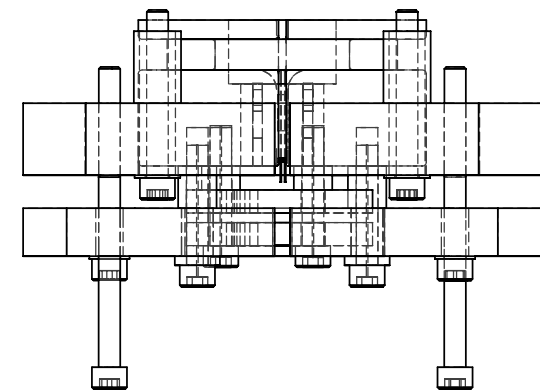

ITEM NO	REQ.	SPARE	TOT.	PART NUMBER	DESCRIPTION	MATERIAL
11	2	2	4		FLAT WASHERS NAS 620-C4L (OR EQUIV.)	300 SSSL
10	2	2	4		SST VENTED SOCKET HEAD CAP SCREW #4-40 UNC-3A X 0.625 LONG	Ag 300 SST
9	4	4	8		SST SOCKET HEAD CAP SCREW #4-40 UNC-3A X 0.875 LONG	300 SSSL
8	4	4	8		FLAT WASHERS NAS 620-5L (OR EQUIV.)	300 SSSL
6	2	2	4	D030123	SPACER FOR COIL FORMER BRACKET	TEFLON
ALT	1	1	2	D030124	KAPTON FILM 0.002" THICK (FOR COIL FORMER) 1.0" WIDE BY 4.7" LONG	KAPTON
4	1	1	2	D030105	ASSEMBLY COIL HEAD	
3	2	2	4	D030122	SHOULDER FOR COIL FORMER BRACKET	MACOR
2	4	4	8		SST SOCKET HEAD CAP SCREW #4-40 UNC-3A X 1 LONG	300 SSSL

NOTES: (UNLESS OTHERWISE SPECIFIED)

- DIMENSIONS IN INCHES.
- REMOVE ALL SHARP EDGES, R.02 MIN.
- ALL MACHINING FLUIDS SHALL BE WATER SOLUBLE AND FREE OF SULFUR, CHLORINE AND SILICONE, SUCH AS CINCINNATI MILACRON'S CIMTECH 410 (STAINLESS STEEL).
- ASSEMBLE ACCORDING TO HYBRID OSEM ASSEMBLY SPECIFICATION, LIGO E030084-00-D.
- ADDITIONAL ISOLATION OF THE COIL HEAD ASSEMBLY, D030105, SUPPLIED BY A COMBINATION OF D030122, D030123, D030124 SHOULD BE USED AS REQUIRED.

PARTS LIST		CALIFORNIA INSTITUTE OF TECHNOLOGY MASSACHUSETTS INSTITUTE OF TECHNOLOGY IGR, GLASGOW UNIVERSITY GEO 600 GROUP
DRAWN	NAME	
CIT	DATE	
CHECKED		
DIMENSIONS ARE IN INCHES		SYSTEM ADVANCED LIGO
TOLERANCES:		SUB-SYSTEM SUS
.XX ± 0.01		NEXT ASSY ETM: COIL
.XXX ± 0.005		PART NAME COIL ASSEMBLY
ANGULAR ± 0.5 °		SIZE DWG. NO. D040170
		REV. A
SCALE: NTS	PROJECTION:	SHEET 1 OF 2

REV.	DATE	DCN #	DRAWING TREE #
A	FEB 17th 2006	E060057-00	E060059-A

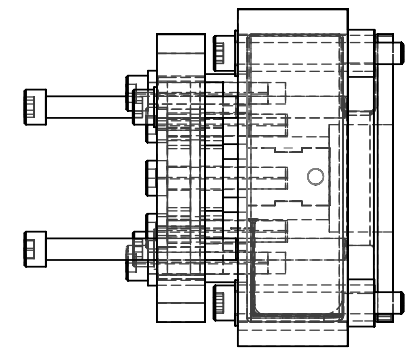
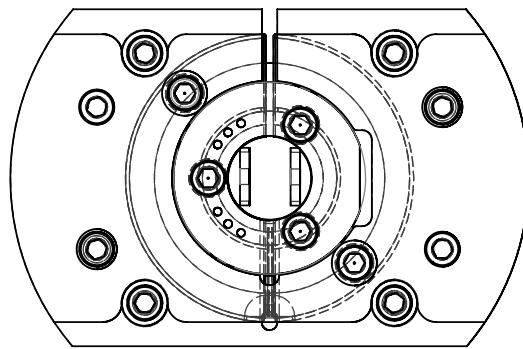
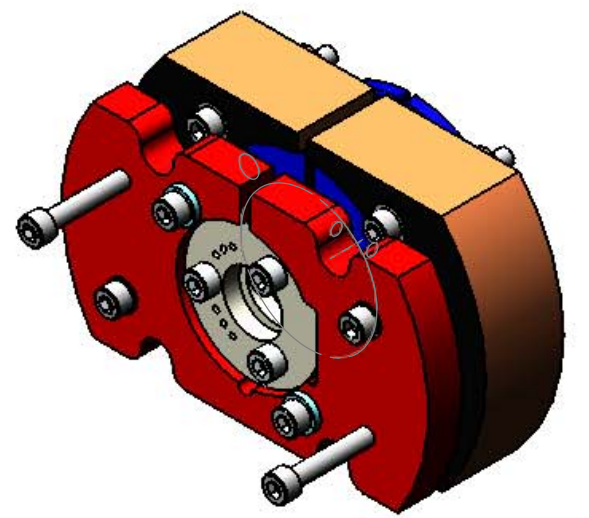
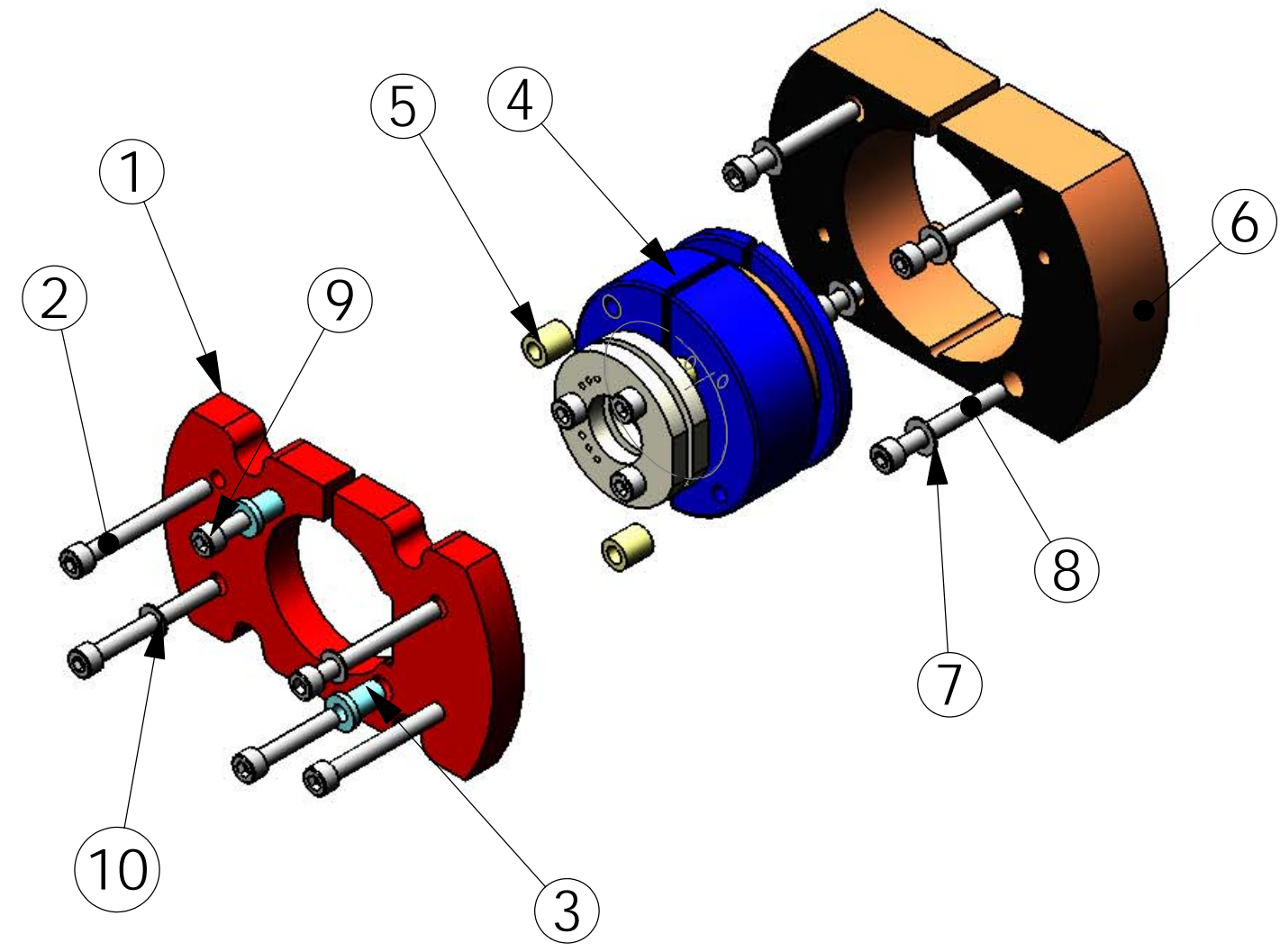
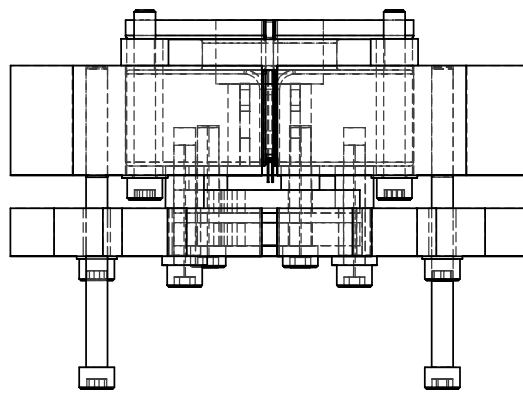

ITEM NO	REQ.	SPARE	TOT.	PART NUMBER	DESCRIPTION	MATERIAL
10	2	2	4		FLAT WASHERS NAS 620-C4L (OR EQUIV.)	300 SSSL
9	2	2	4		SST VENTED SOCKET HEAD CAP SCREW #4-40 UNC-3A X 0.625 LONG	Aq 300 SST
8	4	4	8		SST SOCKET HEAD CAP SCREW #4-40 UNC-3A X 0.875 LONG	300 SSSL
7	4	4	8		FLAT WASHERS NAS 620-5L (OR EQUIV.)	300 SSSL
6	1	1	2	D030712	COIL FORMER CLAMP ONEPIECE_ALT	6061-T6-AI
5	2	2	4	D030123	SPACER FOR COIL FORMER BRACKET	TEFLON
4	1	1	2	D030105	ASSEMBLY COIL HEAD	
3	2	2	4	D030122	SHOULDER FOR COIL FORMER BRACKET	MACOR
2	4	4	8		SST SOCKET HEAD CAP SCREW #4-40 UNC-3A X 1 LONG	300 SSSL
1	1	1	2	D030703	COIL FORMER BRACKET	6061-T6 AI

**PARTS LIST**

NOTES: (UNLESS OTHERWISE SPECIFIED)

- DIMENSIONS IN INCHES.
- REMOVE ALL SHARP EDGES, R.02 MIN.
- ALL MACHINING FLUIDS SHALL BE WATER SOLUBLE AND FREE OF SULFUR, CHLORINE AND SILICONE, SUCH AS CINCINNATI MILACRON'S CIMTECH 410 (STAINLESS STEEL).
- ASSEMBLE ACCORDING TO HYBRID OSEM ASSEMBLY SPECIFICATION, LIGO E030084-00-D.
- ADDITIONAL ISOLATION OF THE COIL HEAD ASSEMBLY, D030105, SUPPLIED BY A COMBINATION OF D030122, D030123, D030124 SHOULD BE USED AS REQUIRED.

DIMENSIONS ARE IN INCHES	
TOLERANCES:	
.XX ±	
.XXX ±	
ANGULAR ±	
MATERIAL	
FINISH	μ inch
	NAME DATE
DRAWN	
CHECKED	
APPROVED	

**LIGO** CALIFORNIA INSTITUTE OF TECHNOLOGY  
 MASSACHUSETTS INSTITUTE OF TECHNOLOGY  
 IGR, GLASGOW UNIVERSITY GEO 600 GROUP

SYSTEM ADVANCED LIGO  
 SUB-SYSTEM SUSPENSIONS  
 NEXT ASSY ETM UPPER STRUCTURE

PART NAME  
 ASSEMBLY COIL FORMER AND ASSOCIATED PARTS

SIZE DWG. NO. REV.  
 B D040170 A

SCALE: NTS PROJECTION: SHEET 2 OF 2