

REV.	DATE	DCN #	DRAWING TREE #
A	9/03	E030462/INITIAL RELEASE	

NOTES: (UNLESS OTHERWISE SPECIFIED)

1. DIMENSIONS IN INCHES.
2. BREAK ALL SHARP EDGES.
3. ALL MACHINING FLUIDS SHALL BE WATER SOLUBLE AND FREE OF SULFUR, CHLORINE AND SILICONE, SUCH AS CINCINNATI MILACRON'S CIMTECH 410 (FOR STAINLESS STEEL.)

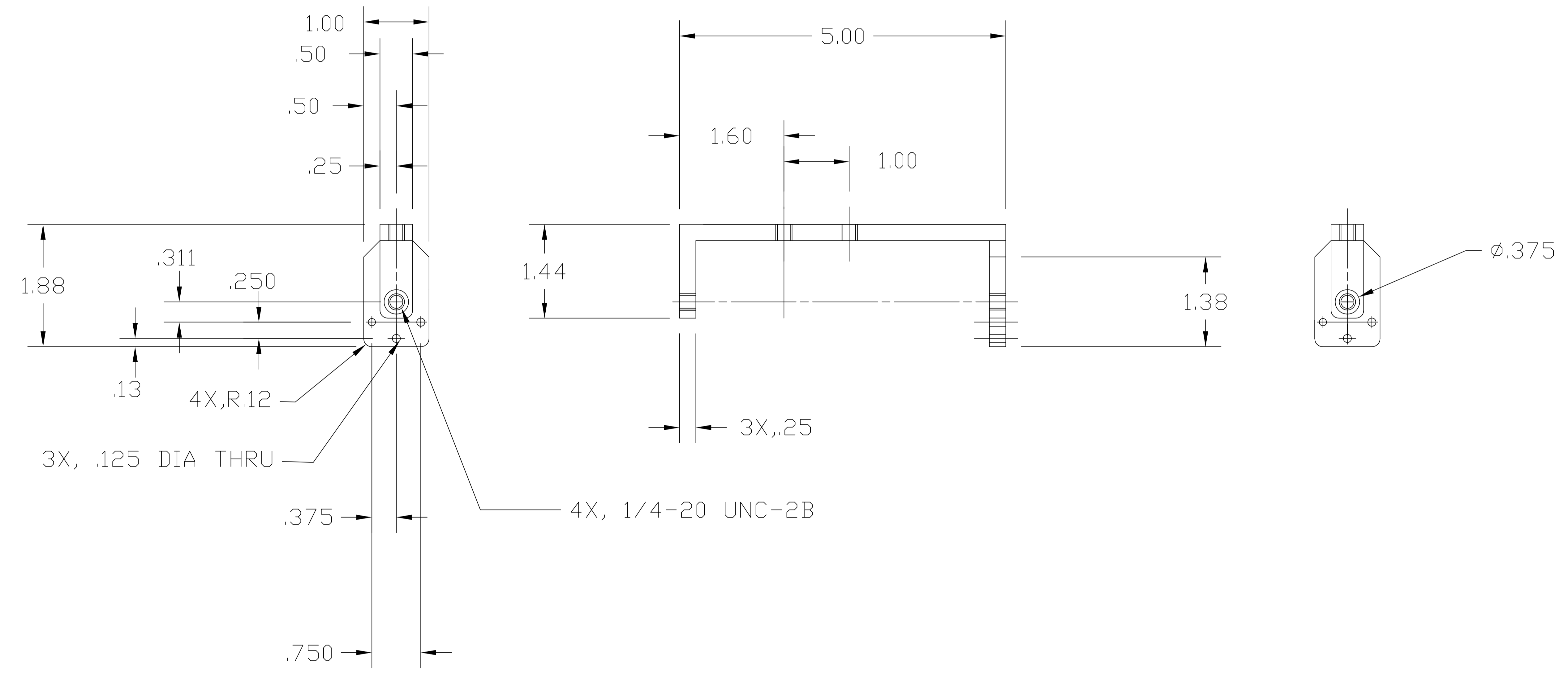

ITEM NO.	REQ.	SPARE	TOT.	PART NUMBER	DESCRIPTION	SUPPLIER
PARTS LIST						
UNLESS OTHERWISE SPECIFIED: DIMENSIONS ARE IN INCHES				DRAWN	DATE	NAME
TOLERANCES: .XX±: .01 .XXX±: .005 ANGULAR:±				CHECKED	3/03	J. ROMIE
MATERIAL 6061-T6 ALUM				LIGO CALIFORNIA INSTITUTE OF TECHNOLOGY MASSACHUSETTS INSTITUTE OF TECHNOLOGY SYSTEM GIN GIN SUB-SYSTEM GIN GIN SUS NEXT ASSY GIN GIN ETM SUS PART NAME TOP BRACKET		
FINISH						
COMMENTS:				SIZE	DWG. NO.	REV
				B	D030142	A
SCALE:					SHEET 1 OF 1	