

NOTES: (UNLESS OTHERWISE SPECIFIED)

1. DIMENSIONS IN INCHES.
2. BREAK ALL SHARP EDGES.
3. ALL MACHINING FLUIDS SHALL BE WATER SOLUBLE AND FREE OF SULFUR, CHLORINE AND SILICONE, SUCH AS CINCINNATI MILACRON'S CIMTECH 410 (STAINLESS STEEL.)

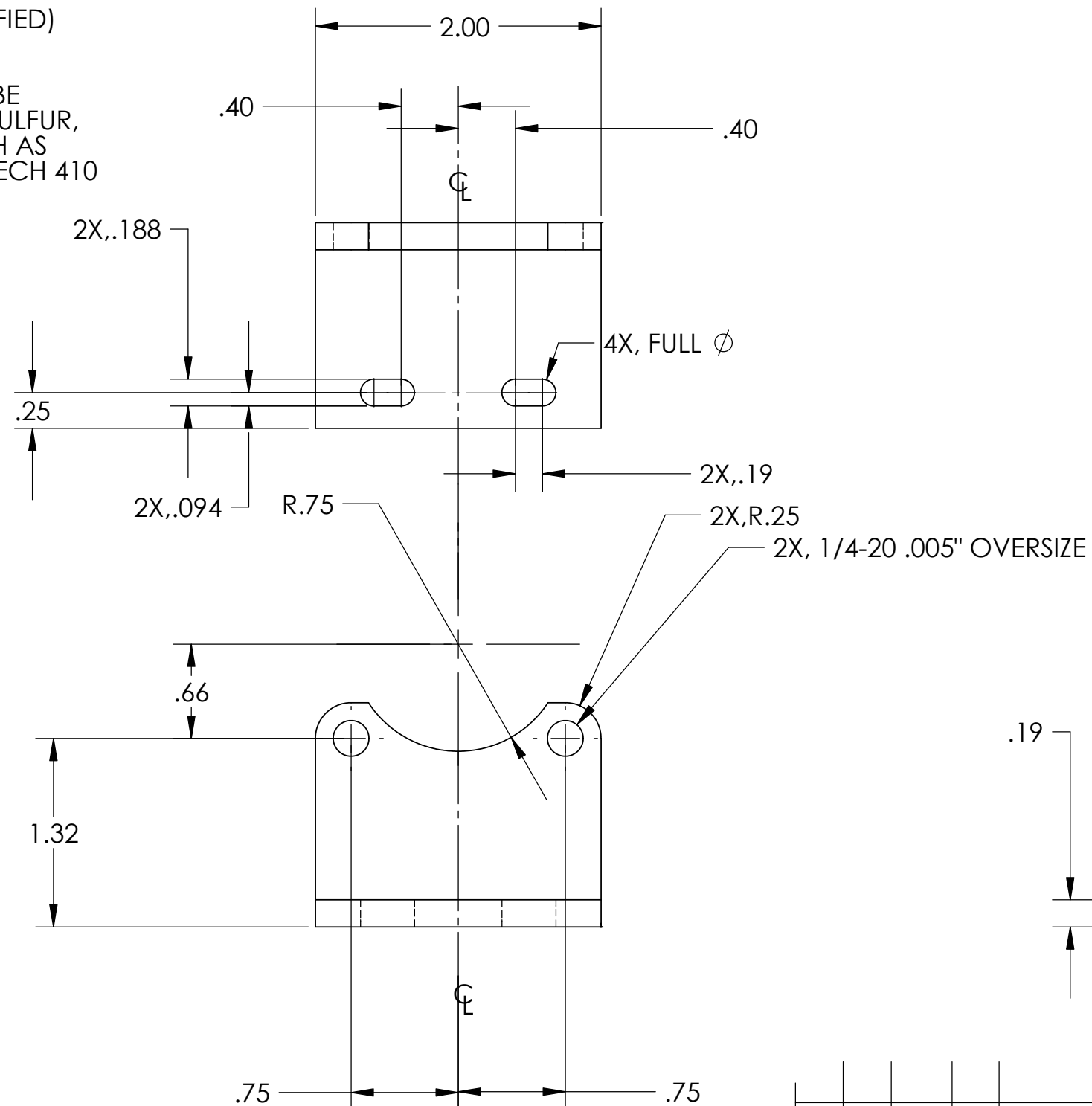

REV.	DATE	DCN #	DRAWING TREE #
A	7/04	E040303-00	E030507-A



D030016_Face_Bracket_3.step

ITEM NO.	REQ.	SPARE	TOT.	PART NUMBER	DESCRIPTION	SUPPLIER	
PARTS LIST							
UNLESS OTHERWISE SPECIFIED: DIMENSIONS ARE IN INCHES				DATE	NAME	CALIFORNIA INSTITUTE OF TECHNOLOGY MASSACHUSETTS INSTITUTE OF TECHNOLOGY	
TOLERANCES: .XX ±:0.01 .XXX ±:0.005 ANGULAR: ±0.5 DEG				DRAWN	1/03		J.ROMIE
MATERIAL				CHECKED			
FINISH							
ALUM 6061-T6				COMMENTS:		SYSTEM: ADVANCED LIGO SUB-SYSTEM: SUSPENSIONS NEXT ASSY: MODE CLEANER SUSPENSION PART NAME: FACE BRACKET 3	
NONE				SIZE	DWG. NO.	REV	
				B	D030016	A	
				SCALE: 1/1	SHEET 1 OF 1		