

NOTES: (UNLESS OTHERWISE SPECIFIED)
 1. DIMENSIONS IN INCHES.
 2. BREAK ALL SHARP EDGES.
 3. ALL MACHINING FLUIDS SHALL BE WATER SOLUBLE AND FREE OF SULFUR, CHLORINE AND SILICONE, SUCH AS CINCINNATI MILACRON'S CIMTECH 410 (STAINLESS STEEL.)

REV.	DATE	DCN #	DRAWING TREE #
A	7/04	E040303-00	E030507-A

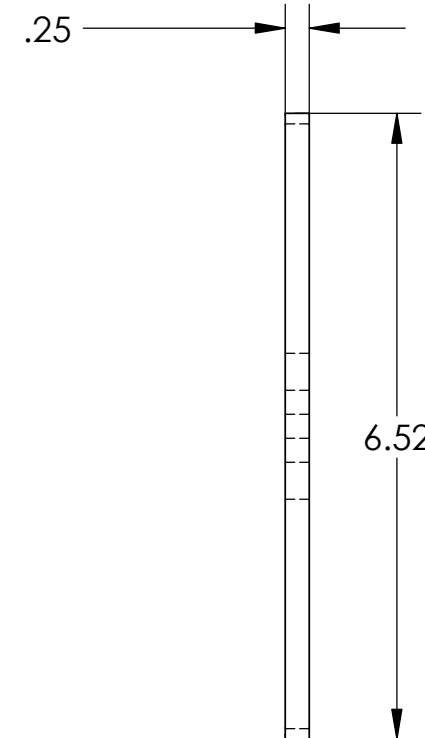

D020522_Crossbar_Bracket.step

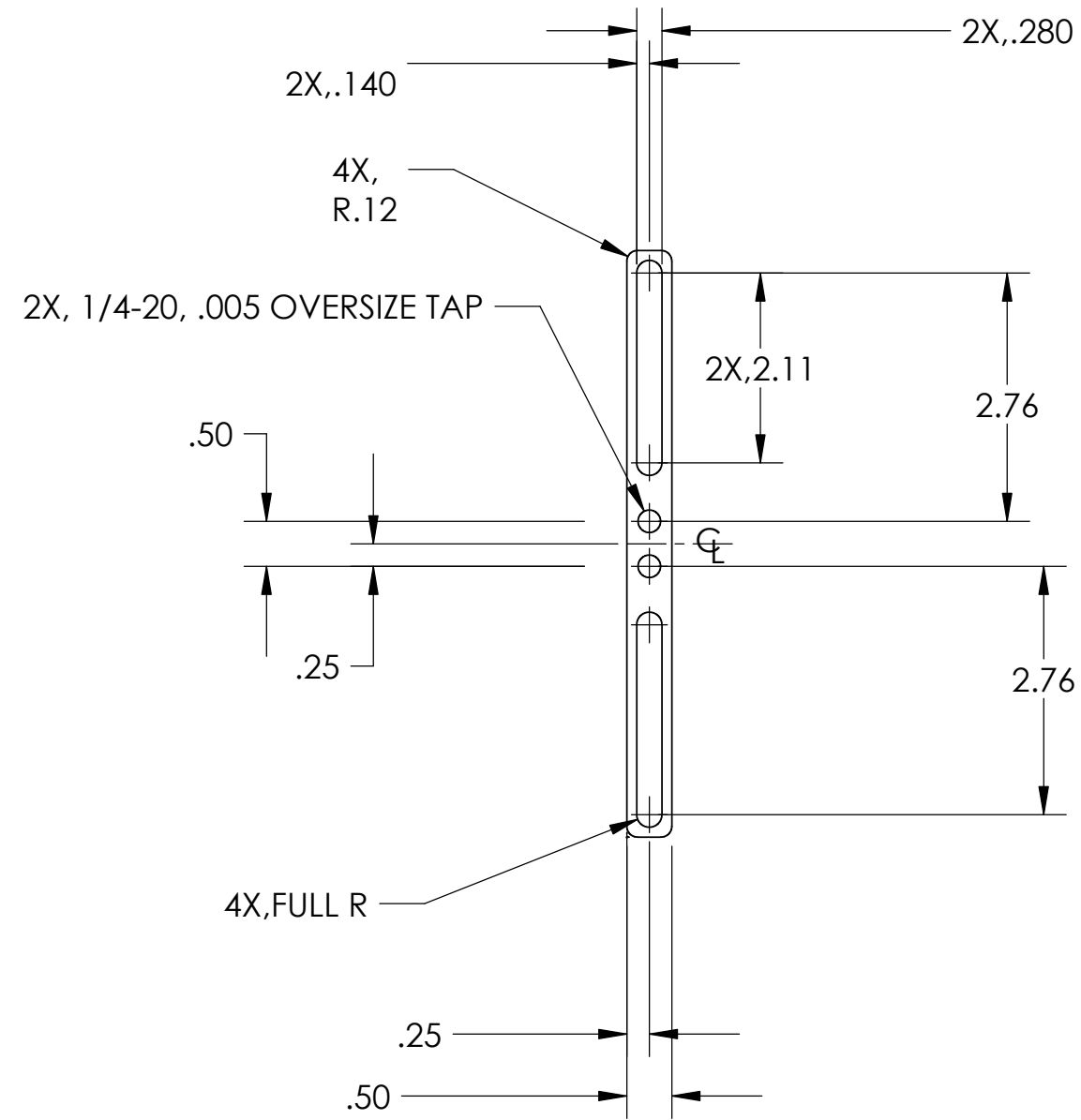

ITEM NO.	REQ.	SPARE	TOT.	PART NUMBER	DESCRIPTION	SUPPLIER
PARTS LIST						
UNLESS OTHERWISE SPECIFIED:				DATE	NAME	CALIFORNIA INSTITUTE OF TECHNOLOGY MASSACHUSETTS INSTITUTE OF TECHNOLOGY
DIMENSIONS ARE IN INCHES				DRAWN	12/02	
TOLERANCES:				CHECKED		SYSTEM
.XX ±:0.01						SUB-SYSTEM
.XXX ±:0.005						NEXT ASSY
ANGULAR: ±0.5 DEG						PART NAME
MATERIAL				COMMENTS:		
ALUM 6061-T6				SIZE		
FINISH				DWG. NO.		REV
NONE				D020522		A
				SCALE: 1/1		SHEET 1 OF 1