

NOTES: (UNLESS OTHERWISE SPECIFIED)

1. DIMENSIONS IN INCHES.
2. BREAK ALL SHARP EDGES.
3. ALL MACHINING FLUIDS SHALL BE WATER SOLUBLE AND FREE OF SULFUR, CHLORINE AND SILICONE, SUCH AS CINCINNATI MILACRON'S CIMTECH 410 (FOR STAINLESS STEEL.)

| REV. | DATE | DCN # | DRAWING TREE # |
|------|-------|-------------------------|----------------|
| A | 11/02 | E020998/INITIAL RELEASE | |
| | | | |
| | | | |

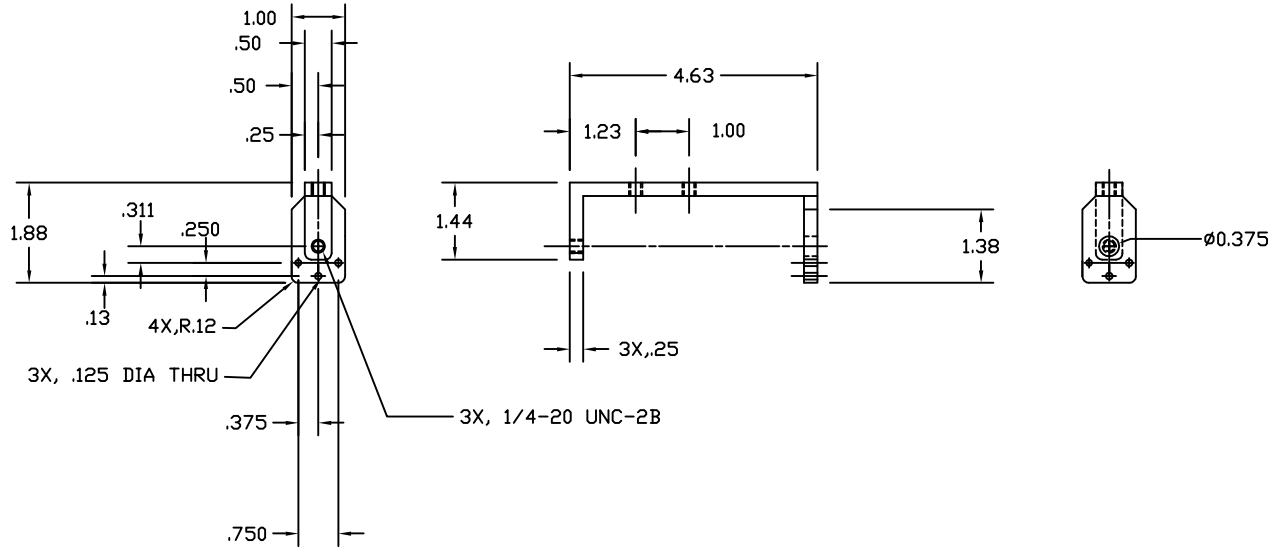

| ITEM NO. | REQ. QUANTITY | SPARE | TOT. | PART NUMBER | DESCRIPTION | SUPPLIER |
|--|---------------|-------|------|--|-------------|--------------|
| UNLESS OTHERWISE SPECIFIED: DIMENSIONS ARE IN INCHES | | | | | | |
| TOLERANCES: XX± .01 XXX± .005 ANGULAR± | | | | DATE NAME 11/02 J. ROMIE | | |
| MATERIAL 6061-T6 ALUM | | | | PARTS LIST LIGO CALIFORNIA INSTITUTE OF TECHNOLOGY MASSACHUSETTS INSTITUTE OF TECHNOLOGY | | |
| FINISH | | | | SYSTEM 40 METER SUB-SYSTEM 40M TEST MASS SUS NEXT ASSY 40M TEST MASS SUS PART NAME 40m TM TOP BRACKET | | |
| | | | | SIZE DWG. NO. B D020521 | | REV A |
| | | | | SCALE: | | SHEET 1 OF 1 |