

| REV. | DATE        | DCN #    | DRAWING TREE # |
|------|-------------|----------|----------------|
| v1   | 24 Mar 2011 | E1100015 | E1100016       |
|      |             |          |                |
|      |             |          |                |

NOTES CONTINUED:

- 4. ALL MACHINING FLUIDS MUST BE FULLY SYNTHETIC, FULLY WATER SOLUBLE AND FREE OF SULFUR, SILICONE AND CHLORINE.
- 5. SCRIBE, ENGRAVE, OR MECHANICALLY STAMP (NO INKS OR DYES) DRAWING PART NUMBER, REVISION (AND VARIANT OR "TYPE" IF APPLICABLE ON NOTED SURFACE OF PART FOLLOWED ON THE NEXT LINE WITH A THREE DIGIT SERIAL NUMBER. SERIAL NUMBERS START AT 001 FOR THE FIRST ARTICLE AND PROCEED CONSECUTIVELY. USE MINIMUM 0.12 HIGH CHARACTERS, UNLESS THE SIZE OF THE PART DICTATES SMALLER CHARACTERS. A VIBRATORY TOOL MAY BE USED. EXAMPLE DXXXXXXX-VY, TYPE-XX, S/N XXX.
- 6. APPROXIMATE WEIGHT = 3.94555199 LB.
- 7. ALL PARTS SHALL BE MANUFACTURED IN ACCORDANCE WITH LIGO SPECIFICATION E0900364.
- 8. PAINT: ALL VISIBLE SURFACES (exclude fastening hardware) EXCEPT AREAS IDENTIFIED BY M MEDIUM BLUE SHERWIN WILLIAMS (POLANE (R) T-PLUS POLYURETHANE ENAMEL) #SW-F63TX-L-2822-5864 PRIME WITH SHERWIN WILLIAMS INDUSTRIAL WASH PRIMER P60G2
- 9. "OXI SOLV RUST INHIBITOR" TO BE APPLIED PER MFG. INSTRUCTIONS TO ALL UNPAINTED SURFACES. BOTH TAPPED AND THRU HOLES WILL BE PLUGGED DURING APPLICATION.

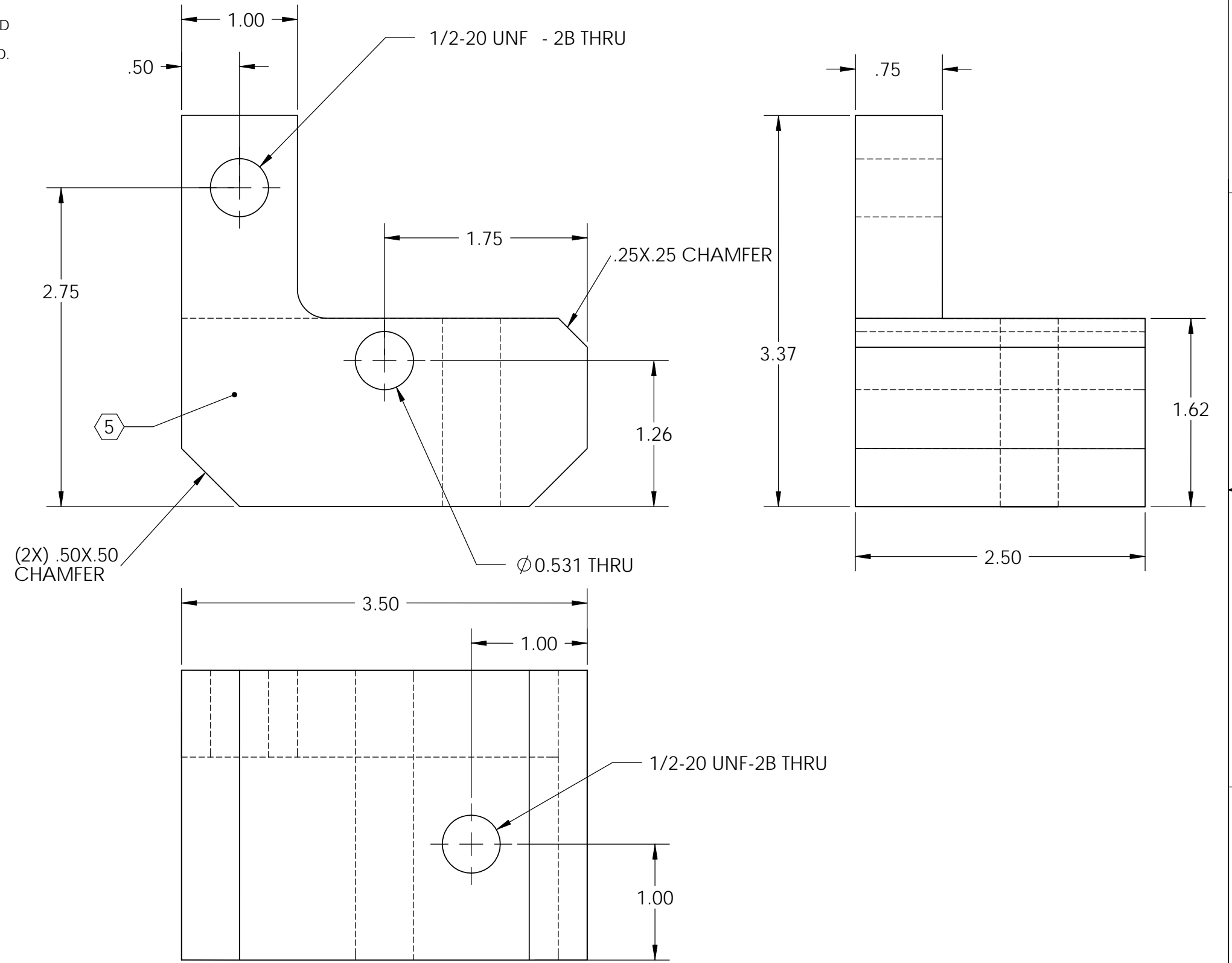

| NOTES AND TOLERANCES: (UNLESS OTHERWISE SPECIFIED) |  |  |  | LIGO CALIFORNIA INSTITUTE OF TECHNOLOGY MASSACHUSETTS INSTITUTE OF TECHNOLOGY |  |  |  | PART NAME                            |  |  |  |
|--|--|--|--|---|--|--|--|--------------------------------------|--|--|--|
| DIMENSIONS ARE IN INCHES                           |  |  |  | 1. INTERPRET DRAWING PER ASME Y14.5-1994.                                     |  |  |  | OFFSET CLAMP LEFT, aLIGO HEPI        |  |  |  |
| TOLERANCES:<br>.XX ± .015<br>.XXX ± .005           |  |  |  | 2. REMOVE ALL SHARP EDGES, .03 x 45°.   |  |  |  | DESIGNER K.MASON 29 May 2002         |  |  |  |
| ANGULAR ± .5°                                      |  |  |  | 3. DO NOT SCALE FROM DRAWING.   |  |  |  | DRAFTER M.HILLARD 24 Mar. 2011       |  |  |  |
| MATERIAL AISI 1018 Steel, Cold Rolled              |  |  |  | FINISH 63 μinch   |  |  |  | NEXT ASSY D030438                    |  |  |  |
|  |  |  |  |   |  |  |  | CHECKER K.MASON 29 May 2002          |  |  |  |
|  |  |  |  |   |  |  |  | APPROVAL K.MASON 24 Mar 2011         |  |  |  |
|  |  |  |  |   |  |  |  | SCALE: 1:1 PROJECTION:  SHEET 1 OF 1 |  |  |  |

D020453, PART PDM REV: X-003, DRAWING PDM REV: X-001