

NOTES: (UNLESS OTHERWISE SPECIFIED)

- 1. X
- 2. X

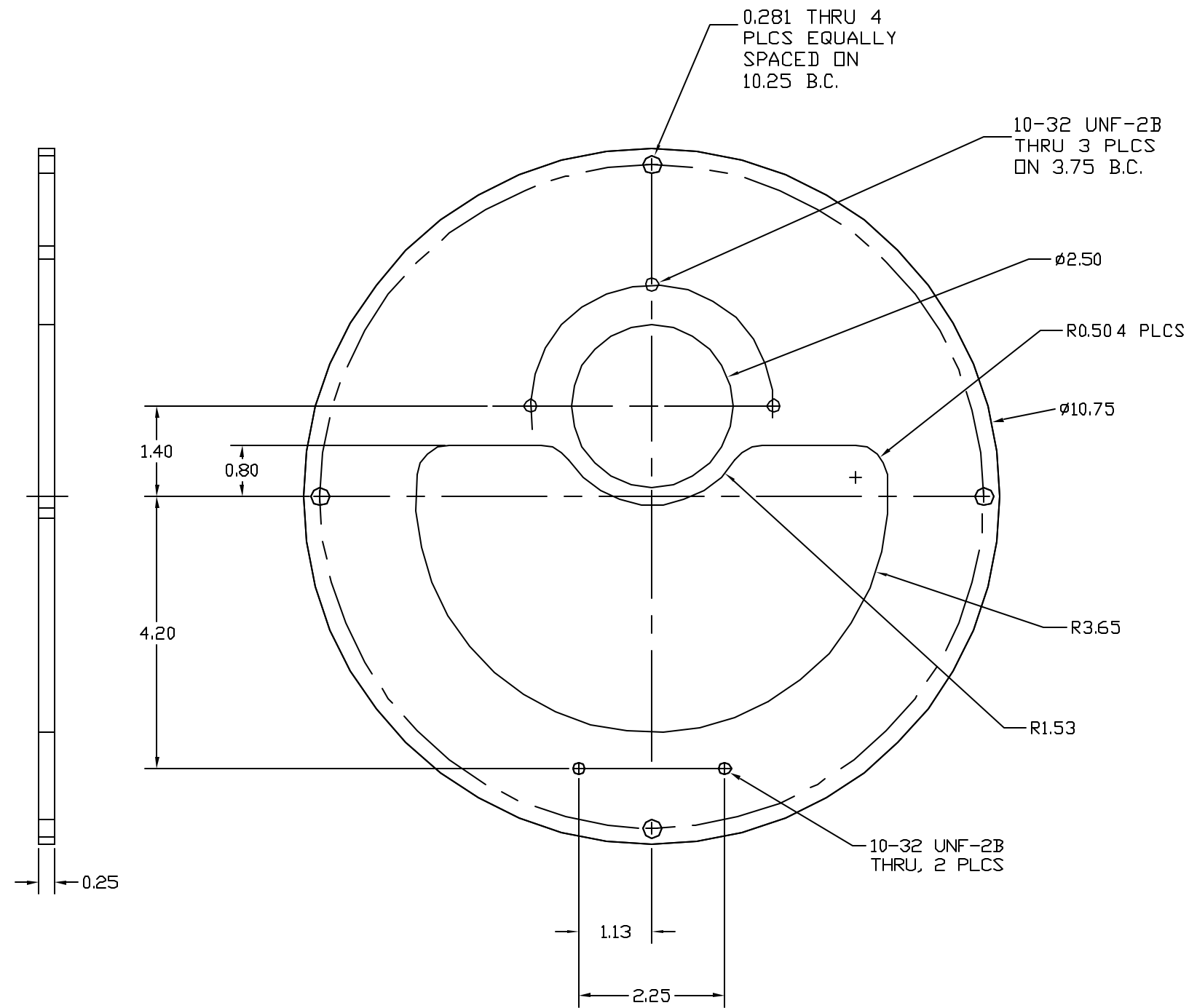

REF	QTY	PART or DRWG No.	DESCRIPTION	MATERIAL
PARTS and MATERIAL LIST				

UNLESS OTHERWISE SPECIFIED  
DIMENSIONS ARE IN INCHES

TOLERANCES:  
FRACTIONAL ± 1/32  
ANGULAR ± 1 DEG  
ANGULAR MATCH ± BEND ±  
TWO PLACE DECIMAL ± 0.01

THREE PLACE DECIMAL ± 0.005  
FINISHED SURFACE RMS: 63  
BREAK CORNERS AND EDGES  
REMOVE ALL BURRS

MATERIAL: ALUM 6061 T6	HEAT TREAT:	FINISH: BLACK ANODIZE
USED ON: XXX	NEXT ASSY: XXX	

REV	DESCRIPTION	DCN NUMBER	APPR'D	CHECK	DRWN	DATE
01	ENLARGED SIZE/SHAPE, ADDED HINGE HOLES	-	-	-	JONES	12/16/02
00	PRE-RELEASE	-	-	-	SMITH	3/5/02

<b>LIGO</b> CALIFORNIA INSTITUTE OF TECHNOLOGY MASSACHUSETTS INSTITUTE OF TECHNOLOGY	
TOP PLATE INLINE ILLUMINATOR 40 M	
CAD FILE: ILLUMINATOR_ASSY	SIZE/DRWG NO.: B D020100-02
SCALE: NTS	SHEET: 1 OF 1

XXX	XXX	REFERENCE DRAWINGS
DRWG NO.	DESCRIPTION	