

1

2

3

4

NOTES: (UNLESS OTHERWISE SPECIFIED)

- 1. DIMENSIONS IN INCHES.
- 2. BREAK ALL SHARP EDGES.
- 3. ALL MACHINING FLUIDS SHALL BE WATER SOLUABLE AND FREE OF SULFUR, CHLORINE AND SILICONE, SUCH AS CINCINNATI MILACRON'S CIMTECH 410 (STAINLESS STEEL.)
- 4. ETCH OR STAMP THE DRAWING PART NUMBER ON NOTED SURFACE OF PART AND THEN A THREE DIGIT SERIAL NUMBER. SERIAL NUMBERS START AT 001 FOR THE FIRST PART AND PROCEED CONSEQUETIVELY. USE .07" HIGH CHARACTERS. EXAMPLE: D010169-A 001

REV	DATE	DRAWN BY	CHECKED	DCC	DCN/DESCRIPTION
A	9/4/01	J. Romie			E010162/INITIAL RELEASE
B	2/11/02	J. Romie			E020250/ADD 1.04 DIMENSION

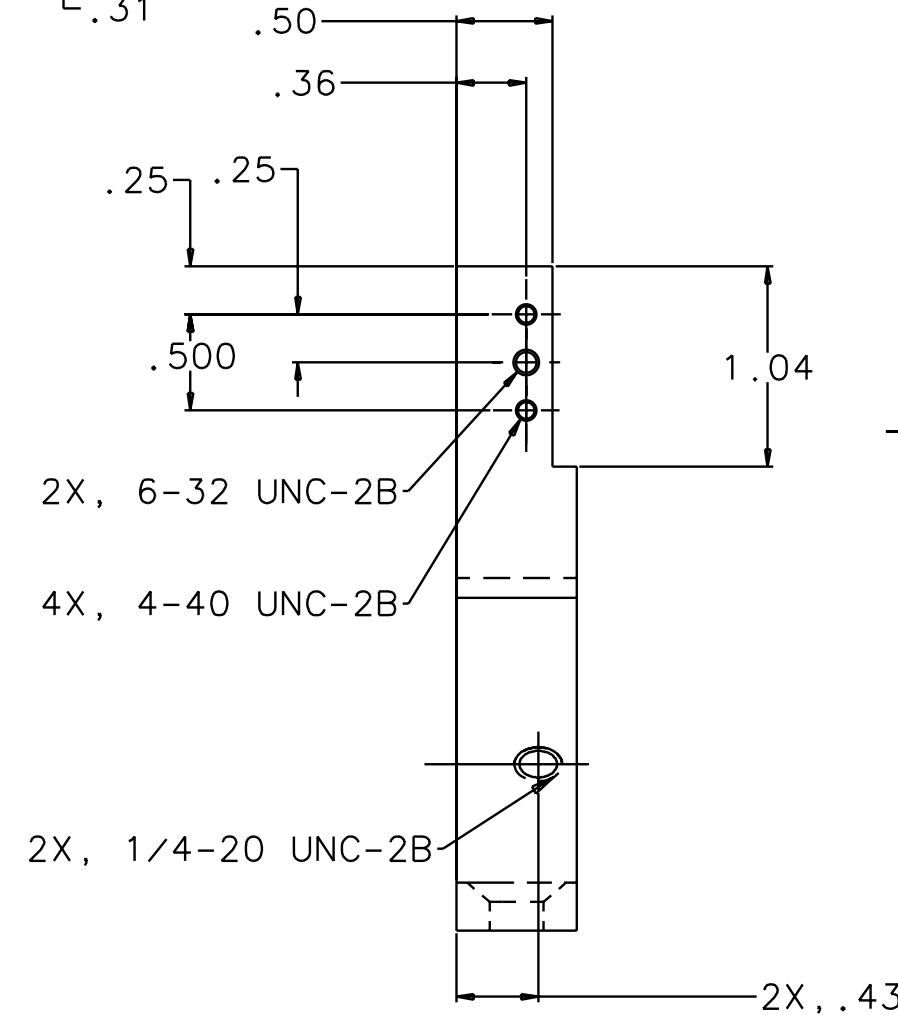
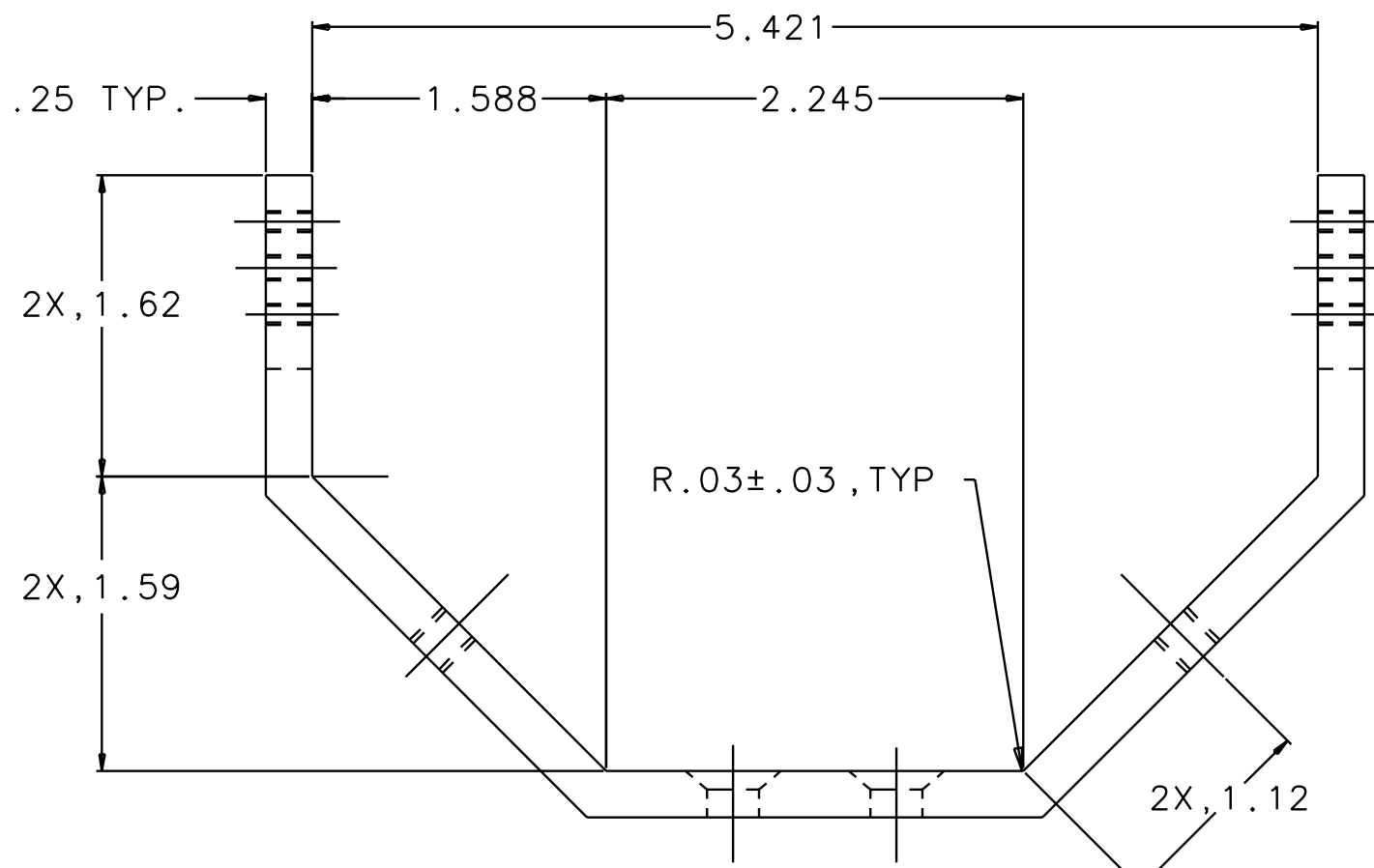
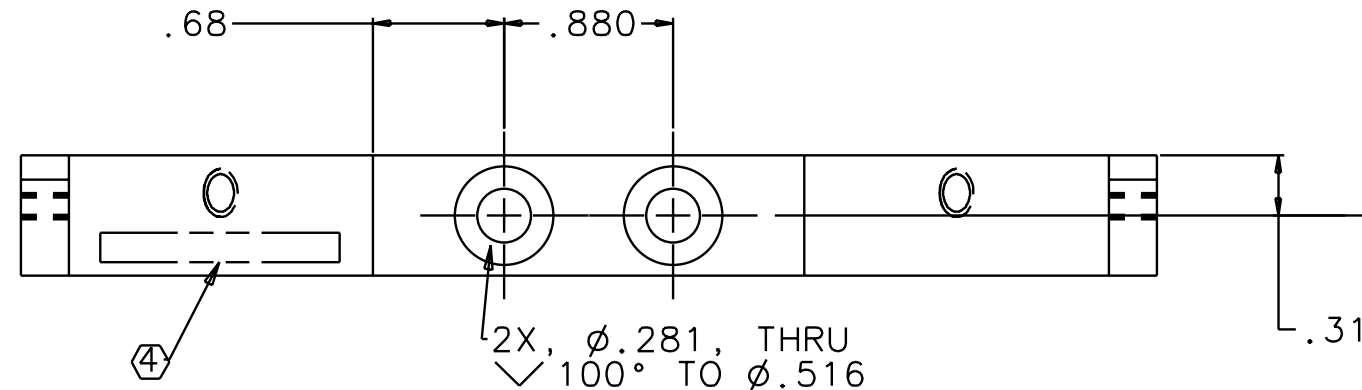

QTY REQD	FSCM NO	PART OR IDENTIFYING NO	NOMENCLATURE OR DESCRIPTION	MATERIAL SPECIFICATION	ITEM NO
PARTS LIST					
UNLESS OTHERWISE SPECIFIED DIMENSIONS ARE IN INCHES TOLERANCES ARE:			APPROVALS	DATE	LIGO CALIFORNIA INSTITUTE OF TECHNOLOGY MASSACHUSETTS INSTITUTE OF TECHNOLOGY
FRACTIONS DECIMALS			J. ROMIE	8/01	
0.XX=±0.01			CHECKED		TITLE
0.XXX=±0.005					40m TM CRADLE
ANGLES=±0.5°					DWG NO.
DO NOT SCALE DRAWING					D010169
NEXT ASSEMBLY			MATERIAL		REV
D010163			ALUM. 6061-T6		B
FILE LOCATION			FINISH		SCALE
/home/dcc/docs/D010169.pdf					1/1
					SHEET 1 OF 1

1

2

3

4