

NOTES: (UNLESS OTHERWISE SPECIFIED)
 Liquids containing hydrocarbons or other contaminants, other than the machining fluids specified herein, shall not be allowed to come into contact with suspension material at any time. All machining fluids shall be water soluble and free of sulfur, chlorine and silicone such as Cincinnati Milacron's Cintech 410 (stainless steel).

Identification, Serial Number
 A serial number shall be etched, or scribed on the part see note drawing note.
Serial Number Format:
 The Serial number shall be of the format: D99xxxxx-
Example: D990021-A-001
 The drawing number, The revision number, The sequential part number

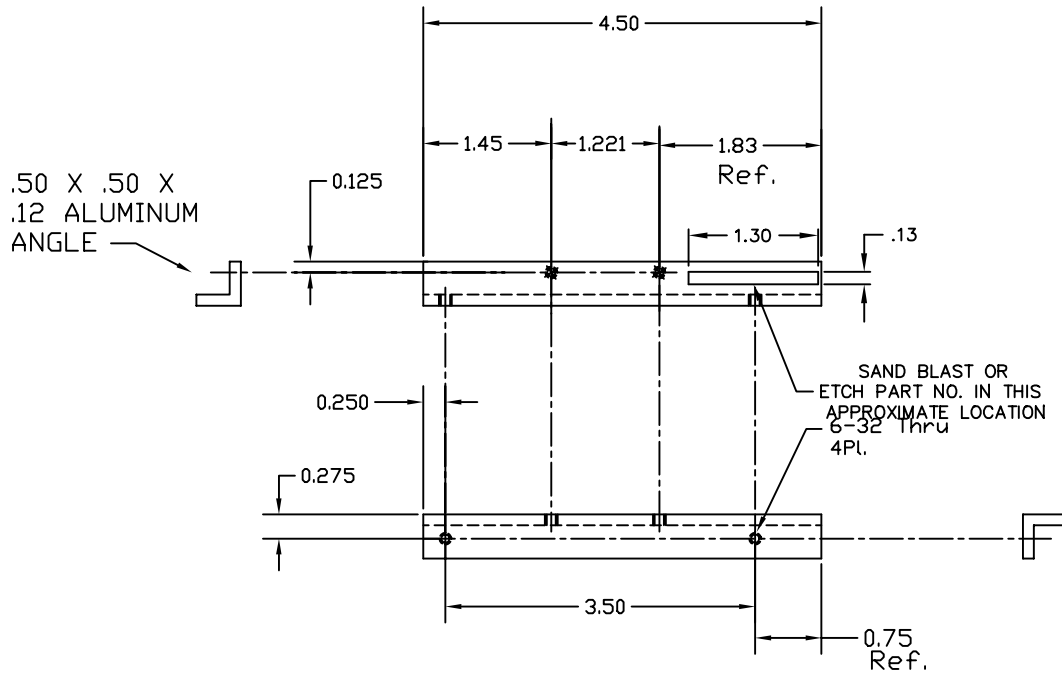

RIGHT HAND
TOP ANGLE
HAM2/3/9

REF. MAKE 1 PER ASSEMBLY

REF	QTY	PART or DRWG No.	DESCRIPTION	MATERIAL
A		LIGD-E000206-00-D	RIGHT HAND TOP ANGLE HAM2/3/9	ALUMINUM
00				
REV				

UNLESS OTHERWISE SPECIFIED DIMENSIONS ARE IN INCHES	
TOLERANCES: FRACTIONAL ± 1/16 ANGULAR ± .25° ANGULAR/ROUNDER → BEND → TVD PLACE DECIMAL ± .01	THREE PLACE DECIMAL ± .006 FINISHED SURFACE RMS 63 BREAK CORNERS DR .015 DUTY .015 REMOVE ALL BURRS
MATERIAL: ALUMINUM	HEAT TREAT: -
USED DR: XXX	NEXT ASS'Y: XXX

REV	DESCRIPTION	DRW	DATE	SCALE	SHEET
A	REV-RELEASE		4/19/00	1:1	1 OF 1
00	PRE-RELEASE		4/19/00		
REV	DESCRIPTION	DRW	DATE	SCALE	SHEET
				1:1	1 OF 1