

D1002303 DOWEL INSTALLATION BUSHING, .38 DIA, aLIGO BSC ISI, PART PDM REV: X-003, DRAWING PDM REV: X-005

NOTES CONTINUED:

- ⑤ SCRIBE, ENGRAVE, OR MECHANICALLY STAMP (NO INKS OR DYES) DRAWING PART NUMBER, REVISION (AND VARIANT OR "TYPE" IF APPLICABLE ON NOTED SURFACE OF PART FOLLOWED ON THE NEXT LINE WITH A THREE DIGIT SERIAL NUMBER. SERIAL NUMBERS START AT 001 FOR THE FIRST ARTICLE AND PROCEED CONSECUTIVELY. USE MINIMUM 0.12 HIGH CHARACTERS, UNLESS THE SIZE OF THE PART DICTATES SMALLER CHARACTERS. A VIBRATORY TOOL MAY BE USED.
EXAMPLE DXXXXXX-VY, TYPE-XX, S/N XXX.
- 6. APPROXIMATE WEIGHT = 0.7 LB.
- 7. MACHINE ALL SURFACES TO REMOVE OXIDES AND MILL FINISH, USE OF ABRASIVE REMOVAL TECHNIQUES (INCLUDING SANDING OR SCOURING FOR MATTE FINISH) IS NOT ALLOWED.
- 8. ALL PARTS SHALL BE MANUFACTURED IN ACCORDANCE WITH LIGO SPECIFICATION E0900364.

| REV. | DATE | DCN # | DRAWING TREE # |
|------|--------------|----------|----------------|
| v1 | 30 Aug 2010 | E1000373 | - |
| v2 | 09 Nov. 2010 | E1000685 | - |
| v3 | 08 Feb. 2011 | E1100087 | - |

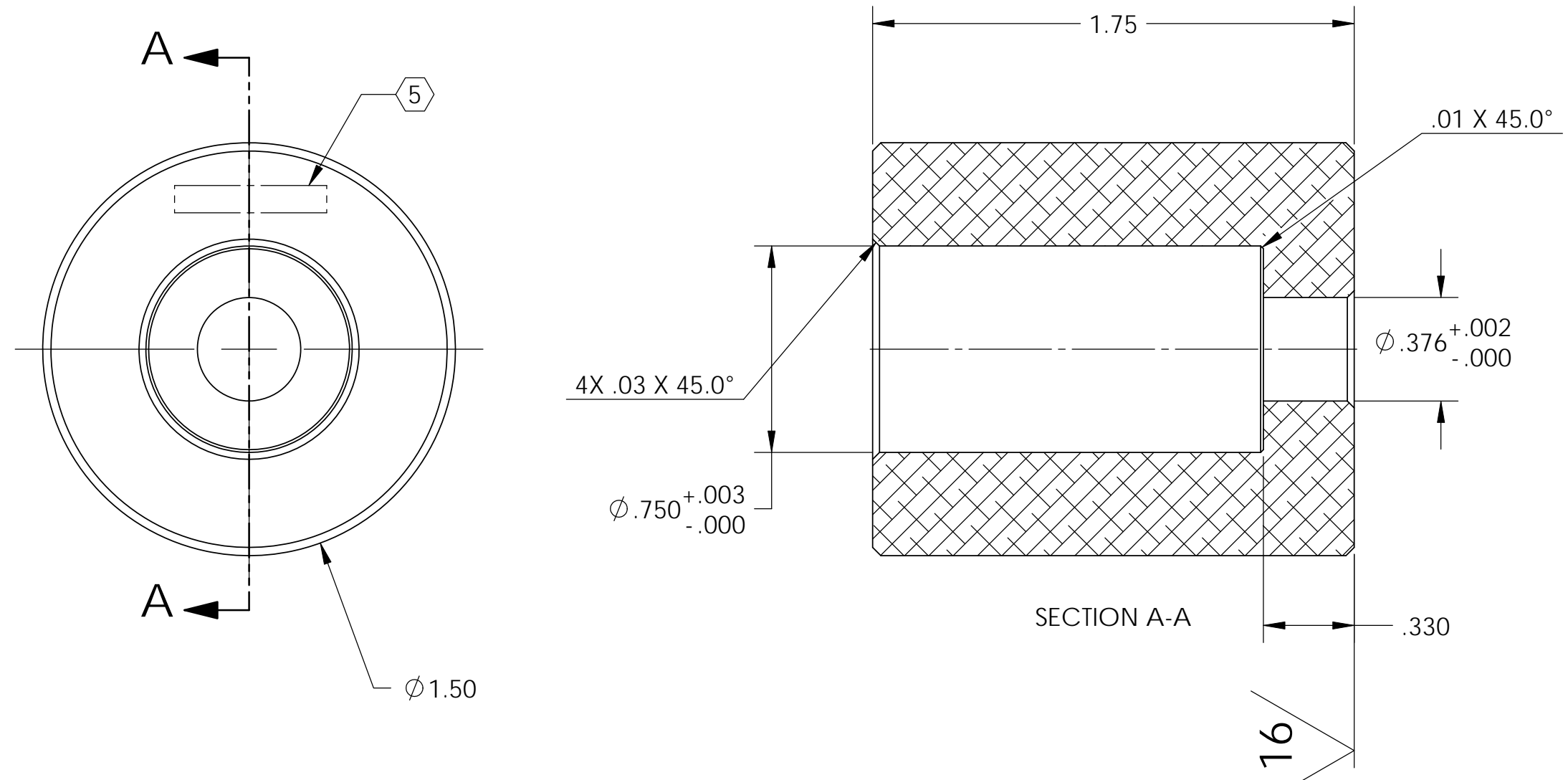

| NOTES AND TOLERANCES: (UNLESS OTHERWISE SPECIFIED) | | | | LIGO CALIFORNIA INSTITUTE OF TECHNOLOGY MASSACHUSETTS INSTITUTE OF TECHNOLOGY | | PART NAME | | | | | | |
|--|--|--|--|---|--|--------------------------|--|--|-------------|------------------|-----------------------------|-------------------|
| DIMENSIONS ARE IN INCHES | | 1. INTERPRET DRAWING PER ASME Y14.5-1994. 2. REMOVE ALL SHARP EDGES, R.02 MIN. 3. DO NOT SCALE FROM DRAWING. 4. ALL MACHINING FLUIDS MUST BE FULLY SYNTHETIC, FULLY WATER SOLUBLE AND FREE OF SULFUR, SILICONE, AND CHLORINE. | | SYSTEM ADVANCED LIGO | | SUB-SYSTEM SEI | | DOWEL INSTALLATION BUSHING, 3/8 DIA. aLIGO BSC ISI | | | | |
| TOLERANCES: .XX ± .015 .XXX ± .005 | | MATERIAL 304 SSTL | | FINISH 32 μinch | | NEXT ASSY | | DESIGNER M.HILLARD | 27 Aug 2010 | SIZE B | DWG. NO. D1002303 | REV. v3 |
| ANGULAR ± .5° | | | | | | CHECKER F.MATICHERD | | 30 Aug 2010 | SCALE: 2:1 | | PROJECTION: | SHEET 1 OF 1 |
| | | | | | | APPROVAL K.MASON | | 30 Aug 2010 | | | | |