

8 7 6 5 4 3 2 1

NOTES CONTINUED:

REV.	DATE	DCN #	DRAWING TREE #
v1	21/10/2010	-	-
v2	23/11/2010	-	-
-	-	-	-

D  
C  
B  
A

D  
C  
B  
A

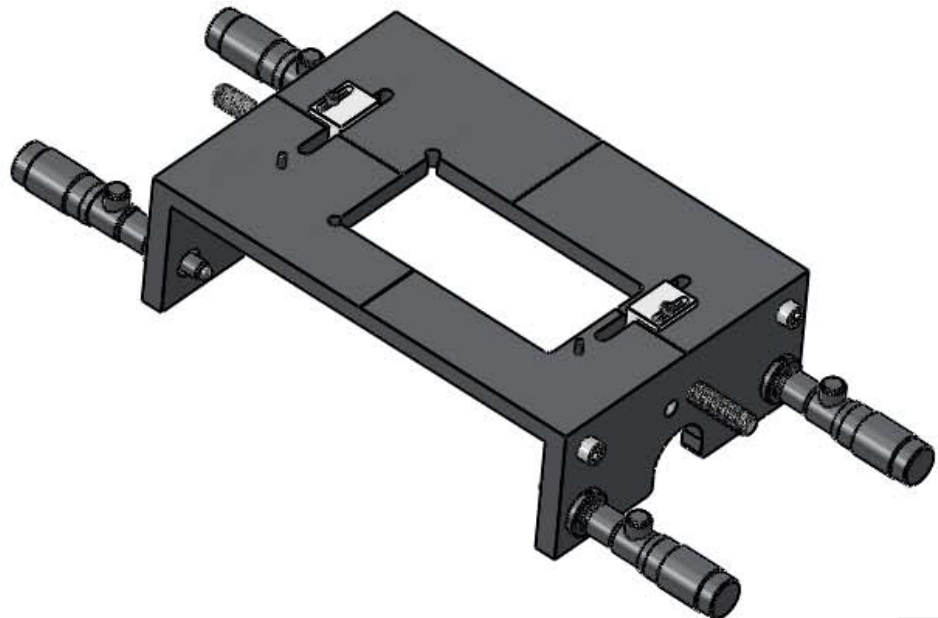
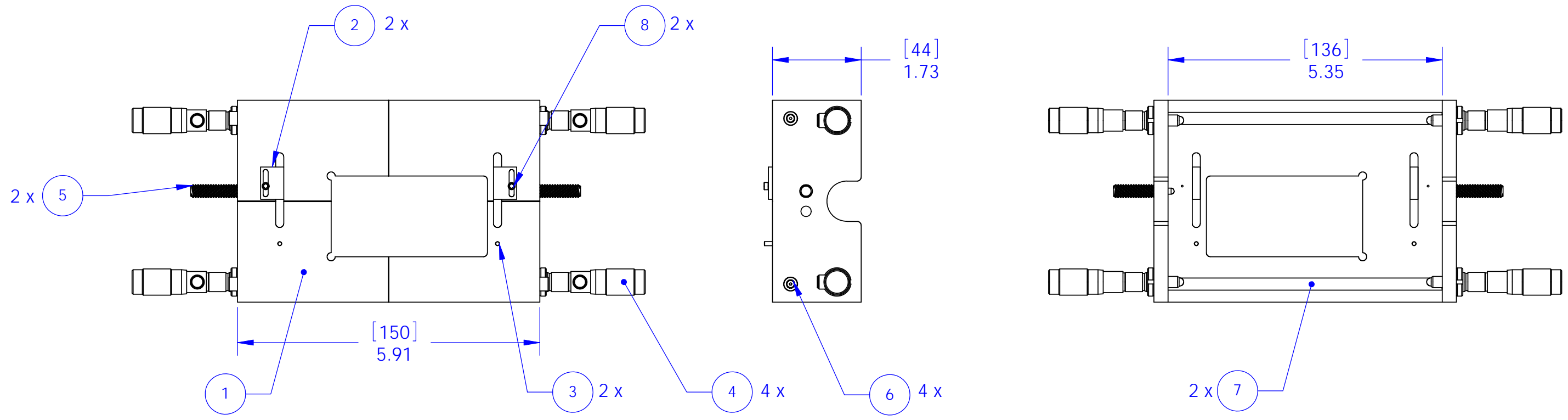

ITEM NO.	PART NUMBER	DESCRIPTION	QTY.
1	D1002203	aLIGO ERM PRISM BONDING BASEPLATE	1
2	D1002143	aLIGO TCP Prism bonding alignment guide	2
3	91585A018	DOWEL PIN, $\phi$ 2 mm x 10 LONG (McMASTER-CARR P/N)	2
4	Newport-HR-13	LOCKABLE MICROMETER (NEWPORT CORPORATION)	4
5	8688A151	316 SS Round-Nose Spring Plunger Std L, 1/4"-20	2
6	92200A196	Socket Head Cap Screw, 8-32 x 5/8", 300 Series SS	4
7	D1002288	aLIGO ERM Prism bonding support cylinder	2
8	92185A078	Socket Head Cap Screw 2-56 x 5/16", 300 Series SS	2

**NOTES AND TOLERANCES: (UNLESS OTHERWISE SPECIFIED)**

DIMENSIONS ARE IN N/A  
 TOLERANCES:  
 .XX ± N/A  
 .XXX ± N/A  
 ANGULAR ± N/A\*

1. INTERPRET DRAWING PER ASME Y14.5-1994.  
 2. REMOVE ALL SHARP EDGES, R.5 MIN.  
 3. DO NOT SCALE FROM DRAWING.  
 4. ALL MACHINING FLUIDS MUST BE FULLY SYNTHETIC, FULLY WATER SOLUBLE AND FREE OF SULFUR, SILICONE, AND CHLORINE.

**MATERIAL** N/A **FINISH** N/A µinch

**SYSTEM** aLIGO **SUB-SYSTEM** SUS **NEXT ASSY** D1002201

**CALIFORNIA INSTITUTE OF TECHNOLOGY**  
**MASSACHUSETTS INSTITUTE OF TECHNOLOGY**

**PART NAME** aLIGO ERM PRISM BONDING FIXTURE

<b>DESIGNER</b> M.VEGGEL	26/08/2010	<b>SIZE</b> DWG. NO.	<b>D1002202</b>	<b>REV.</b> v2
<b>DRAFTER</b> M.v.Veggel	11/10/2010	<b>B</b>		
<b>CHECKER</b> R.Jones	12/10/2010	<b>SCALE:</b> 1:2		
<b>APPROVAL</b>		<b>PROJECTION:</b>		

SHEET 1 OF 1

8 7 6 5 4 3 2 1

D1002202\_aLIGO\_ERM\_PRISM\_BONDING\_FIXTURE, PART PDM REV: v2, DRAWING PDM REV: