

D1001965_d1lGO_AOS_D101964_Fixed Mirror Assy, PART PDM REV: X-008, DRAWING PDM REV: X-003

| REV. | DATE | DCN # | DRAWING TREE # |
|------|-------------|----------|----------------|
| v1 | 08 OCT 2010 | E1000563 | |
| | | | |
| | | | |

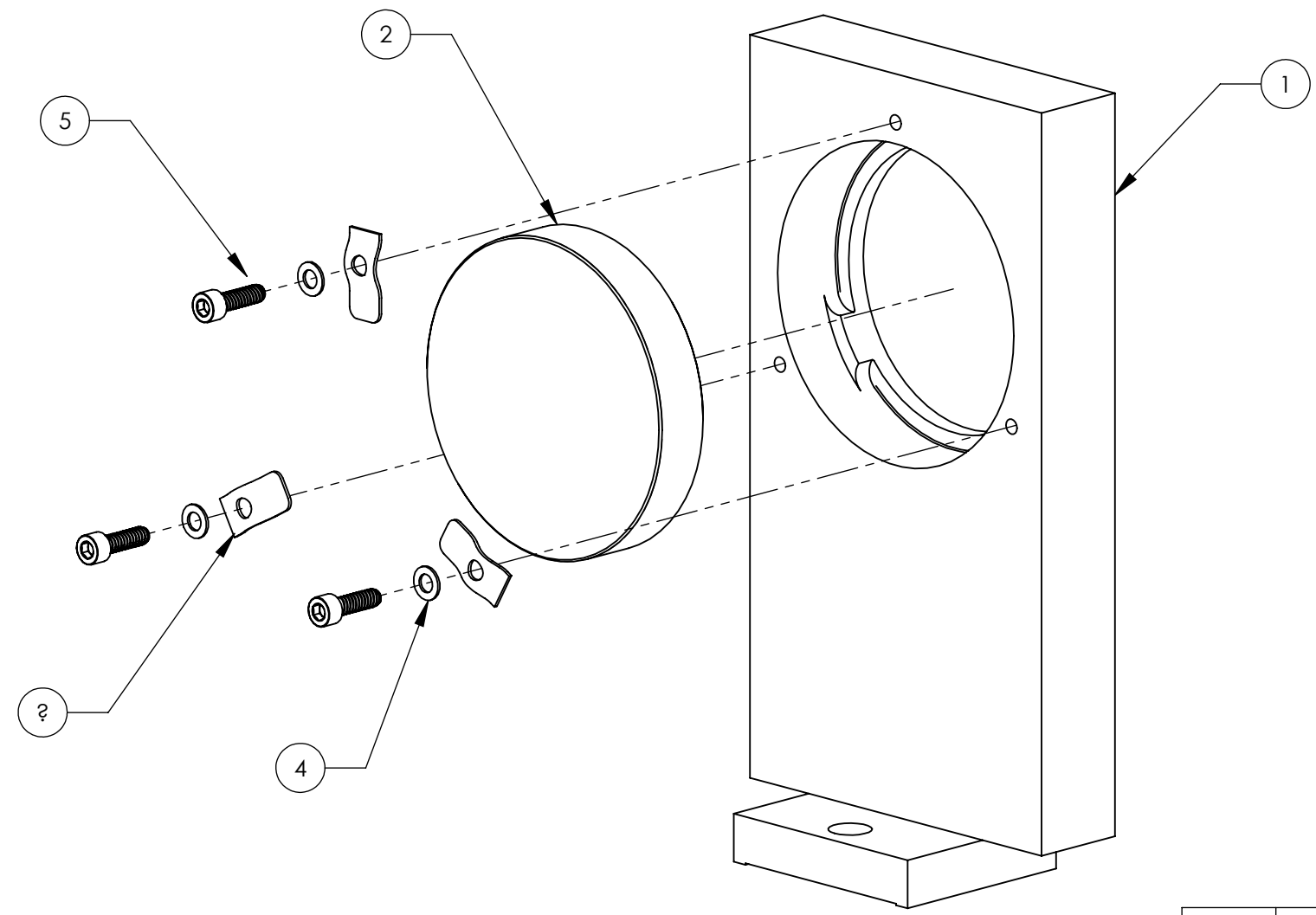

| ITEM NO. | PART NUMBER | DESCRIPTION | MATERIAL | REQ | SPARE | TOTAL |
|----------|---------------------|---|------------|-----|-------|-------|
| 5 | 92200A108 | Head Cap Screw 300 Series SS, 4-40 Thrd, 3/8" Length, MS 16995-10 | 18-8 SSSL | 3 | | 3 |
| 4 | - | WASHER, FLAT, #4 (NAS 620-C4L OR EQUIVALENT) | 300 SSSL | 3 | | 3 |
| 3 | D1001919 | BEAM DUMP MOUNTING CLAMP | 304 SSSL | 3 | | 3 |
| 2 | TFP-1064-PW-2025-UV | STEERING MIRROR | | 1 | | 1 |
| 1 | D1001966 | FIXED MIRROR MOUNT | 6061-T6 Al | 1 | | 1 |

NOTES AND TOLERANCES: (UNLESS OTHERWISE SPECIFIED)

DIMENSIONS ARE IN
TOLERANCES:
.XX ± .02
.XXX ± .010
ANGULAR ± 0.5°

1. INTERPRET DRAWING PER ASME Y14.5-1994.
2. REMOVE ALL SHARP EDGES, R.02 MIN.
3. DO NOT SCALE FROM DRAWING.
4. ALL MACHINING FLUIDS MUST BE FULLY SYNTHETIC, FULLY WATER SOLUBLE AND FREE OF SULFUR, SILICONE, AND CHLORINE.

MATERIAL -- **FINISH** -- μinch

SYSTEM ADVANCED LIGO **SUB-SYSTEM** AOS **PART NAME** FIXED MIRROR ASSY

DESIGNER **DRAFTER** MRUIZ 03 AUG 2010 **SIZE** B **DWG. NO.** D1001965 **REV.** v1

CHECKER **APPROVAL** **SCALE:** 3:4 **PROJECTION:** **SHEET 1 OF 1**

NEXT ASSY D0900623

8 7 6 5 4 3 2 1

D
C
B
A

D
C
B
A

8 7 6 5 4 3 2 1