

D1001359 Test-Bench Pocket Stage2 Optics Table, PART PDM REV: X-002, DRAWING PDM REV: X-002

NOTES CONTINUED:
 5. SCRIBE, ENGRAVE, OR MECHANICALLY STAMP (NO INKS OR DYES) DRAWING PART NUMBER, REVISION (AND VARIANT OR 'TYPE' IF APPLICABLE ON NOTED SURFACE OF PART FOLLOWED ON THE NEXT LINE WITH A THREE DIGIT SERIAL NUMBER, SERIAL NUMBERS START AT 001 FOR THE FIRST ARTICLE AND PROCEED CONSECUTIVELY. USE MINIMUM 0.12 HIGH CHARACTERS, UNLESS THE SIZE OF THE PART DICTATES SMALLER CHARACTERS. A VIBRATORY TOOL MAY BE USED.
 EXAMPLE DXXXXXX-VY, TYPE-XX, S/N XXX.
 6. APPROXIMATE WEIGHT = 27.0 LB.

REV.	DATE	DCN #	DRAWING TREE #
v1	25 May 2010	E1000195	-

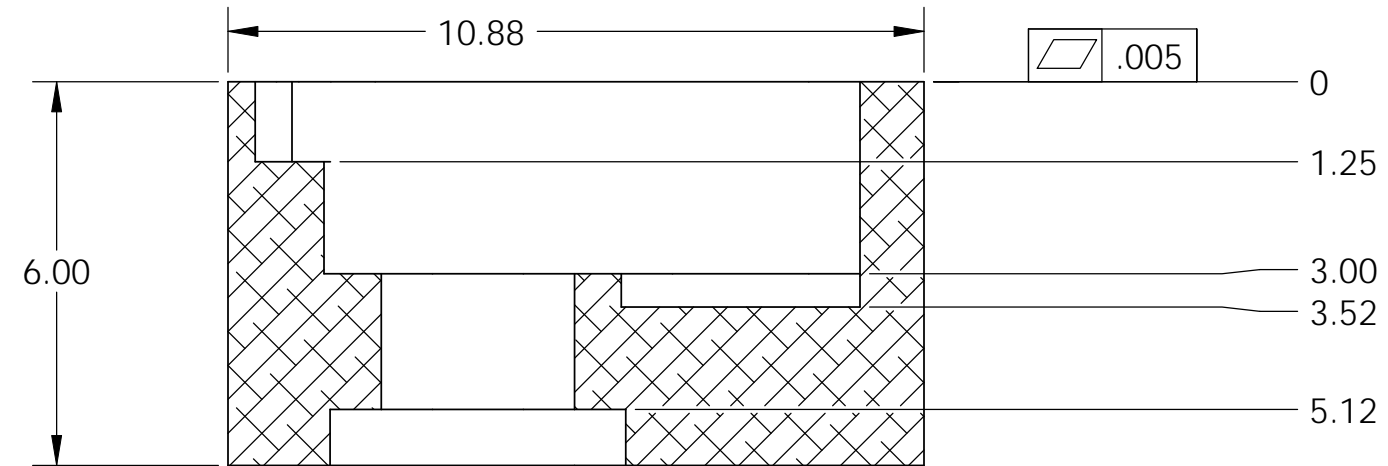
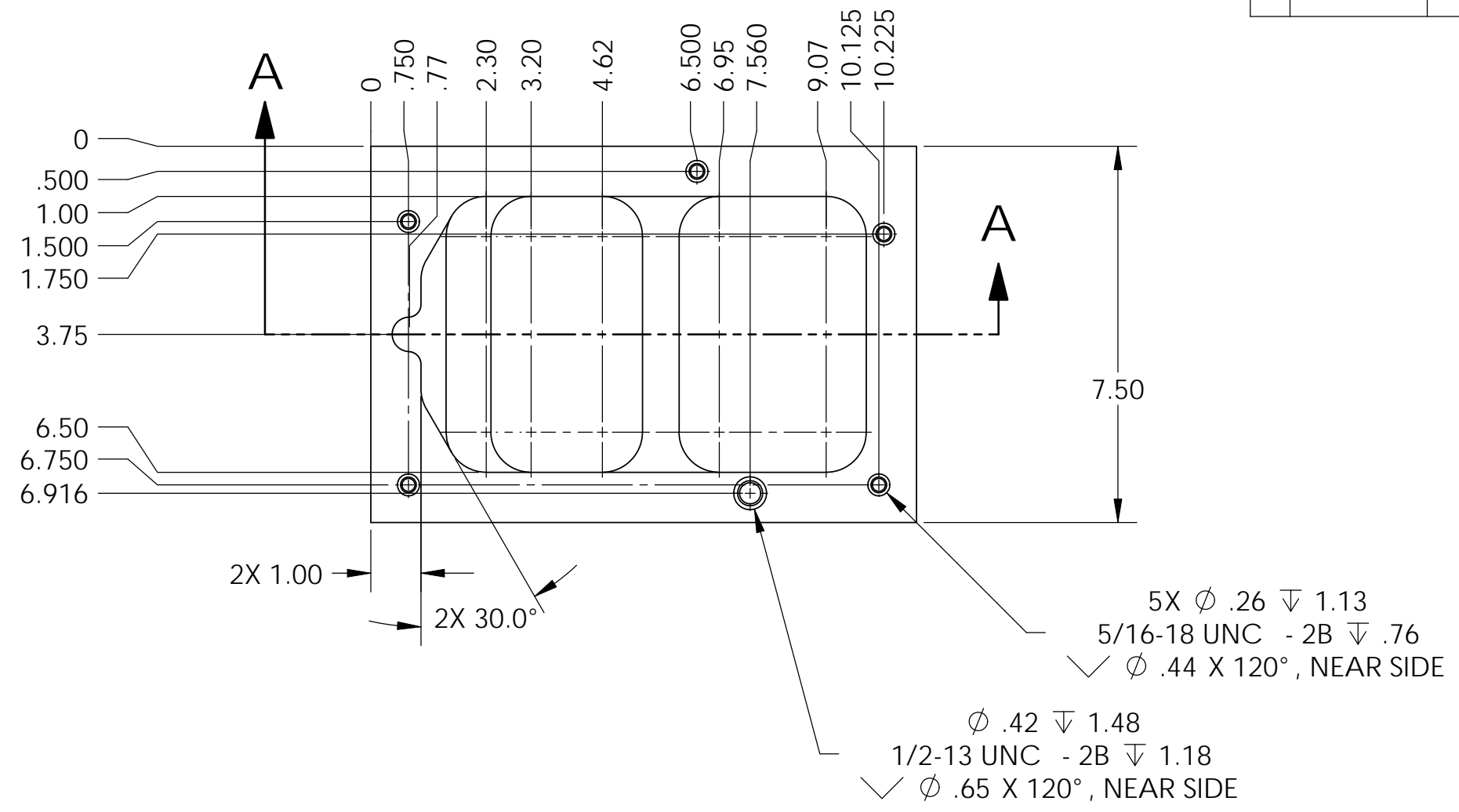

SECTION A-A

NOTES AND TOLERANCES: (UNLESS OTHERWISE SPECIFIED)				LIGO		PART NAME	
DIMENSIONS ARE IN INCHES TOLERANCES: .XX ± .015 .XXX ± .005 ANGULAR ± .5°				CALIFORNIA INSTITUTE OF TECHNOLOGY MASSACHUSETTS INSTITUTE OF TECHNOLOGY		TEST-BENCH POCKET STAGE 2 OPTICS TABLE	
1. INTERPRET DRAWING PER ASME Y14.5-1994. 2. REMOVE ALL SHARP EDGES, R.02 MIN. 3. DO NOT SCALE FROM DRAWING. 4. ALL MACHINING FLUIDS MUST BE FULLY SYNTHETIC, FULLY WATER SOLUBLE AND FREE OF SULFUR, SILICONE, AND CHLORINE.				ADVANCED LIGO		SEI	
MATERIAL 6061-T6 Al		FINISH 63 μinch		NEXT ASSY D1001366		DESIGNER S.BARNUM 25 May 2010 DRAFTER M.HILLARD 25 May 2010 CHECKER F.MATICHARD 25 May 2010 APPROVAL K.MASON 25 May 2010	
SCALE: 1:3				PROJECTION:		DWG. NO. D1001359	
SHEET 1 OF 1				REV. v1		SIZE B	