

NOTES CONTINUED:
 MACHINE SHOWN IN DEFAULT VERTICAL CONFIGURATION, MOUNTED ON THE TABLE ASSEMBLY.

| REV. | DATE | DCN # | DRAWING TREE # |
|------|------|-------|----------------|
| | | | |
| | | | |
| | | | |

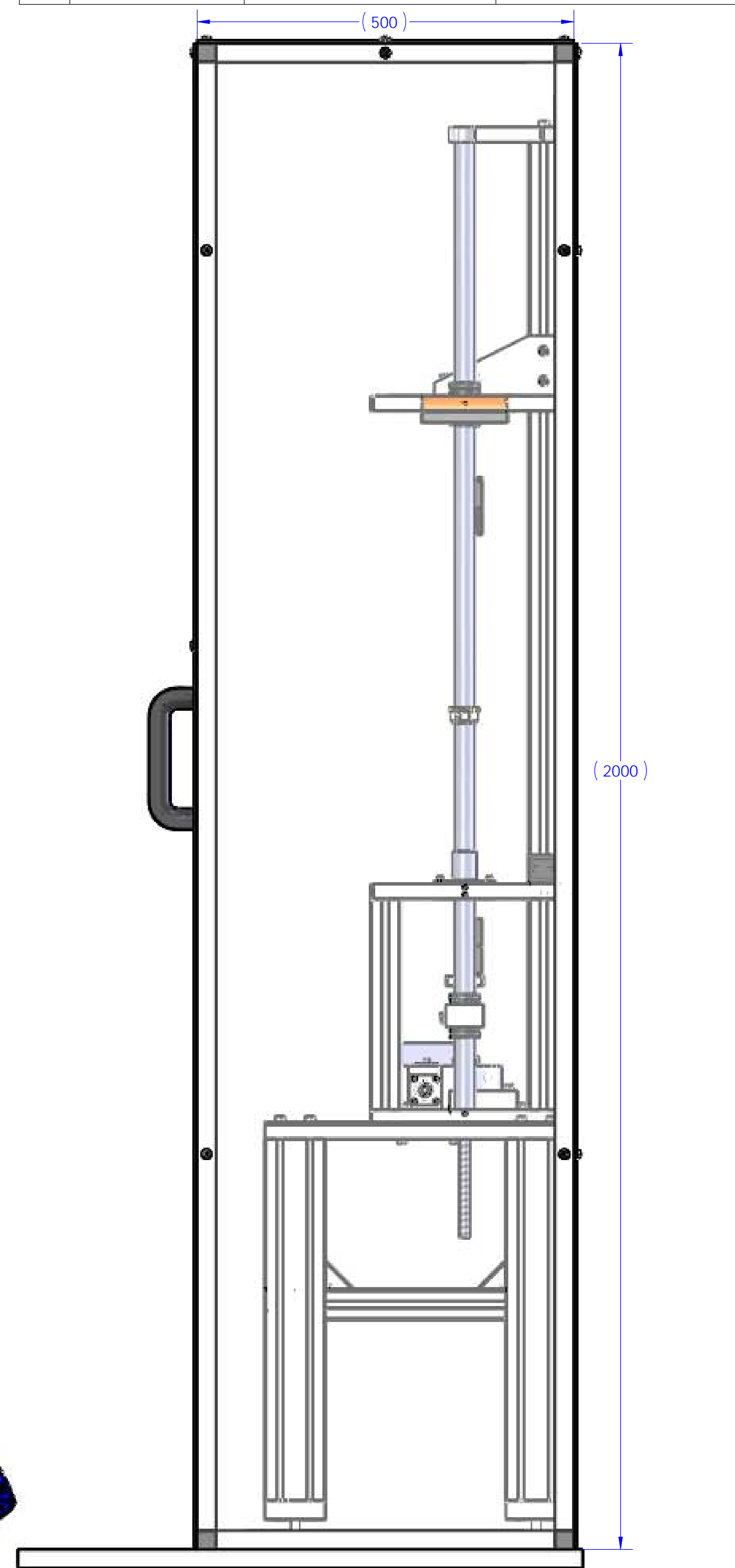
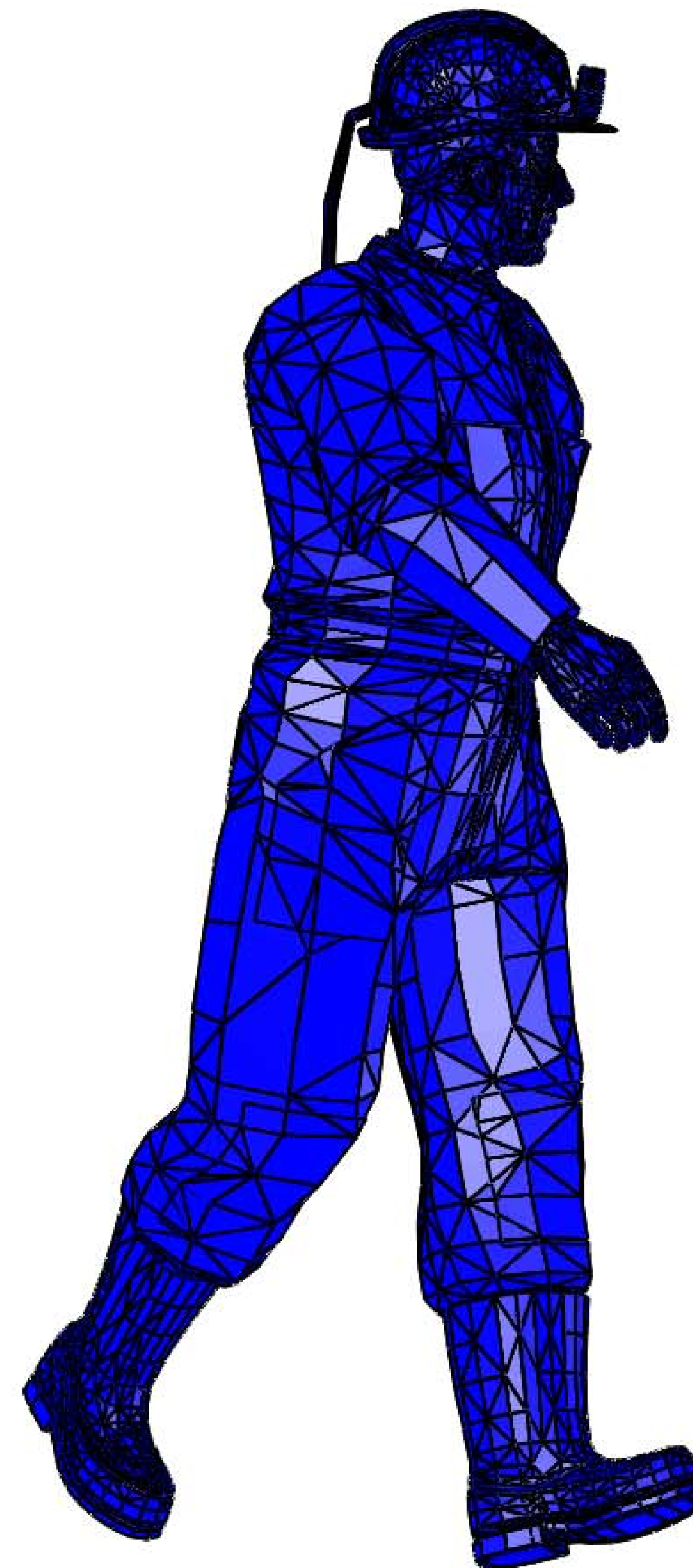
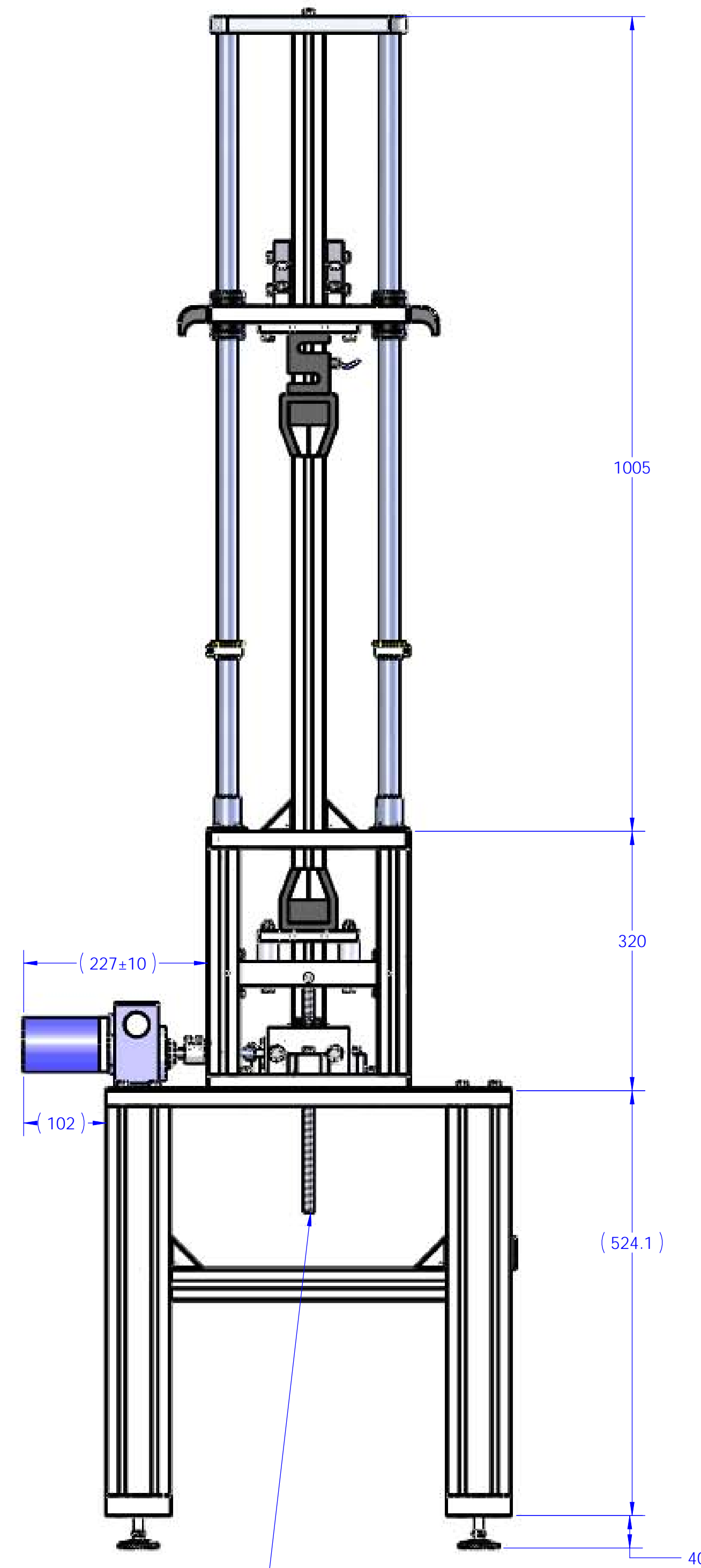
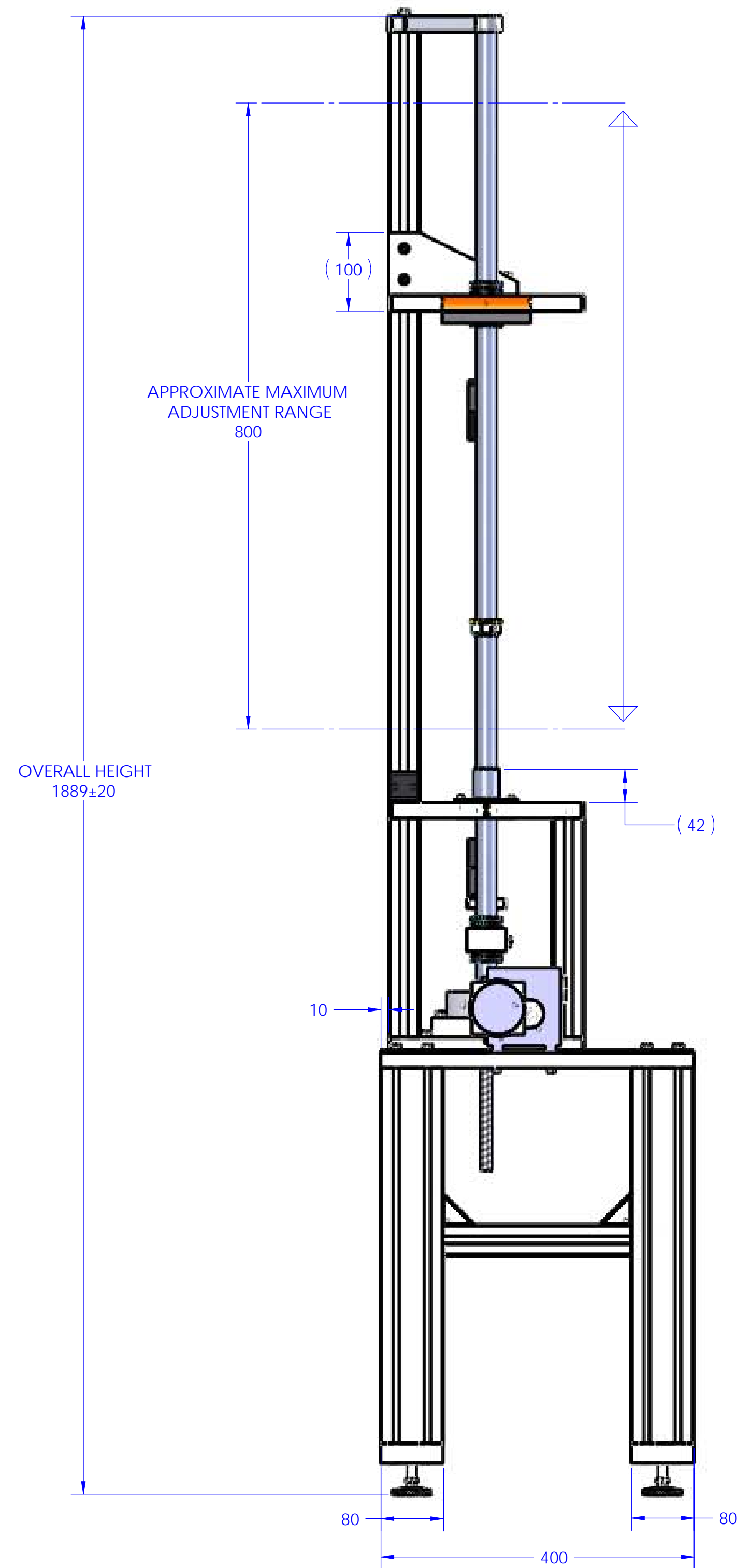

NOTE: BALLSCREW SHAFT PROTRUDES UNPROTECTED BELOW THE TABLE SURFACE. A SAFETY CAGE TO BLOCK OFF THE VOLUME USED IN THE ADJUSTMENT RANGE OF THE DRIVE ASSEMBLY IS NOT ESSENTIAL BUT WOULD BE A SENSIBLE ADDITION FOR A MACHINE UPGRADE.

| NOTES AND TOLERANCES: (UNLESS OTHERWISE SPECIFIED) | |
|--|-----------|
| 1. INTERPRET DRAWING PER ASME Y14.5-1994. 2. REMOVE ALL SHARP EDGES, R.02 MIN. 3. DO NOT SCALE FROM DRAWING. 4. ALL MACHINING FLUIDS MUST BE FULLY SYNTHETIC, FULLY WATER SOLUBLE AND FREE OF SULFUR, SILICONE, AND CHLORINE. | |
| DIMENSIONS ARE IN MILLIMETERS | |
| GENERAL TOLERANCES: ± 2 | |
| ANGULAR ± 1° | |
| MATERIAL | N/A |
| FINISH | N/A μinch |

| | |
|---|------------|
| CALIFORNIA INSTITUTE OF TECHNOLOGY MASSACHUSETTS INSTITUTE OF TECHNOLOGY | |
| SYSTEM | SUB-SYSTEM |
| IGR MKII Strength Testing Machine | -- |
| NEXT ASSY | -- |

| | | | | | | | |
|-----------|---------|--------|-------------|--|--------------|--|--|
| PART NAME | | | | IGR MKII Strength Testing Machine Overall Assembly | | | |
| DESIGNER | R.JONES | 2008 | SIZE | DWG. NO. | REV. | | |
| DRAFTER | R.JONES | SEPT10 | D | D080197 | v2 | | |
| CHECKER | A.BELL | SEPT10 | SCALE: 1:10 | PROJECTION: | SHEET 1 OF 2 | | |
| APPROVAL | | | | | | | |

D080197_IGR MKII Strength Testing Machine_Overall Assembly_PART PDM_REV-V2_DRAWING PDM_REV-

NOTES CONTINUED:

| REV. | DATE | DCN # | DRAWING TREE # |
|------|------|-------|----------------|
| | | | |
| | | | |
| | | | |

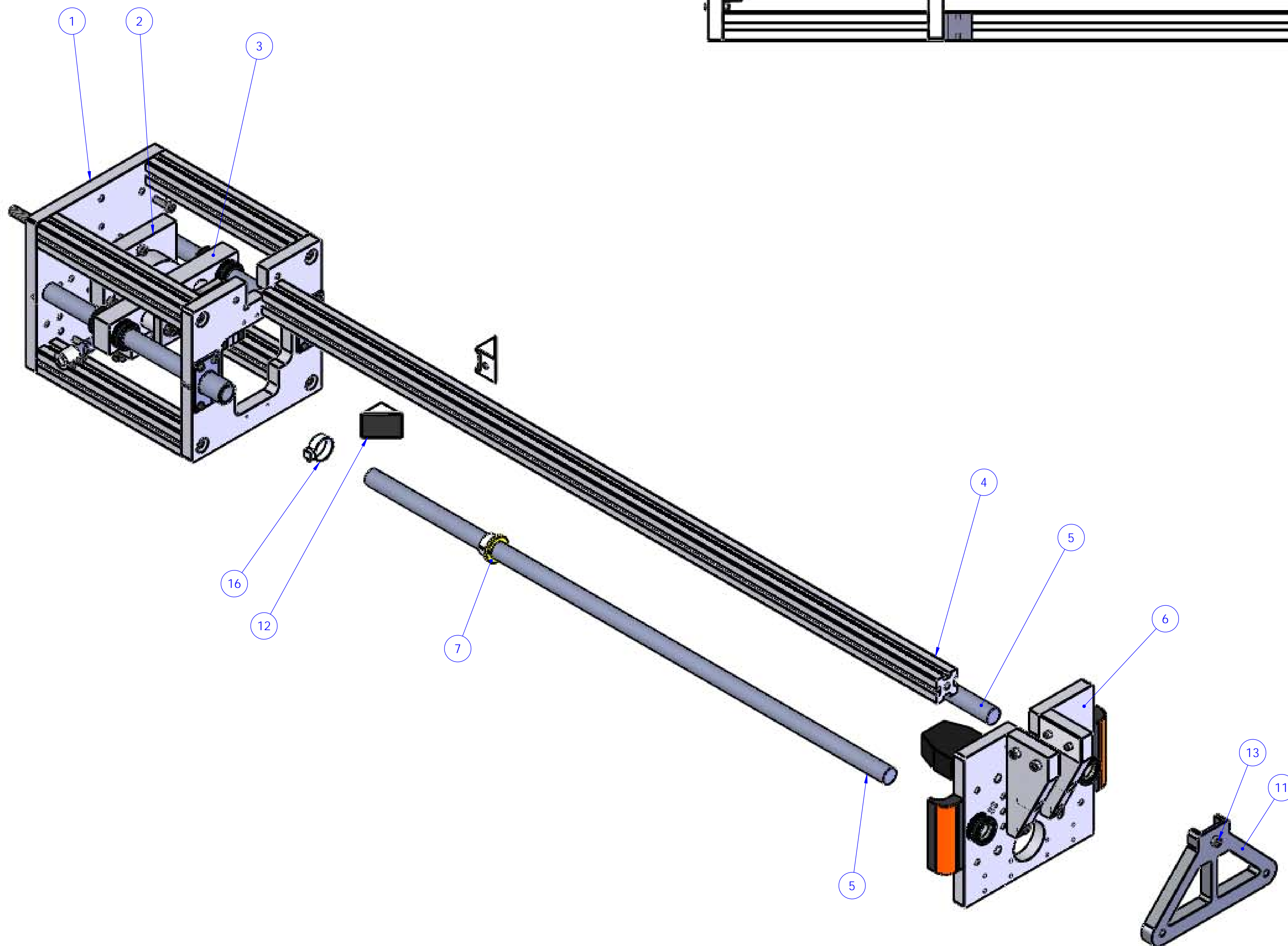
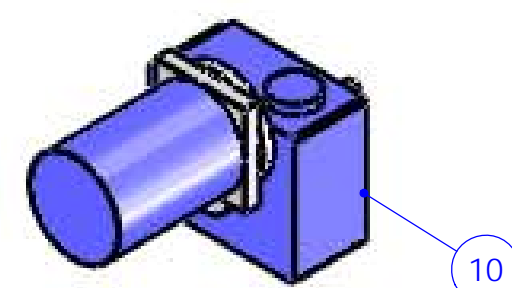
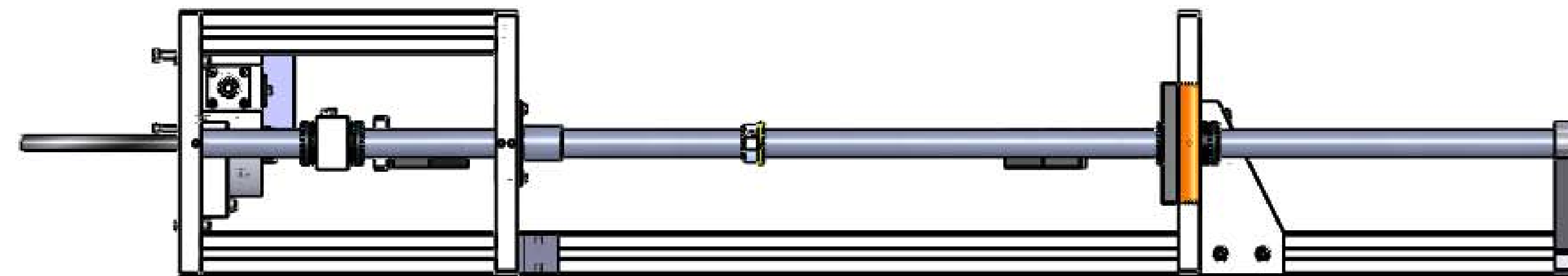
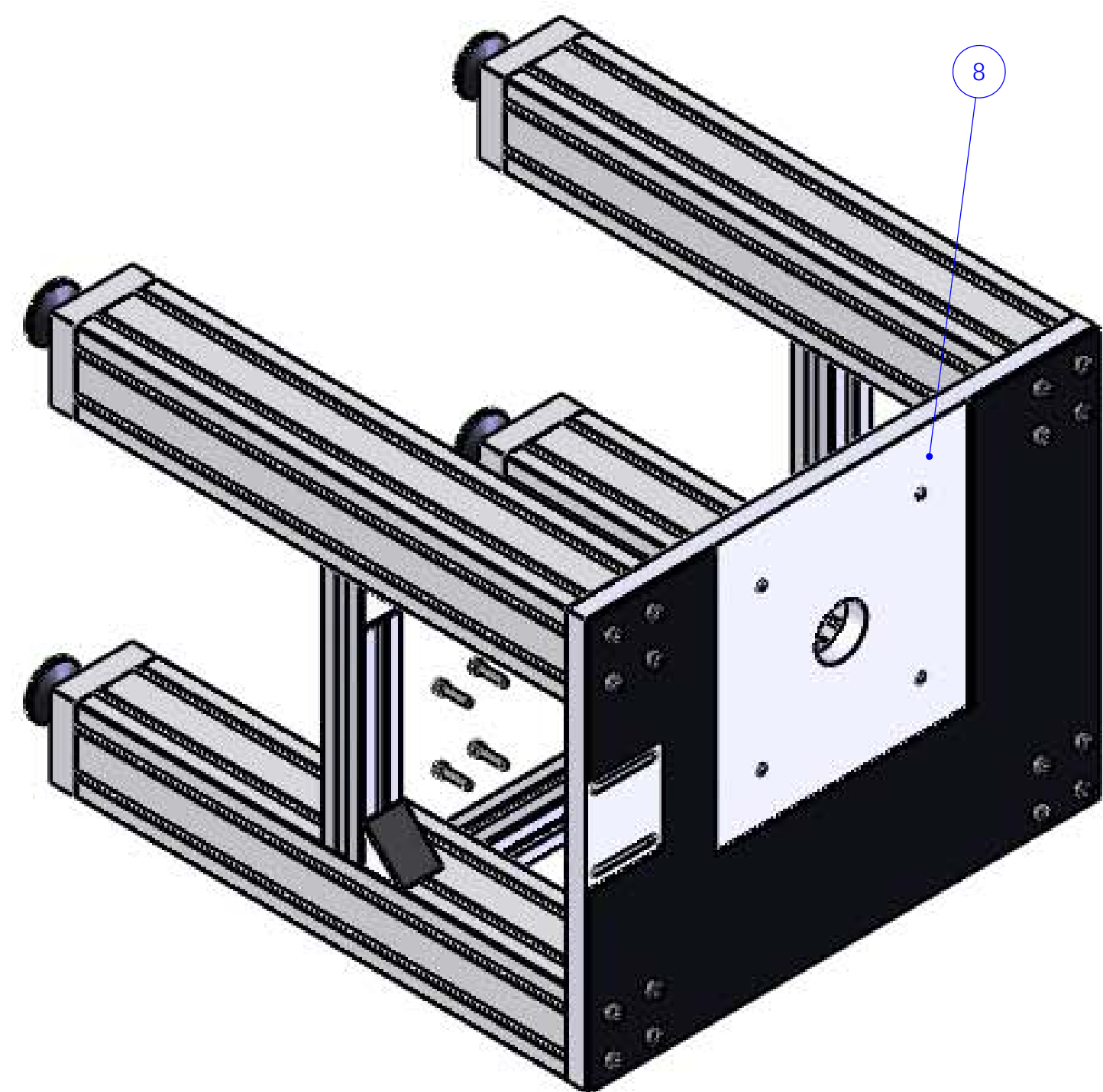

| ITEM NO. | PART NUMBER | QTY. |
|----------|--|------|
| 1 | D080198_Drive_Pull Module | 1 |
| 2 | D080200_Worm Wheel Drive Assembly | 1 |
| 3 | D080199_Load Cell Pull Assembly | 1 |
| 4 | D080214_Aluminium Spine (extrusion) | 1 |
| 5 | D080215_Extended Support Bearing Pole | 2 |
| 6 | D080202_Adjustable Anchoring Assembly | 1 |
| 7 | D080217_Extending Support_Collet | 2 |
| 8 | D1002003_Table Assembly | 1 |
| 9 | D1002012_Worm Cap Assembly | 1 |
| 10 | Parvalux PM10C Motor | 1 |
| 11 | D1002162_Triangular End Cap | 1 |
| 12 | Item_0060162_Set_of_Angle_Brackets_X_8_40x40_0 | 2 |
| 13 | ISO 4762 M8 x 20 --- 20N | 1 |
| 14 | ISO 4762 M6 x 25 --- 25N | 4 |
| 15 | ISO 4762 M8 x 25 --- 25N | 4 |
| 16 | Jubilee clip_size 1_25-35mm diameter | 2 |

| NOTES AND TOLERANCES: (UNLESS OTHERWISE SPECIFIED) | |
|--|---|
| 1. INTERPRET DRAWING PER ASME Y14.5-1994. 2. REMOVE ALL SHARP EDGES, R.02 MIN. 3. DO NOT SCALE FROM DRAWING. 4. ALL MACHINING FLUIDS MUST BE FULLY SYNTHETIC, FULLY WATER SOLUBLE AND FREE OF SULFUR, SILICONE, AND CHLORINE. | |
| DIMENSIONS ARE IN MILLIMETERS | GENERAL TOLERANCES: ± 2 ANGULAR ± 1° |
| MATERIAL | FINISH |
| N/A | N/A μinch |

| | |
|---|------------|
| CALIFORNIA INSTITUTE OF TECHNOLOGY MASSACHUSETTS INSTITUTE OF TECHNOLOGY | |
| SYSTEM | SUB-SYSTEM |
| IGR MKII Strength Testing Machine | -- |
| NEXT ASSY | -- |

| | | | | | |
|--|---------|--------|-------------|-------------|--------------|
| PART NAME | | | | | |
| IGR MKII Strength Testing Machine Overall Assembly | | | | | |
| DESIGNER | R.JONES | 2008 | SIZE | DWG. NO. | REV. |
| DRAFTER | R.JONES | AUG10 | D | D080197 | v2 |
| CHECKER | A.BELL | SEPT10 | SCALE: 1:10 | PROJECTION: | SHEET 2 OF 2 |
| APPROVAL | | | | | |

D080197_IGR MKII Strength Testing Machine_Overall Assembly_PART PDM REV:V2_DRAWING PDM REV: