

NOTES (CONTINUED):
 ③ REPLACE MANUFACTURERS INCLUDED HARDWARE WITH ITEMS ③ & ④.
 4. THIS ASSEMBLY IS SYMETRICALLY OPPOSITE TO D1001325. SEE DRAWING D1001325 FOR COMPLETE ASSEMBLY DETAILS.

REV.	DATE	DCN #	DRAWING TREE #
v1	19 OCT 2010	E1000182	-
v2	27 JUN 2012	-	-
v3	14 OCT 2013	E1300649	-
v4	07 APR 2014	-	-
v5	29 APR 2014	-	-

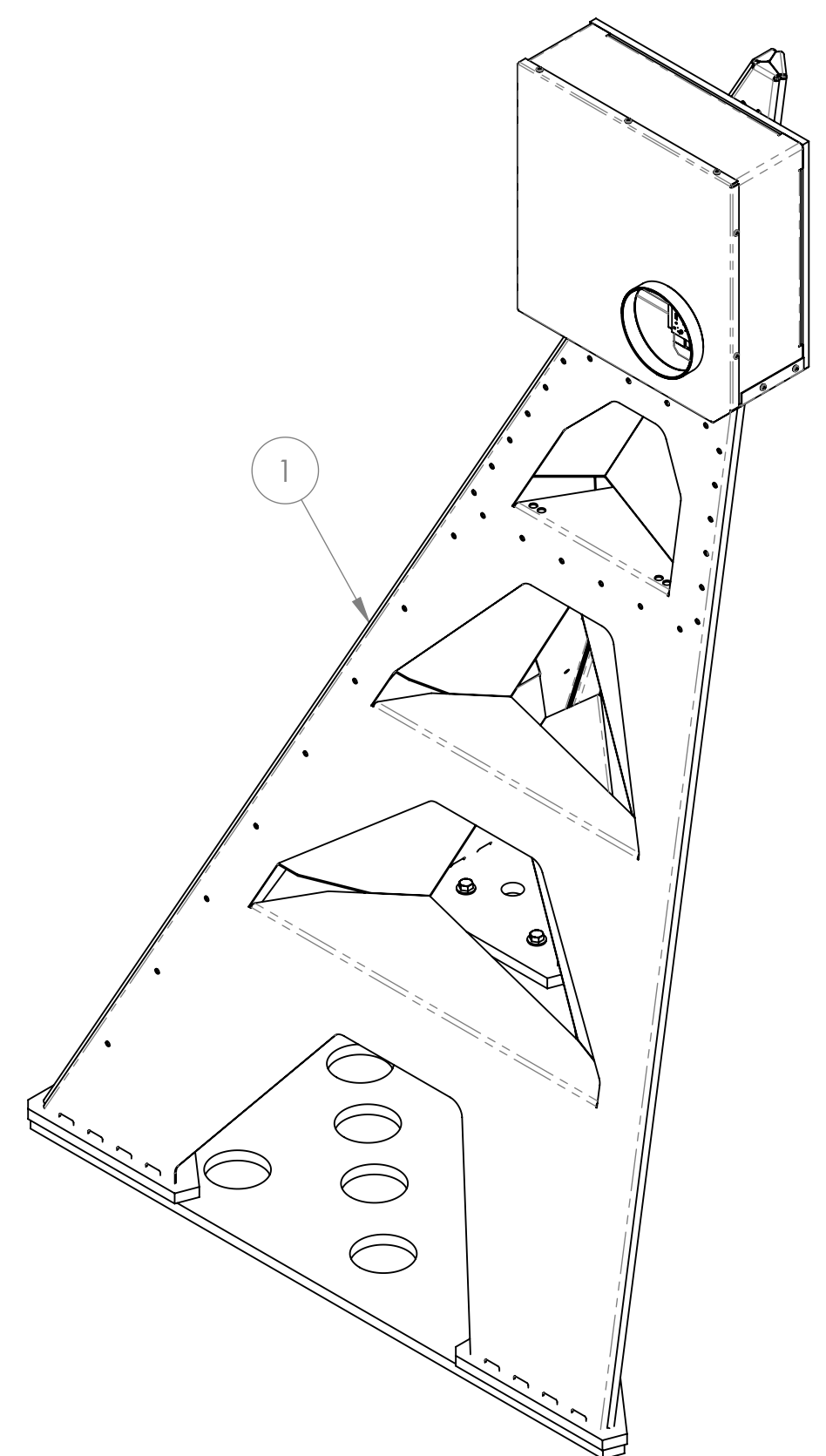

**-01 (ITMY)
OPLEV ONLY**

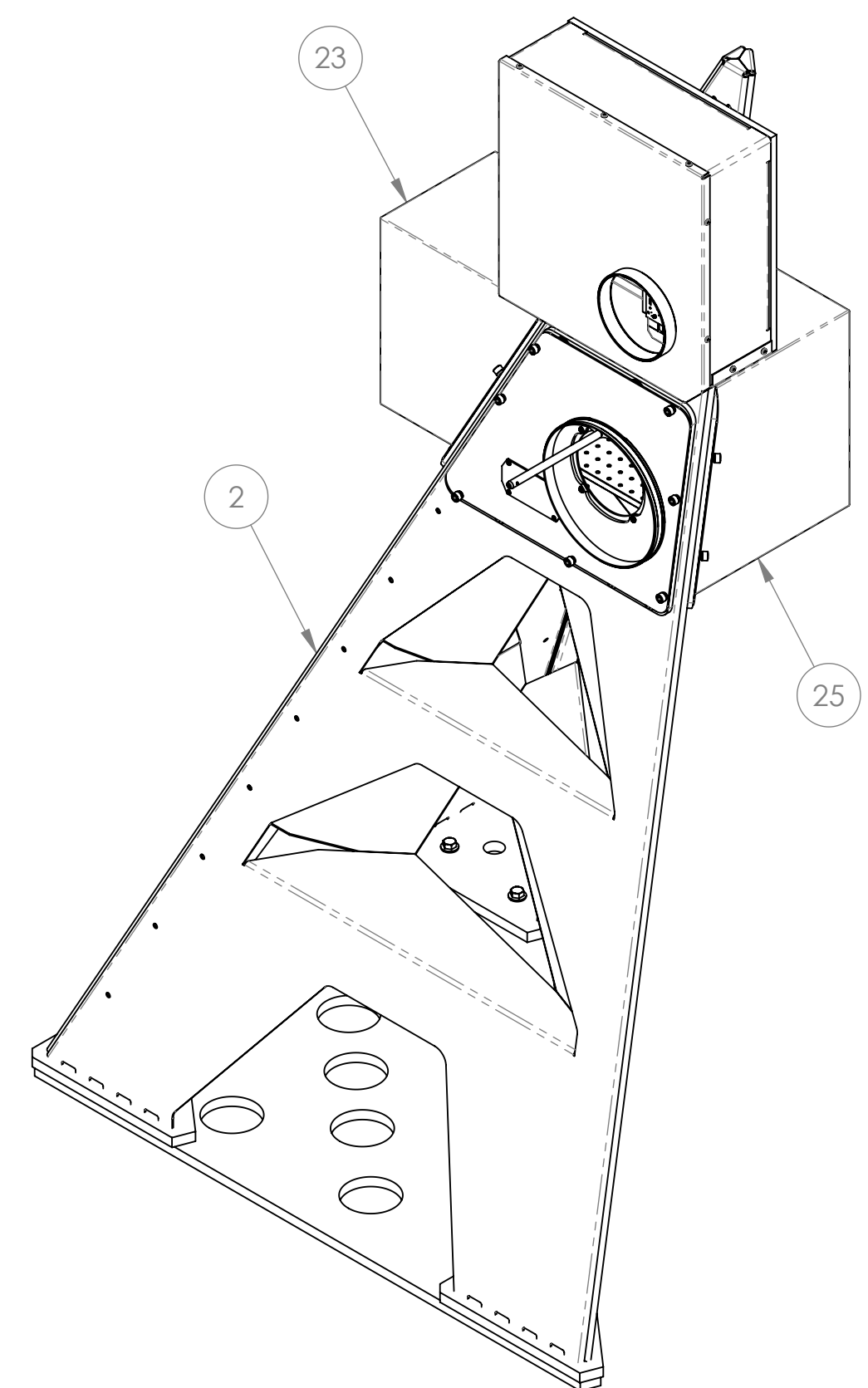

**-02 (ETMX)
OPLEV/PCAL**

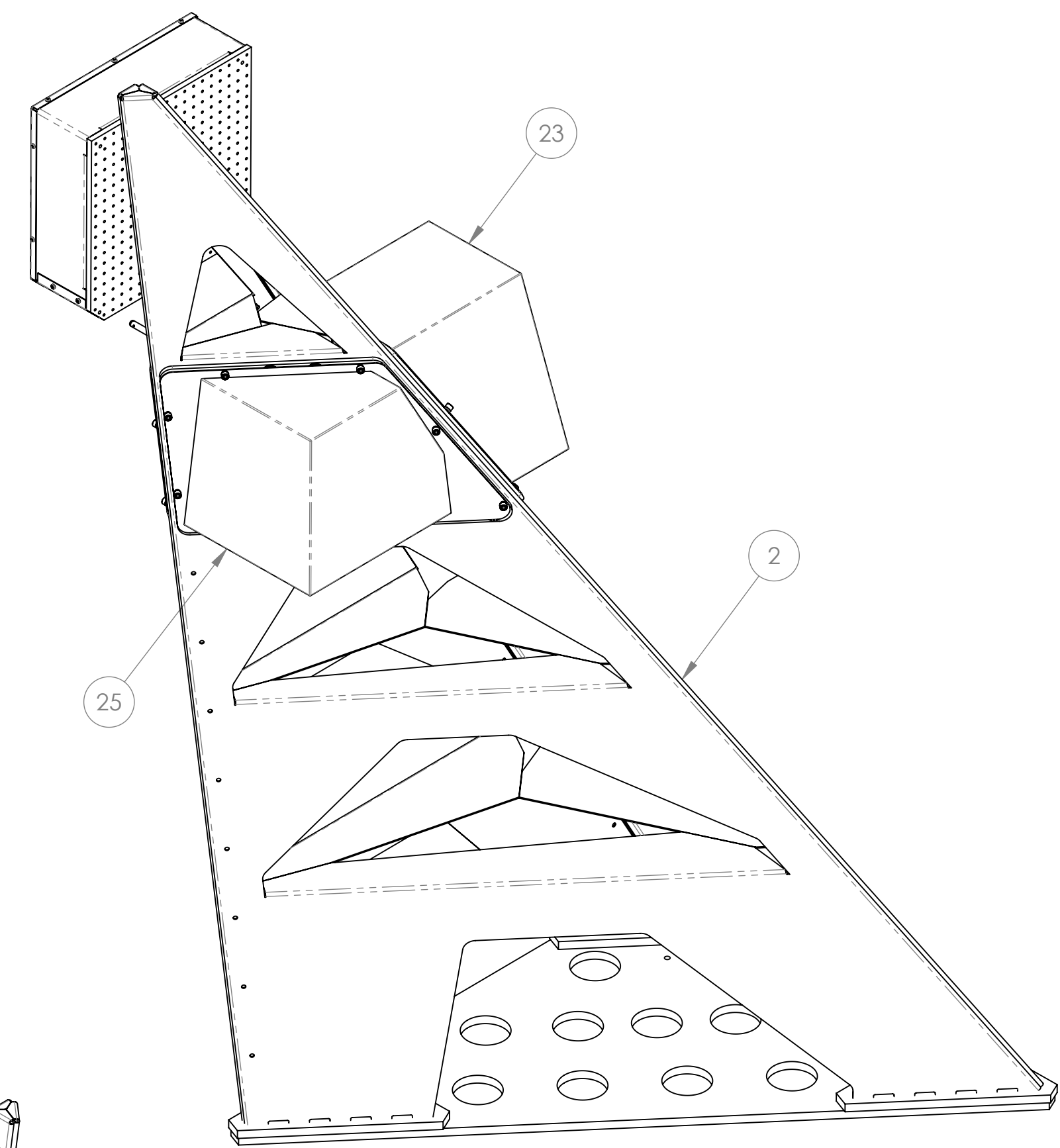

**-02 (ETMX)
OPLEV/PCAL
(REORIENTED)**

32	97763A504 (McM-Carr) or equiv	BUTTON HEAD SOCKET SCREW, 8-32 X 5/16L, BLACK OXIDE		18-8 SSSL	-	4
31	D1400081	PHOTON CALIBRATOR RECEIVER PANEL	v1	6061-T6 Al	-	1
30	92949A196 (McM-Carr) or equiv	BUTTON HEAD SOCKET SCREW, 8-32 x 5/8		18-8 SSSL	-	5
29	98019A325 (McM-Carr) or equiv PER MS15795-807	WASHER, FLAT, #8		300 SSSL	-	5
28	D1300731-02	ALIGO PCAL VIEWPORT BELLOWS ADAPTER ASSEMBLY, RECEIVER	v2	N/A	-	1
27	D1300246-01	ALIGO PCAL RECEIVER APERTURE, X-ARM	v3	6061-T6 Al	-	1
26	D1300682-01	ALIGO PCAL RECEIVER ENCLOSURE ADAPTER, FRONT, X-ARM	v3	6061-T6 Al	-	1
25	D1300207-01	ALIGO PCAL RECEIVER ENCLOSURE, X-ARM	v3	6061-T6 Al	-	1
24	D1300684-01	ALIGO PCAL RECEIVER ENCLOSURE ADAPTER, INSIDE, X-ARM	v3	6061-T6 Al	-	1
23	D1300182-01	ALIGO PCAL RECEIVER ENCLOSURE, X-ARM	v3	6061-T6 Al	-	1
22	91255A539 (McM-Carr) or equiv	BUTTON HEAD SOCKET SCREW, 1/4-20 x 5/8		Alloy Steel	-	32
21	98019A360 (McM-Carr) or equiv PER MS15795-811	WASHER, FLAT, 1/4		300 SSSL	-	32
20	D1300683-01	ALIGO PCAL RECEIVER ENCLOSURE ADAPTER, OUTSIDE, X-ARM	v3	6061-T6 Al	-	1
19	91847A029 (McM-Carr) or equiv	JAM NUT, 1/4-20		300 SSSL	-	3
18	92196A5450 (McM-Carr) or equiv	SCREW, SOCKET HEAD CAP, 1/4-20 UNC-2A X 1.375 LONG		18-8 SSSL	-	3
17	90945A761 (McM-Carr) or equiv PER NAS 620-C416	WASHER, FLAT, 1/4		300 SSSL	-	3
16	D1300800-01	ALIGO PCAL RECEIVER MODULE, X-ARM	v1	N/A	-	1
15	D1100342	ALIGO, AOS, OPLEV, RCVR ENCLOSURE ASSY. (RIGHT HAND)	v2	N/A	1	1
14	92196A113 (McM-Carr) or equiv	SCREW, SOCKET HEAD CAP, #4-40 UNC-2A X 0.75 LONG		18-8 SSSL	4	4
13	90945A710 (McM-Carr) or equiv PER NAS 620-C4L	WASHER, FLAT, #4		300 SSSL	4	4
12	D1100290	ALIGO OPTICAL LEVER QPD AMPLIFIER	v1		1	1
11	D1100617	ALIGO AOS OPLEV PCB CARRIER	v2	6061-T6 Al	1	1
10	91292A125 (McM-Carr) or equiv	SCREW, SOCKET HEAD CAP, M5-0.8 X 12 LONG		18-8 SSSL	4	4
9	511-3322-RH (OptoSigma)	LINEAR STEPPING MOTOR STAGE, XY AXES, RIGHT HANDED		N/A	1	1
8	92196A537 (McM-Carr) or equiv	SCREW, SOCKET HEAD CAP, 1/4-20 UNC-2A X 0.5 LONG		18-8 SSSL	19	19
7	D1001510	ALIGO AOS OPLEV RX STAGE ADAPTER	v2	6061-T6 Al	1	1
6	D1001509	ALIGO AOS OPLEV RX BREADBOARD	v2	6061-T6 Al	1	1
5	92196A540 (McM-Carr) or equiv	SCREW, SOCKET HEAD CAP, 1/4-20 UNC-2A X 0.75 LONG		18-8 SSSL	6	6
③ 4	91286A369 (McM-Carr) or equiv	HEX HEAD CAP SCREW, GRADE 8, 1/2-20 X 1.50L, ARMOR COAT		Alloy Steel	9	9
③ 3	95221A115 (McM-Carr) or equiv	BELLEVILLE WASHER, 13MM ID, 29MM OD, 3MM TH, 3.95MM HT, ZN PL		Alloy Steel	9	9
2	D1001297-02	ALIGO AOS OPLEV & PCAL RX PIER WELDMENT RH, ETMX	v2	N/A	-	1
1	D1001297-01	ALIGO AOS OPLEV & PCAL RX PIER WELDMENT RH, ITMY	v2	N/A	1	-

ITEM NO.	PART NUMBER	DESCRIPTION	REV.	MATERIAL	-01 (ITMY) /QTY.	-02 (ETMX) /QTY.
PARTS LIST						
DIMENSIONS ARE IN INCHES		TOLERANCES: .XX ± .XXX ±		ANGULAR ± °		
MATERIAL		FINISH		NEXT ASSY		
N/A		N/A μinch		D1000354 D1000417 D1000418		
SYSTEM		SUB-SYSTEM		PART NAME		
ADVANCED LIGO		AOS		ALIGO AOS OPLEV & PCAL RX PIER ASSEMBLY RH		
DESIGNER		SIZE		DWG. NO.		
C. CONLEY		17 AUG 2010		D		
DRAFTER		CHECKER		REV.		
N. KILPATRICK		SEE DCN		v5		
APPROVAL		SCALE: NONE		PROJECTION:		
		SEE DCN		SHEET 1 OF 1		

NOTES AND TOLERANCES: (UNLESS OTHERWISE SPECIFIED)	
1. INTERPRET DRAWING PER ASME Y14.5-1994.	
2. DO NOT SCALE FROM DRAWING.	
MATERIAL	
N/A	
FINISH	
N/A μinch	
NEXT ASSY	
D1000354 D1000417 D1000418	

D1001330.dwg CALIGO AOS Oplev & Pcal Rx Pier Assembly RH PART PDM REV: X-148 DRAWING PDM REV: X-206