

8

7

6

5

4

3

2

1

NOTES CONTINUED:

5. MACHINE ALL SURFACES TO REMOVE OXIDES AND MILL FINISH, USE OF ABRASIVE REMOVAL TECHNIQUES IS NOT ALLOWED. REFER TO LIGO-E0900364

6. ALL PARTS SHALL BE MANUFACTURED IN ACCORDANCE WITH LIGO SPECIFICATION E0900364.

REV.	DATE	DCN #	DRAWING TREE #
v1	12 JUL 2011	-	-
v2	6 FEB 2012	-	-
v3	5 MAR 2012	E1200249-x0	-

### ISO VIEW

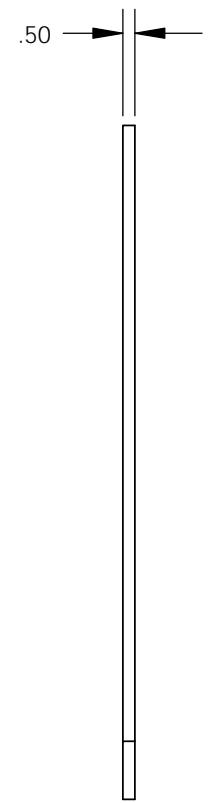
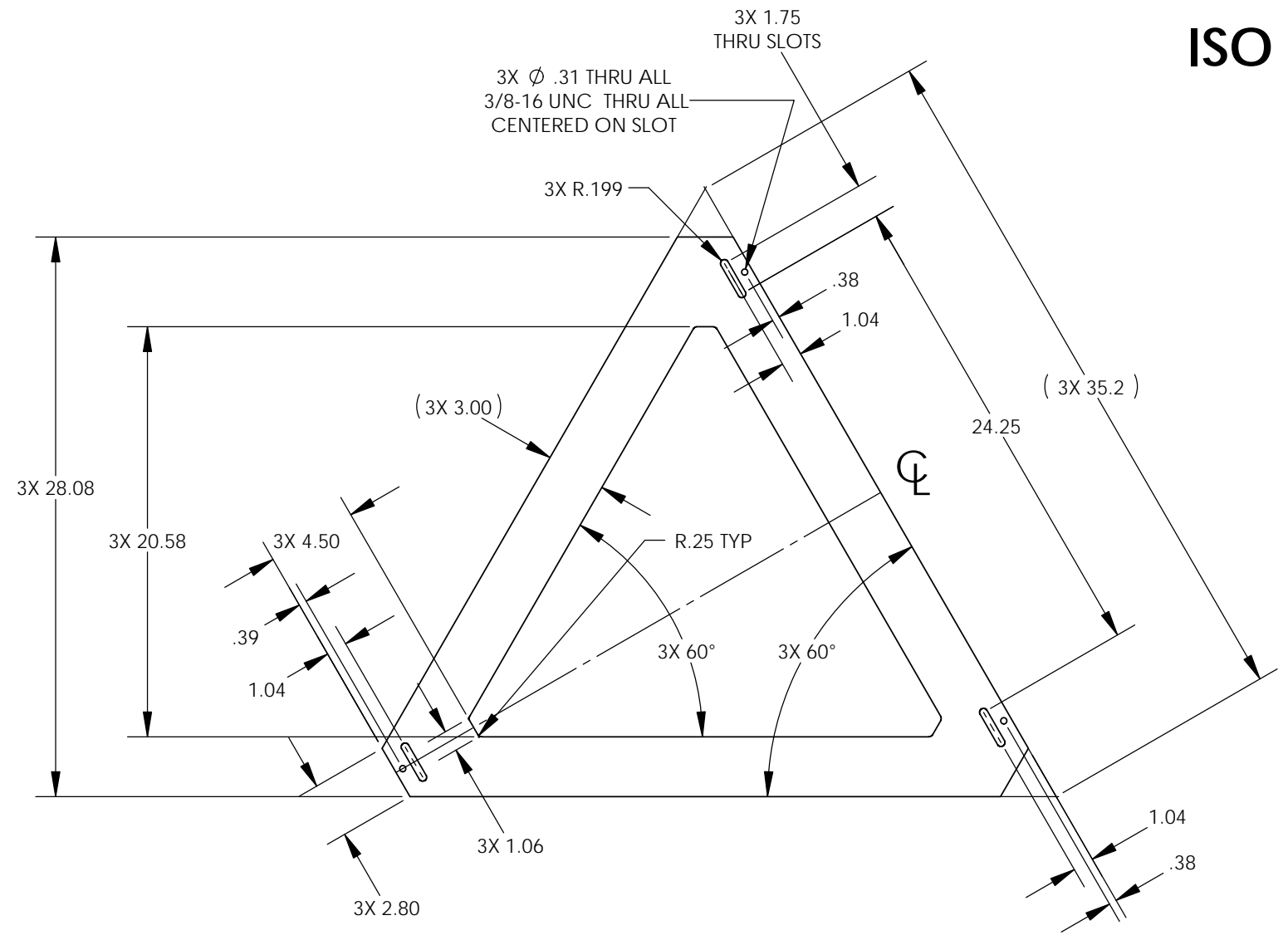

D1000673 aLIGO AOS PhotCal TX Table Base, PART PDM REV: X-009, DRAWING PDM REV: X-007

NOTES AND TOLERANCES: (UNLESS OTHERWISE SPECIFIED)	
DIMENSIONS ARE IN INCHES	1. INTERPRET DRAWING PER ASME Y14.5-1994.
TOLERANCES: .XX ± .01 .XXX ± .005	2. REMOVE ALL SHARP EDGES, R.02 MIN.
ANGULAR ± 1.0°	3. DO NOT SCALE FROM DRAWING.
	4. ALL MACHINING FLUIDS MUST BE FULLY SYNTHETIC, FULLY WATER SOLUBLE AND FREE OF SULFUR, SILICONE, AND CHLORINE.
MATERIAL	304 SSSL
FINISH	N/A μinch

	CALIFORNIA INSTITUTE OF TECHNOLOGY MASSACHUSETTS INSTITUTE OF TECHNOLOGY
SYSTEM	ADVANCED LIGO
SUB-SYSTEM	AOS
NEXT ASSY	D1000675

PART NAME		ADLIGO AOS PHOTCAL TX PIER TABLE	
DESIGNER	C. CONLEY	24 MAR 2010	SIZE
DRAFTER	N. KILPATRICK	12 JUL 2011	DWG. NO.
CHECKER			<b>B</b>
APPROVAL			<b>D1000673</b>
			REV. <b>v3</b>
SCALE: 1:8	PROJECTION:	SHEET 1 OF 1	

8 7 6 5 4 3 2 1