

| REV. | DATE | DCN # | DRAWING TREE # |
|------|------------|-------|----------------|
| v1 | 29/01/2010 | | |
| v2 | 25/06/2010 | | |

NOTES CONTINUED:

⑤ SCRIBE, ENGRAVE, OR MECHANICALLY STAMP (NO INKS OR DYES) DRAWING PART NUMBER AND REVISION ON NOTED SURFACE FOLLOWED ON THE NEXT LINE BY A THREE DIGIT SERIAL NUMBER. SERIAL NUMBERS START AT 001 FOR THE FIRST ARTICLE AND PROCEED CONSECUTIVELY. USE 07" HIGH CHARACTERS. EXAMPLE: DXXXXXX-VY, S/N 001. A VIBRATORY TOOL MAY BE USED.

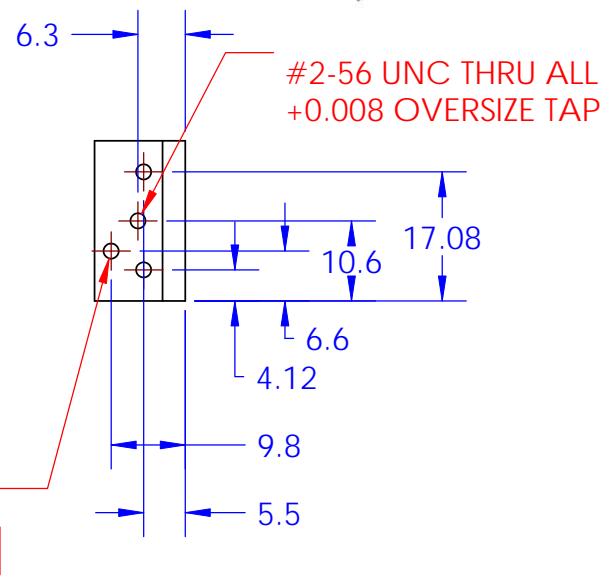
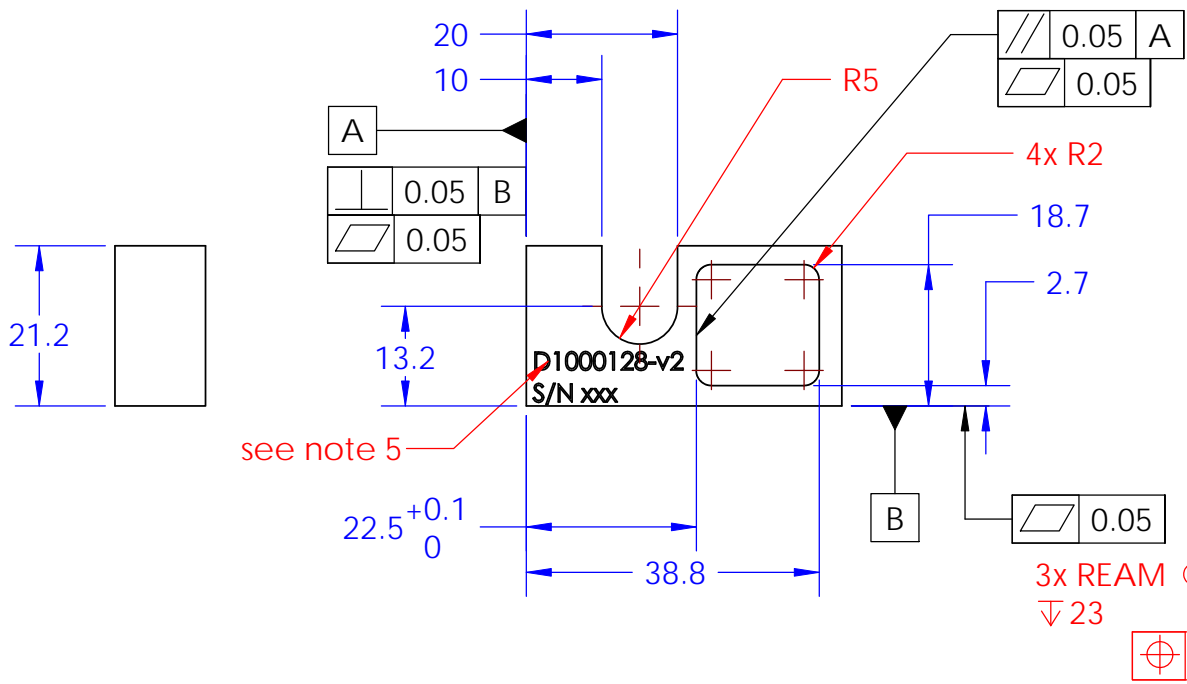
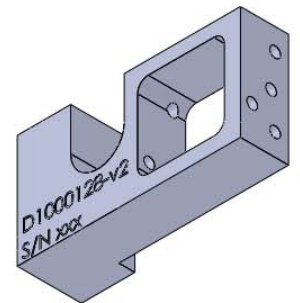
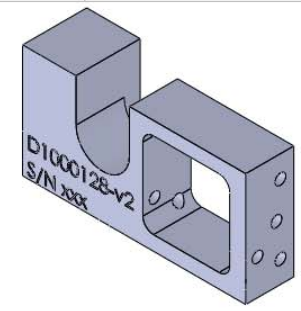
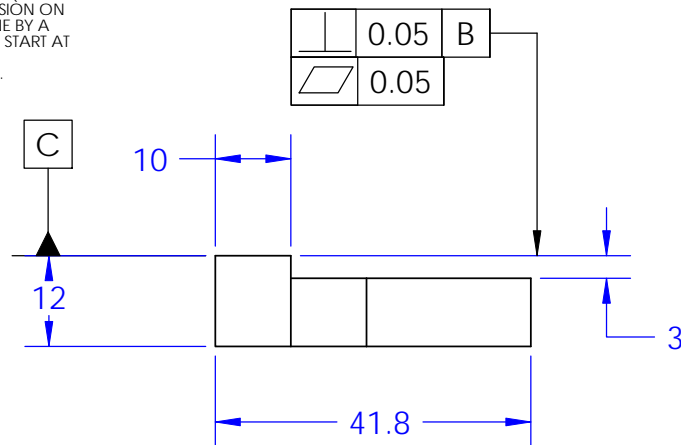

| NOTES AND TOLERANCES: (UNLESS OTHERWISE SPECIFIED) | |
|--|--|
| DIMENSIONS ARE IN mm | 1. INTERPRET DRAWING PER ASME Y14.5-1994. |
| TOLERANCES: X ± 0.1 XX ± 0.01 | 2. REMOVE ALL SHARP EDGES, R.5 MIN. |
| ANGULAR ± 0.2° | 3. DO NOT SCALE FROM DRAWING. |
| | 4. ALL MACHINING FLUIDS MUST BE FULLY SYNTHETIC, FULLY WATER SOLUBLE AND FREE OF SULFUR, SILICONE, AND CHLORINE. |
| MATERIAL | NATURAL PEEK |
| FINISH | 1.6 μm |

| | |
|---|----------------------|
| CALIFORNIA INSTITUTE OF TECHNOLOGY MASSACHUSETTS INSTITUTE OF TECHNOLOGY | |
| SYSTEM | aLIGO |
| SUB-SYSTEM | SUS |
| NEXT ASSY | ETM Penultimate mass |

| | | | |
|-----------|------------|-------------------------------|------------|
| PART NAME | | Penultimate mass prism holder | |
| DESIGNER | M v Veggel | DATE | 25/01/2010 |
| DRAFTER | R Jones | DATE | 02/08/2010 |
| CHECKER | R Jones | DATE | 02/08/2010 |
| APPROVAL | | SCALE: | 1:1 |
| SIZE | DWG. NO. | PROJECTION: | |
| A | D1000128 | | |
| REV. | v2 | SHEET | 1 OF 1 |