

REV.	DATE	DCN #	DRAWING TREE #

NOTES CONTINUED:

⑤ SCRIBE, ENGRAVE, OR MECHANICALLY STAMP (NO INKS OR DYES) DRAWING PART NUMBER AND REVISION ON NOTED SURFACE FOLLOWED ON THE NEXT LINE BY A THREE DIGIT SERIAL NUMBER. SERIAL NUMBERS START AT 001 FOR THE FIRST ARTICLE AND PROCEED CONSECUTIVELY. USE 07" HIGH CHARACTERS. EXAMPLE: DXXXXXX-VY, S/N 001. A VIBRATORY TOOL MAY BE USED.

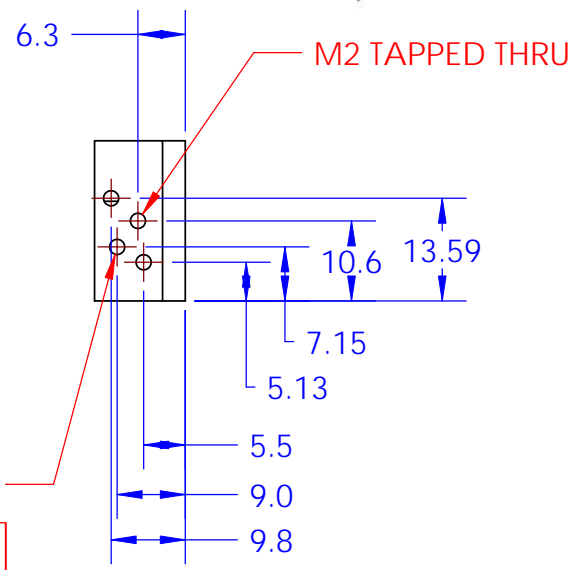
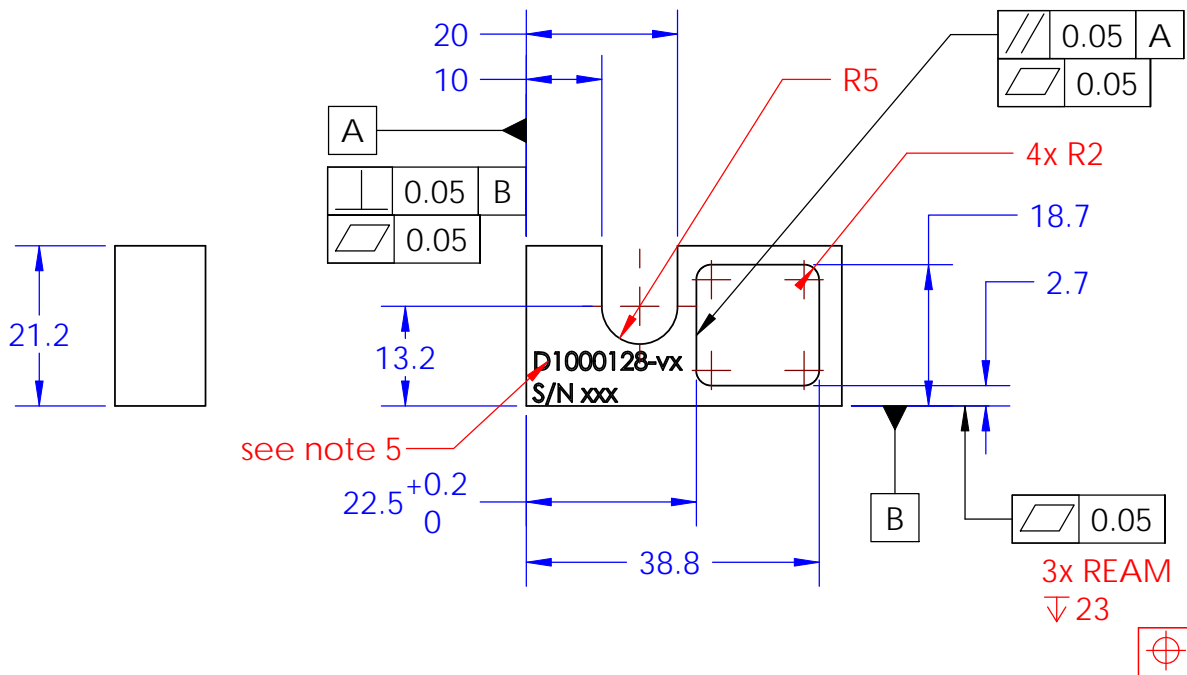
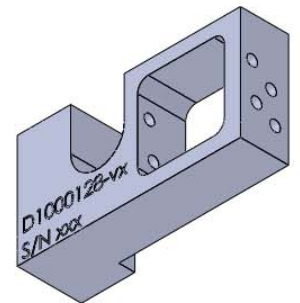
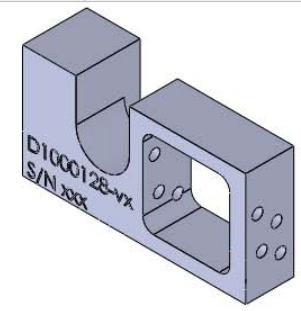
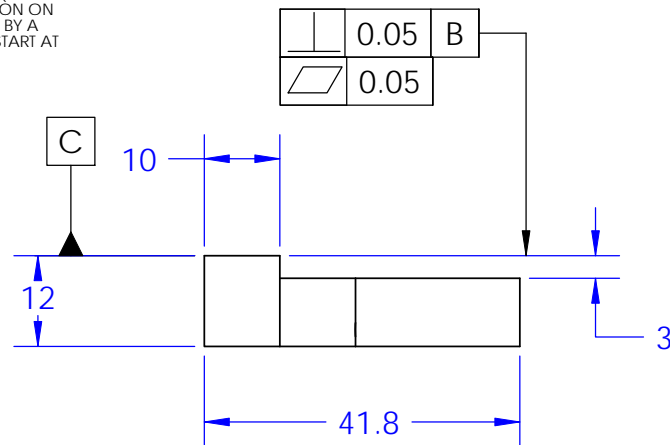

NOTES AND TOLERANCES: (UNLESS OTHERWISE SPECIFIED)	
DIMENSIONS ARE IN mm	1. INTERPRET DRAWING PER ASME Y14.5-1994.
TOLERANCES: XX ± 0.1 XXX ± 0.01	2. REMOVE ALL SHARP EDGES, R.5 MIN.
ANGULAR ± 0.2°	3. DO NOT SCALE FROM DRAWING.
	4. ALL MACHINING FLUIDS MUST BE FULLY SYNTHETIC, FULLY WATER SOLUBLE AND FREE OF SULFUR, SILICONE, AND CHLORINE.
MATERIAL	NATURAL PEEK
FINISH	1.6 µm

CALIFORNIA INSTITUTE OF TECHNOLOGY MASSACHUSETTS INSTITUTE OF TECHNOLOGY	
SYSTEM	aLIGO
SUB-SYSTEM	SUS
NEXT ASSY	ETM Penultimate mass

PART NAME		Penultimate mass prism holder	
DESIGNER	M v Veggel	DATE	25/01/2010
DRAFTER	R Jones	DATE	26/01/2010
CHECKER		DATE	
APPROVAL		DATE	
SIZE	DWG. NO.	REV.	
A	D1000128	v1	
SCALE:	1:1	PROJECTION:	
			SHEET 1 OF 1