

NOTES CONTINUED:

REV.	DATE	DCN #	DRAWING TREE #

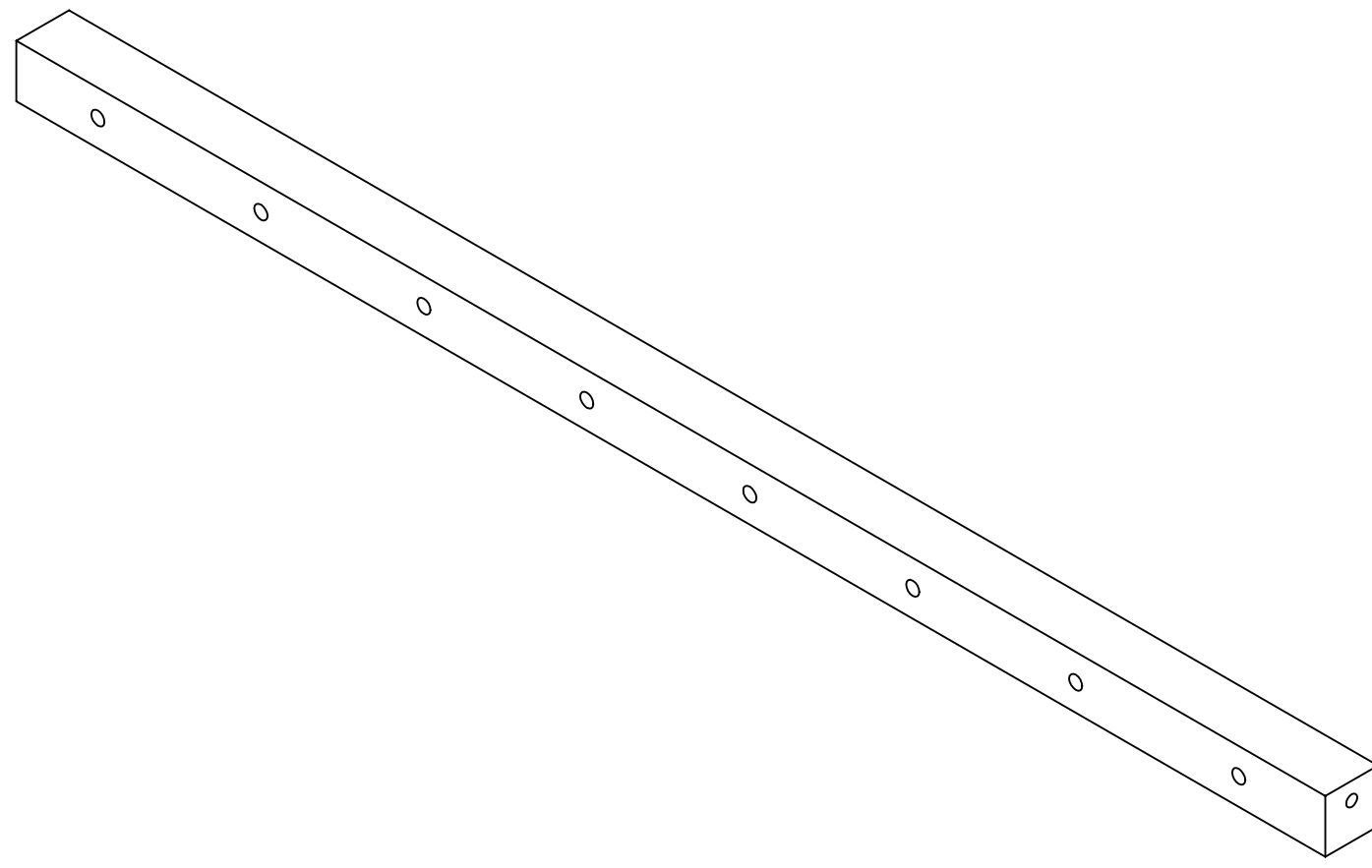

ISOMETRIC VIEW



1-HOLE TAPPED 8-32 UNC-1B
(LOOSE FIT)
0.164 MIN. LENGTH FULL THREAD
0.258 MAX. DRILL DEPTH
BOTH ENDS POSITIONED AS
SHOWN

ϕ 0.004

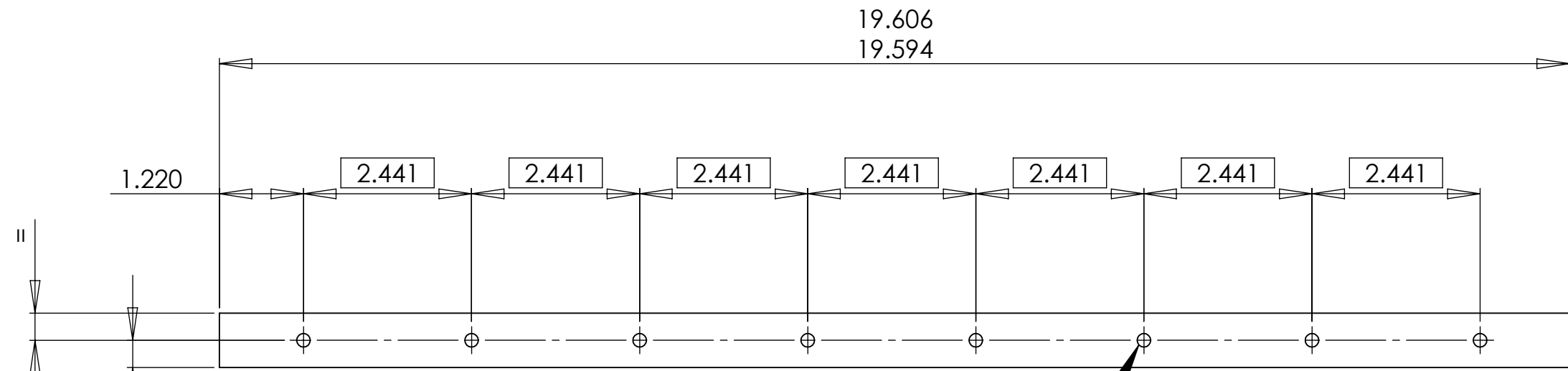
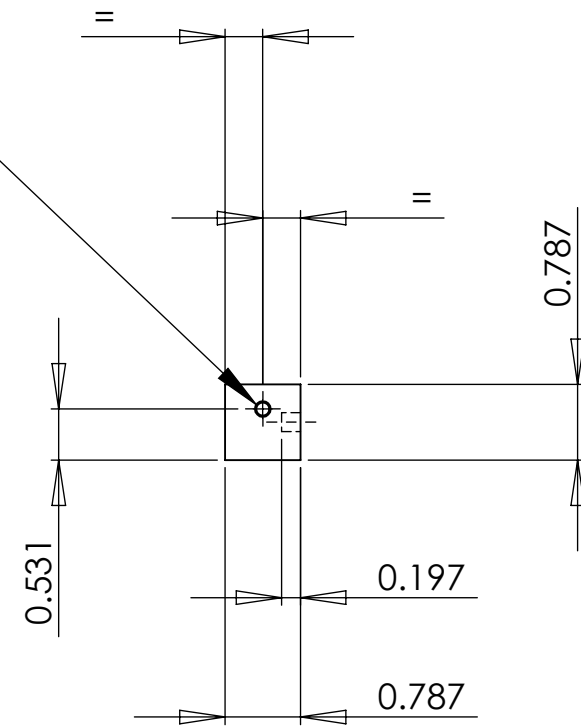

8-HOLES FLAT NOSE DRILL ϕ 0.197/0.200
TO DEPTH SHOWN POSITIONED AS
SHOWN

ϕ 0.004

NOTES AND TOLERANCES: (UNLESS OTHERWISE SPECIFIED)

DIMENSIONS ARE IN INCHES

GENERAL TOLERANCES:
0<X<2" : ±0.004"
2<X<6" : ±0.008"
6<X<40" : ±0.012"
ANGULAR : ± 0.2°

GEOMETRIC TOLERANCES:
ISO-2768-K

1. INTERPRET DRAWING PER ASME Y14.5-1994.
2. REMOVE ALL SHARP EDGES 0.02 ±0.01 AND REMOVE ALL BURRS.
3. DO NOT SCALE FROM DRAWING.
4. ALL MACHINING FLUIDS SHALL BE WATER SOLUBLE AND FREE OF SULFUR, CHLORINE AND SILICONE, SUCH AS CINCINNATI MILACRON'S CIMTECH 410.

MATERIAL ALUMINIUM **FINISH** 125 μ inch

LIGO CALIFORNIA INSTITUTE OF TECHNOLOGY
MASSACHUSETTS INSTITUTE OF TECHNOLOGY

SYSTEM ADVANCED LIGO **SUB-SYSTEM** SUS

NEXT ASSY

PART NAME HORIZONTAL TIE BAR (MIT)

DESIGNER	L.CUNNINGHAM	01/12/2009	SIZE	DWG. NO.	REV.
DRAFTER	K.MCINTYRE	15/12/2009	C	LIGO-D1000018	03
CHECKER	B.HENDERSON	21/12/2009			
APPROVAL	B.HENDERSON	21/12/2009			

SCALE: 1:2 PROJECTION: SHEET 1 OF 1