

REV	DATE	CHK'D	APPROVAL	DESCRIPTION
A	7/27/2007		A. STERN	INITIAL RELEASE

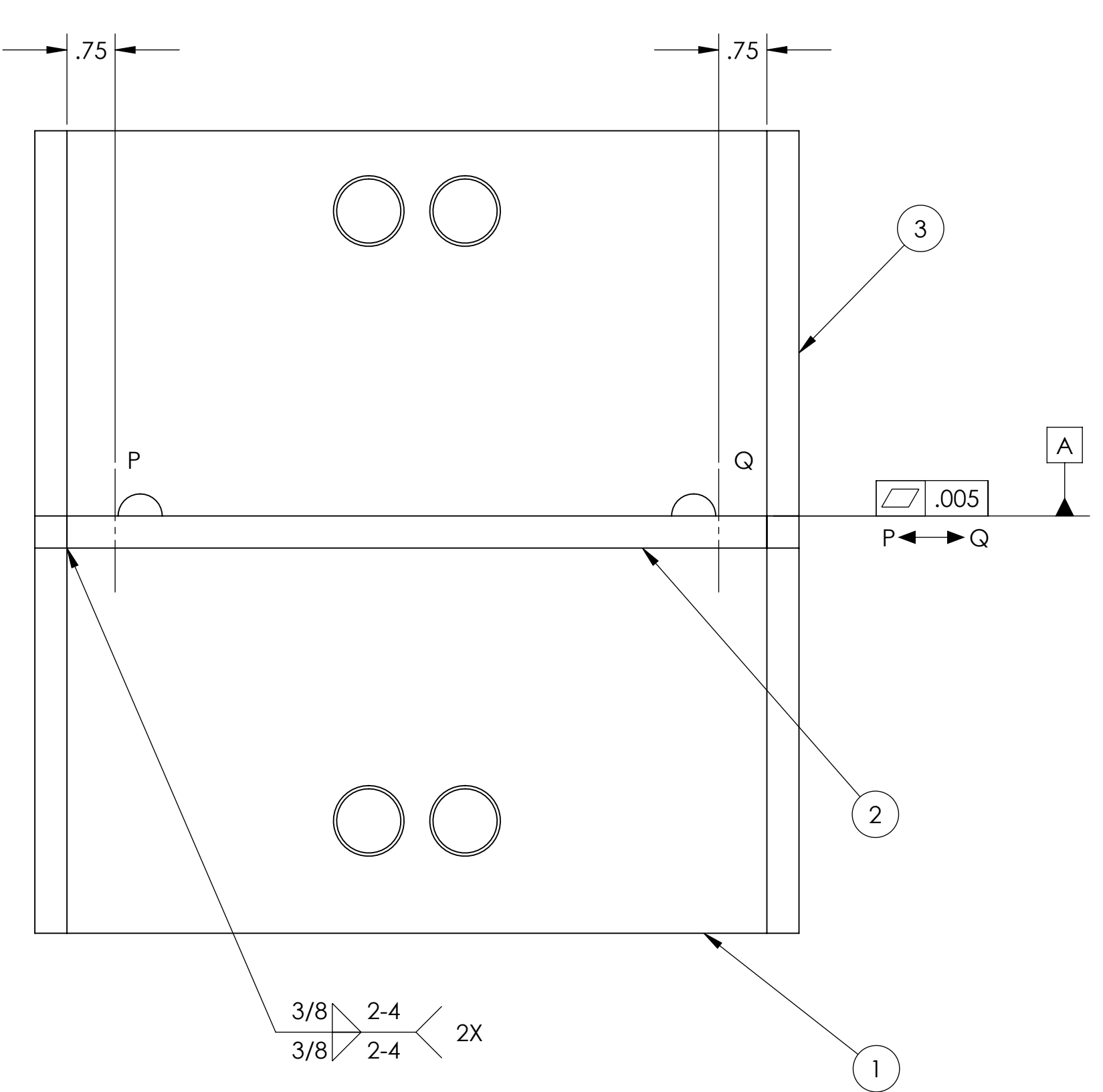
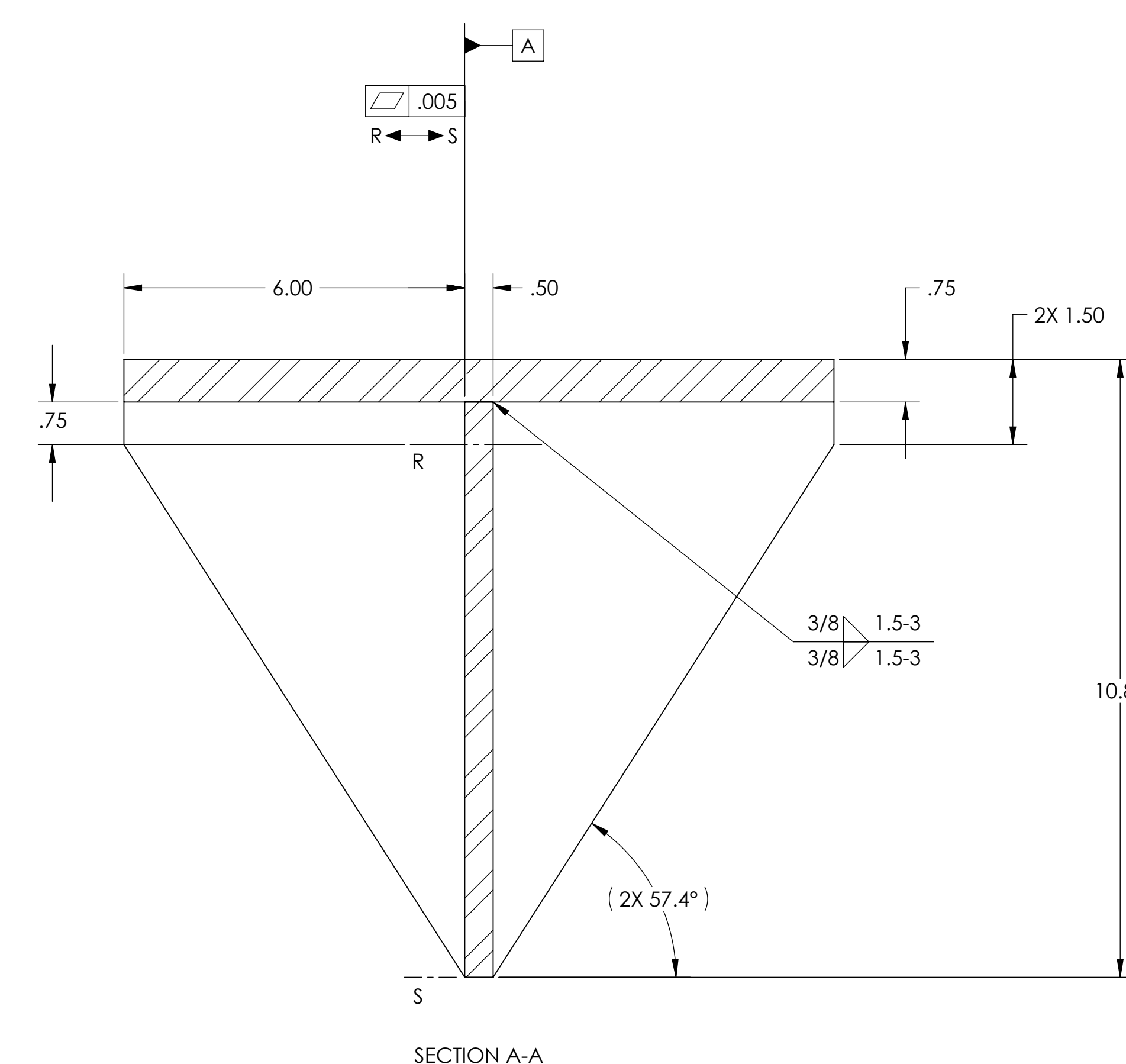
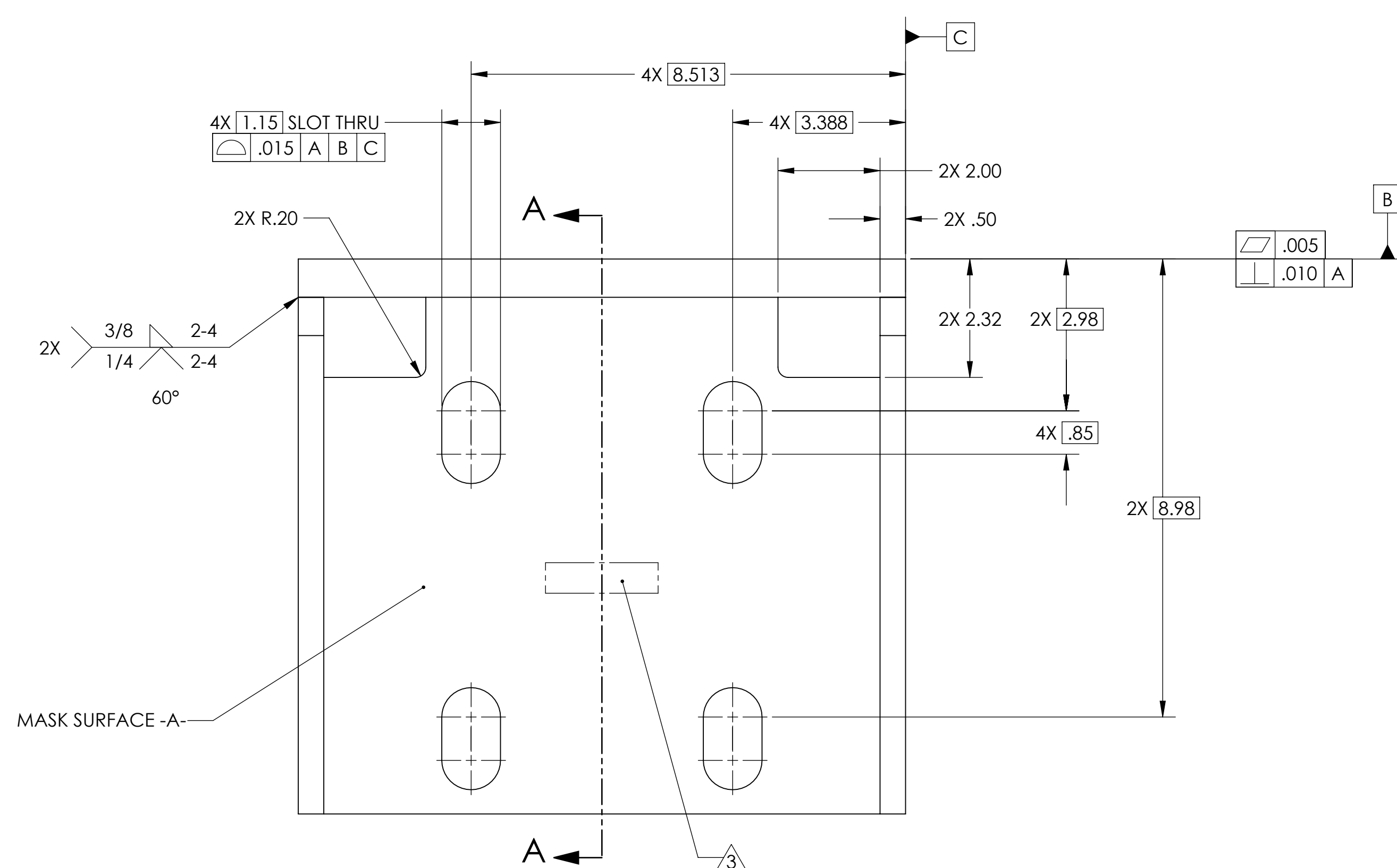
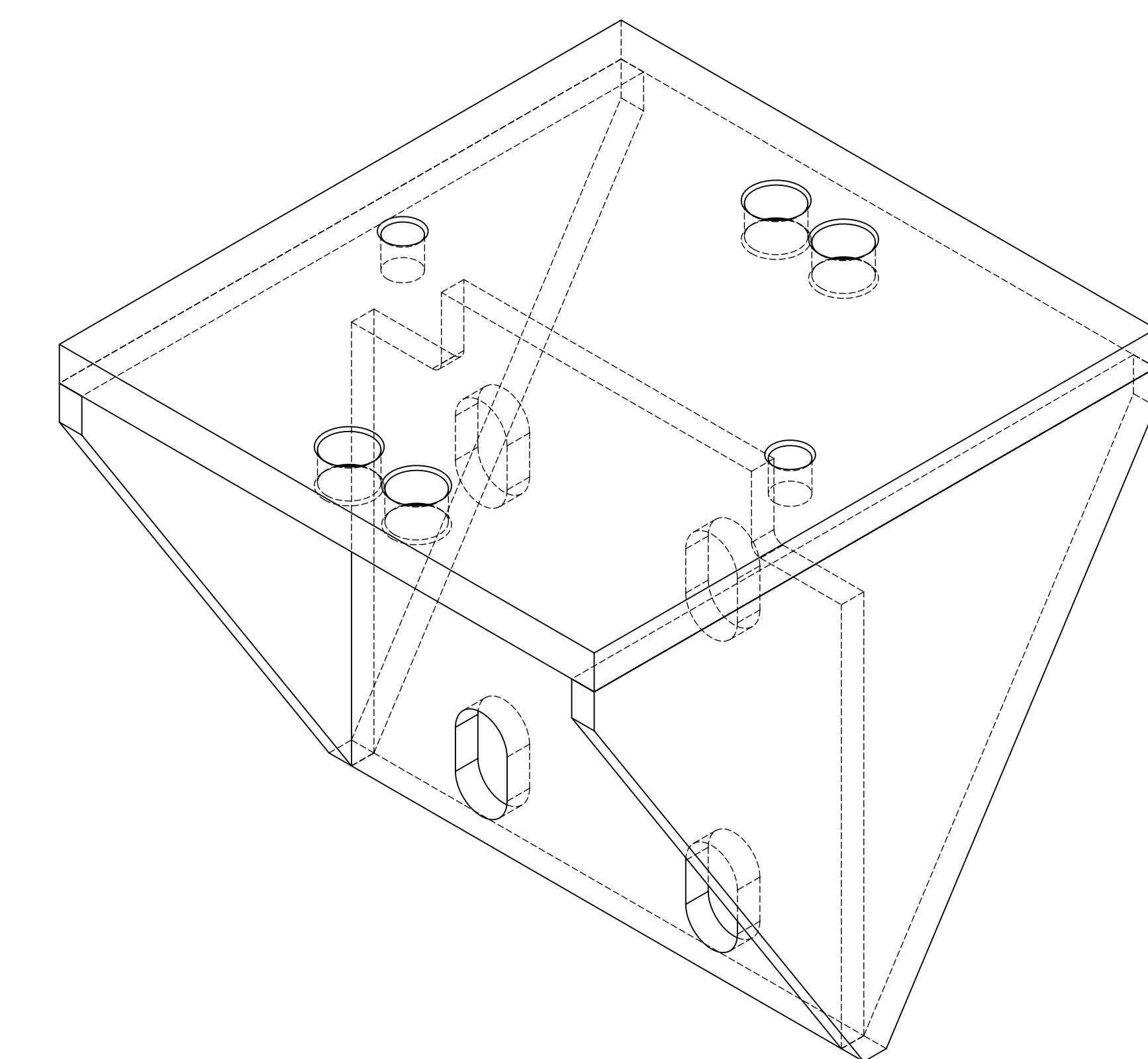
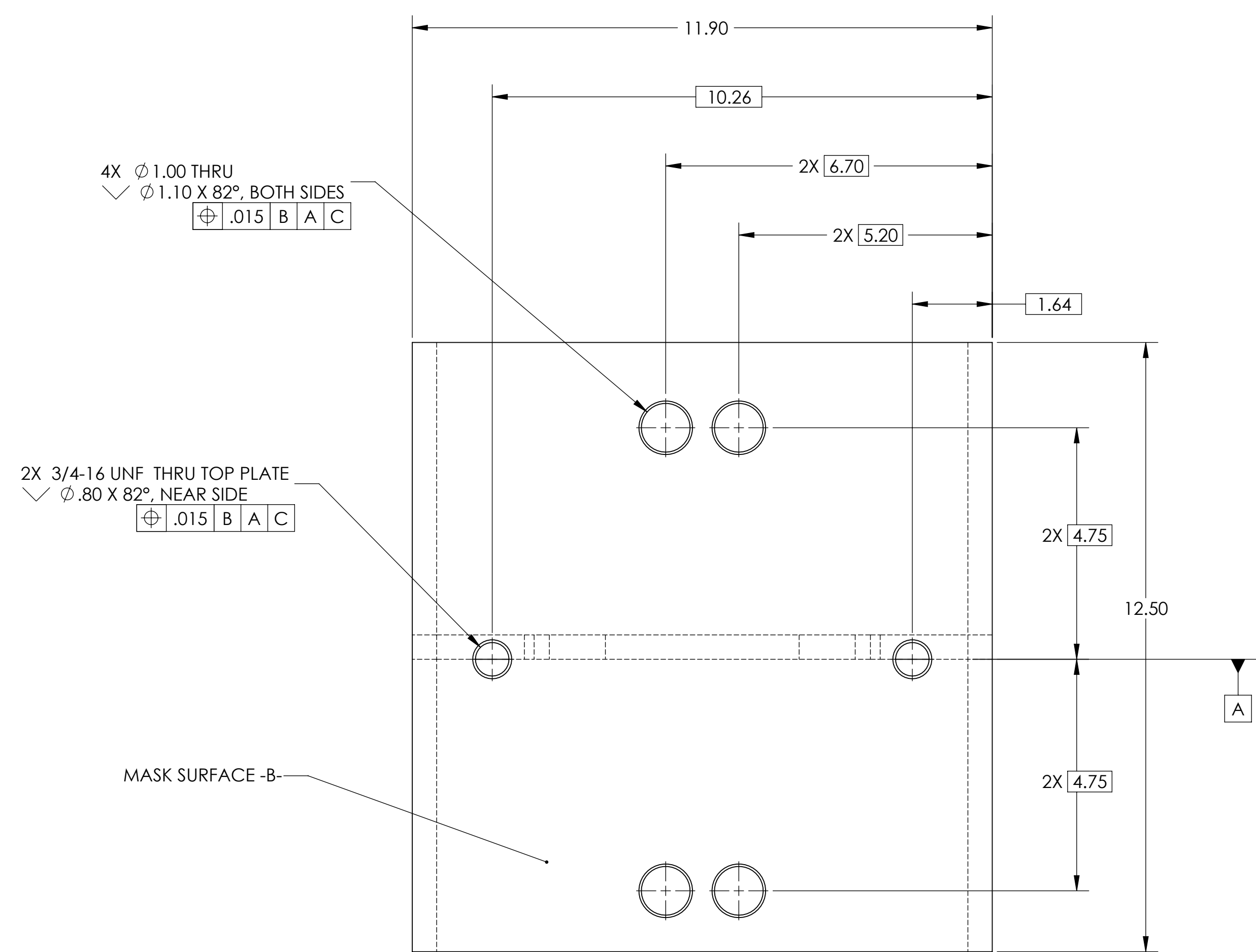

- NOTES:
1. THOROUGHLY CLEAN PART TO REMOVE ALL OIL, GREASE, DIRT, AND CHIPS.
 2. ALL MACHINING FLUIDS MUST BE WATER SOLUBLE AND FREE OF SULFUR, CHLORINE, AND SILICONE, SUCH AS CINCINNATI MILACRON CIMTECH 410.
 3. WHERE INDICATED, MECHANICALLY SCRIBE, STAMP, OR ENGRAVE (VIBRATORY ACCEPTABLE) THE FOLLOWING INFORMATION AS SHOWN BELOW: PART NUMBER-REVISION, USE 0.12" TALL CHARACTERS UNLESS PART SIZE DICTATES SMALLER.
D070276-A
 4. PAINT SMOOTH WHITE. SHERWIN WILLIAMS POLANE T-PLUS POLYURETHANE ENAMEL. MASK ALL HOLES AND AREAS MARKED ON PRINT.
 5. PRIME WITH SHERWIN WILLIAMS INDUSTRIAL WASH PRIMER P60G2.

ITEM NO.	Fincl Match ne/QT Y.	Description	Material
1	1	PLATFORM, TOP PLATE	A36 STEEL
2	1	PLATFORM, FRONT PLATE	A36 STEEL
3	2	PLATFORM, SIDE PLATE	A36 STEEL

UNLESS OTHERWISE SPECIFIED	ALL DIMENSIONS ARE IN INCHES	UNLESS OTHERWISE SPECIFIED	ALL DIMENSIONS ARE IN INCHES
FINISH	SEE BOM	SEE NOTES	SEE BOM
DATE	7/27/2007	DATE	7/27/2007
DESIGNER	E	DESIGNER	E
APPROVER		APPROVER	
PART NAME	TEST STAND, HAM ISI	PART NAME	TEST STAND PLATFORM WELDMENT
REV	A	REV	A
SCALE	1:1	SCALE	1:1
SHEET	1 OF 1	SHEET	1 OF 1