

D0902663_Advanced_LIGO_SUS_HLTS_Sapphire_Holder_Assembly, PART PDM REV: V1-001, DRAWING PDM REV: V1-000

REV.	DATE	DCN #	DRAWING TREE #
v1	22 OCT 2009	E0900369	E080191
v2	02 SEP 2011	E1100826	E080191
-	-	-	-

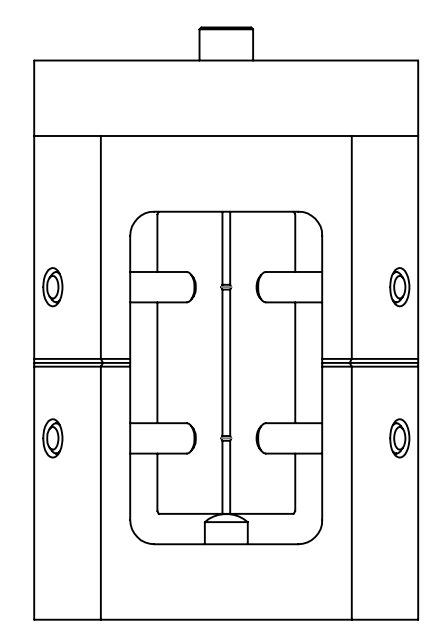
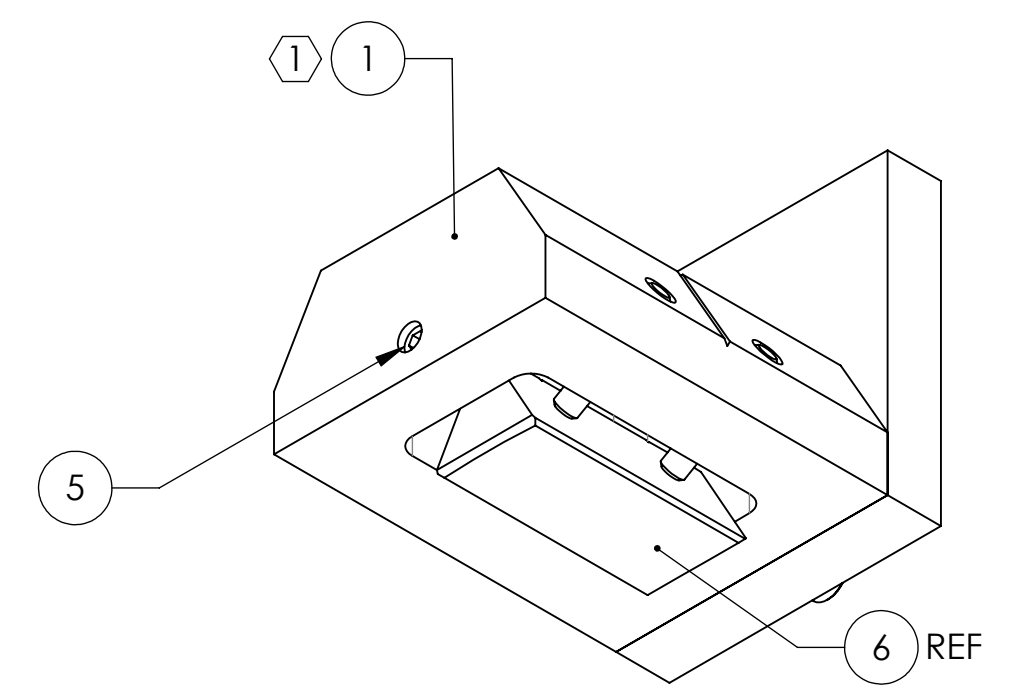
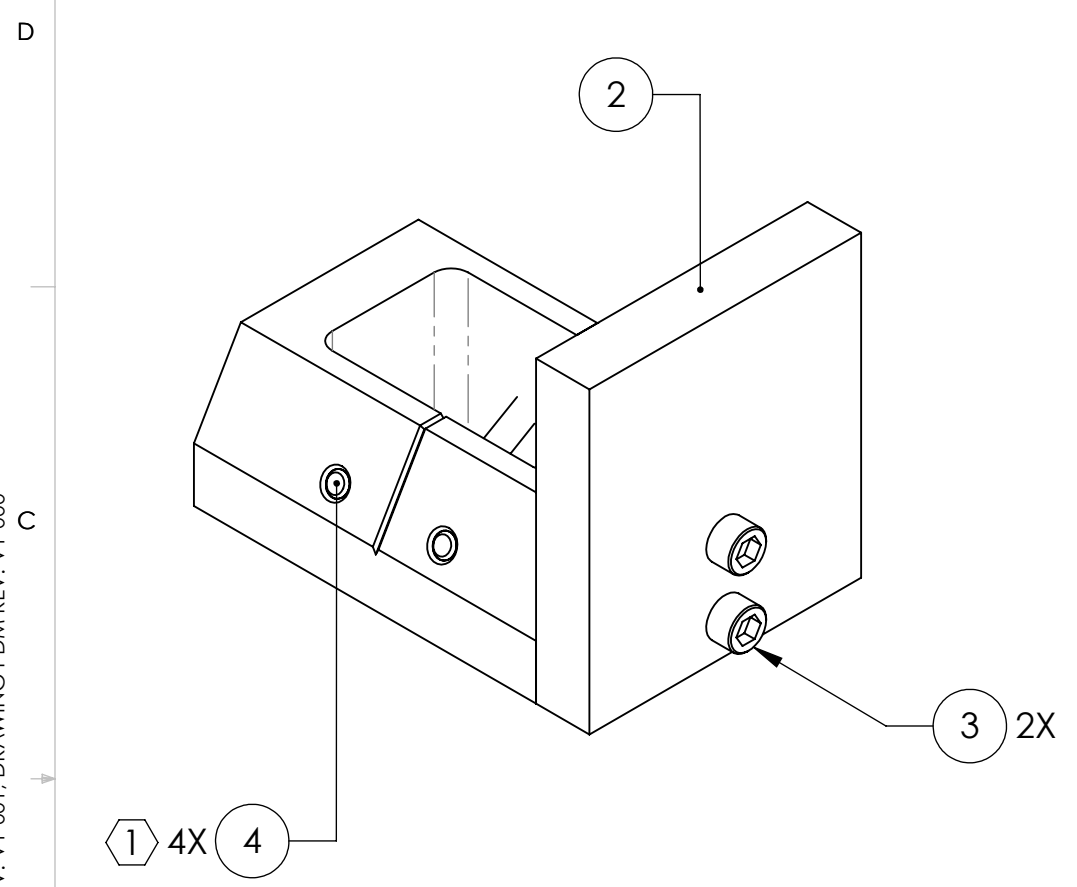

TOP VIEW

ITEM NO.	PART NUMBER	DESCRIPTION	MATERIAL	REQ	SPARE	TOTAL
6	D070441	PRISM BREAKOFF WIRE LOOP	SAPPHIRE	REF	0	0
5	-	SCREW, SOCKET SET, #4-40 UNC-2A X 0.25 LONG, OVAL POINT	300 SSTL	1	1	2
4	91585A018	DOWEL PIN, ϕ 2 mm X 10 mm LONG (MCMASTER CARR P/N)	300 SSTL	4	1	5
3	-	SCREW, SOCKET HEAD CAP, #2-56 UNC-2A X 0.375 LONG	300 SSTL	2	1	3
2	D0902722	SAPPHIRE PRISM HOLDER EXTENSION	6061-T6 Al	1	0	1
1	D0902664	SAPPHIRE PRISM HOLDER	6061-T6 Al	1	1	2

PARTS LIST

NOTES AND TOLERANCES: (UNLESS OTHERWISE SPECIFIED)

① PRESS FIT DOWEL PINS INTO HOLES FLUSH WITH PRISM HOLDER SURFACE, AFTER ALL PARTS ARE CLEANED AND BAKED.

CALIFORNIA INSTITUTE OF TECHNOLOGY MASSACHUSETTS INSTITUTE OF TECHNOLOGY		PART NAME		SAPPHIRE PRISM HOLDER ASSY	
SYSTEM	ADVANCED LIGO	SUB-SYSTEM	SUS	DESIGNER	D. BRIDGES 06 SEP 2011
DRAFTER	D. BRIDGES 07 SEP 2011	CHECKER	B. MOORE 08 SEP 2011	APPROVAL	
MATERIAL	N/A	FINISH	N/A μ inch	SIZE DWG. NO.	B D0902663
NEXT ASSY	SAPPHIRE PRISM BONDING JIG, HLTS	REV.	v2	SCALE: 2:1	PROJECTION: