

REV.	DATE	DCN #	DRAWING TREE #
v1	22 OCT 2009	E0900369	E080191
-	-	-	-
-	-	-	-

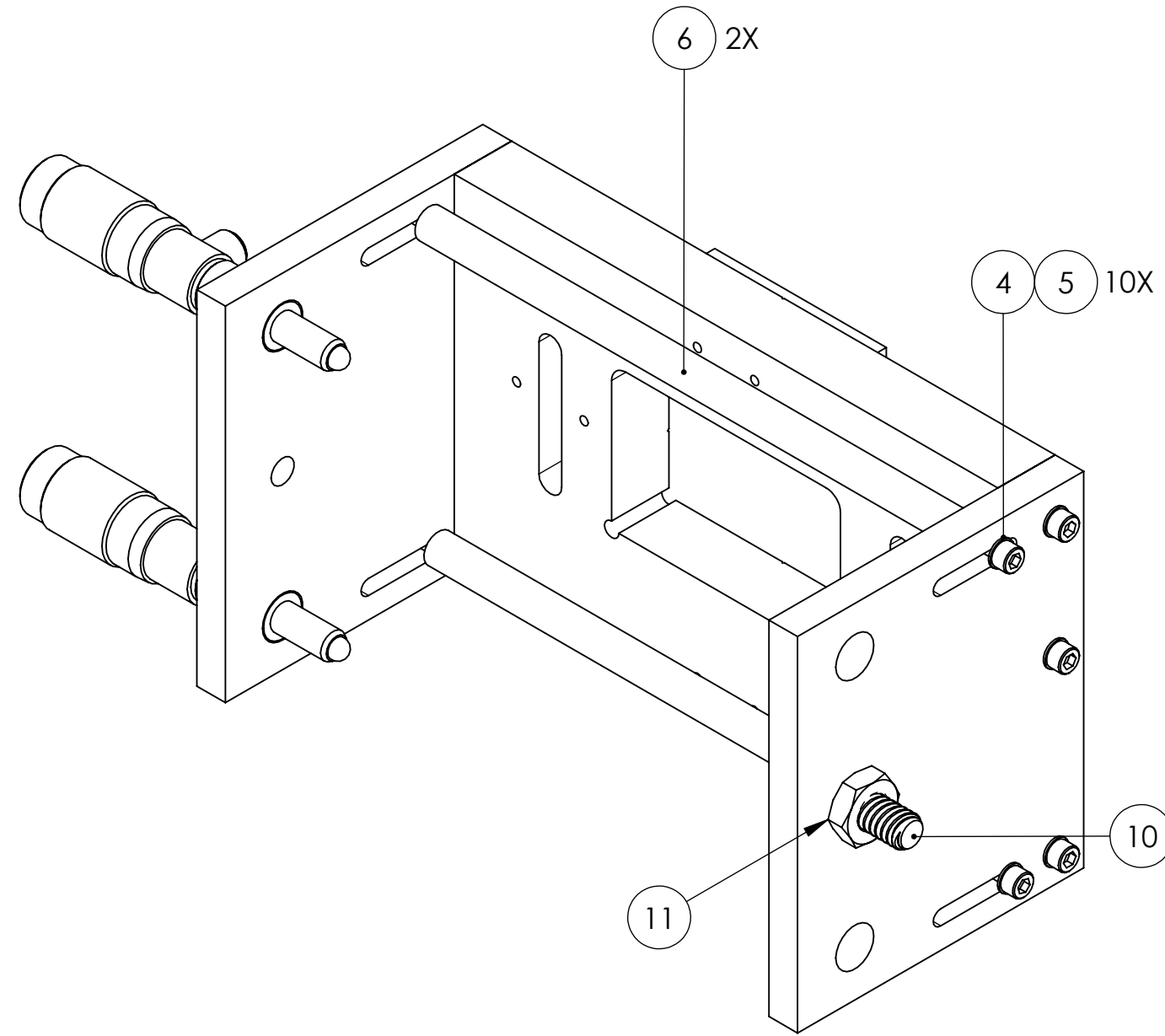
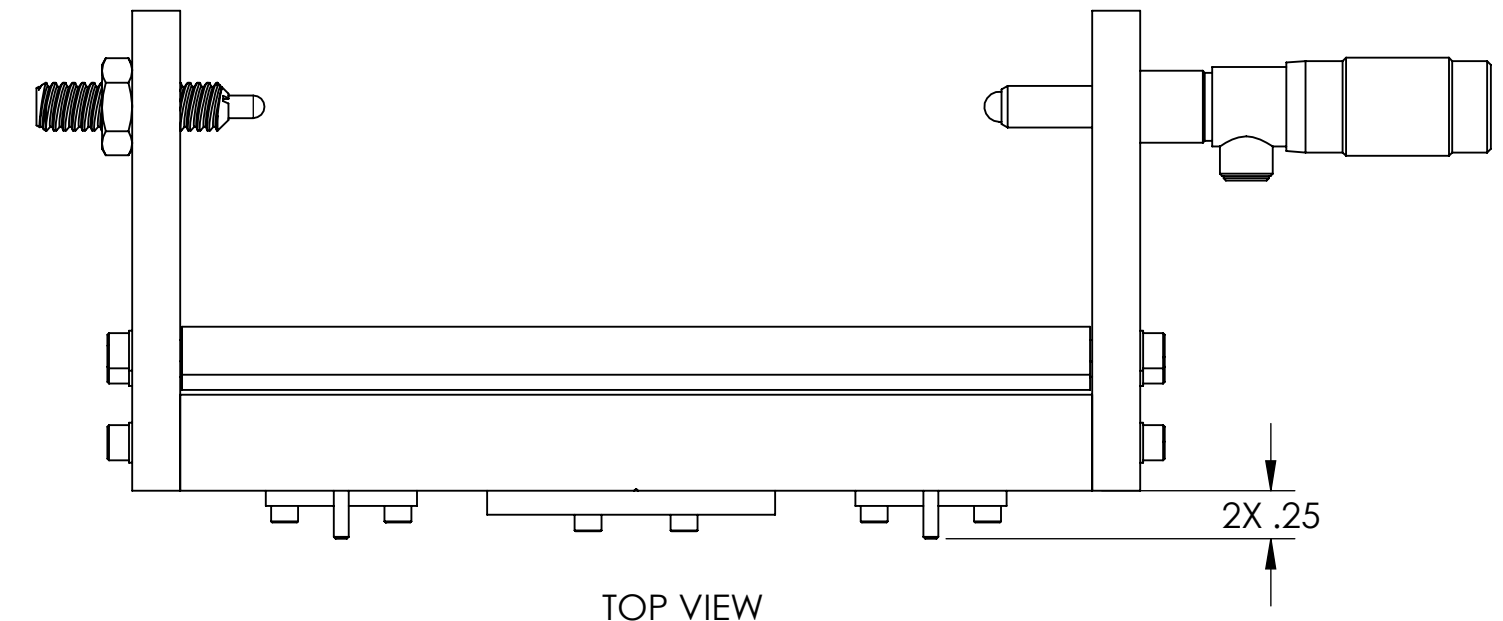
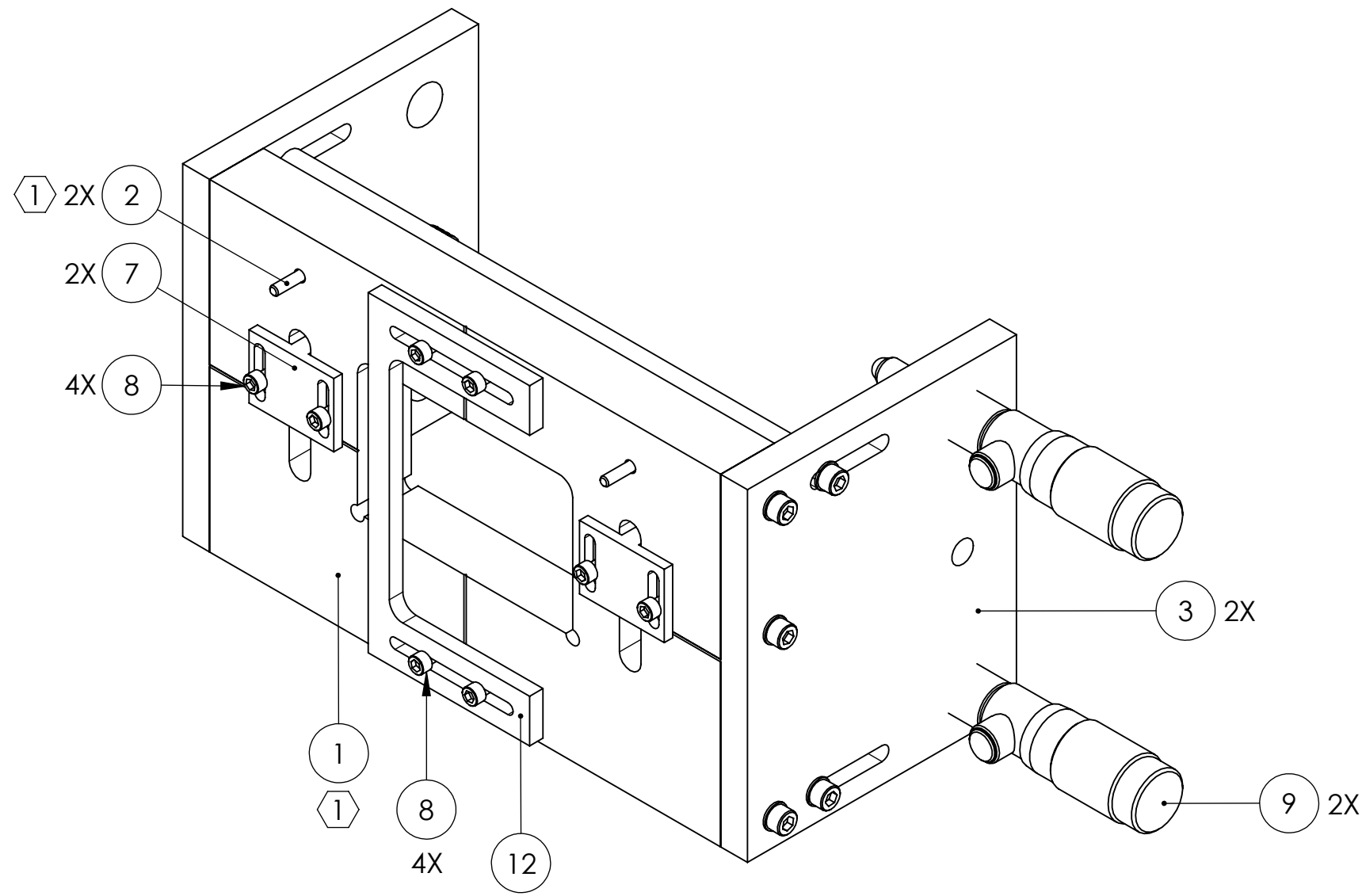

ITEM NO.	PART NUMBER	DESCRIPTION	MATERIAL	REQ	SPARE	TOTAL
12	D0902721	SAPPHIRE PRISM HOLDER GUIDE	6061-T6 AI	1	0	1
11	-	JAM NUT, 1/4-20	300 SSTL	1	1	2
10	8688A151	SPRING PLUNGER, ROUND-NOSE, 1/4-20 X 1 LONG (MCMaster-CARR P/N)	316 SSTL	1	1	2
9	HR-13	LOCKING MICROMETER (NEWPORT CORP. P/N)	6061-T6 AI	2	0	2
8	-	SCREW, SOCKET HEAD CAP, #2-56 UNC-2A X 0.375 LONG	300 SSTL	8	2	10
7	D080409	ALIGNMENT GUIDE	6061-T6 AL	2	0	2
6	D0902669	SUPPORT CYLINDER	PFA440 HP (PRESHRUNK)	2	1	3
5	-	SCREW, SOCKET HEAD CAP, #4-40 UNC-2A X 0.5 LONG	300 SSTL	10	2	12
4	-	WASHER, FLAT, #4 (NAS 620-C4L OR EQUIVALENT)	300 SSTL	10	2	12
3	D0902666	BONDING TEMPLATE SIDE	6061-T6 AI	2	0	2
2	91585A018	DOWEL PIN, ϕ 2 mm X 10 mm LONG (MCMaster CARR P/N) ①	300 SSTL	2	1	3
1	D0902665	BONDING TEMPLATE FRONT ①	6061-T6 AI	1	0	1
PARTS LIST						

NOTES AND TOLERANCES: (UNLESS OTHERWISE SPECIFIED)

① PRESS FIT DOWEL PINS INTO HOLES AS SHOWN AFTER ALL PARTS ARE CLEANED AND BAKED.

DIMENSIONS ARE IN INCHES

TOLERANCES:
 .XX ± .01
 .XXX ± .005

MATERIAL

N/A

FINISH

N/A μ inch

LIGO CALIFORNIA INSTITUTE OF TECHNOLOGY
 MASSACHUSETTS INSTITUTE OF TECHNOLOGY

SYSTEM

ADVANCED LIGO

SUB-SYSTEM

SUS

NEXT ASSY

SAPPHIRE PRISM BONDING JIG, HLTS

PART NAME

SAPPHIRE PRISM BONDING FIXTURE

DESIGNER

D. BRIDGES

12 NOV 2009

SIZE

C

DRAFTER

D. BRIDGES

17 NOV 2009

CHECKER

M. MEYER

19 NOV 2009

APPROVAL

DWG. NO.

D0902662

REV.

v1

SCALE: 1:1

PROJECTION:

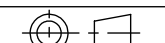

SHEET 1 OF 1