

REV.	DATE	DCN #	DRAWING TREE #
v1	22 OCT 2009	E0900369	-
v2	02 SEP 2011	E1100826	-
-	-	-	-

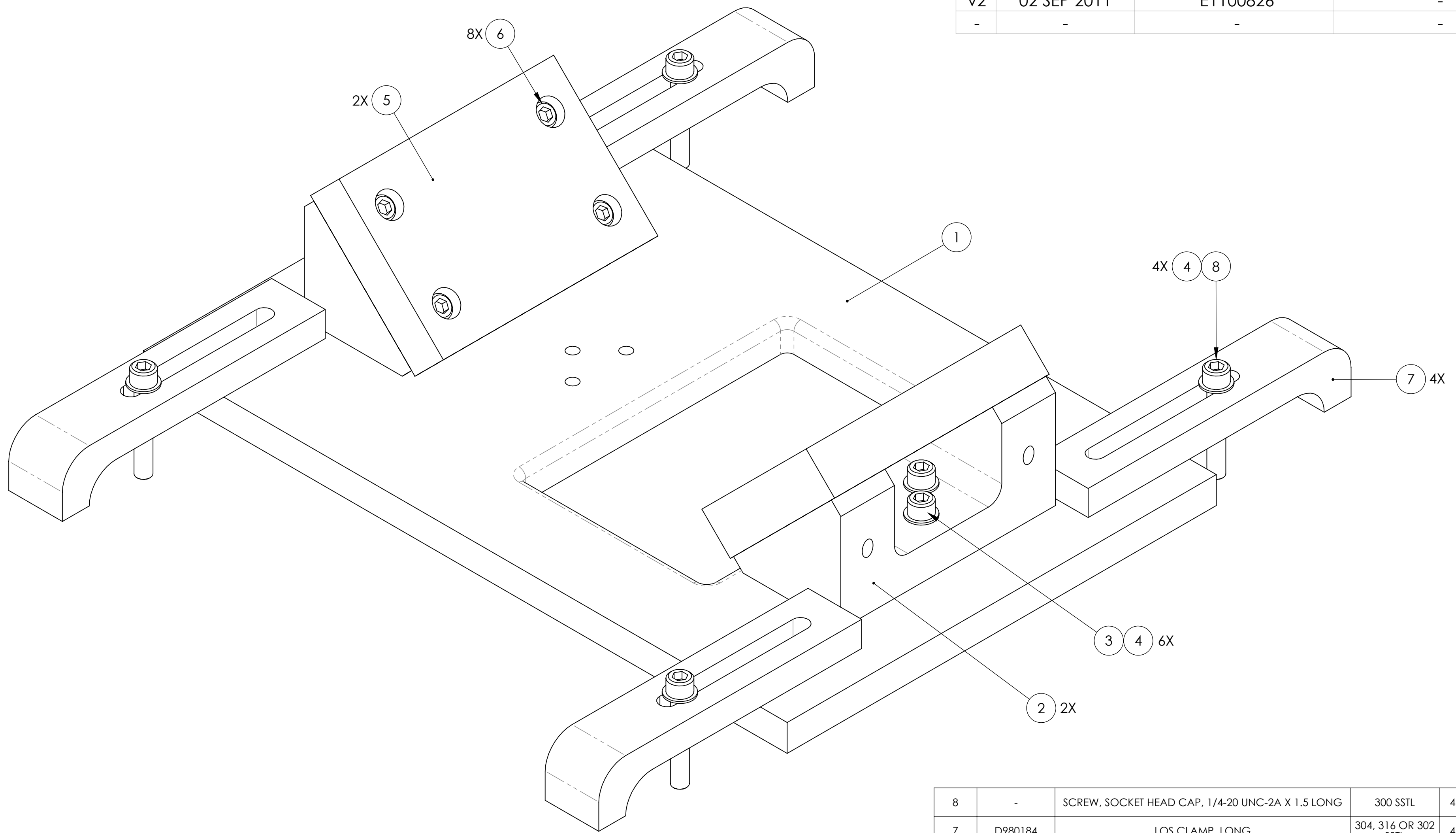

ITEM NO.	PART NUMBER	DESCRIPTION	MATERIAL	REQ	SPARE	TOTAL
8	-	SCREW, SOCKET HEAD CAP, 1/4-20 UNC-2A X 1.5 LONG	300 SSSL	4	1	5
7	D980184	LOS CLAMP, LONG	304, 316 OR 302 SSSL	4	0	4
6	-	SCREW, SOCKET HEAD CAP, 1/4-20 UNC-2A X 0.75 LONG	300 SSSL	8	2	10
5	D0902585	OPTIC REST PLATE	PFA440 HP (PRESHRUNK)	2	0	2
4	-	WASHER, FLAT, 1/4 (NAS 620-C416L OR EQUIVALENT)	300 SSSL	10	3	13
3	-	SCREW, SOCKET HEAD CAP, 1/4-20 UNC-2A X 1 LONG	300 SSSL	6	2	8
2	D0902461	OPTIC REST WEDGE	6061-T6 AI	2	0	2
1	D0902460	BASE PLATE	6061-T6 AI	1	0	1
PARTS LIST						

NOTES AND TOLERANCES: (UNLESS OTHERWISE SPECIFIED)

LIGO CALIFORNIA INSTITUTE OF TECHNOLOGY
 MASSACHUSETTS INSTITUTE OF TECHNOLOGY

PART NAME
OPTIC HOLDER, HAM TRIPLE SUS.

SYSTEM
 ADVANCED LIGO

SUB-SYSTEM
 SUS

DESIGNER	D. BRIDGES	09 SEP 2011	SIZE	DWG. NO.	REV.
DRAFTER	D. BRIDGES	09 SEP 2011	c	D0902658	v2
CHECKER	B. MOORE	09 SEP 2011			
APPROVAL			SCALE: 1:1	PROJECTION:	SHEET 1 OF 1

MATERIAL
 N/A

FINISH
 N/A μinch

NEXT ASSY
 MULTIPLE ASSYS