

D0902526_AdvLIGO_SUS_HSTS_Intermediate Wire Jig Assembly, PART PDM REV: X-010, DRAWING PDM REV: X-010

NOTES:
 ① HELICOILS TO BE INSTALLED INTO ITEM NO. 2 BY LIGO PRIOR TO ASSEMBLY AND AFTER ALL PARTS ARE CLEANED AND BAKED.

REV.	DATE	DCN #	DRAWING TREE #
v1	09 APR 2010	E0900502	E0900353
v2	02 SEP 2010	E1000347	E0900353
-	-	-	-

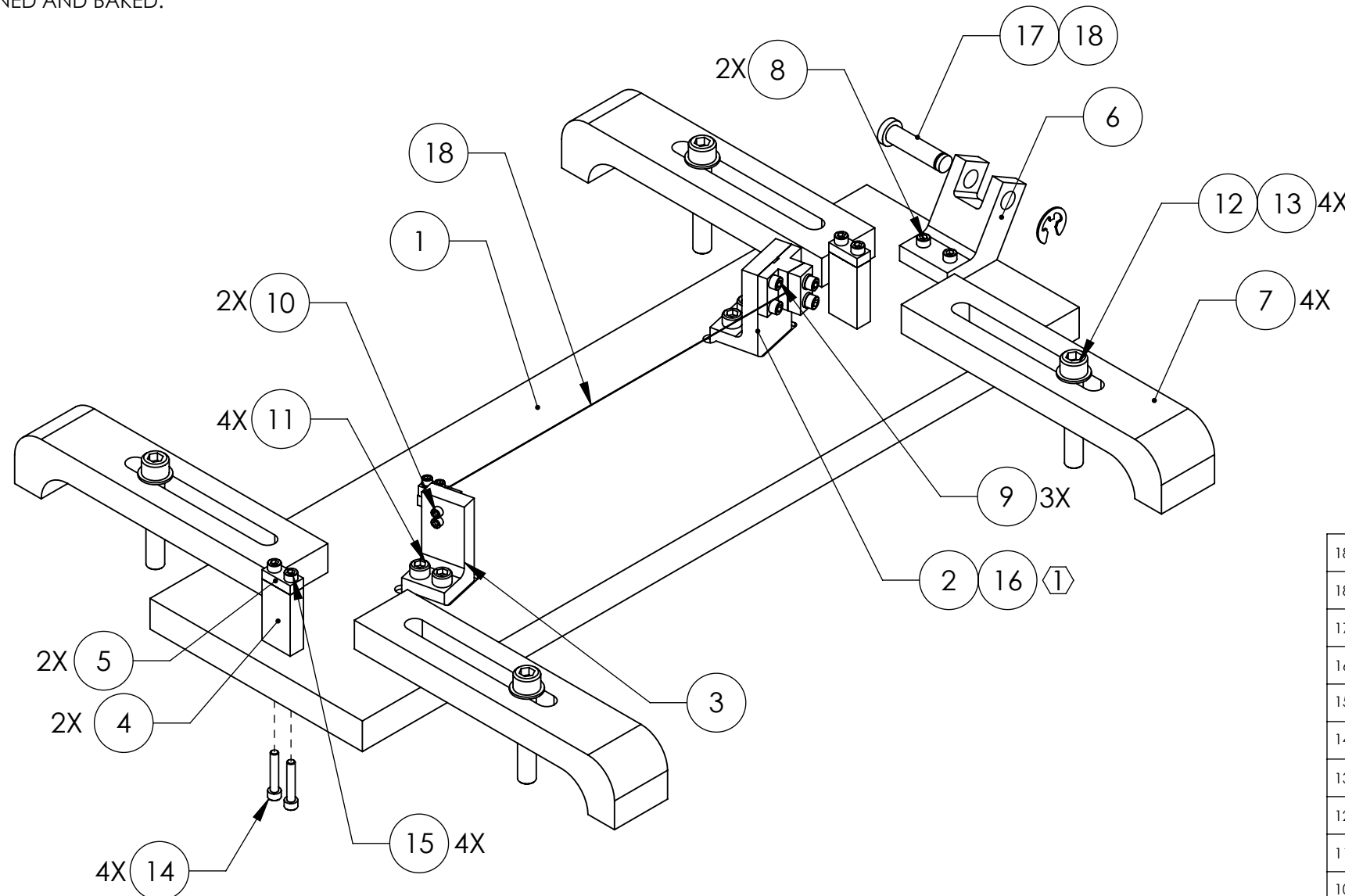

18	D0901905	INTERMEDIATE WIRE ASSEMBLY, HSTS	N/A	REF	-	REF
18	98408A120	RETAINING RING (MCMASTER-CARR P/N)	300 SSSL	1	-	1
17	92735A230	CLEVIS PIN (MCMASTER-CARR P/N)	300 SSSL	1	-	1
16	1185-04EN224	HELICOIL, #4-40 X 0.224 LONG ①	NITRONIC 60	3	1	4
15	-	SCREW, SOCKET HEAD CAP, #4-40 UNC-2A X 0.375 LONG	Ag-PLATED 300 SSSL	4	1	5
14	-	SCREW, SOCKET HEAD CAP, #4-40 UNC-2A X 0.625 LONG	Ag-PLATED 300 SSSL	4	1	5
13	-	WASHER, FLAT, 1/4 (NAS 620-C416L OR EQUIVALENT)	300 SSSL	4	1	5
12	-	SCREW, SOCKET HEAD CAP, 1/4-20 UNC-2A X 1.5 LONG	300 SSSL	4	1	5
11	-	SCREW, SOCKET HEAD CAP, #8-32 UNC-2A X 0.625 LONG	300 SSSL	4	1	5
10	-	SCREW, SOCKET HEAD CAP, #2-56 UNC-2A X 0.375 LONG	Ag-PLATED 300 SSSL	2	1	3
9	-	SCREW, SOCKET HEAD CAP, #4-40 UNC-2A X 0.375 LONG	300 SSSL	3	-	3
8	-	SCREW, SOCKET HEAD CAP, #4-40 UNC-2A X 0.5 LONG	300 SSSL	2	-	2
7	D980184	LOS CLAMP, LONG	304, 316 OR 302 SSSL	4	-	4
6	D0900563	PIN SUPPORT, WIRE JIG	6061-T6 AI	1	-	1
5	D1000583	WIRE START CLAMP, TOP	304, 316 OR 302 SSSL	2	-	2
4	D1000628	WIRE START POST, INTERMEDIATE WIRE JIG	304, 316 OR 302 SSSL	2	-	2
3	D0902532	BLADE WIRE CLAMP BRACKET, HSTS INTERMEDIATE WIRE JIG	6061-T6 AI	1	-	1
2	D0902533	MASS WIRE CLAMP BRACKET, HSTS INTERMEDIATE WIRE JIG ①	6061-T6 AI	1	-	1
1	D0902535	BASE PLATE, HSTS INTERMEDIATE WIRE JIG	6061-T6 AI	1	-	1
ITEM NO.	PART NUMBER	DESCRIPTION	MATERIAL	QTY.	SPARE	TOTAL

PARTS LIST

CALIFORNIA INSTITUTE OF TECHNOLOGY MASSACHUSETTS INSTITUTE OF TECHNOLOGY		PART NAME INTERMEDIATE WIRE JIG ASSEMBLY, HSTS			
SYSTEM ADVANCED LIGO	SUB-SYSTEM SUS	DESIGNER W. RASCH	20 OCT 2009	SIZE	DWG. NO. D0902526
DRAFTER W. RASCH	CHECKER M. MEYER	09 30 2009	09 30 2009	B	REV. v2
NEXT ASSY D040391	APPROVAL	SCALE: 1:2	PROJECTION:		SHEET 1 OF 1