

4

3

2

1

NOTE:

Ⓛ ITEM NO. 2 TO BE CLEANLY PRESS FIT INTO ITEM NO. 1 AND ITEM NO. 4 BY LIGO AFTER ALL ITEMS ARE CLEANED AND BAKED.

REV.	DATE	DCN #	DRAWING TREE #
v1	09 JUL 2010	E0900501	E0900353
-	-	-	-
-	-	-	-

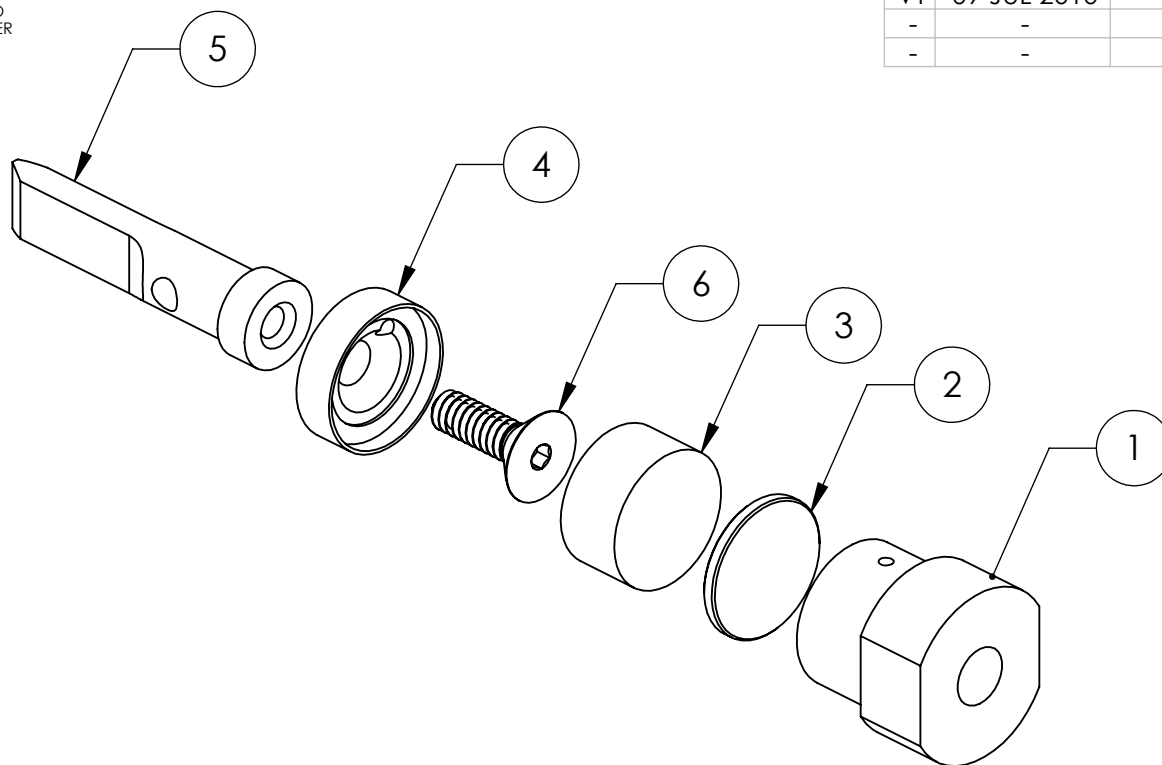

6	94518A108 (McMASTER-CARR P/N)	SS FLAT HEAD #4-40 X 3/8" SCREW	300 SSSL	1	-	1
5	D1100573	BOSEM FLAG , αLIGO SUS	6061-T6 Al	1	-	1
4	D1100574	BOSEM FLAT FLAG DISK αLIGO SUS	416 SSSL	1	-	1
3	DCNI 00626/N	SINTERED NdFeB MAGNET, Ni-PLATED, 10 mm X 5 mm (MMG MAGDEV P/N OR EQUIVALENT)	NEO 35 (NdFeB)	1	-	1
2	D1001534	MAGNETIC PLUG	416 SSSL	1	-	1
1	D0902423	MAGNET HOLDER (LONG), UPPER MASS	6061-T6 Al	1	-	1
ITEM NO.	PART NUMBER	DESCRIPTION	MATERIAL	REQ	SPARE	TOTAL

PARTS LIST

CALIFORNIA INSTITUTE OF TECHNOLOGY MASSACHUSETTS INSTITUTE OF TECHNOLOGY		PART NAME		MAGNET/FLAG ASSY (LONG), UPPER MASS		
SYSTEM	ADVANCED LIGO	SUB-SYSTEM	SUS	DESIGNER	M. MEYER 26 OCT 2009	SIZE DWG. NO.
NEXT ASSY	MULTIPLE ASSYS		DRAFTER	B. MOORE 12 APR 2012	A	D0902418
			CHECKER	D. BRIDGES 26 JUN 2012	REV.	v2
			APPROVAL	SCALE: 2:1		PROJECTION:
					SHEET 1 OF 1	

4

3

2

1