

4

3

2

1

NOTES:
① HELICOILS TO BE INSTALLED INTO ITEM NO. 1 BY LIGO PRIOR TO ASSEMBLY AND AFTER ALL PARTS ARE CLEANED AND BAKED.

REV.	DATE	DCN #	DRAWING TREE #
v1	01 JUN 2010	E0900504	E0900353
-	-	-	-
-	-	-	-

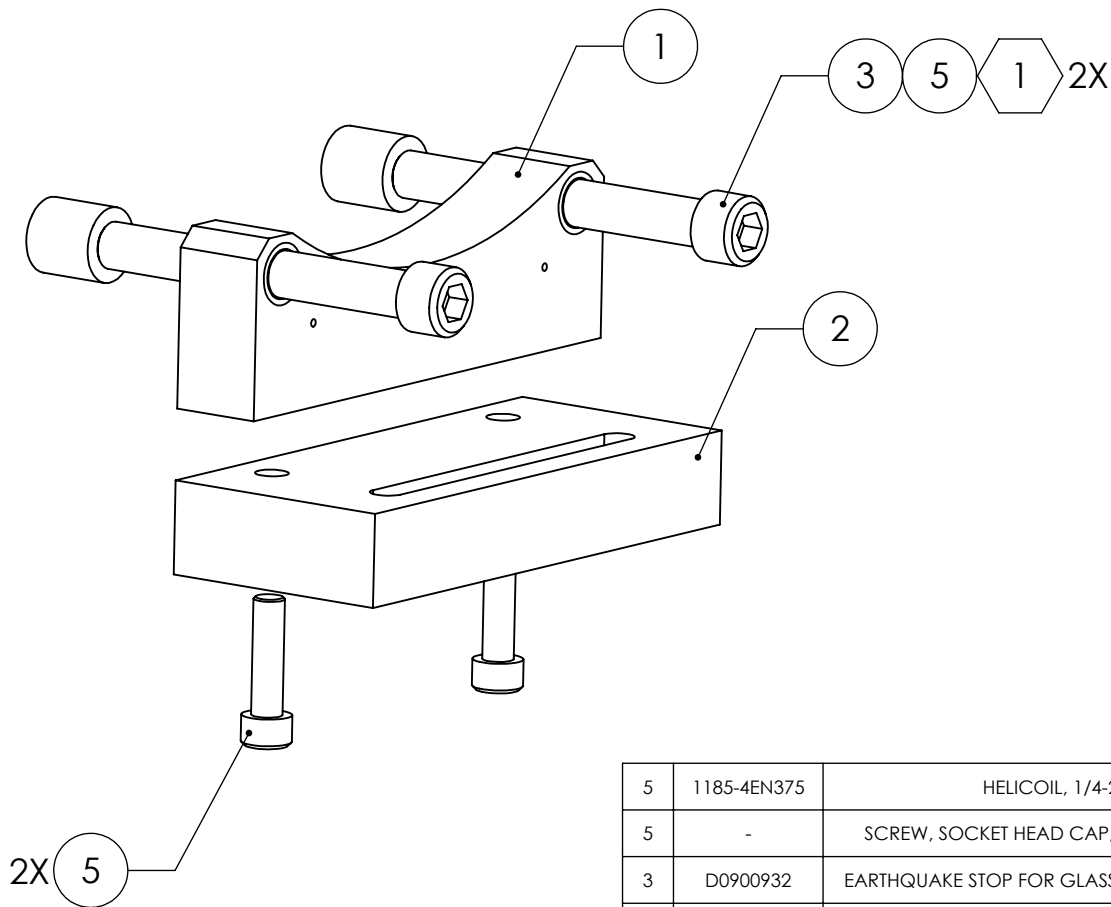

5	1185-4EN375	HELICOIL, 1/4-20 X 0.375 LONG	NITRONIC 60	2		2
5	-	SCREW, SOCKET HEAD CAP, #8-32 UNC-2A X 0.625 LONG ①	300 SSTL	2	-	2
3	D0900932	EARTHQUAKE STOP FOR GLASS (GLASS TIP), SIMPLIFIED, 2 INCH	N/A	2	-	2
2	D0901923	HSTS FACE EQ STOP BASE	6061-T6 Al	1	-	1
1	D0902204	FACE EQ STOP BRACKET, HSTS INTER. MASS ①	6061-T6 Al	1	-	1
ITEM NO.	PART NUMBER	DESCRIPTION	MATERIAL	REQ	SPARE	TOTAL

PARTS LIST

CALIFORNIA INSTITUTE OF TECHNOLOGY MASSACHUSETTS INSTITUTE OF TECHNOLOGY		PART NAME		FACE EQ STOP ASSY, INT. MASS						
SYSTEM	ADVANCED LIGO	SUB-SYSTEM	SUS	DESIGNER	W. RASCH	14 OCT 2009	SIZE	DWG. NO.	REV.	
NEXT ASSY	D020700			DRAFTER	B. MOORE	17 MAY 2010	A	D0902413	v1	
				CHECKER	M. MEYER	01 JUN 2010				
				APPROVAL			SCALE: 1:1	PROJECTION:		SHEET 1 OF 1

4

3

2

1