

8 7 6 5 4 3 2 1

REV.	DATE	DCN #	DRAWING TREE #
v1	30 DEC 2009	E0900507	E0900353
v2	20 JUN 2011	E1100590	E0900353
v3	09 OCT 2012	E1200887	E0900353

- ⑤ PLEASE SEE E1200145 FOR OPTIC ORIENTATION AND WEDGE ANGLE.
- ⑥ ALIGN SPACER, F/N 10, AT A 45° ANGLE.

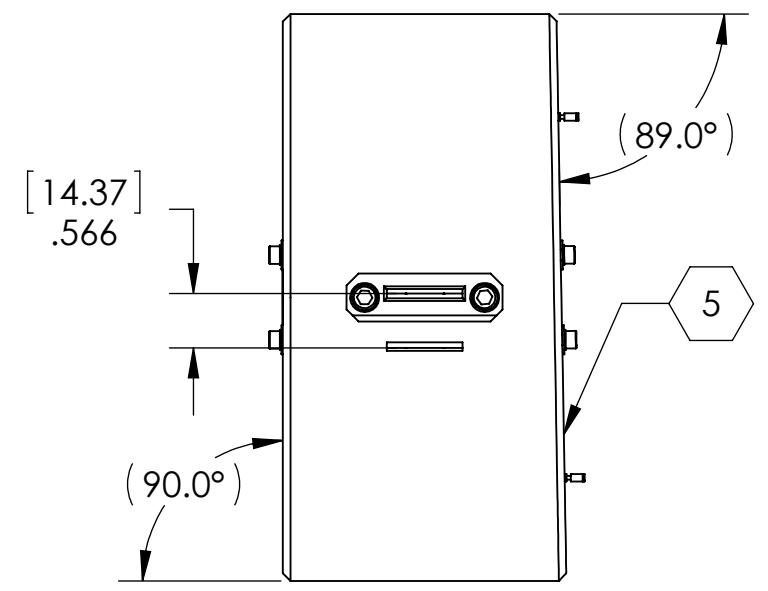
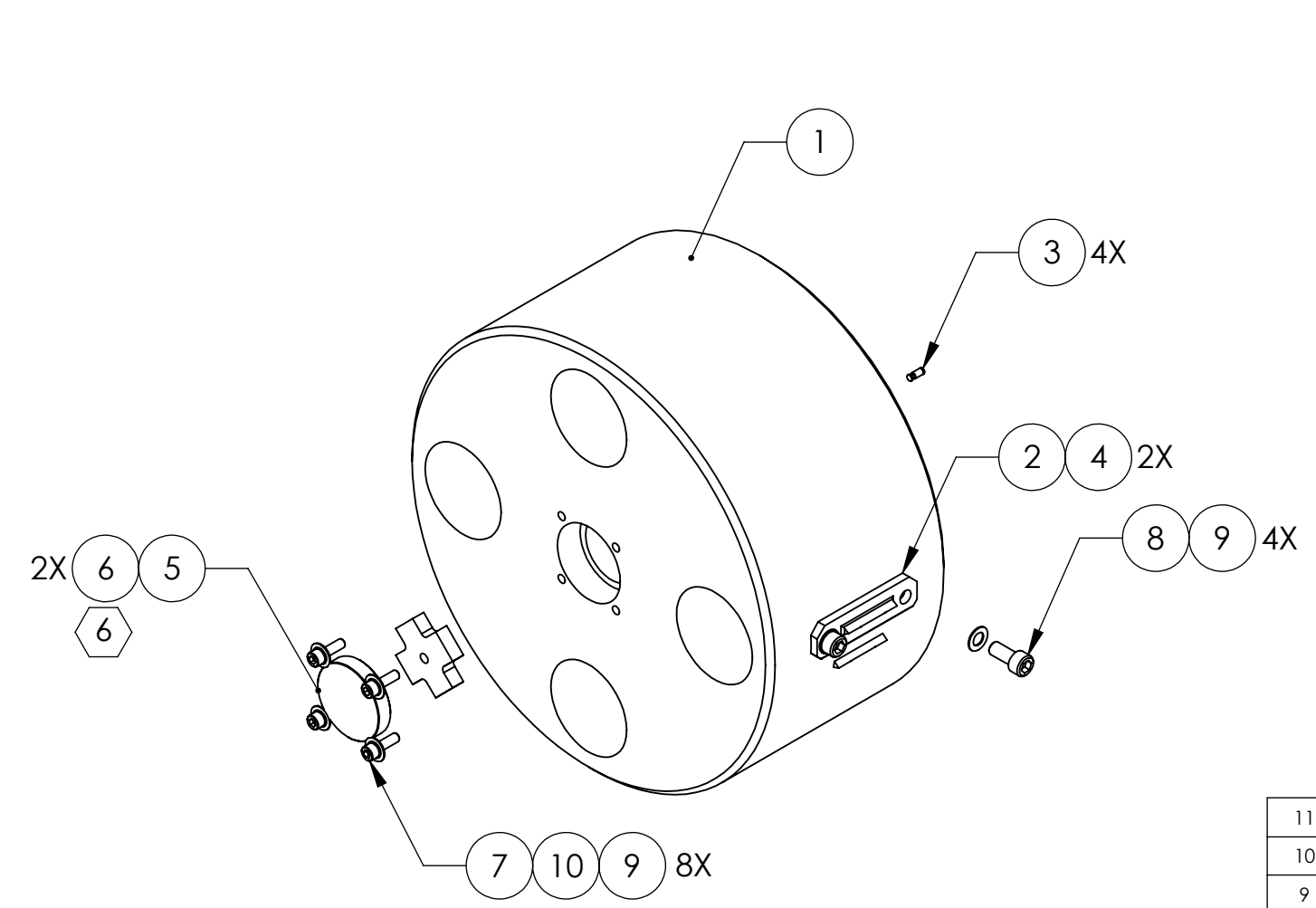

ITEM NO.	PART NUMBER	DESCRIPTION	MATERIAL	REQ	SPARE	TOTAL
11	-	UHV-COMPATIBLE ADHESIVE (MASTERBOND EP30-2 OR EQUIVALENT)	-	AR	-	AR
10	-	WASHER, FLAT, #4 (NAS 620-C4L OR EQUIVALENT)	300 SSSL	8	2	10
9	-	WASHER, FLAT, #8 (NAS 620-C8L OR EQUIVALENT)	300 SSSL	12	3	15
8	-	SCREW, SOCKET HEAD CAP, #8-32 UNC-2A X 0.375 LONG	300 SSSL	4	1	5
7	-	SCREW, SOCKET HEAD CAP, #4-40 UNC-2A X 0.375 LONG	300 SSSL	8	2	10
6	D1100197	SPACER, BOTTOM MASS OPTIC, HLTS/HSTS	-	2	1	3
5	-	METALLIZED MIRROR, ROUND (OPTOSIGMA P/N 033-0280 OR EQUIVALENT)	-	2	1	3
4	D0901278	HSTS SECONDARY METAL PRISM	304, 316 OR 302 SSSL	2	1	3
3	D0902432	MAGNET/STANDOFF ASSEMBLY, HSTS TEST MASS	N/A	4	1	5
2	D0901790	PRIMARY METAL BREAKOFF PRISM, HSTS	304, 316 OR 302 SSSL	2	-	2
1	D0902332	METAL LOWER MASS (PR/SR), HSTS	6061-T6 Al	1	-	1

NOTES: (UNLESS OTHERWISE SPECIFIED)

1. PARTS TO BE ASSEMBLED ACCORDING TO E030518, HSTS ASSEMBLY SPECIFICATION, USING D020427, HSTS MAGNET PLACEMENT FIXTURE.

LIGO CALIFORNIA INSTITUTE OF TECHNOLOGY MASSACHUSETTS INSTITUTE OF TECHNOLOGY

ADVANCED LIGO SUB-SYSTEM **SUS**

PART NAME METAL LOWER MASS (PR/SR) ASSEMBLY, HSTS

DESIGNER M. MEYER 01 NOV 2009 SIZE DWG. NO. **B** **D0902333** REV. **v3**

DRAFTER B. MOORE 23 OCT 2012

CHECKER D. BRIDGES 08 JUN 2012

APPROVAL

NEXT ASSY **D020700**

SCALE: 1:2 PROJECTION: SHEET 1 OF 1

D0902333_AdvLIGO_SUS_HSTS_Metal Test Mass Assembly (PR-SR, 1 deg), HSTS, PART PDM REV: V1, DRAWING PDM REV: V1

8 7 6 5 4 3 2 1