

5. REFER TO DOCUMENT D1101296 FOR OPTICAL TABLE HOLE TABULATION CONVENTION.
6. REFER TO G1000125 FOR ISI NAMING AND ORIENTATION CONVENTION.
7. REFER TO T1100292 FOR VIEWPORT DEFINITION.
8. DIMENSION WRT TO LOCAL BUILDING CS. REFER TO E1200625 FOR LOCAL COORDINATES OF SUPPORT TUBE ENDS.

REV.	DATE	DCN #	DRAWING TREE #
v4	01 OCT 2012		
v9	25 NOV 2014	E1400458-X0	
v10	26 FEB 2015		

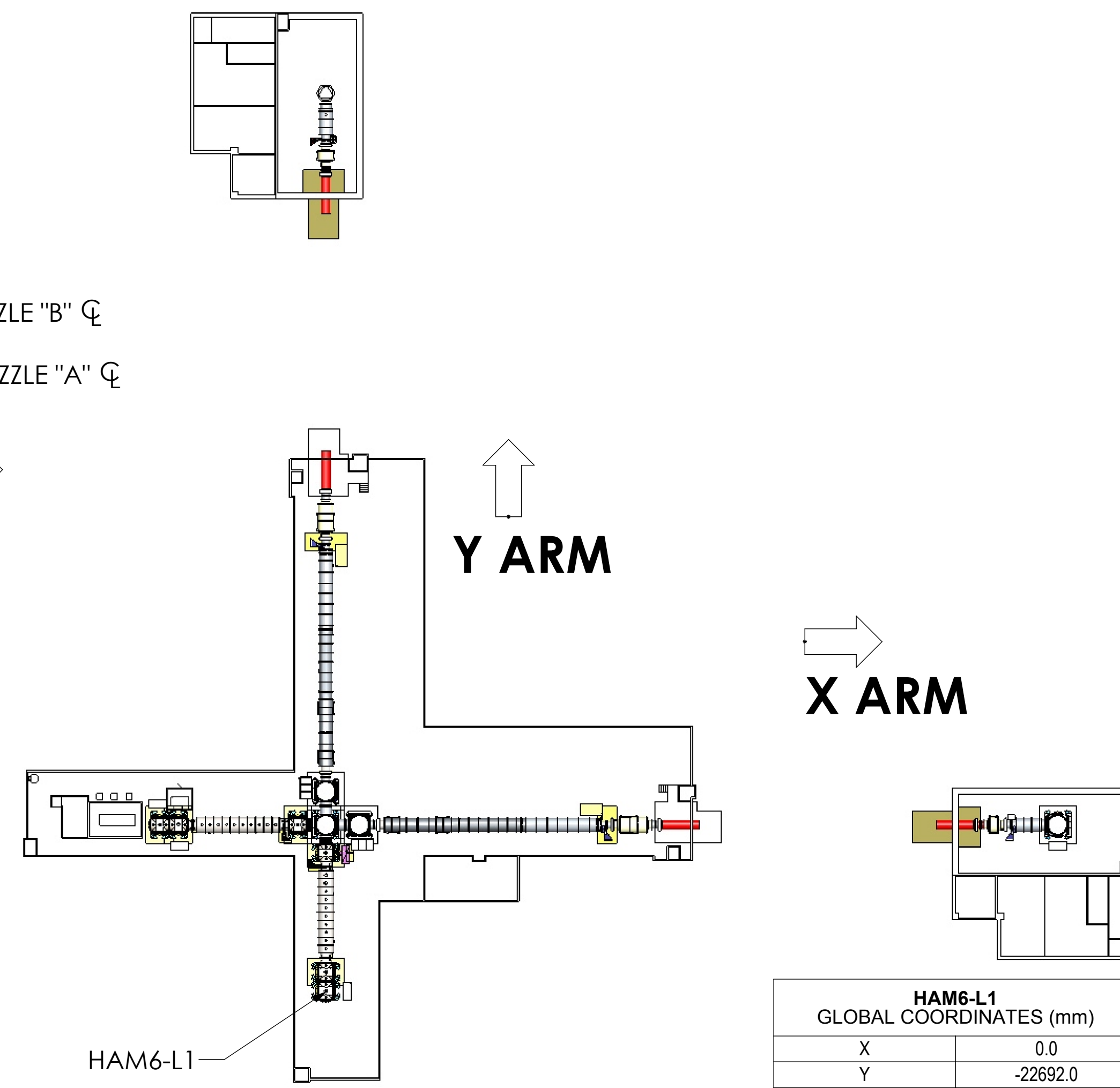

HAM6-L1 GLOBAL COORDINATES (mm)	
X	0.0
Y	-22692.0
Z	0.0

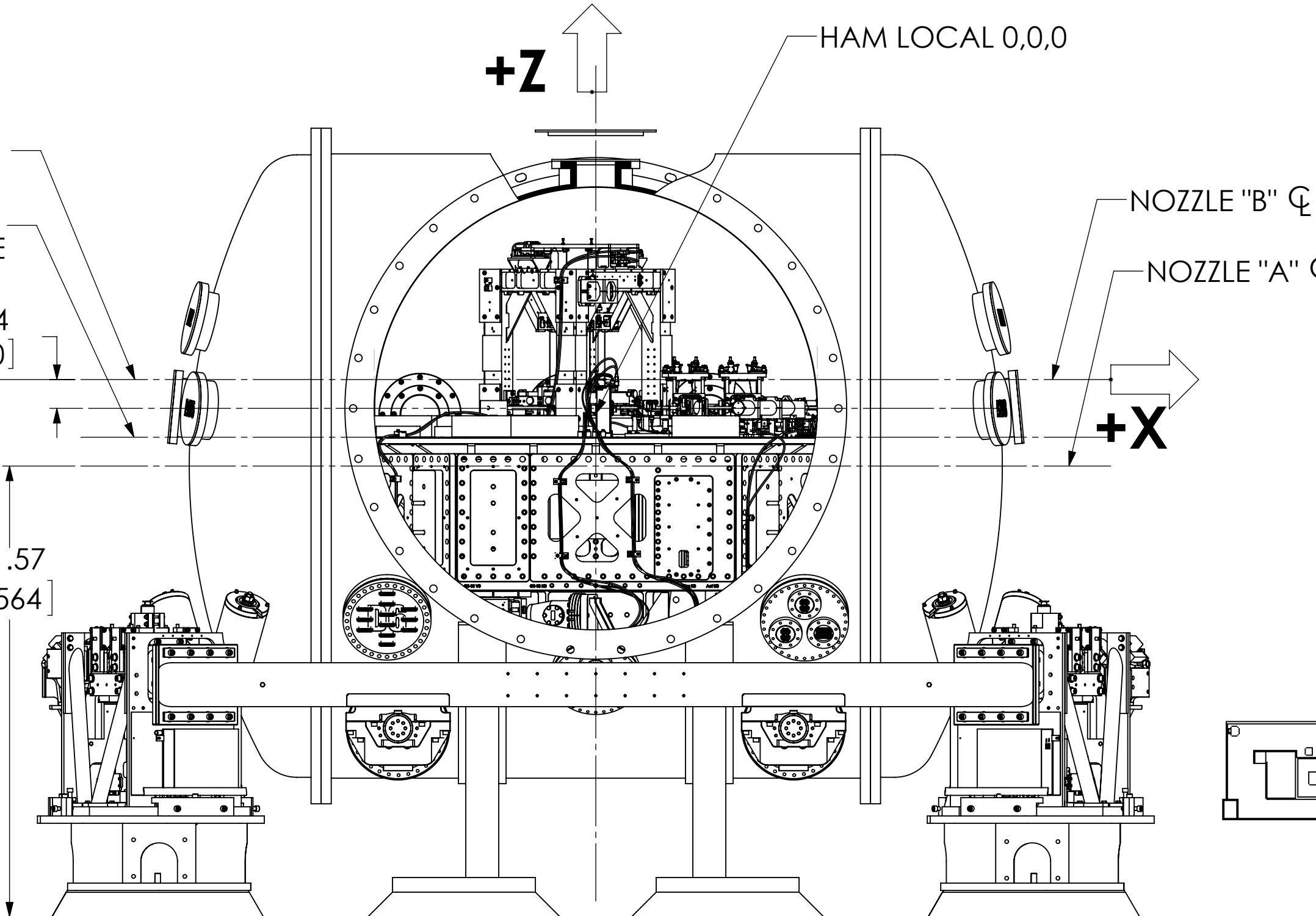
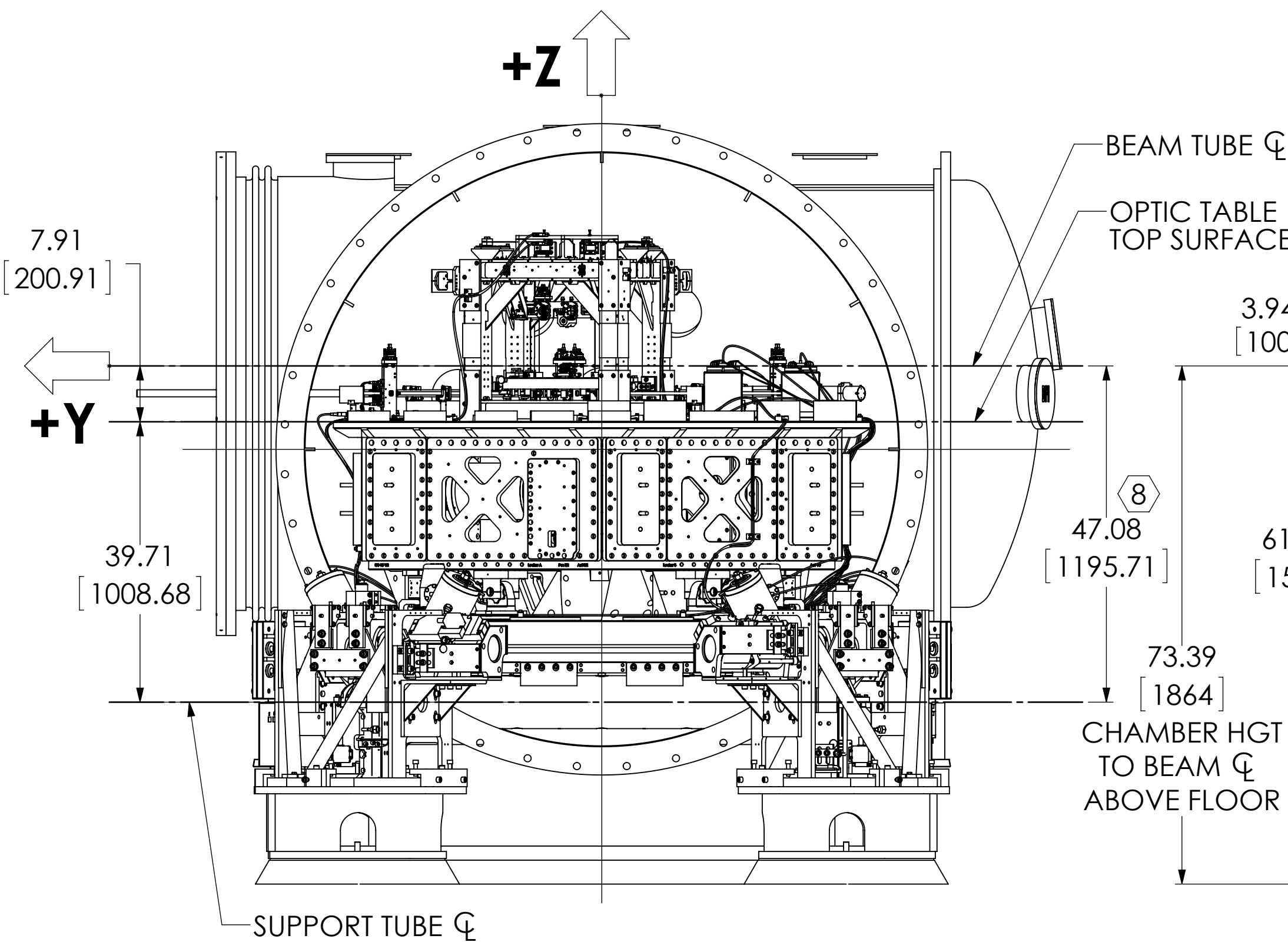
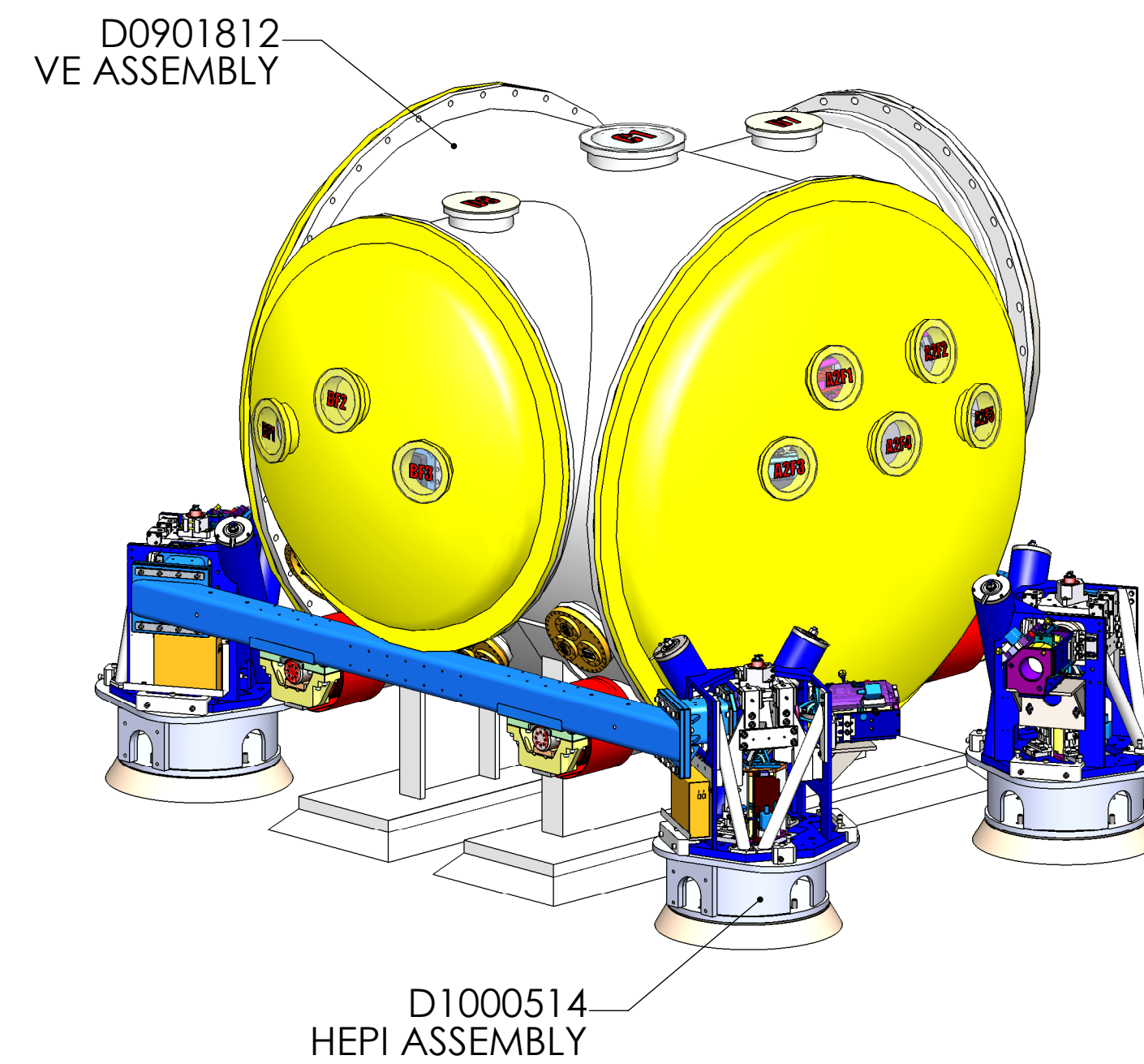
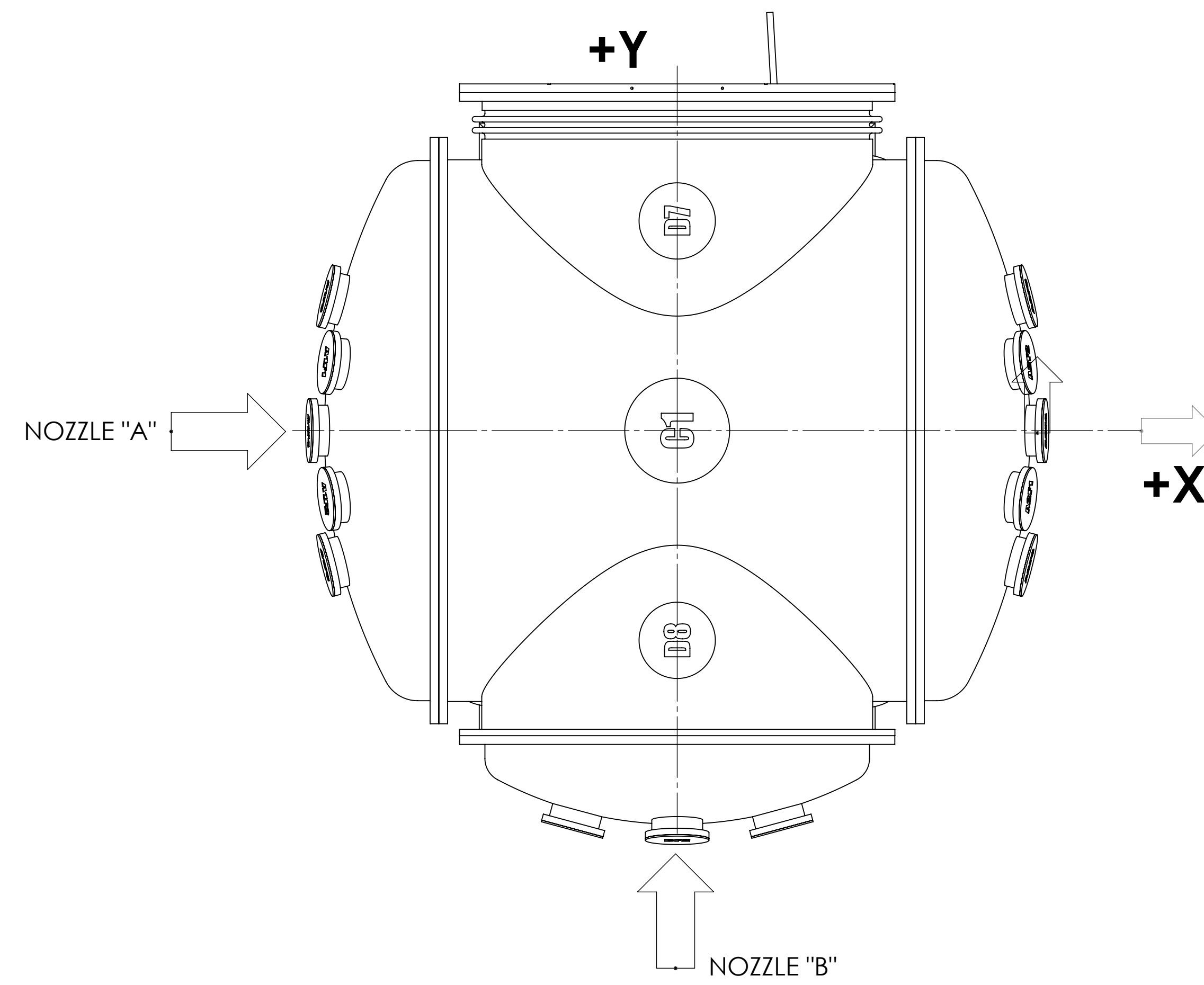
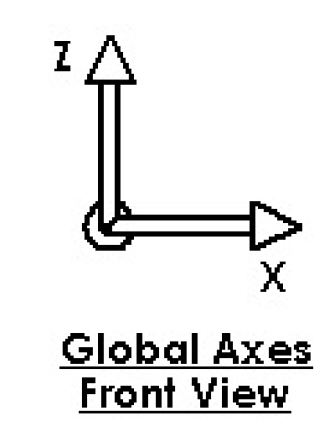

NOTES AND TOLERANCES: (UNLESS OTHERWISE SPECIFIED)		LIGO CALIFORNIA INSTITUTE OF TECHNOLOGY MASSACHUSETTS INSTITUTE OF TECHNOLOGY		PART NAME	
DIMENSIONS ARE IN INCHES		ADVANCED LIGO		AdvLIGO Systems, HAM6-L1 Top Level Chamber Assembly	
MATERIAL	N/A	FINISH	N/A μinch	DESIGNER	ED CHAVEZ
				DRAFTER	07 MAY 2012
				CHECKER	
				APPROVAL	
				SIZE	DWG. NO.
				D	D0901811
				SCALE: 1:16	PROJECTION:
					SHEET 1 OF 4

D0901811 AdvLIGO Systems, HAM6-L1 Top Level Chamber Assembly, ALL PART PDM REV. X-053, DRAWING PDM REV. X-014

9 SAFETY BOLTS + VITON PADS NOT INSTALLED.  
REFER TO D1201021 FOR DETAILS.

D1300077  
OMC STRUCTURE ASSY

D1200317  
ISC BLOCKDIAGRAM ASSY  
(SEE D1000342 FOR DETAILS)

D1100979  
HAM ISI TABLE ASSY

D1201021  
BALANCE MASSES ASSY

8	D1201021 AdvLIGO Systems HAM6-L1 ISI Table, Balance Masses Assembly	AdvLIGO HAM6-L1 ISI Table, Payload & Suspended Mass Assembly	1
6	D1300122	Cable Harness Routing Configuration - HAM6	1
5	D1300077	AdvLIGO SEI HAM6-L1, XYZ Local CS for Output Mode Cleaner	1
4	D1200317	AdvLIGO SEI HAM6-L1, XYZ Local CS for ISC BlockDiagram	1
3	D1100979	AdvLIGO SEI HAM6-L1, XYZ Local CS for ISO Table	1
2	D1000514	HEPI ASSEMBLY, HAM, aLIGO SEI	1
1	D0901812	AdvLIGO VE HAM6-L1, Vacuum Equipment Assembly	1
ITEM NO.	PART NUMBER	DESCRIPTION	Full Complete /QTY.

**LIGO** CALIFORNIA INSTITUTE OF TECHNOLOGY  
MASSACHUSETTS INSTITUTE OF TECHNOLOGY

SIZE DWG. NO. REV.  
D D0901811 v10

SCALE: 1:5 PROJECTION: SHEET 2 OF 4

DD0901811 AdvLIGO Systems: HAM6-L1 Top Level Chamber Assembly: ALL PART PDM REV: X-053, DRAWING PDM REV: X-014

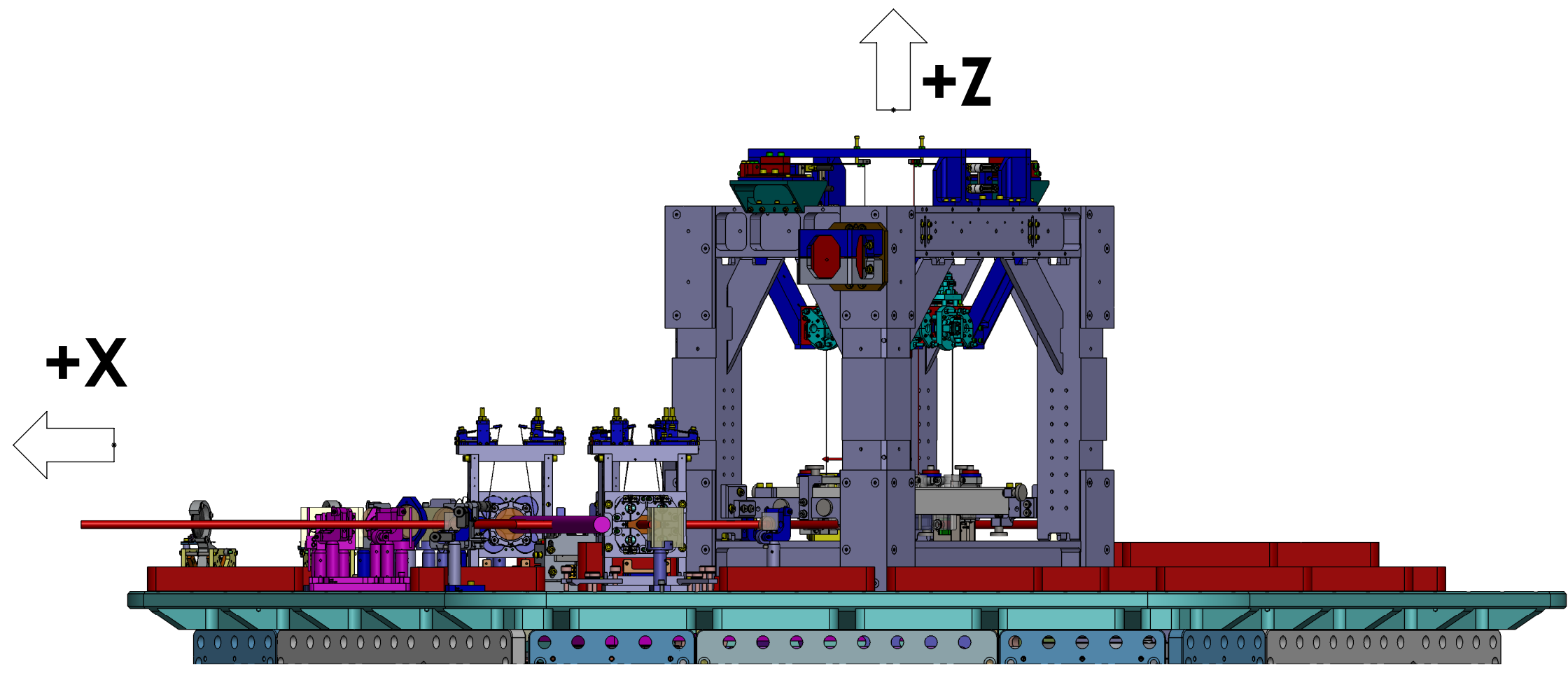

REAR VIEW  
(ROTATED 180 DEGREES CCW)

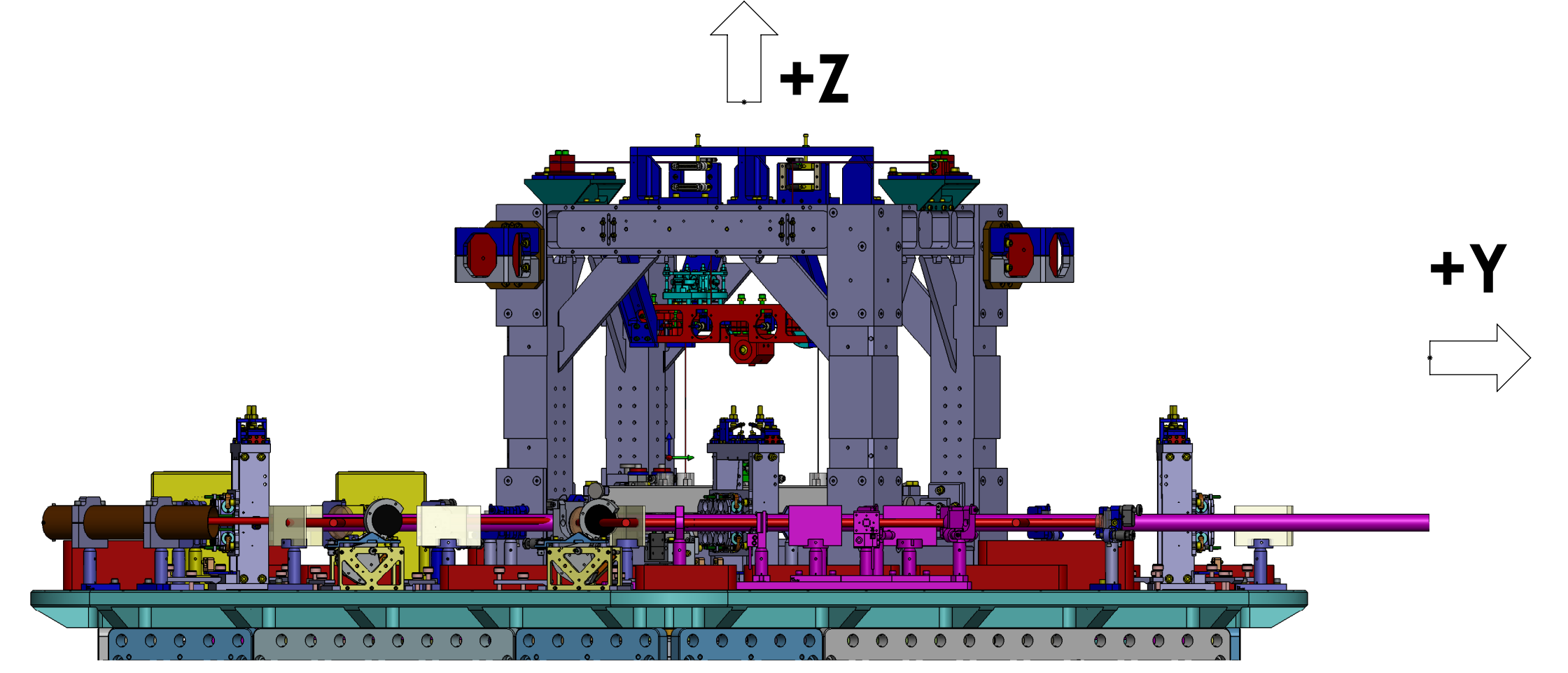

RIGHT SIDE VIEW  
(ROTATED 180 DEGREES CCW)

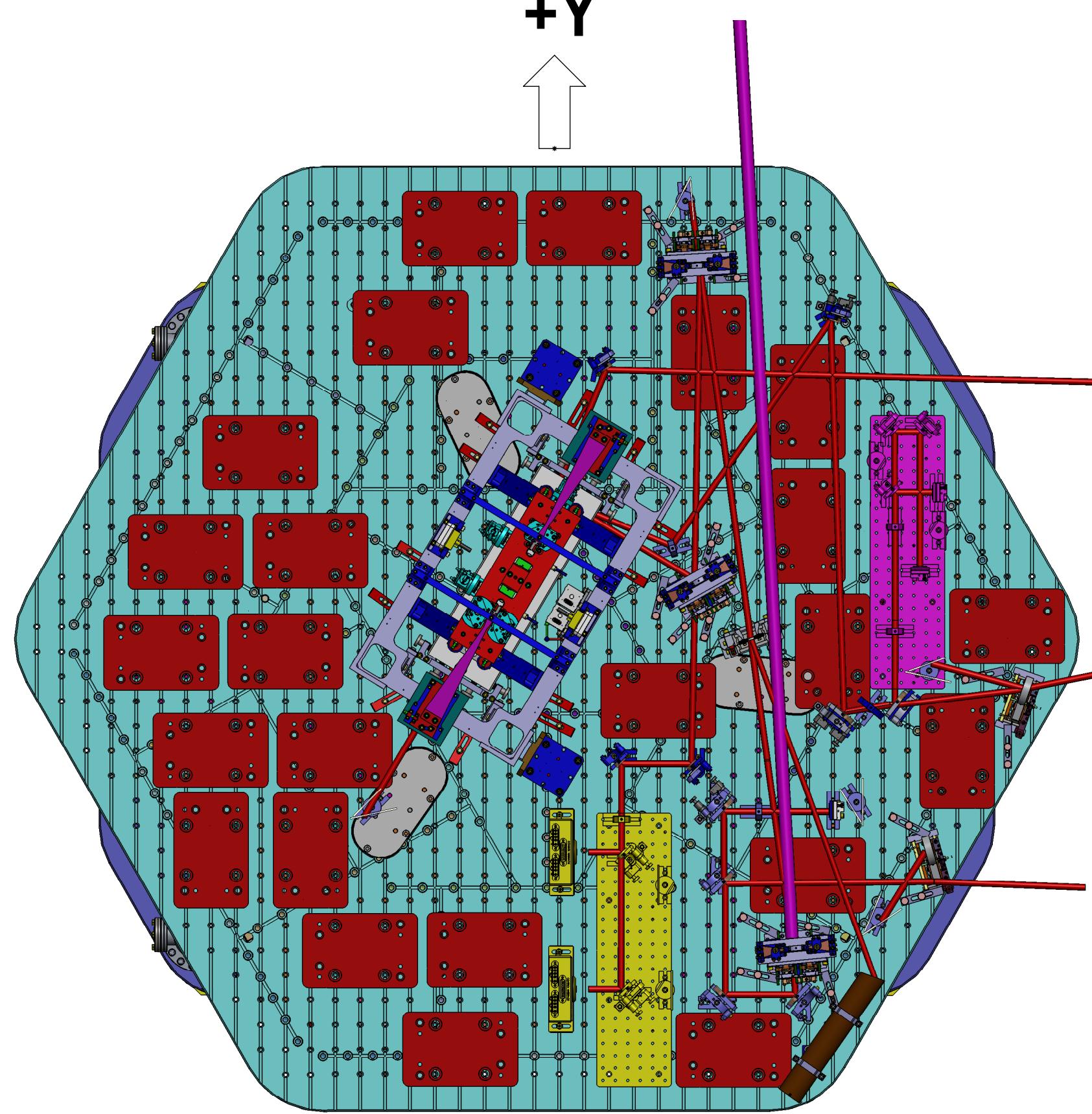

TOP VIEW

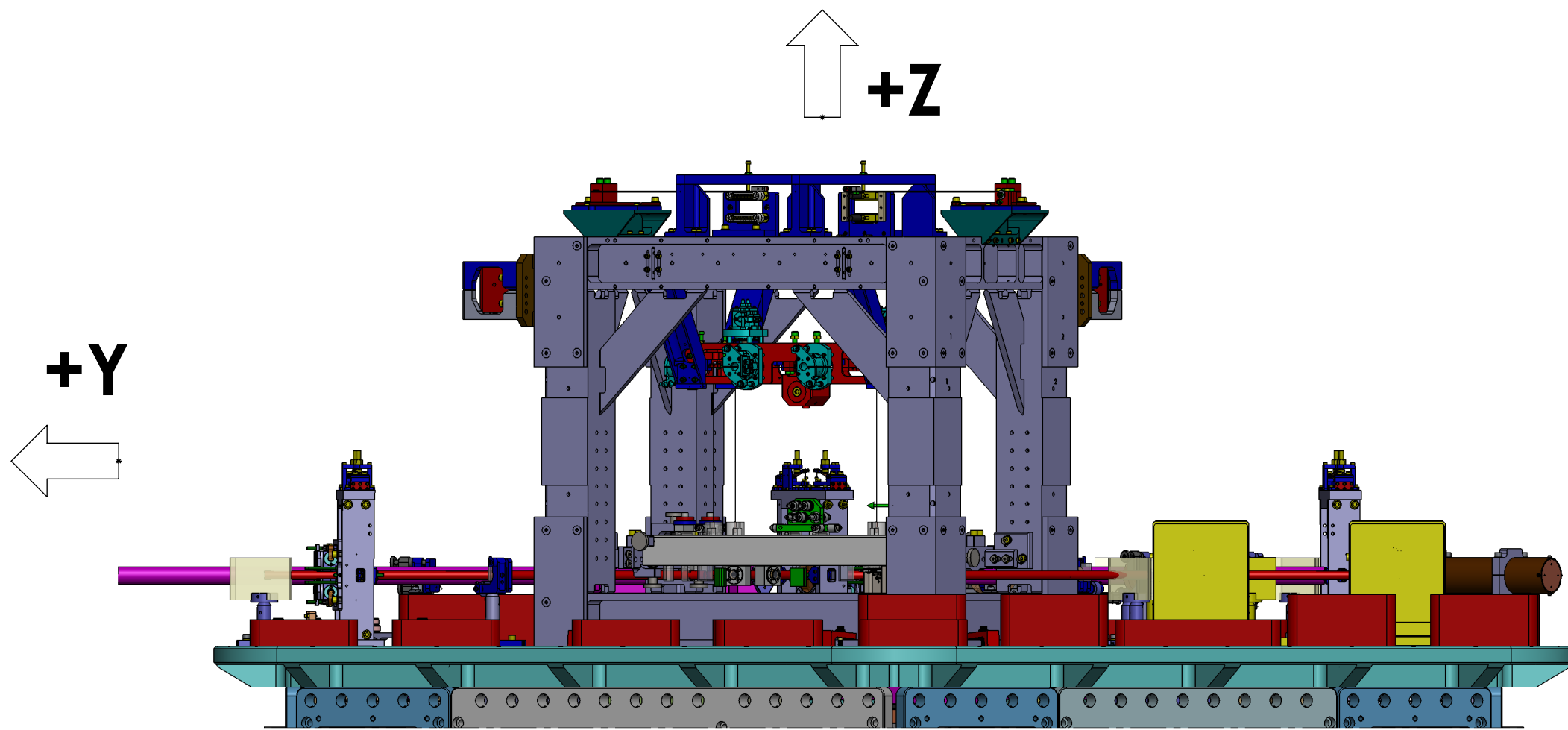

LEFT SIDE VIEW  
(ROTATED 90 DEGREES CCW)

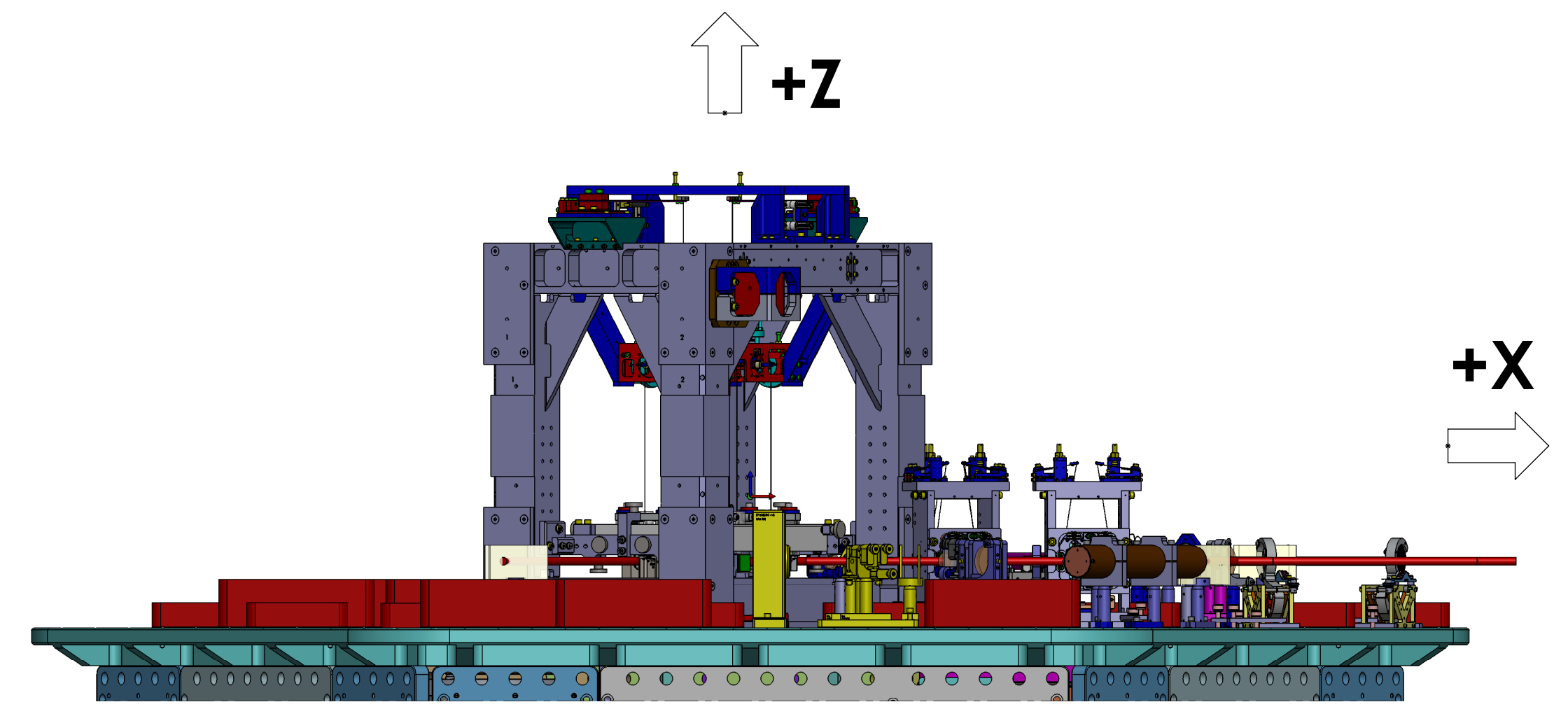

FRONT VIEW

LASER BEAMS - ORTHO VIEWS

CALIFORNIA INSTITUTE OF TECHNOLOGY MASSACHUSETTS INSTITUTE OF TECHNOLOGY	
SIZE DWG. NO.	REV.
D D0901811	v10
SCALE: 1:8	PROJECTION:
SHEET 3 OF 4	

D0901811 Asst LIGO Systems: HAM6-L1 Top Level Chamber Assembly: ALL PART PDM REV: X-053 DRAWING PDM REV: X-014

8 7 6 5 4 3 2 1

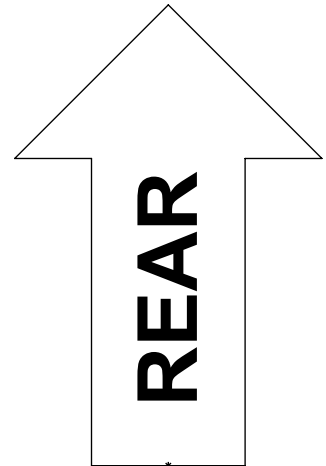
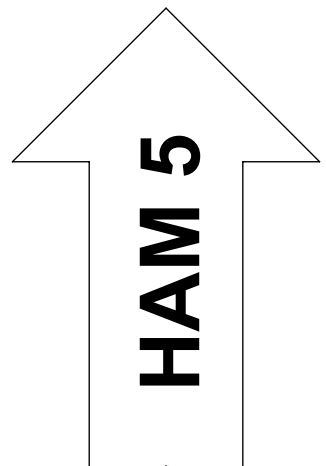
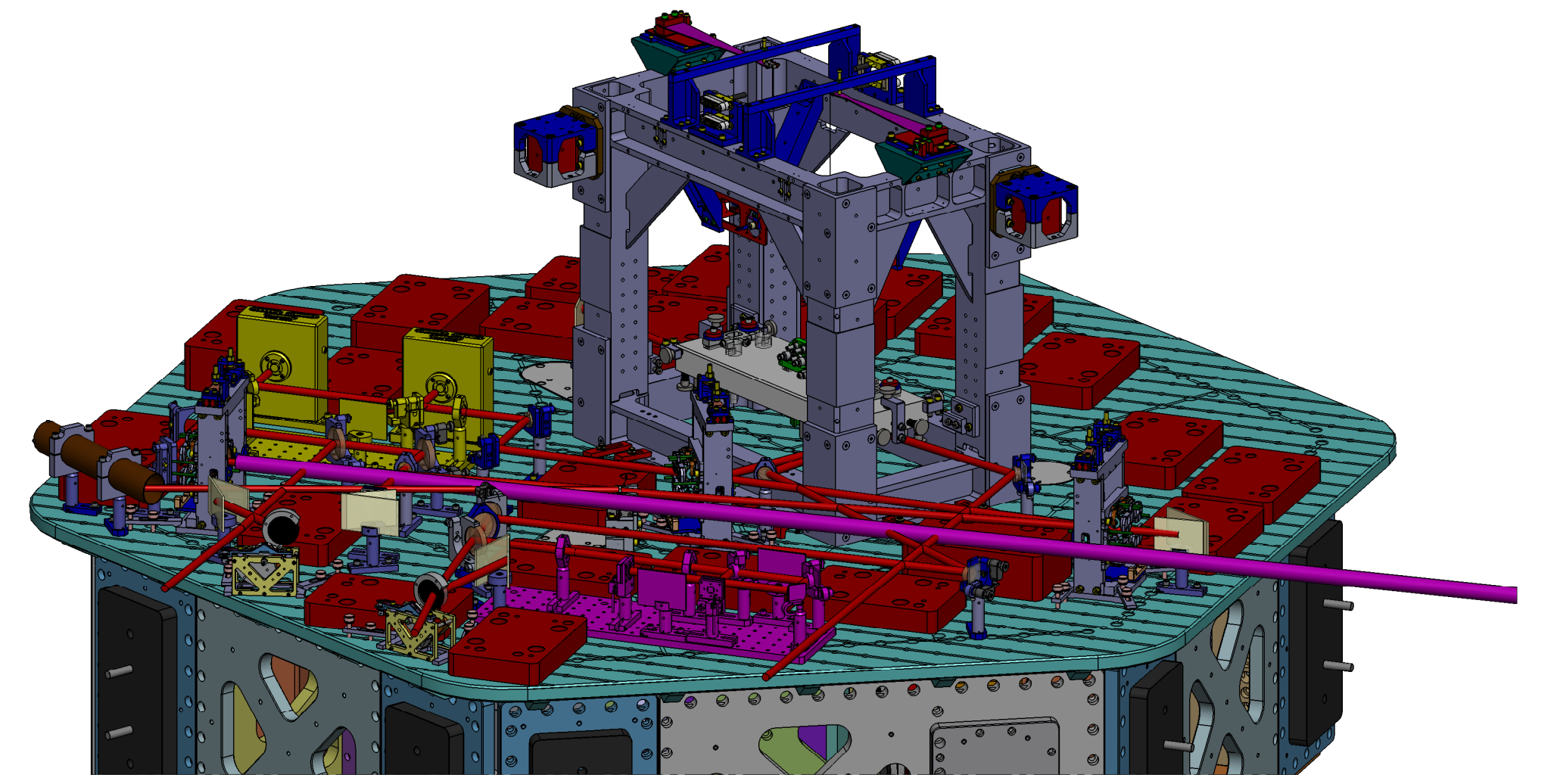
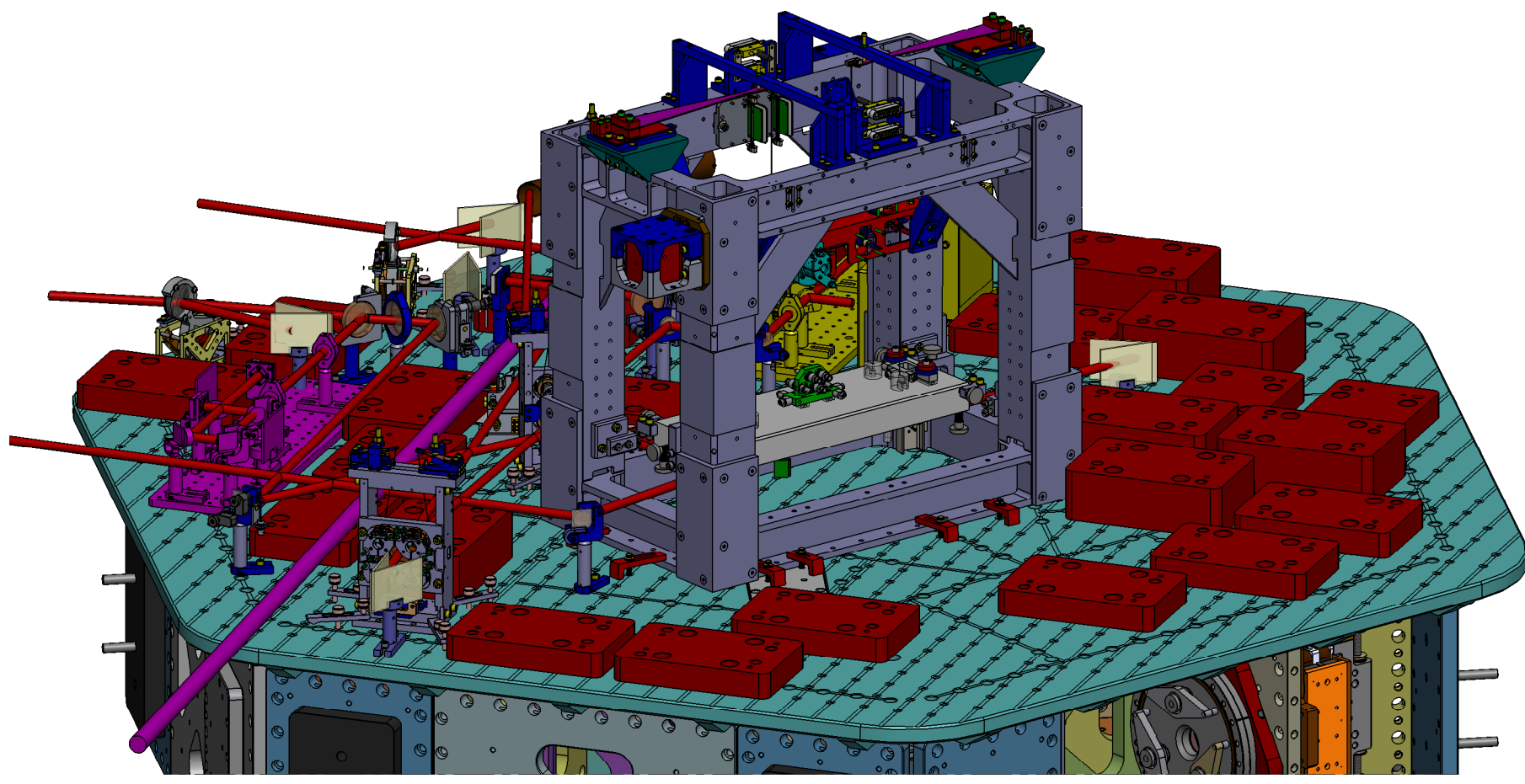

+Y

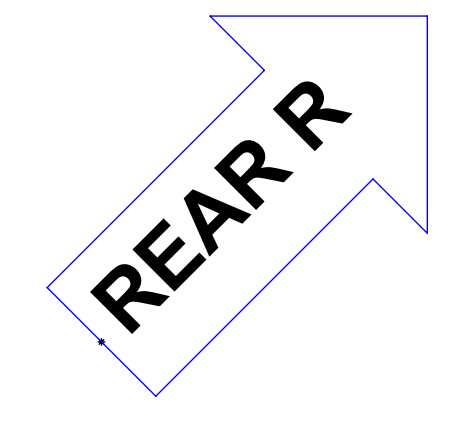
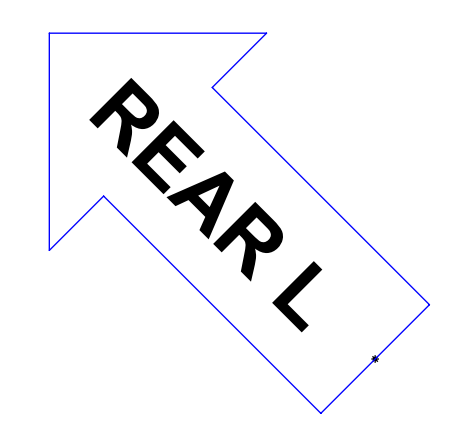
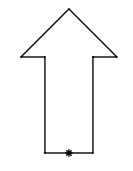

+X

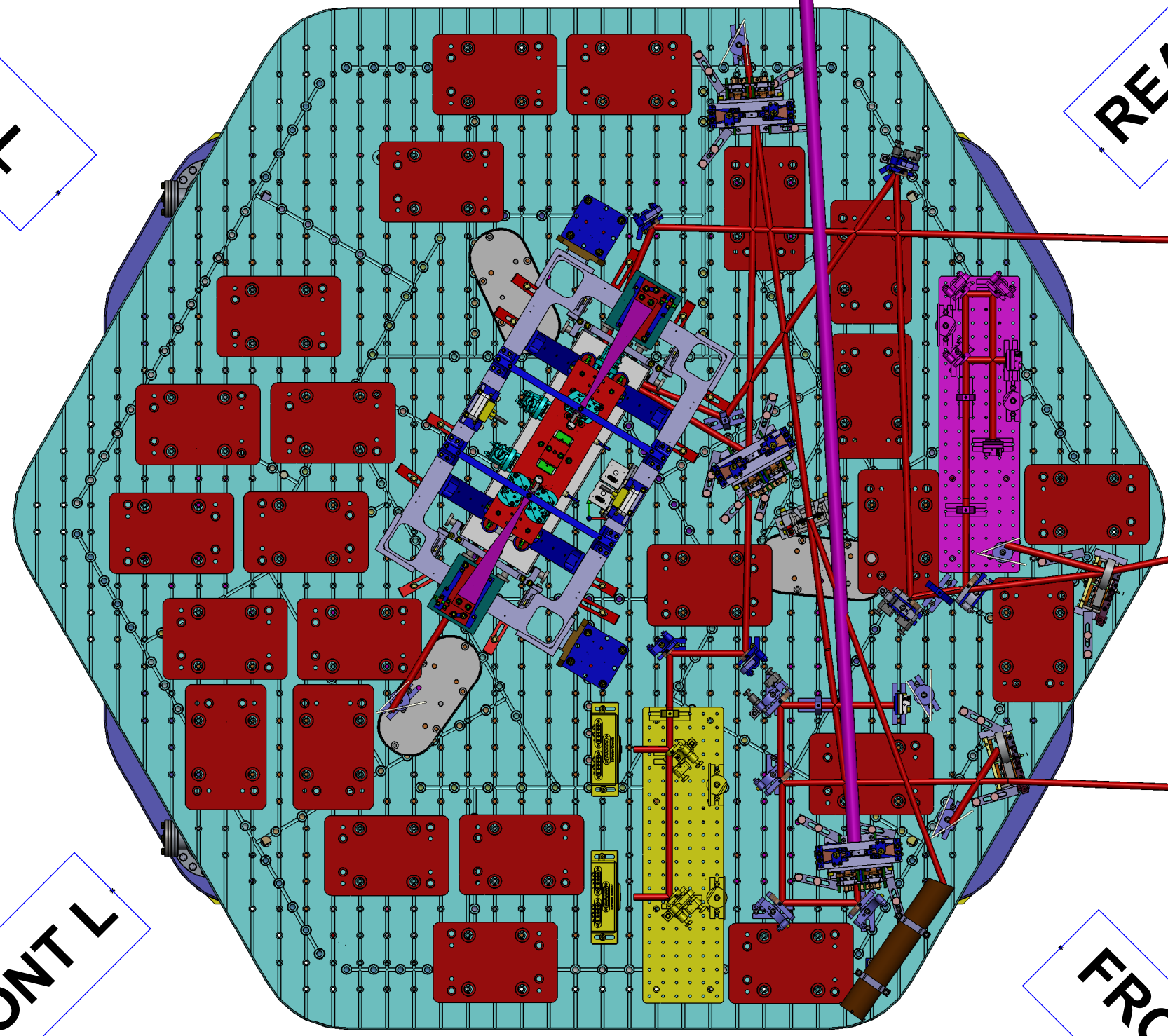
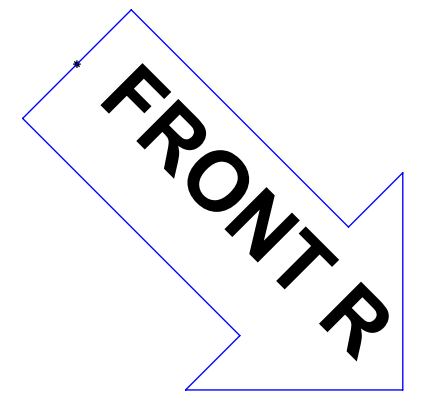
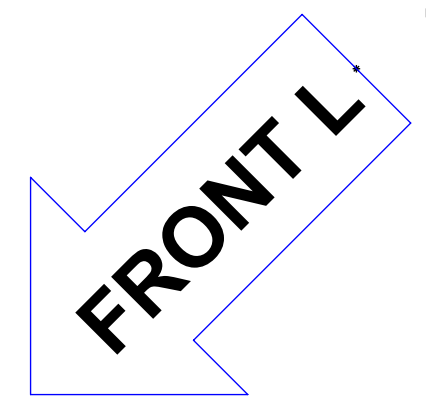
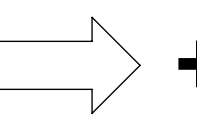

TOP VIEW

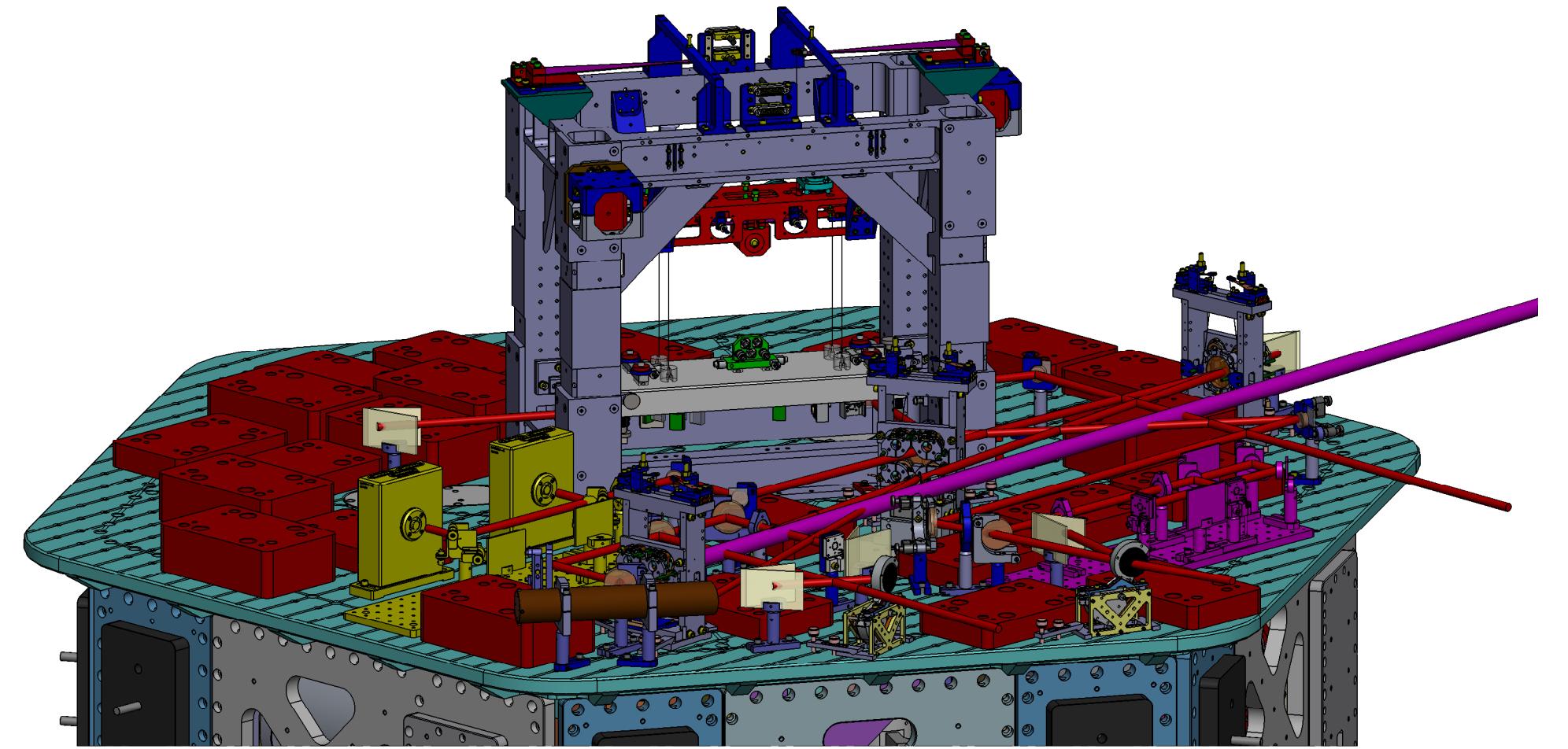
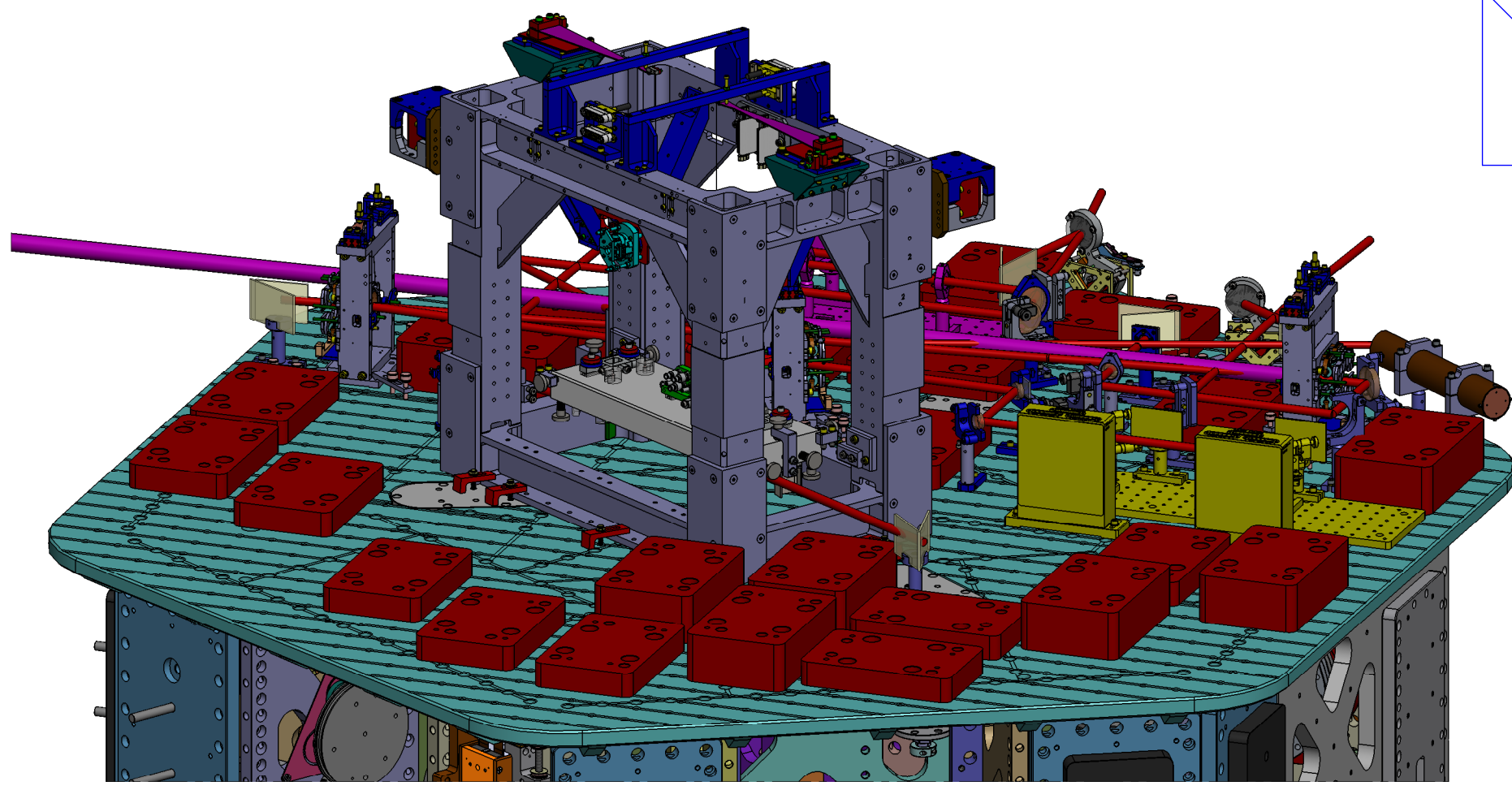

# LASER BEAMS - ORTHO VIEWS

**LIGO** CALIFORNIA INSTITUTE OF TECHNOLOGY  
MASSACHUSETTS INSTITUTE OF TECHNOLOGY

SIZE	DWG. NO.	REV.
D	D0901811	v10
SCALE: 1:8	PROJECTION:	SHEET 4 OF 4

DD901811 Adv/LIGO Systems: HAM6-L1 Top Level Chamber Assembly: ALL PART PDM REV: X-053 DRAWING PDM REV: X-014

8 7 6 5 4 3 2 1