

TAP 4 HOLES 8-32 UNC X 15 DP
X 0.005" OVERSIZE ON 123 PCD
⊕ ∅0.2

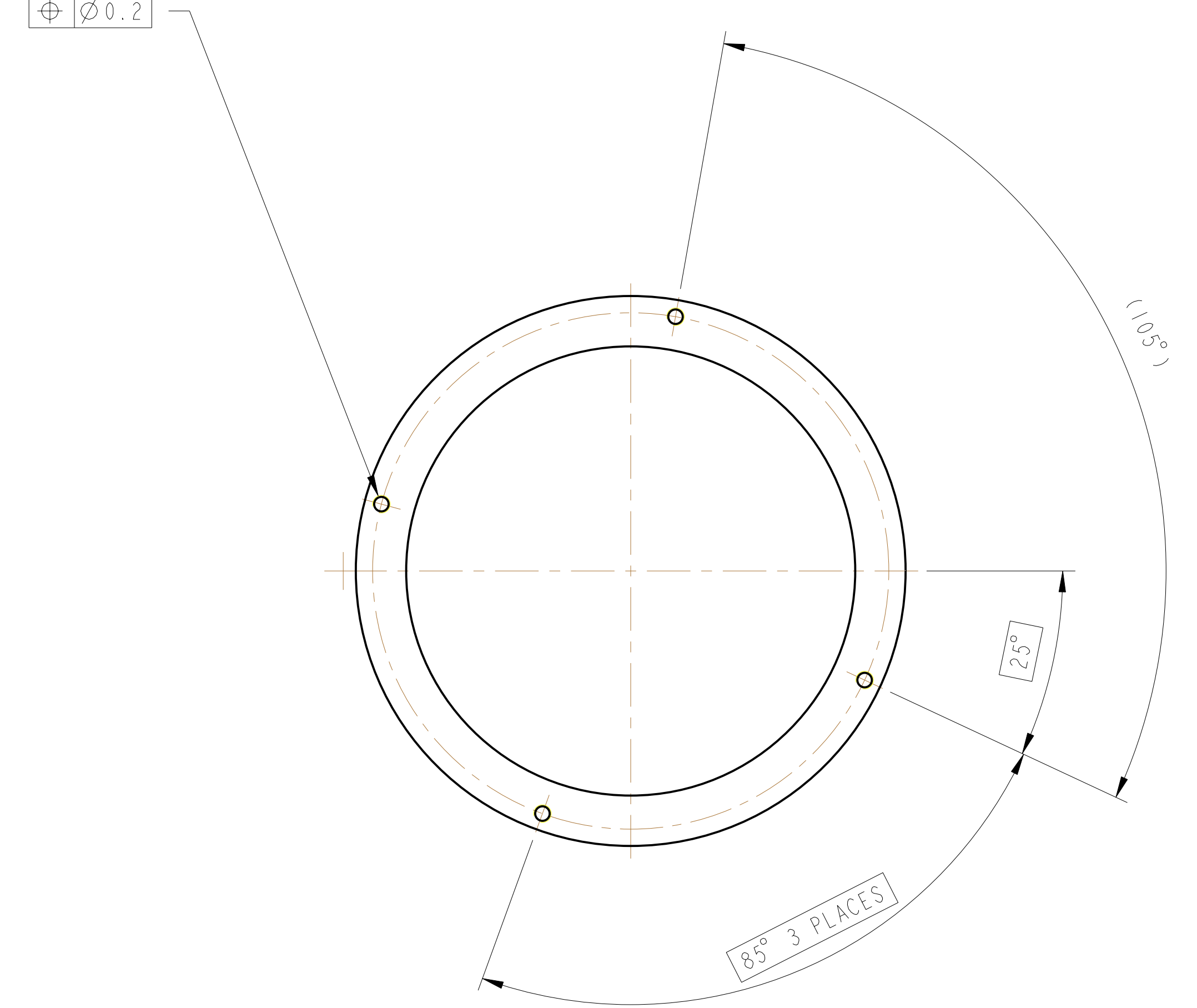
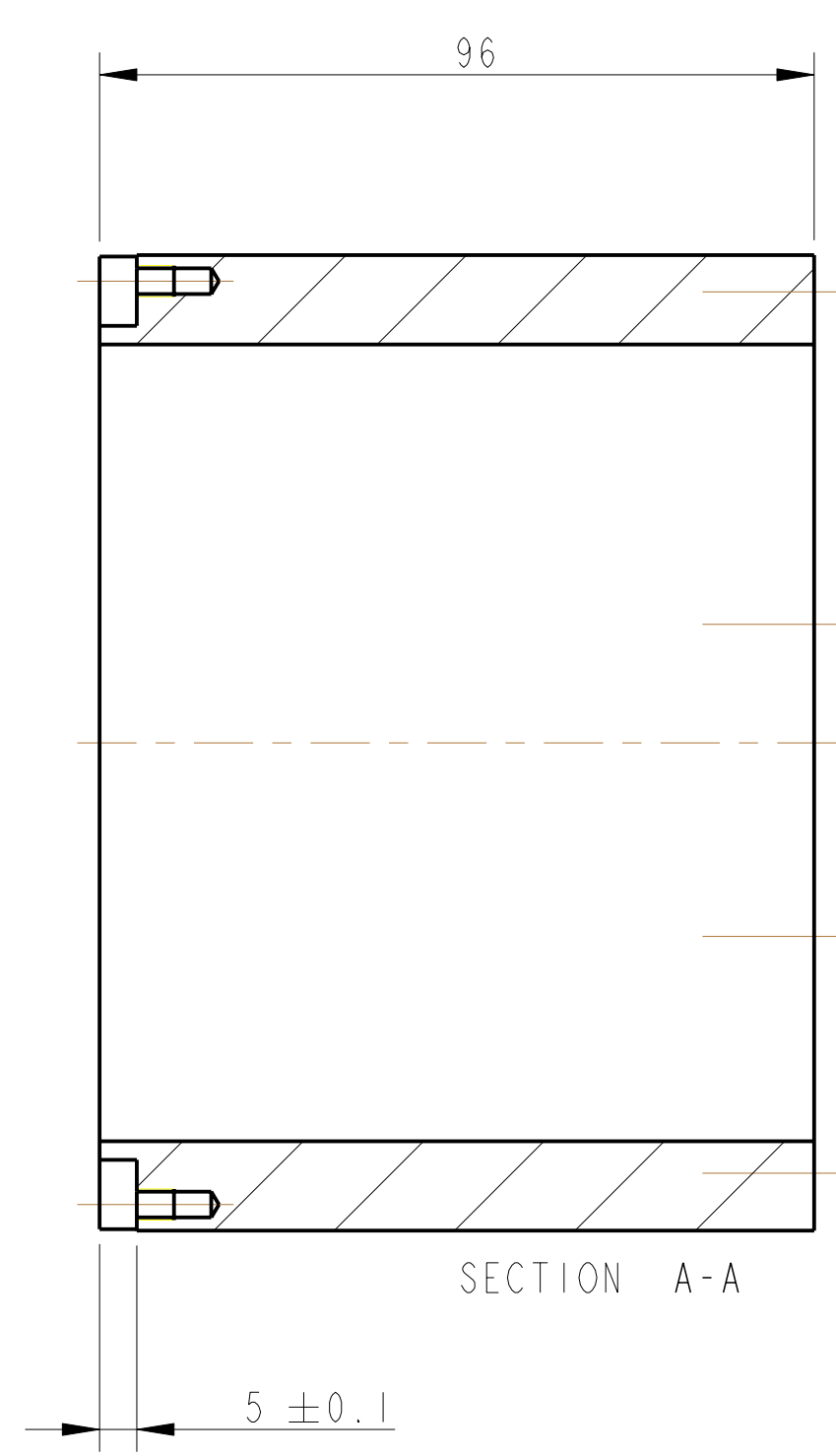
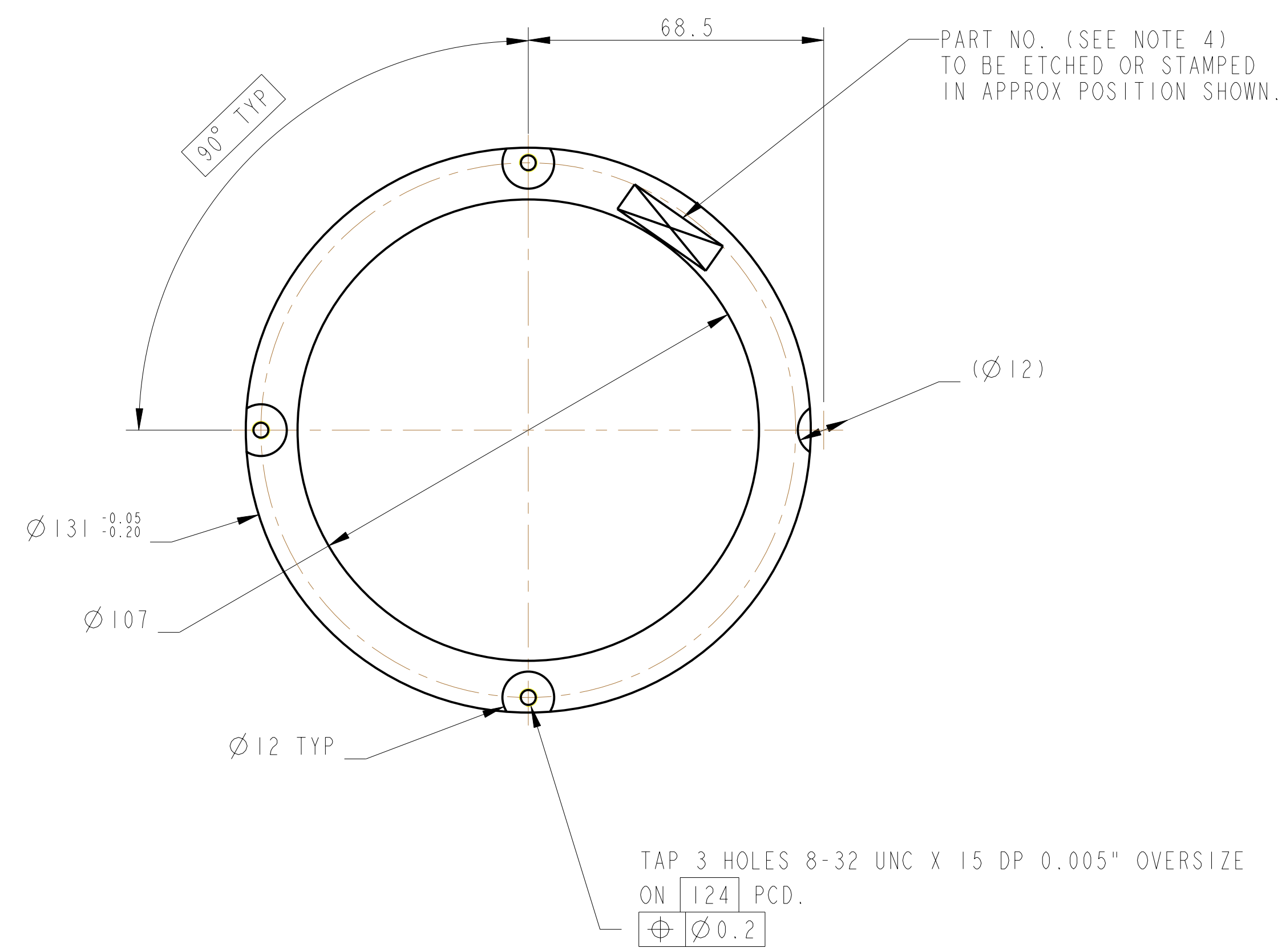

NOTES: (UNLESS OTHERWISE SPECIFIED)

- REMOVE ALL SHARP EDGES. R.02 MIN.
- DO NOT SCALE FROM DRAWING.
- ALL MACHINING FLUIDS SHALL BE WATER SOLUBLE AND FREE OF SULFUR, CHLORINE AND SILICONE. SUCH AS CINCINNATI MILACRON'S CIMTECH 410 (STAINLESS STEEL).
- SCRIBE, ENGRAVE OR STAMP DRAWING PART NUMBER ON NOTED SURFACE OF PART AND A THREE DIGIT SERIAL NUMBER. SERIAL NUMBERS START AT 001 FOR THE FIRST PART AND PROCEED CONSECUTIVELY. USE 07* HIGH CHARACTERS. EXAMPLE: 000100-001 - A VIBRATOR TOOL MAY BE USED.

DIMENSIONS ARE IN mm (INCHES)
TOLERANCES:
X.XX ±.13
ANGULAR ±0.25 °

MATERIAL: ST STEEL
304 OR 316

FINISH: CLEAN, GREASE FREE
√μm (μIN) Ra = 1.6

NAME	DATE
DRAWN J. O'DELL	09/04/08
CHECKED MB	15/MAR/10
APPROVED JOD	15/MAR/10

CALIFORNIA INSTITUTE OF TECHNOLOGY
MASSACHUSETTS INSTITUTE OF TECHNOLOGY
RUTHERFORD APPLIION LABORATORIES

SYSTEM aLIGO
SUB-SYSTEM SUS
NEXT ASSY PENRE QUAD
PART NAME CAN BODY
PEN RE MASS CAN

DRG. NO. 0000168
SCALE 1:1 PROJECTION