

4 HOLES $\varnothing 4.3$ THRO'
C'BORE $\varnothing 7$ X 10 DP
ON REVERSE

$\varnothing 0.2$

PART NO. (SEE NOTE 4)
TO BE ETCHED OR STAMPED
IN APPROX POSITION SHOWN

2 HOLES THRO' FOR
8-32 UNC HELICOILS
HELICOILS NOT TO BE FITTED

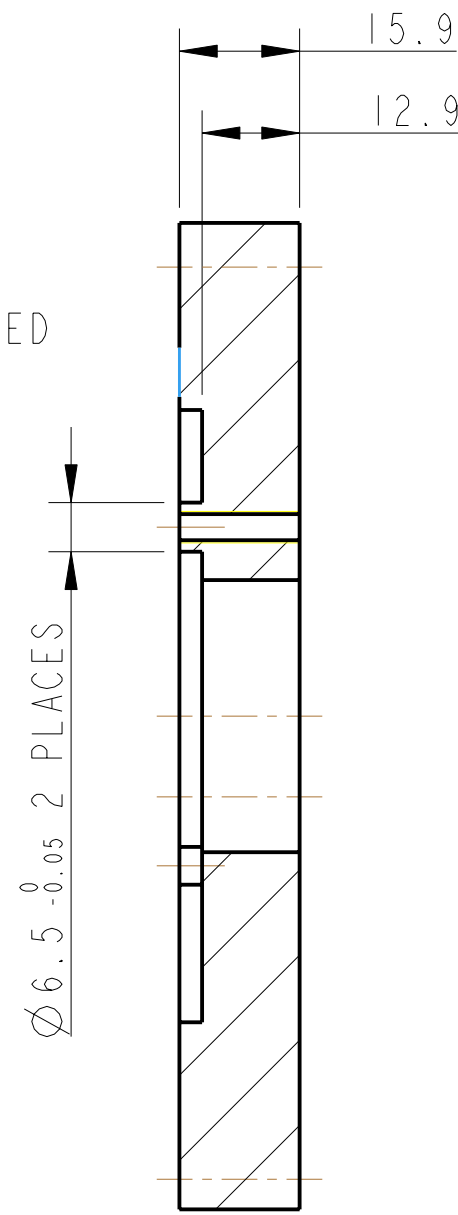

SECTION A-A

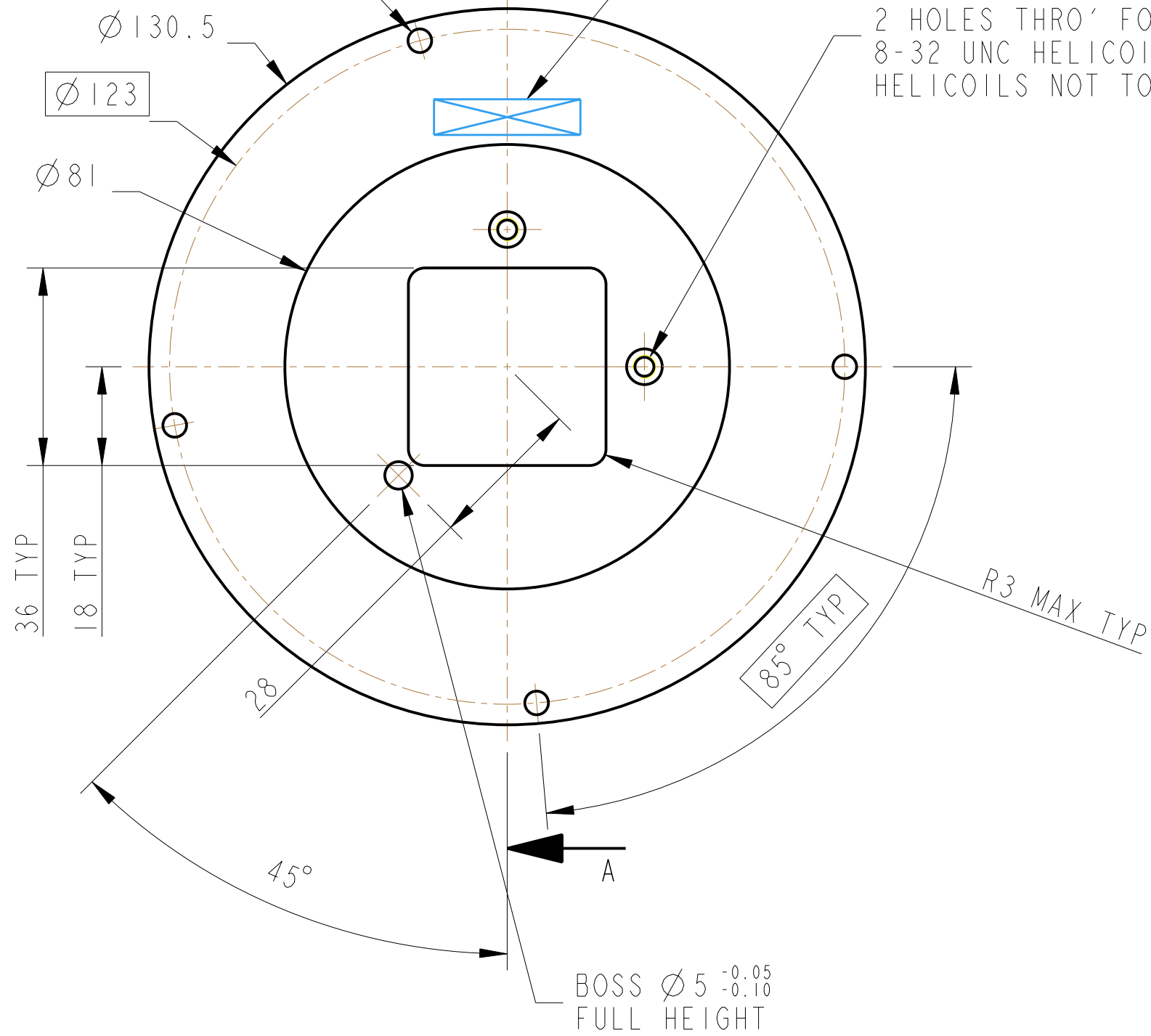

BOSS $\varnothing 5$ -0.05
 -0.10
FULL HEIGHT

NOTES: (UNLESS OTHERWISE SPECIFIED)

- REMOVE ALL SHARP EDGES, R.02 MIN.
- DO NOT SCALE FROM DRAWING.
- ALL MACHINING FLUIDS SHALL BE WATER SOLUBLE AND FREE OF SULFUR, CHLORINE AND SILICONE, SUCH AS CINCINNATI MILACRON'S CIMTECH 410 (STAINLESS STEEL)
- SCRIBE, ENGRAVE OR STAMP DRAWING PARTNUMBER ON NOTED SURFACE OF PART AND A THREE DIGIT SERIAL NUMBER. SERIAL NUMBERS START AT 001 FOR THE FIRST PART AND PROCEED CONSECUTIVELY. USE .07" HIGH CHARACTERS. EXAMPLE: D020188- 001. A VIBRATORY TOOL MAY BE USED.

DIMENSIONS ARE IN mm [INCHES]	
TOLERANCES:	
X.XX ± 0.2 mm	
ANGULAR ± 0.25 °	
MATERIAL:	ST. STEEL 304 OR 316
FINISH:	CLEAN, GREASE FREE
$\sqrt{\mu m}$ [μin]	$R_a = 1.6$
NAME	DATE
DRAWN J O'DELL	09/04/08
CHECKED MB	15/MAR/10
APPROVED JOD	15/MAR/10

CALIFORNIA INSTITUTE OF TECHNOLOGY MASSACHUSETTS INSTITUTE OF TECHNOLOGY IGR, GLASGOW UNIVERSITY GEO 600 GROUP RUTHERFORD APPLETON LABORATORIES	
SYSTEM	aLIGO
SUB-SYSTEM	SUS
NEXT ASSY	PENRE MASS QUAD
PART NAME	CAN FRONT PLATE PEN RE MASS CAN
SIZE	B
DRG. NO.	D080167
REV	B.
SCALE	1:1
PROJECTION	First Angle
SHEET	1 OF 1